

LOCATION DRAWING
PRONTO 10-11-67

VEGETATION:
GRASSLAND
SURFACE USE:
RANGELAND

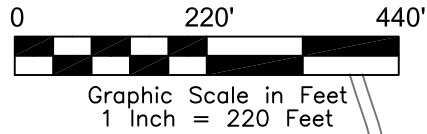

PRONTO 10-11-67 WELLHEAD
LATITUDE: 40.941381
LONGITUDE: -104.875129
FOOTAGE: 605' FNL 2029' FEL
GROUND ELEV: 5888.7'
PDOP: 3.2
INSTRUMENT OPERATOR: JASON LEVANEN

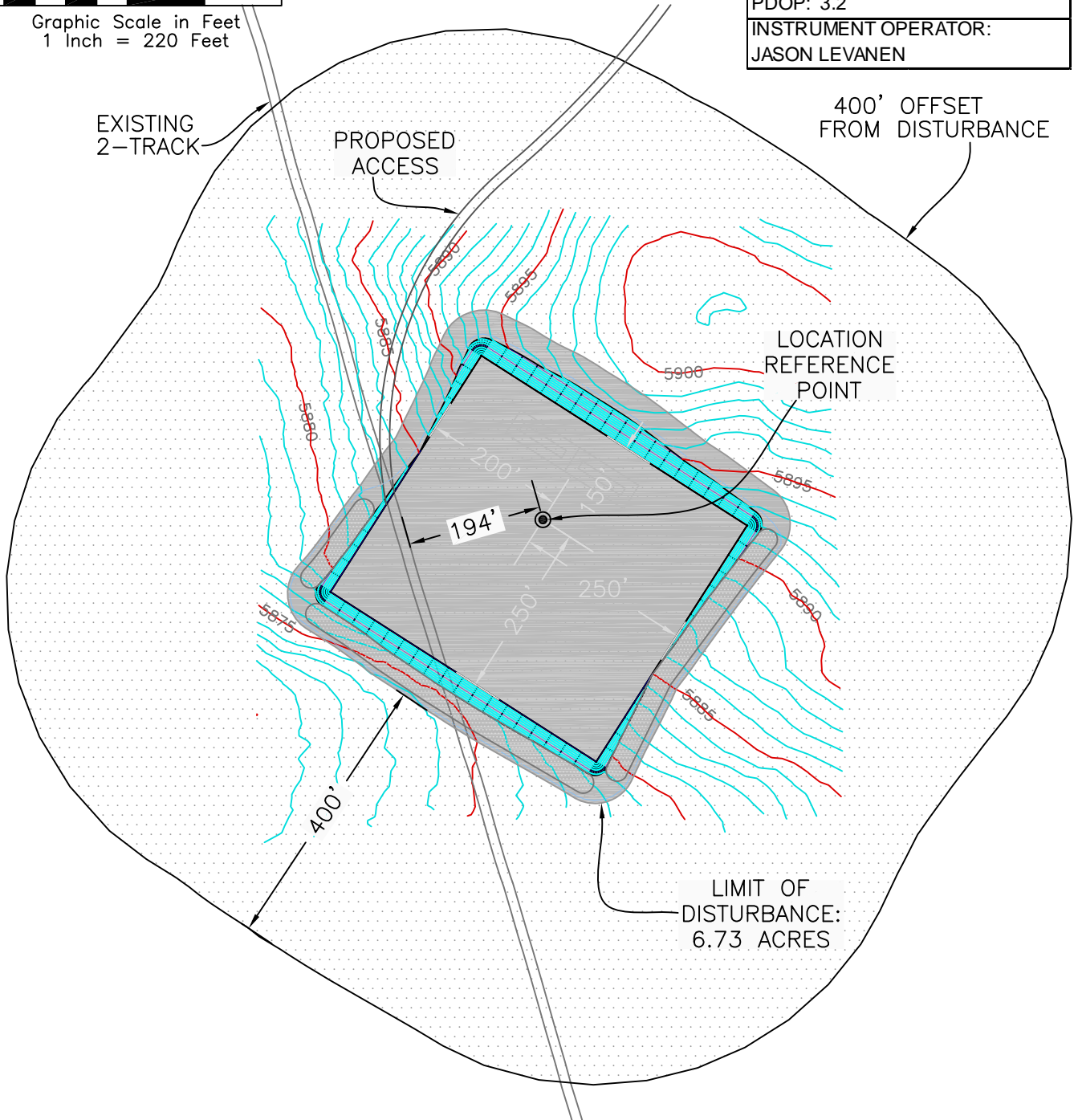

Revised: 6/22/2010

WESTERN LAND SERVICES
Sheridan, WY 82801 (307)673-1817

DP: L:...Slawson\Permitting_Booklets\Pronto... Date: 6/14/2010

SLAWSON EXPLORATION COMPANY, INC
PRONTO 10-11-67

SL: NW1/4 NE1/4, SECTION 10, T11N R67W
BL: SE1/4 SE1/4, SECTION 10, T11N R67W
6TH PM, WELD COUNTY, COLORADO