

# LOCATION DRAWING

**VEGETATION:**  
NATIVE GRASSLAND

**SURFACE USE:**  
RANGELAND

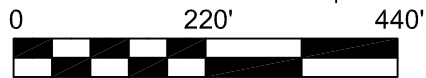

Graphic Scale in Feet  
1 Inch = 220 Feet

## WELLHEAD

LATITUDE: 40.91574°N

LONGITUDE: -104.85094°W

FOOTAGE: 605' FSL 605' FEL

GROUND ELEVATION: 5743'

PDOP: 1.7 DATE: 4/27/10

INSTRUMENT OPERATOR: Jason Levanen

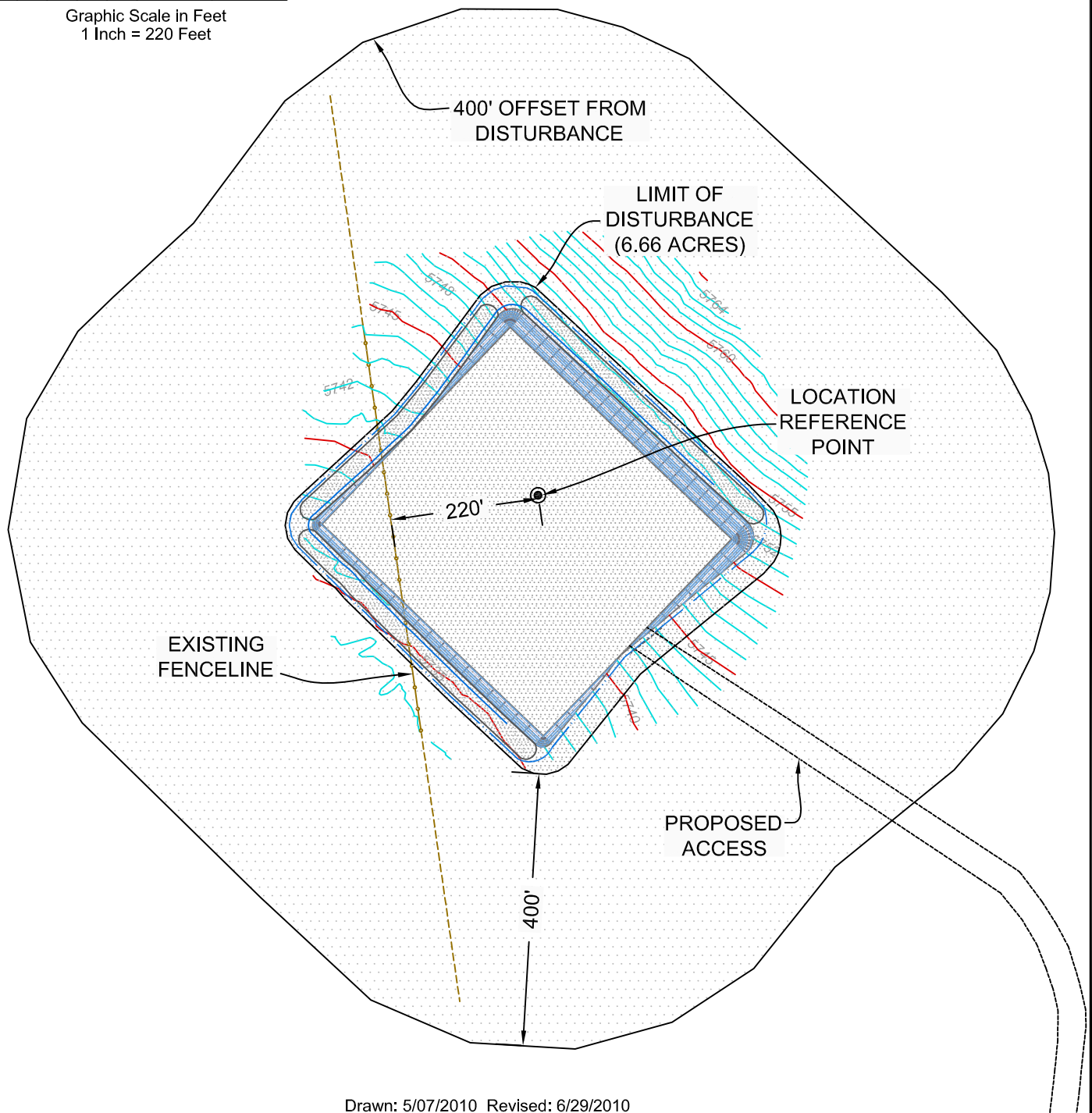

Drawn: 5/07/2010 Revised: 6/29/2010



**WESTERN LAND SERVICES**

Sheridan, WY 82801 (307)673-1817

**SLAWSON EXPLORATION COMPANY, INC**  
RAMROD 14-11-67

SE1/4 SE1/4 SECTION 14, T11N R67W  
6TH PM, WELD COUNTY, COLORADO