

at 585 feet; well F bearing SW at 928 feet; South Platte River bearing NW 482 feet

05-123-13806 KAMMERZELL - UP 167

05-123-12160 EDKAM 5-34

05-123-11124 MONFORT GILCREST 8-14

Distance: 585.33 ft

Distance: 482.26 ft

Distance: 302.08 ft

Distance: 928.33 ft

Distance: 364.44 ft

Distance: 114.10 ft

Distance: 170.39 ft

Distance: 33.72 ft

Distance: 1002.12 ft

Distance: 500.22 ft

SCALE 1 : 5,555

500 0 500 1,000 1,500 FEET

K. P. Kauffman Company, Inc.
Hydrology location map; surface waters and water wells
Lewis-Hodgson 4-17 pad
NWNW section 17-T4N-R66W
Weld Co., Colorado

Tuesday, May 18, 2010 12:49 PM

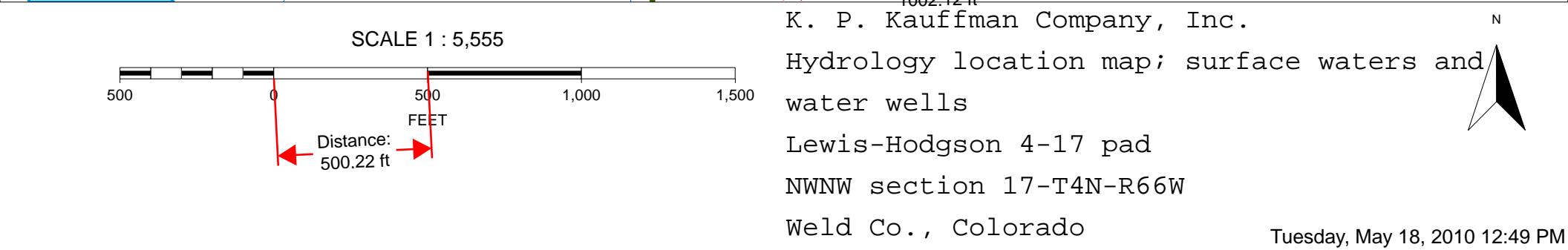

Hydrology location map; surface waters and water wells

NWNW section 17-T4N-R66W

Tuesday, May 18, 2010 12:49 PM