

Well Name: Federal RG 334-14-298
 Surface Location: RG 23-14-298 Pad
 North American Datum 1983 US State Plane 1983 Colorado Central Zone
 Ground Elevation: 6600.0
 +N/-S +E/-W Northing Easting Latitude Longitude Slot
 0.0 0.0 1755772.70 2196391.30 39° 52' 25.102 N 108° 21' 48.557 W A6
 Cyclone 29 (21' RKB) jbb FULLY BUSHING @ 6621.0usft (Cyclone 29 (21' RKB) jbb)

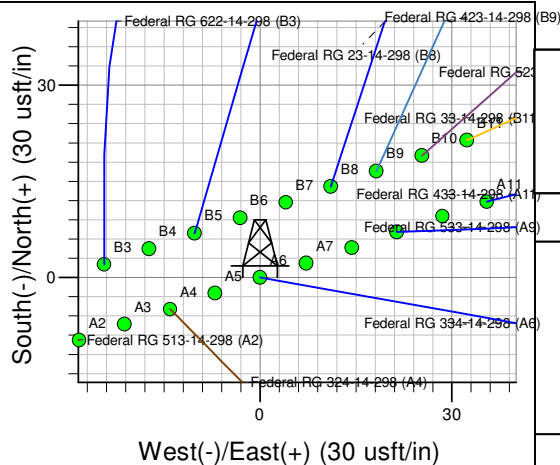
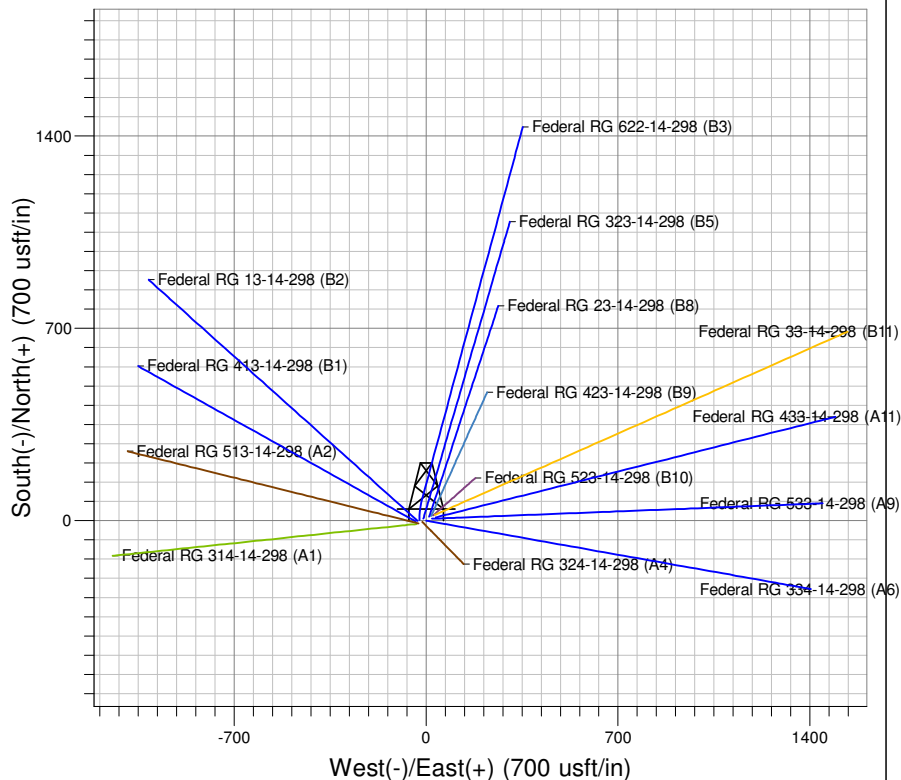

Project: RG 14-02S-098W
 Site: RG 23-14-298 Pad
 Well: Federal RG 334-14-298
 Plan: Plan #2 15Mar10 kjs

Azimuths to True North
 Magnetic North: 10.79°
 Magnetic Field
 Strength: 52621.5snT
 Dip Angle: 66.04°
 Date: 7/16/2009
 Model: IGRF2005-10

SECTION DETAILS

MD	Inc	Azi	TVD	+N/-S	+E/-W	Dleg	TFace	V Sect	Target
0.0	0.00	0.00	0.0	0.0	0.0	0.00	0.000	0.0	
120.0	0.00	0.00	120.0	0.0	0.0	0.00	0.000	0.0	
685.8	14.14	100.05	680.1	-12.1	68.4	2.50	100.051	69.5	
5757.1	14.14	100.05	5597.6	-228.4	1288.7	0.00	0.000	1308.7	
6700.0	0.00	0.00	6531.0	-248.6	1402.7	1.50	180.000	1424.6	Mesaverde (25' Radius) Federal RG 334-14-298
11150.0	0.00	0.00	10981.0	-248.6	1402.7	0.00	0.000	1424.6	

TVD	MD	Inc	Azi	+N/-S	+E/-W	V Sect	Departure	Annotation
120.0	120.0	0.00	0.00	0.0	0.0	0.0	0.0	Start Build 2.50
680.1	685.8	14.14	100.05	-12.1	68.4	69.5	69.5	Hold 14.14 Inc
5597.6	5757.1	14.14	100.05	-228.4	1288.7	1308.7	1308.7	Start Drop -1.50
6531.0	6700.0	0.00	0.00	-248.6	1402.7	1424.6	1424.6	Vertical
10981.0	11150.0	0.00	0.00	-248.6	1402.7	1424.6	1424.6	TD at 11150