

Well Name: Federal RG 324-14-298  
 Surface Location: RG 23-14-298 Pad  
 North American Datum 1983 US State Plane 1983 Colorado Central Zone  
 Ground Elevation: 6600.0  
 +N/-S +E/-W Northing Easting Latitude Longitude Slot  
 0.0 0.0 1755768.20 2196377.10 39° 52' 25.053 N 108° 21' 48.737 W A4  
 Cyclone 29 (21' RKB) KALLY BUSHING @ 6621.0usft (Cyclone 29 (21' RKB) jib)

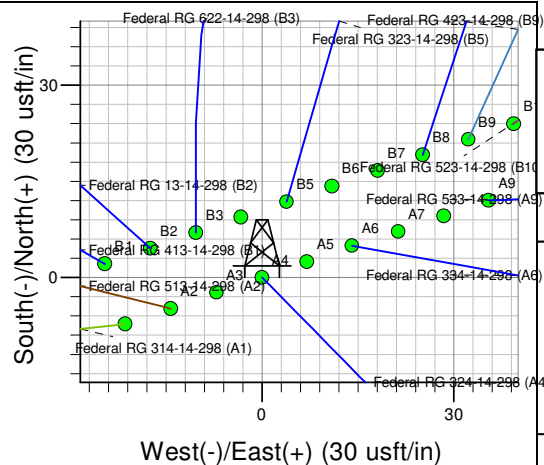
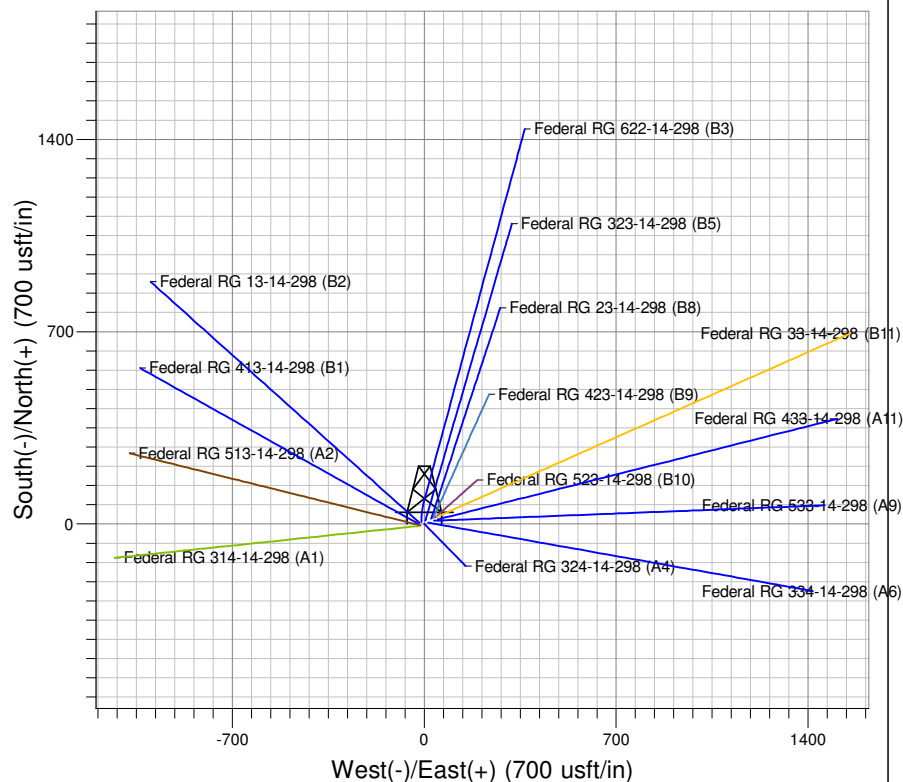

Project: RG 14-02S-098W  
 Site: RG 23-14-298 Pad  
 Well: Federal RG 324-14-298  
 Plan: Plan #2 15Mar10 kjs

Azimuths to True North  
 Magnetic North: 10.79°  
 Magnetic Field  
 Strength: 52621.5nT  
 Dip Angle: 66.04°  
 Date: 7/16/2009  
 Model: IGRF2005-10

#### SECTION DETAILS

MD	Inc	Azi	TVD	+N/-S	+E/-W	Dleg	TFace	V Sect	Target
0.0	0.00	0.00	0.0	0.0	0.0	0.00	0.000	0.0	
120.0	0.00	0.00	120.0	0.0	0.0	0.00	0.000	0.0	
218.6	1.97	135.38	218.6	-1.2	1.2	2.00	135.379	1.7	
6353.2	1.97	135.38	6349.5	-151.5	149.5	0.00	0.000	212.8	
6484.7	0.00	0.00	6481.0	-153.1	151.1	1.50	180.000	215.1	Mesaverde (25' Radius) Federal RG 324-14-298
10904.7	0.00	0.00	10901.0	-153.1	151.1	0.00	0.000	215.1	

TVD	MD	Inc	Azi	+N/-S	+E/-W	V Sect	Departure	Annotation
120.0	120.0	0.00	0.00	0.0	0.0	0.0	0.0	Start Build 2.00
218.6	218.6	1.97	135.38	-1.2	1.2	1.7	1.7	Hold 1.97 Inc
6349.5	6353.2	1.97	135.38	-151.5	149.5	212.8	212.8	Start Drop -1.50
6481.0	6484.7	0.00	0.00	-153.1	151.1	215.1	215.1	Vertical
10901.0	10904.7	0.00	0.00	-153.1	151.1	215.1	215.1	TD at 10905