

ACCESS ROAD MAP LITTLE OLLIE 36-11-67

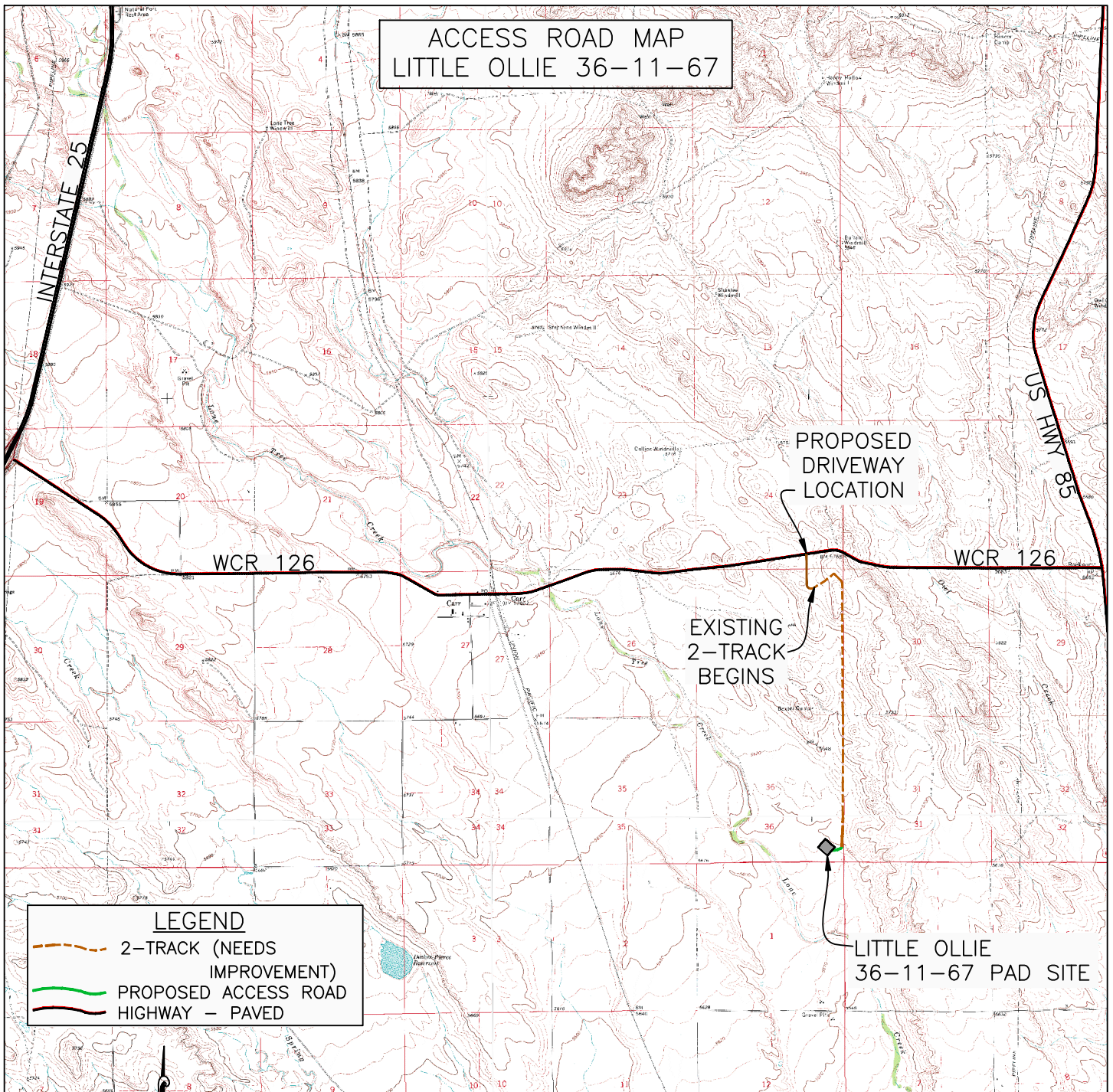

LEGEND

- 2-TRACK (NEEDS IMPROVEMENT)
- PROPOSED ACCESS ROAD
- HIGHWAY - PAVED

DRIVING DIRECTIONS:

From I-25 at Exit 293, turn East on WCR 126, travel East ± 5.7 mi
OR: From Highway 85, approx. 13.8 miles North of Nunn, CO, turn West on WCR 126, travel West ± 2.0 mi

Turn South onto approach, travel South on proposed road $\pm 1,260'$ to intersection with existing 2-track road.
Turn left, travel N-NE on existing 2-track road $\pm 1,460'$, following a curve to the South.
Travel South on existing 2-track ± 1.8 miles (9,525').
Turn Right onto Proposed Access, travel $\pm 414'$ onto Little Ollie 36-11-67 pad.



Graphic Scale in Feet
1 Inch = 1 Mile



WESTERN LAND SERVICES

Sheridan, WY 82801 (307)673-1817

DP: L...SlawsonPermitting Book...Little O... Date: 5/19/2010

SLAWSON EXPLORATION COMPANY, INC
LITTLE OLLIE 36-11-67

SL: SE1/4 SE1/4 SECTION 36, T11N R 67W
BL: NW1/4 NE1/4 SECTION 36, T11N R67W
6TH PM, WELD COUNTY, COLORADO