

VISIBLE IMPROVEMENTS SKETCH DINNEL C27-29D

SECTION 22, TOWNSHIP 4 NORTH, RANGE 64 WEST OF THE 6TH PRINCIPAL MERIDIAN

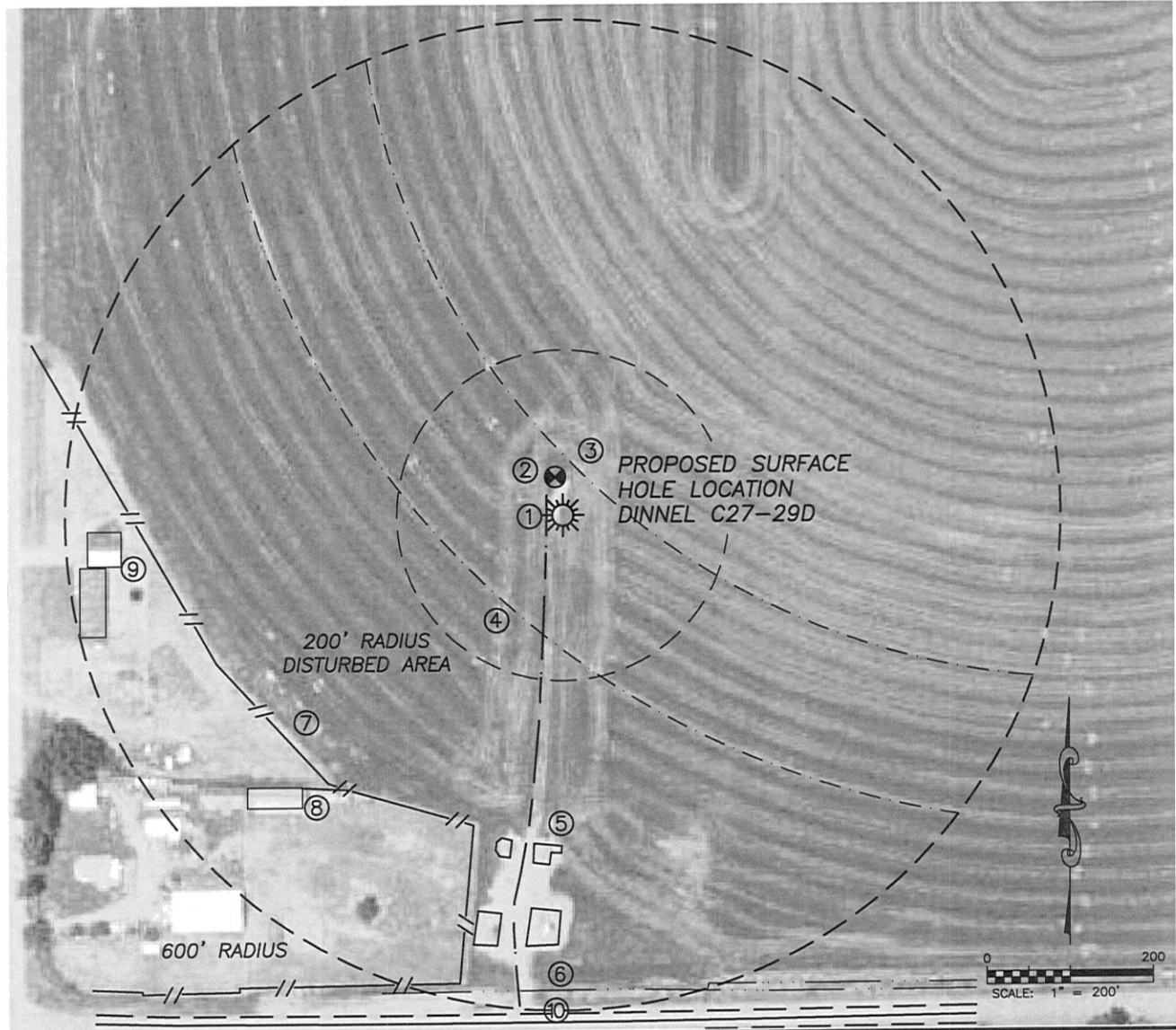

①
CENTERLINE
FIELD ROAD
20'± W

②
WELL:
HERBST 1
47'± N

③
PIVOT TRACK
52'± NE

④
PIVOT TRACK
125'± SW

⑤
PROD. FACILITY
415'± S

⑥
IRRIG. DITCH
575'± S

⑦
METAL FENCE
427'± SW

⑧
BLOCK
BUILDING
455'± SW

⑨
GARAGE
535'± SW

⑩
NORTH EDGE
WCR 42
603'± S

NEAREST OVERHEAD POWER 630'± S