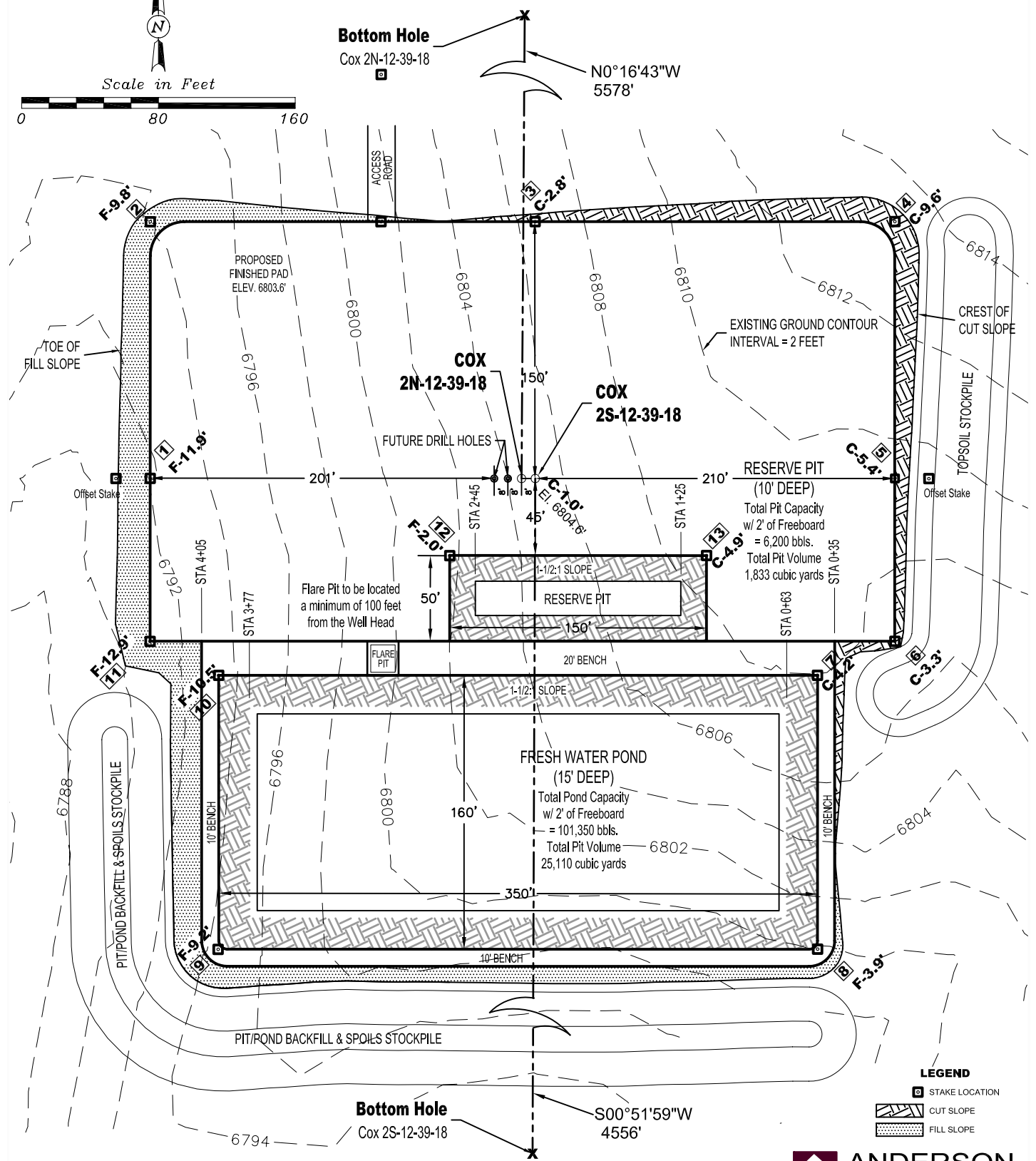
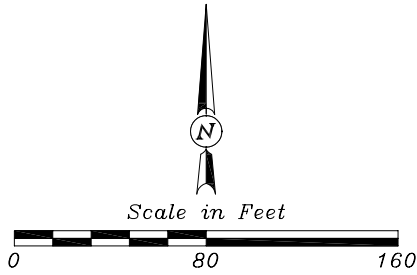

Figure 1

BILL BARRETT CORPORATION
 CONSTRUCTION LAYOUT DRAWINGS
 FOR
COX 2-12-39-18 PAD
 SECTION 12, T39N, R18W, N.M.P.M.



REVISED: 5/20/10



BILL BARRETT CORPORATION

CONSTRUCTION LAYOUT DRAWINGS

FOR

COX 2-12-39-18 PAD

SECTION 12, T39N, R18W, N.M.P.M.

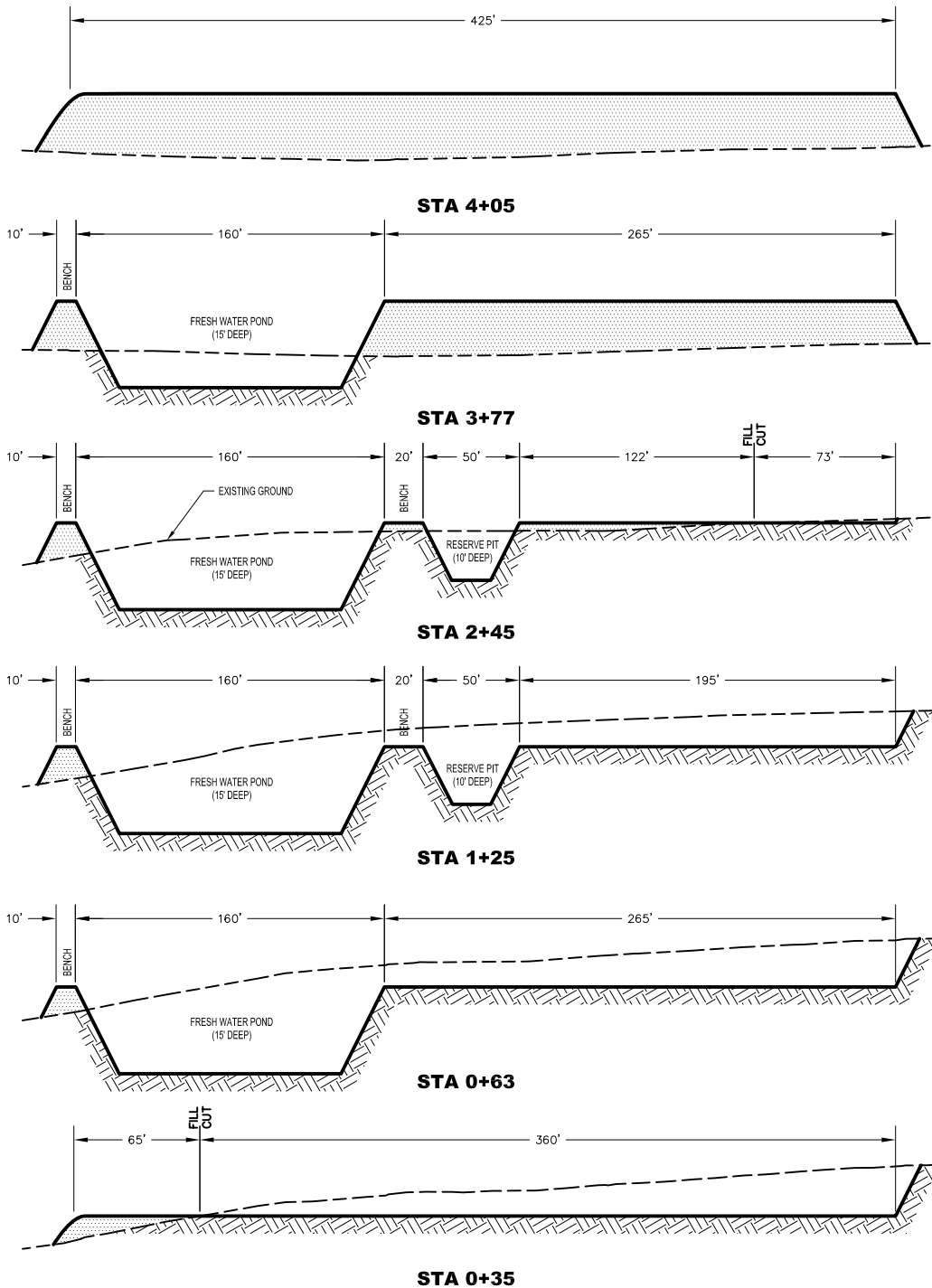

EARTHWORK QUANTITIES

TOPSOIL: 4533 cu. yds. (6" x 5.62 acres)

CUT VOLUME: 31454 cu. yds (excl. topsoil)

FILL VOLUME: 18922 cu. yds (Assumes 15% Shrink **16454 cu. yds. Neat Line)

EXCESS MATERIAL: 12532 cu. yds. (15000 cu. yds Neat Line)

DISTURBANCE AREAS

WELL PAD & PIT AREA: 4.49 AC. (5.99 AC. INCL. STOCKPILES)

ACCESS ROAD: 0.06 AC. (90' X 30')