

# HYDROLOGY MAP

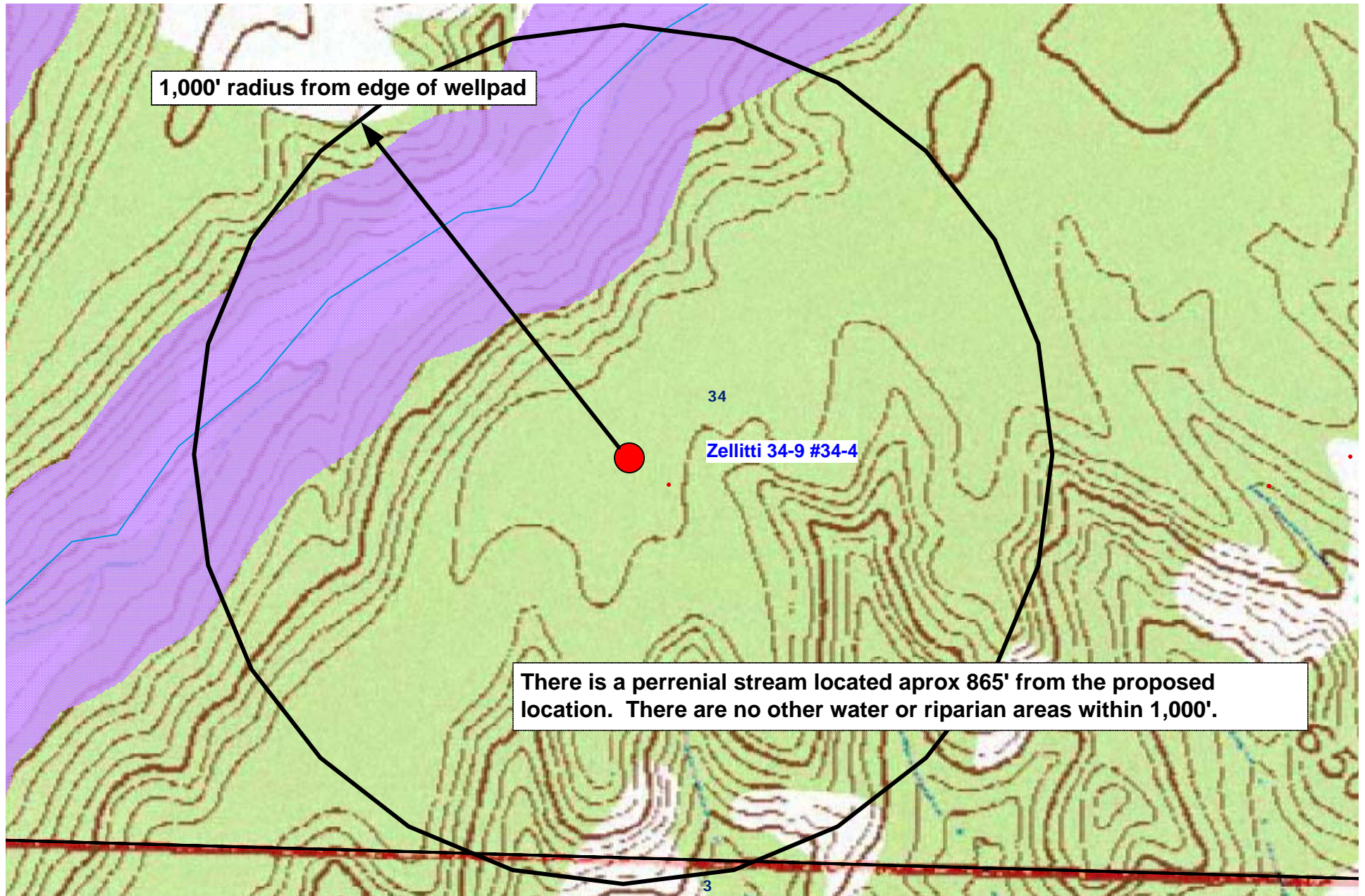

- Water Wells
- Lakes
- Major Rivers
- Streams
- 300-Foot Stream Buffer

ZELLITTI 34-9 #34-4  
1,166' FSL & 1,990' FWL  
Sec. 34, T34N, R9W, N.M.P.M  
La Plata County, Colorado

N  
↑  
Scale 1" = 400'