

Steil Surveying Services, LLC

1102 West 19th Street P.O. BOX 2073

Cheyenne, Wyoming 82009

VISIBLE IMPROVEMENTS

THIS MAP DOES NOT REPRESENT A BOUNDARY SURVEY

SECTION 1
TOWNSHIP 3 NORTH
RANGE 64 WEST

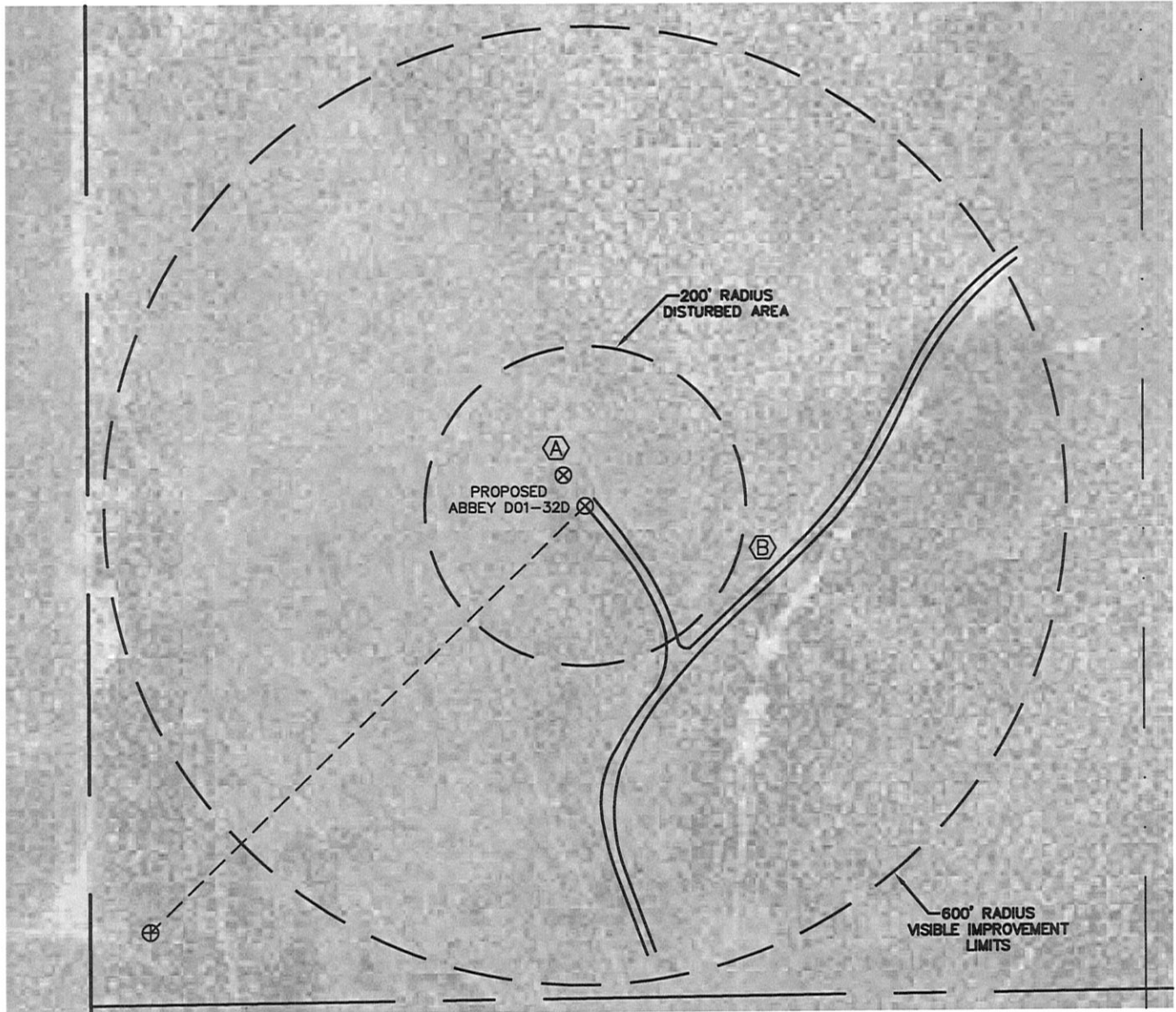

IMPROVEMENTS:

- (A) EXISTING WELL ABBEY D1-5 - 47' NORTHWEST
- (B) DIRT ROAD - 220'+/- SOUTHEAST

THE NEAREST OVERHEAD POWER LINE IS 1250' SOUTH

NOTICE: According to Colorado law you MUST commence any legal action based upon any defect in this W.L.C. within three years after you first discover such defect. In no event may any action based upon any defect in this W.L.C. be commenced more than ten years from this said date of the certification shown hereon.

