

VISIBLE IMPROVEMENTS

THIS MAP DOES NOT REPRESENT A BOUNDARY SURVEY

SECTION 6
TOWNSHIP 11 NORTH
RANGE 61 WEST

COUNTY ROAD 134

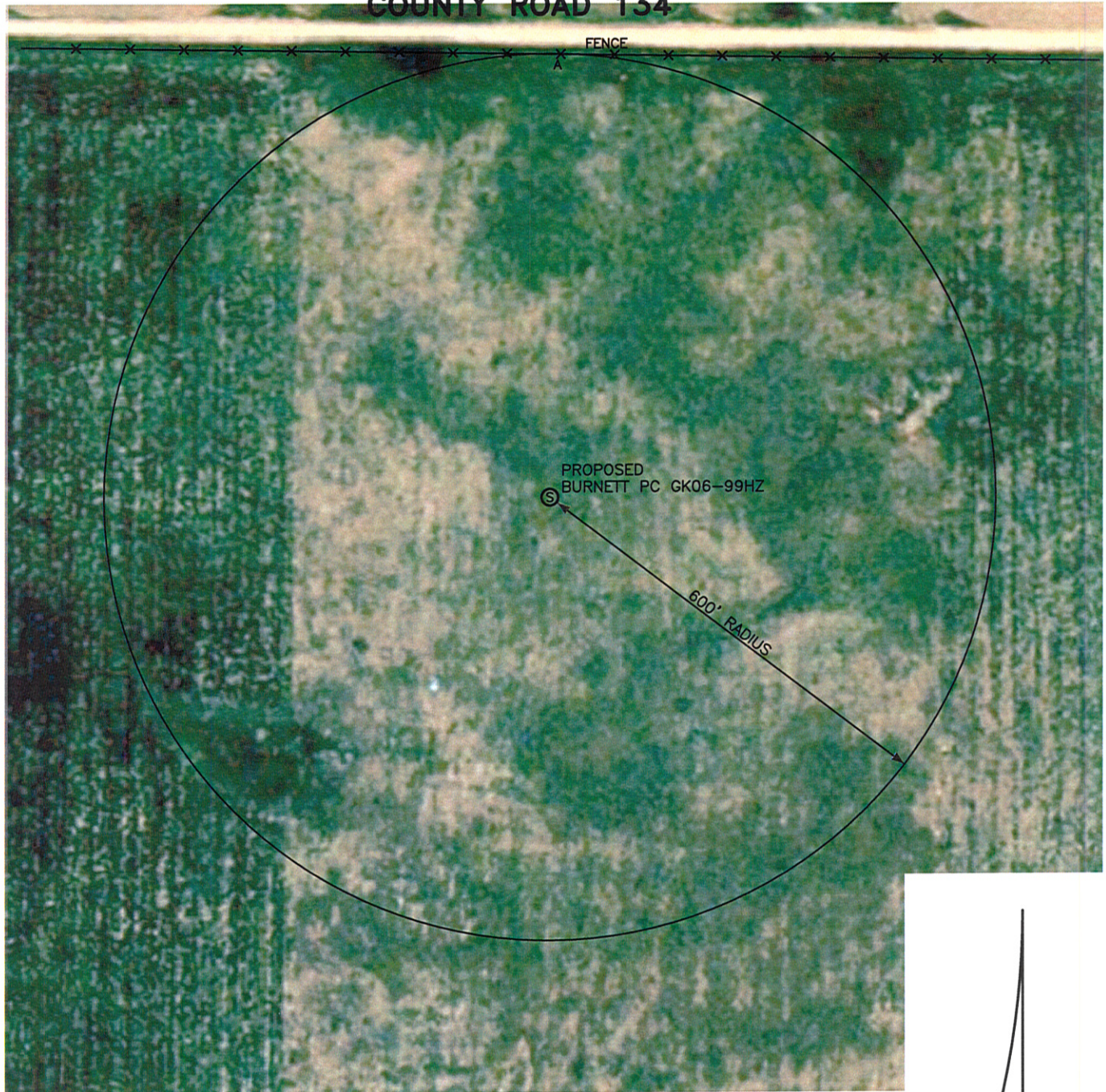

IMPROVEMENTS:

A FENCE N0°47'10"E 599'

THE NEAREST OVERHEAD POWER LINE IS 661' NORTH.

NOTICE: According to Colorado law you MUST commence any legal action based upon any defect in the W.L.C. within three years after you first discover such defect. In no event may only action based upon any defect in this W.L.C. be commenced more than ten years from this sold date of the certification shown hereon.



SCALE: 1"=200'
0 100 200

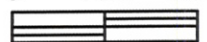

SCALE IN FEET