

Water Wells within 1000' radius of location; A. Well bearing 1072.30' WNW;

B. Well bearing 944.73' WNW; C. Well bearing 448.31' NE;

Surface Water within 1000' radius of location; D. Wetlands bearing 616.91' ESE

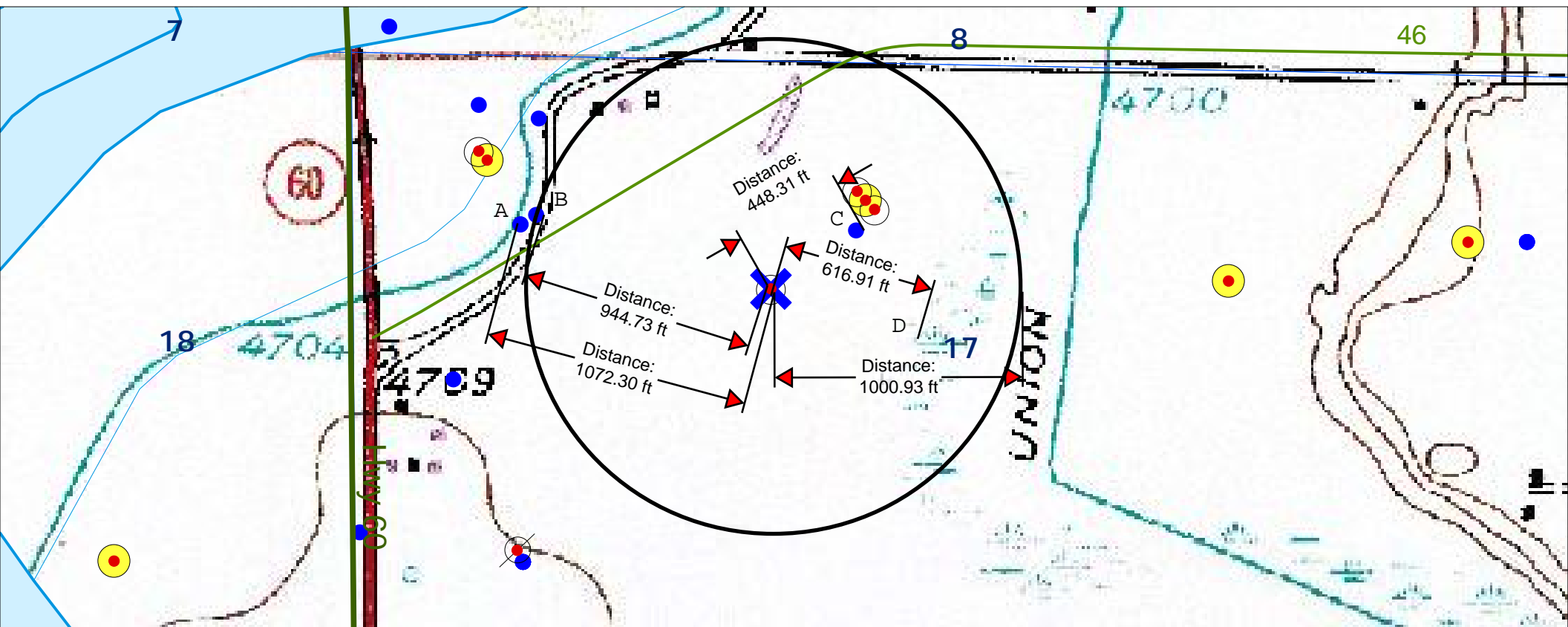

SCALE 1 : 6,845

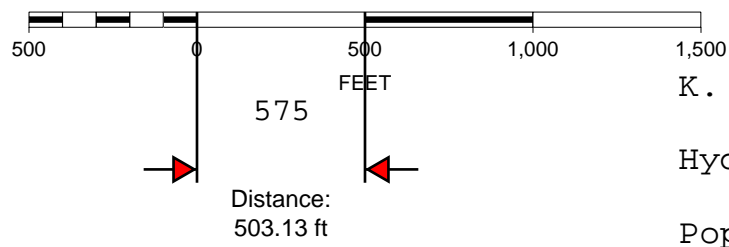

K. P. Kauffman Company, Inc.

Hydrology map; indicating surface waters and water wells

Pope #18-17

NENW section 17-T4N-R66W

Weld Co., Colorado