

# WELL PAD MV 29-27 ESTIMATED EARTHWORK QUANTITIES

ITEM	CUT	FILL	TOPSOIL	EXCESS
PAD	38,002	9,718	1,800	28,284
ROAD		2591		
PIT	5,458			5,458
TOTALS	43,460	12,309	1,800	33,742

CUT SLOPES: 1.5:1\*  
FILL SLOPES: 2:1

\*-MAY BE INCREASED TO 1:1 IF IN-SITU MATERIAL IS STABLE AT THESE SLOPES.

CUTTINGS TRENCH:  
1:1 SIDE SLOPES; DEPTH: 16"  
VOLUME: 5,458 CY (26,247 bbl)

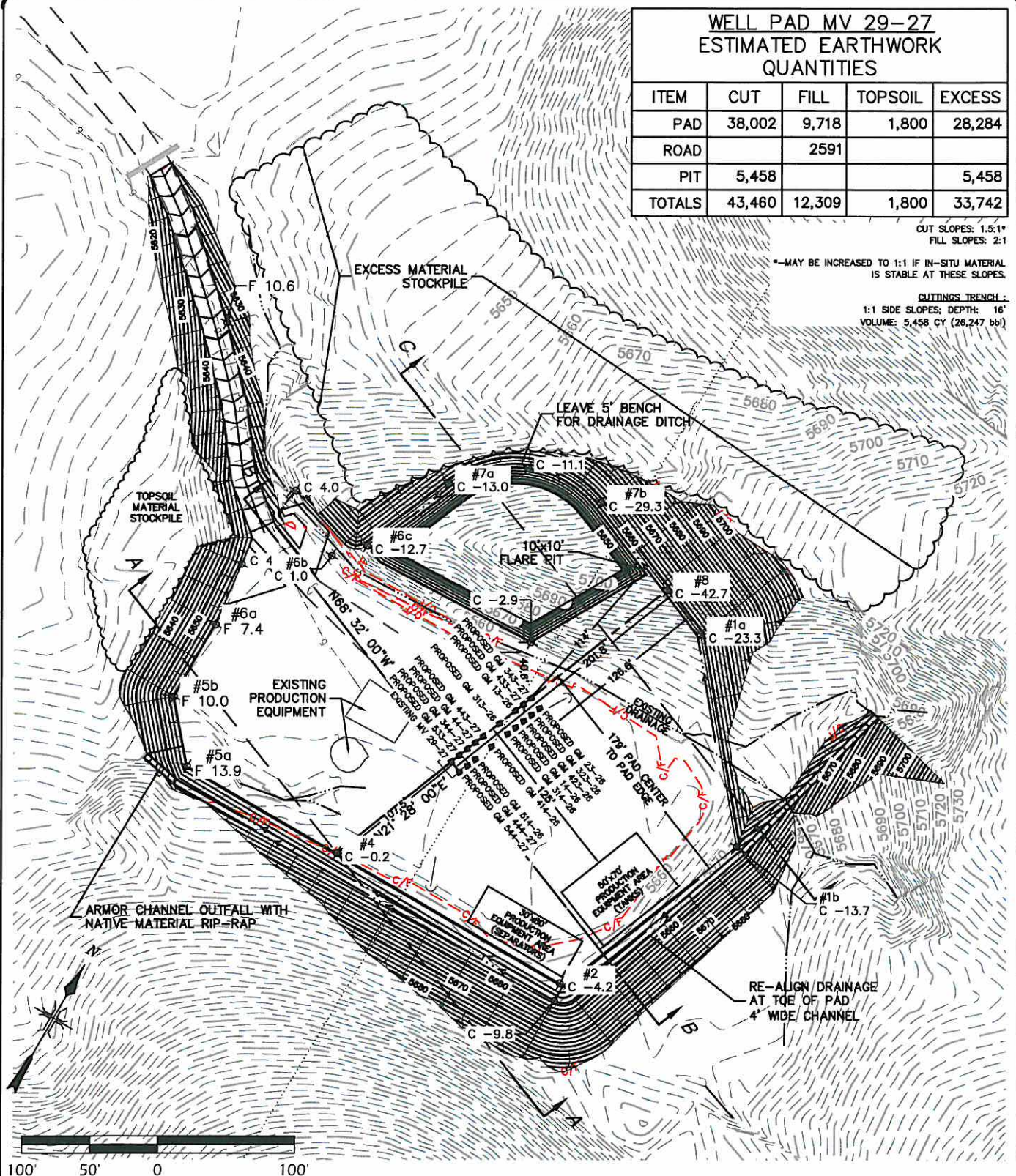

DEL-MONT CONSULTANTS IS PROVIDING GRADING DESIGN FOR THIS PROJECT THAT PROVIDES DIMENSIONS AND VOLUME INFORMATION FOR CONSTRUCTION.



**DEL-MONT CONSULTANTS, INC.**  
ENGINEERING • SURVEYING • PLANNING  
1100 Colorado Ave., Suite 100, Fort Collins, CO 80501  
Phone: 970.225.1100 • Fax: 970.225.1101 • Email: info@delmont.com

DESIGNED BY: MGW  
SCALE: 1"=100'  
CHECKED BY: KS  
FILE NAME: 10030C-MV29-27\_PAD-SITE



S26 & S27, T6S, R96W, 6TH P.M.  
CONSTRUCTION LAYOUT  
WELL PAD MV 29-27

GARFIELD COUNTY, CO  
WILLIAMS PRODUCTION, RMT

DMC JOB NO: 10030  
DATE ISSUED: 2010-04-26  
DATE SURVEYED: 2008-11-17  
PLAT: 2 of 9



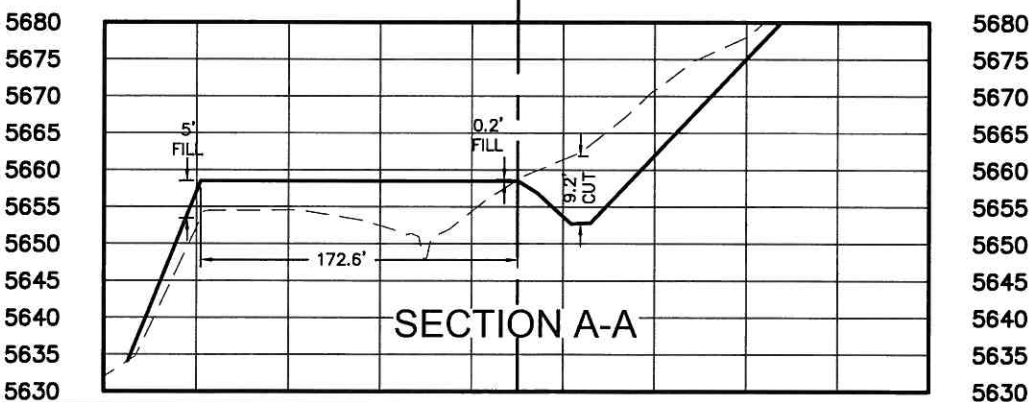
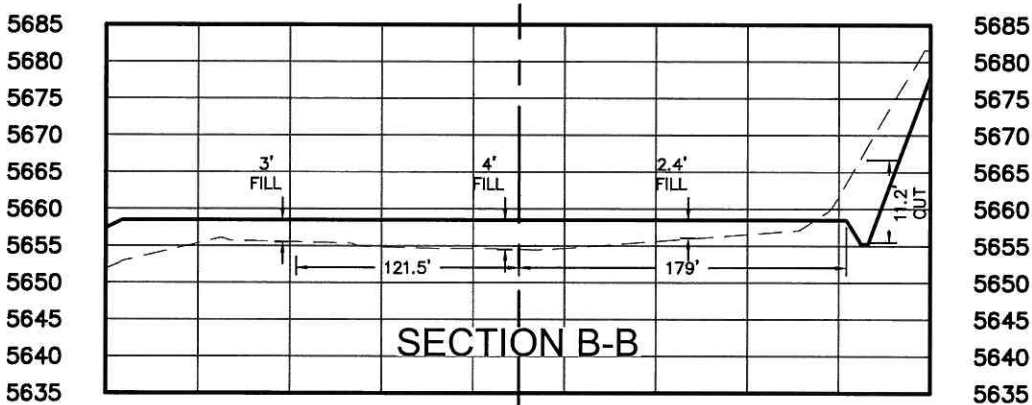
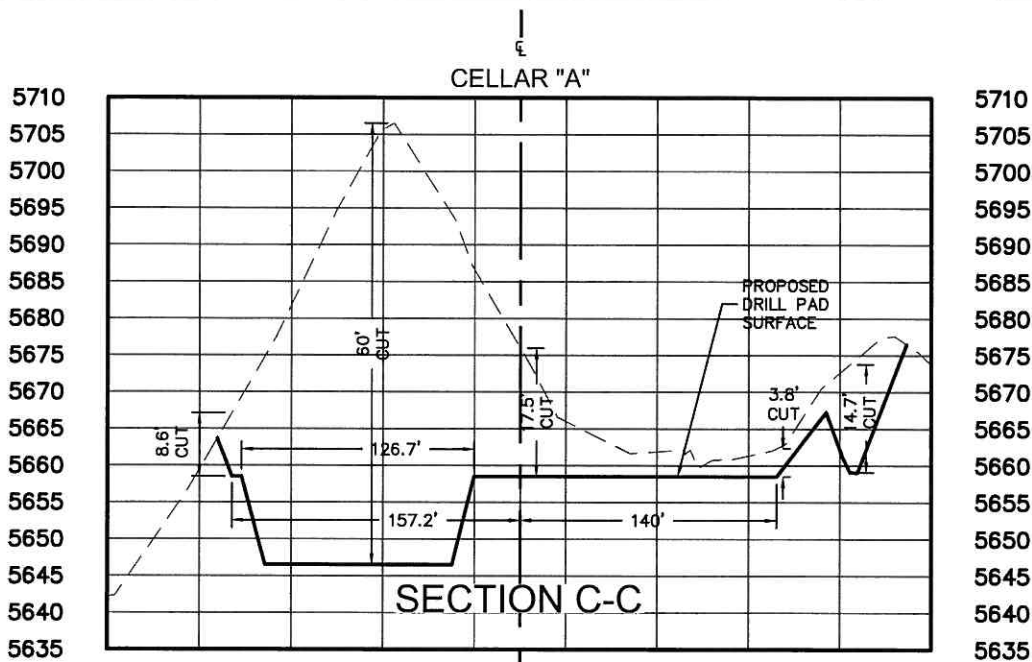

DEL-MONT CONSULTANTS IS PROVIDING GRADING DESIGN FOR THIS PROJECT THAT PROVIDES DIMENSIONS AND VOLUME INFORMATION FOR CONSTRUCTION.



**DEL-MONT CONSULTANTS, INC.**  
ENGINEERING • SURVEYING • PLANNING  
140 Columbia Ave. • Bloomington, NE 68110 • (402) 334-4400 • (402) 334-4401  
www.del-mont.com • www.del-mont.com

S26 & S27, T6S, R96W, 6TH P.M.  
CONSTRUCTION LAYOUT CROSS SECTIONS  
WELL PAD MV 29-27



GARFIELD COUNTY, CO  
WILLIAMS PRODUCTION, RMT

DESIGNED BY

MGW

SCALE

H: 1"=100' V: 1"=25'

CHECKED BY

KS

FILE NAME

10030C-MV29-27\_PAD-SITE

DMC JOB NO.

10030

DATE ISSUED

2010-04-19

DATE SURVEYED

2008-11-17

PLAT

3 of 9