

TIMM PC GK04-12
Township 11 North, Range 61 West
Section 4: NW/4SW/4
Weld County, Colorado

Stake location facing north
Picture Dated: 04/16/2010



Stake location facing south
Picture Dated: 04/16/2010



TIMM PC GK04-12
Township 11 North, Range 61 West
Section 4: NW/4SW/4
Weld County, Colorado

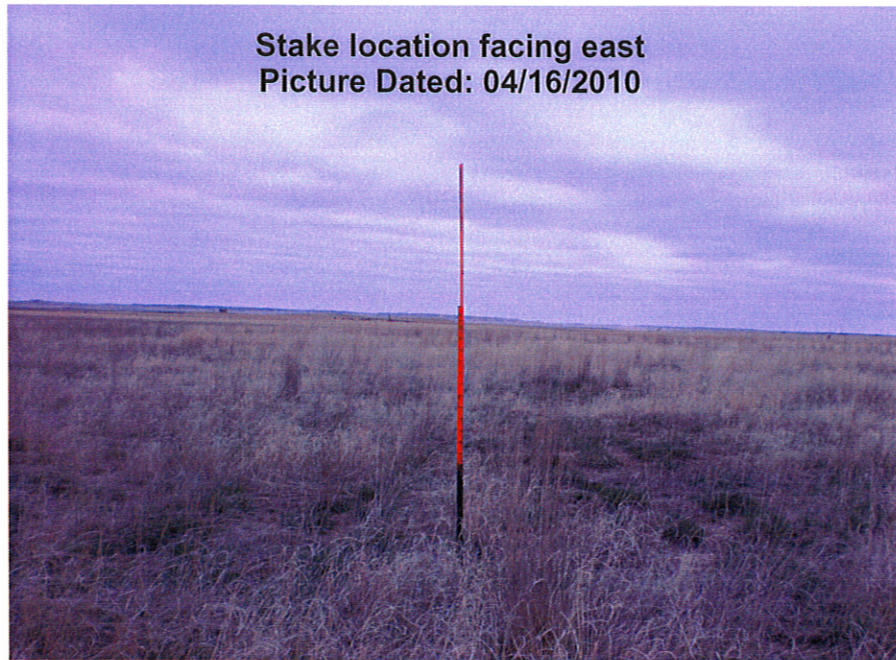

TIMM PC GK04-12
Township 11 North, Range 61 West
Section 4: NW/4SW/4
Weld County, Colorado

Access road facing west
Picture Dated: 04/16/2010

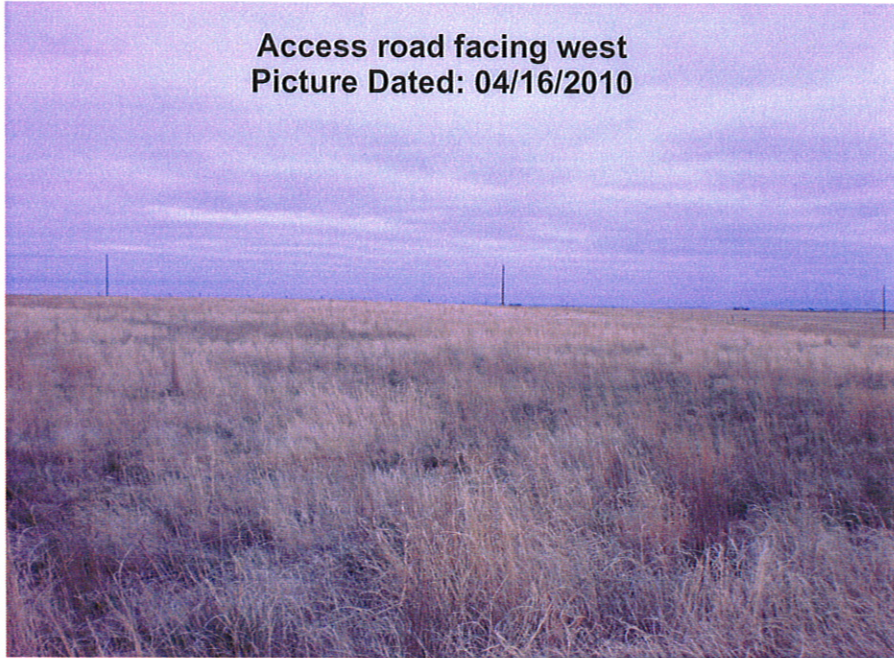

Reference area facing south
Picture Dated: 04/16/2010

