

VISIBLE IMPROVEMENTS

THIS MAP DOES NOT REPRESENT A BOUNDARY SURVEY

SECTION 36
TOWNSHIP 12 NORTH
RANGE 62 WEST

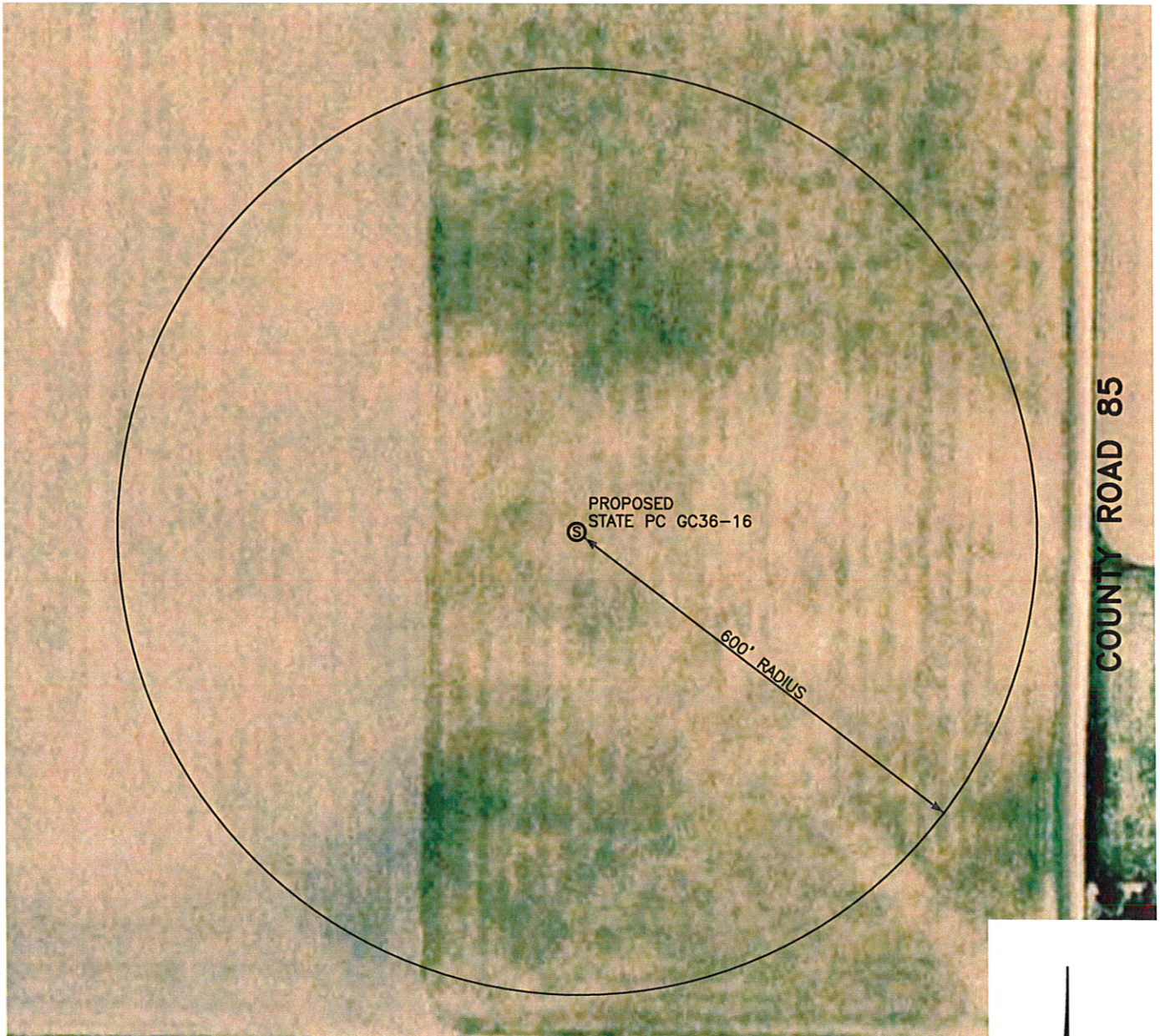

THE NEAREST OVERHEAD POWER LINE IS 1014' SOUTHEAST.

NOTICE: According to Colorado law you MUST commence any legal action based upon any defect in the W.L.C. within three years after you first discover such defect. In no event may only action based upon any defect in this W.L.C. be commenced more than ten years from this sold date of the certification shown hereon.



SCALE: 1"=200'
0 100 200
SCALE IN FEET