

**EOG RESOURCES, INC.**  
**CRITTER CREEK #18-22H**  
LOCATED IN WELD COUNTY, COLORADO  
SECTION 22, T11N, R63W, 6th P.M.



PHOTO: VIEW FROM CORNER #7 TO LOCATION STAKE

CAMERA ANGLE: NORTHERLY



PHOTO: VIEW FROM CORNER #1 TO LOCATION STAKE

CAMERA ANGLE: EASTERLY



Uintah Engineering & Land Surveying  
85 South 200 East Vernal, Utah 84078  
435-789-1017 FAX (435) 789-1813

LOCATION PHOTOS

02 22 10  
MONTH DAY YEAR

PHOTO  
P2

TAKEN BY: A.F.

DRAWN BY: Z.L.

REVISED: 03-15-10

**EOG RESOURCES, INC.**  
**CRITTER CREEK #18-22H**  
LOCATED IN WELD COUNTY, COLORADO  
SECTION 22, T11N, R63W, 6th P.M.



PHOTO: VIEW FROM CORNER #3 TO LOCATION STAKE

CAMERA ANGLE: SOUTHERLY

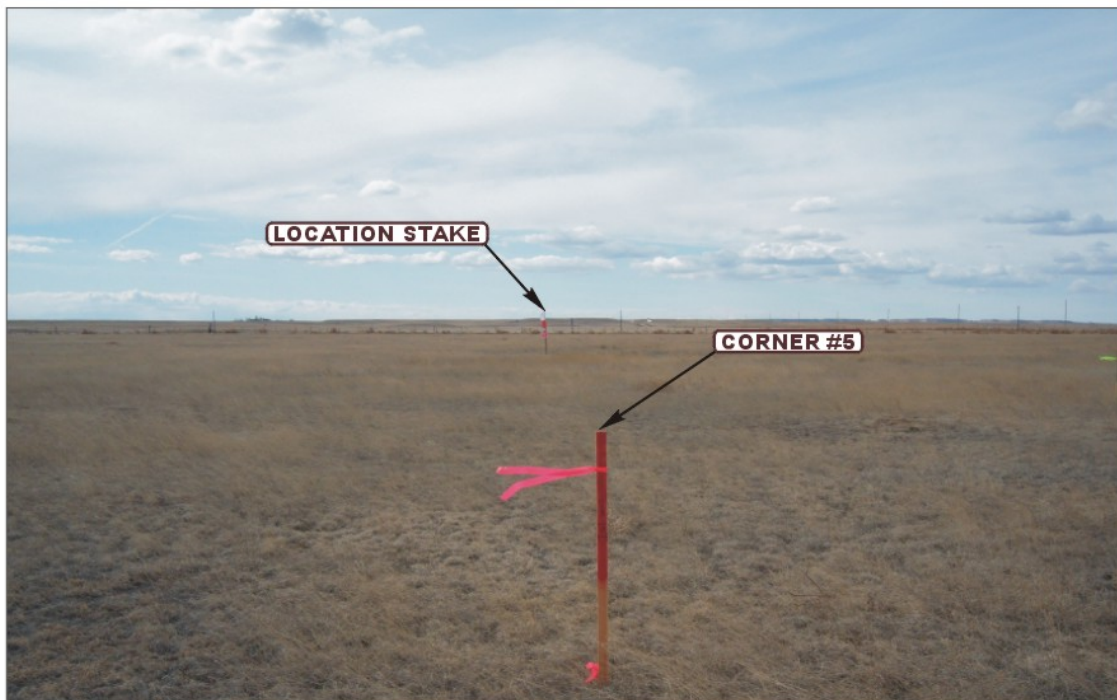

PHOTO: VIEW FROM CORNER #5 TO LOCATION STAKE

CAMERA ANGLE: WESTERLY



**UELS**

Uintah Engineering & Land Surveying  
85 South 200 East Vernal, Utah 84078  
435-789-1017 FAX (435) 789-1813

- Since 1964 -

**LOCATION PHOTOS**

**02 22 10**  
MONTH DAY YEAR

**PHOTO  
P3**

TAKEN BY: A.F.

DRAWN BY: Z.L.

REVISED: 03-15-10