

Steil Surveying Services, LLC

1102 West 19th Street P.O. BOX 2073

Cheyenne, Wyoming 82009

# VISIBLE IMPROVEMENTS

THIS MAP DOES NOT REPRESENT A BOUNDARY SURVEY

SECTION 1  
TOWNSHIP 3 NORTH  
RANGE 64 WEST

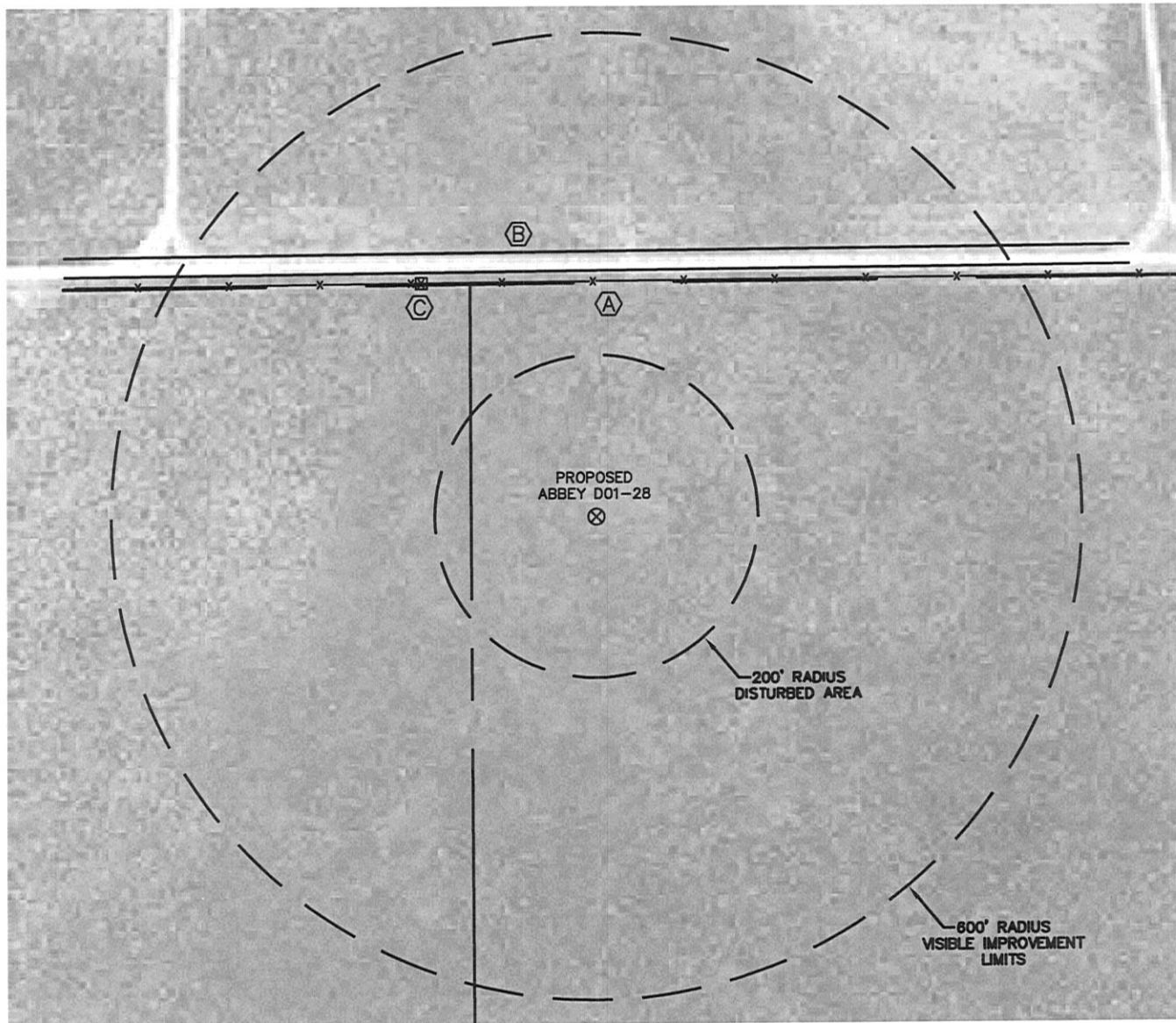

## IMPROVEMENTS:

- (A) BARBED WIRE FENCE - 292' NORTH
- (B) GRAVEL ROAD - 305' NORTH
- (C) BURIED GAS LINE MARKER - 362' NORTHWEST

THE NEAREST OVERHEAD POWER LINE IS 3603'+/- SOUTHWEST

NOTICE: According to Colorado law you MUST commence any legal action based upon any defect in this W.L.C. within three years after you first discover such defect. In no event may any action based upon any defect in this W.L.C. be commenced more than ten years from this said date of the certification shown hereon.

