

Laramie Energy II, LLC

Garfield County, CO

Johnson 32-03 PAD

Johnson 32-03B (Sec. 32-T7S-R93W) - A2

Plan #1

Plan: Plan #1 Proposal

Sperry Drilling Services

Proposal Report

26 February, 2010

Well Coordinates: 1,582,260.85 N, 2,350,532.46 E (39° 24' 34.23" N, 107° 47' 55.90" W)

Ground Level: 7,850.00 ft

Local Coordinate Origin: Centered on Well Johnson 32-03B (Sec. 32-T7S-R93

Viewing Datum: KB @ 7871.00ft (Original Well Elev)

TVDs to System: N

North Reference: True

Unit System: API - US Survey Feet - Custom

Geodetic Scale Factor Applied

Version: 2003.16 Build: 43I

HALLIBURTON



Plan Report for Johnson 32-03B (Sec. 32-T7S-R93W) - Plan #1 Proposal

Measured Depth (ft)	Inclination (°)	Azimuth (°)	Vertical Depth (ft)	+N/-S (ft)	+E/-W (ft)	Vertical Section (ft)	Dogleg Rate (°/100ft)	Build Rate (°/100ft)	Turn Rate (°/100ft)	Toolface Azimuth (°)
0.00	0.00	0.00	0.00	0.00	0.00	0.00	0.00	0.00	0.00	0.00
100.00	0.00	0.00	100.00	0.00	0.00	0.00	0.00	0.00	0.00	0.00
200.00	0.00	0.00	200.00	0.00	0.00	0.00	0.00	0.00	0.00	0.00
300.00	0.00	0.00	300.00	0.00	0.00	0.00	0.00	0.00	0.00	0.00
400.00	0.00	0.00	400.00	0.00	0.00	0.00	0.00	0.00	0.00	0.00
KOP - Begin 1.5°/100' Build at 400.00ft										
500.00	1.50	195.63	499.99	-1.26	-0.35	1.31	1.50	1.50	0.00	195.63
600.00	3.00	195.63	599.91	-5.04	-1.41	5.23	1.50	1.50	0.00	0.00
686.73	4.30	195.63	686.46	-10.36	-2.90	10.76	1.50	1.50	0.00	0.00
End of Build at 686.73ft										
700.00	4.30	195.63	699.69	-11.32	-3.17	11.75	0.00	0.00	0.00	0.00
800.00	4.30	195.63	799.41	-18.54	-5.19	19.25	0.00	0.00	0.00	0.00
900.00	4.30	195.63	899.13	-25.76	-7.21	26.75	0.00	0.00	0.00	0.00
1,000.00	4.30	195.63	998.85	-32.98	-9.23	34.25	0.00	0.00	0.00	0.00
1,100.00	4.30	195.63	1,098.57	-40.21	-11.25	41.75	0.00	0.00	0.00	0.00
1,200.00	4.30	195.63	1,198.29	-47.43	-13.27	49.25	0.00	0.00	0.00	0.00
1,300.00	4.30	195.63	1,298.00	-54.65	-15.29	56.75	0.00	0.00	0.00	0.00
1,400.00	4.30	195.63	1,397.72	-61.87	-17.31	64.25	0.00	0.00	0.00	0.00
1,500.00	4.30	195.63	1,497.44	-69.09	-19.33	71.75	0.00	0.00	0.00	0.00
1,600.00	4.30	195.63	1,597.16	-76.32	-21.35	79.25	0.00	0.00	0.00	0.00
1,700.00	4.30	195.63	1,696.88	-83.54	-23.38	86.75	0.00	0.00	0.00	0.00
1,800.00	4.30	195.63	1,796.60	-90.76	-25.40	94.25	0.00	0.00	0.00	0.00
1,900.00	4.30	195.63	1,896.31	-97.98	-27.42	101.75	0.00	0.00	0.00	0.00
2,000.00	4.30	195.63	1,996.03	-105.20	-29.44	109.24	0.00	0.00	0.00	0.00
2,100.00	4.30	195.63	2,095.75	-112.43	-31.46	116.74	0.00	0.00	0.00	0.00
2,200.00	4.30	195.63	2,195.47	-119.65	-33.48	124.24	0.00	0.00	0.00	0.00
2,300.00	4.30	195.63	2,295.19	-126.87	-35.50	131.74	0.00	0.00	0.00	0.00
2,400.00	4.30	195.63	2,394.91	-134.09	-37.52	139.24	0.00	0.00	0.00	0.00
2,500.00	4.30	195.63	2,494.62	-141.31	-39.54	146.74	0.00	0.00	0.00	0.00
2,600.00	4.30	195.63	2,594.34	-148.54	-41.56	154.24	0.00	0.00	0.00	0.00
2,700.00	4.30	195.63	2,694.06	-155.76	-43.58	161.74	0.00	0.00	0.00	0.00
2,800.00	4.30	195.63	2,793.78	-162.98	-45.61	169.24	0.00	0.00	0.00	0.00
2,900.00	4.30	195.63	2,893.50	-170.20	-47.63	176.74	0.00	0.00	0.00	0.00
3,000.00	4.30	195.63	2,993.22	-177.42	-49.65	184.24	0.00	0.00	0.00	0.00
3,100.00	4.30	195.63	3,092.93	-184.65	-51.67	191.74	0.00	0.00	0.00	0.00
3,200.00	4.30	195.63	3,192.65	-191.87	-53.69	199.24	0.00	0.00	0.00	0.00
3,300.00	4.30	195.63	3,292.37	-199.09	-55.71	206.74	0.00	0.00	0.00	0.00
3,400.00	4.30	195.63	3,392.09	-206.31	-57.73	214.24	0.00	0.00	0.00	0.00
3,500.00	4.30	195.63	3,491.81	-213.53	-59.75	221.74	0.00	0.00	0.00	0.00
3,600.00	4.30	195.63	3,591.53	-220.76	-61.77	229.24	0.00	0.00	0.00	0.00
3,700.00	4.30	195.63	3,691.25	-227.98	-63.79	236.74	0.00	0.00	0.00	0.00
3,800.00	4.30	195.63	3,790.96	-235.20	-65.81	244.23	0.00	0.00	0.00	0.00
3,900.00	4.30	195.63	3,890.68	-242.42	-67.83	251.73	0.00	0.00	0.00	0.00
4,000.00	4.30	195.63	3,990.40	-249.64	-69.86	259.23	0.00	0.00	0.00	0.00
Hold Angle at 4.30°										
4,100.00	4.30	195.63	4,090.12	-256.87	-71.88	266.73	0.00	0.00	0.00	0.00
4,200.00	4.30	195.63	4,189.84	-264.09	-73.90	274.23	0.00	0.00	0.00	0.00
4,300.00	4.30	195.63	4,289.56	-271.31	-75.92	281.73	0.00	0.00	0.00	0.00
4,400.00	4.30	195.63	4,389.27	-278.53	-77.94	289.23	0.00	0.00	0.00	0.00
4,500.00	4.30	195.63	4,488.99	-285.75	-79.96	296.73	0.00	0.00	0.00	0.00
4,600.00	4.30	195.63	4,588.71	-292.98	-81.98	304.23	0.00	0.00	0.00	0.00
4,700.00	4.30	195.63	4,688.43	-300.20	-84.00	311.73	0.00	0.00	0.00	0.00
4,800.00	4.30	195.63	4,788.15	-307.42	-86.02	319.23	0.00	0.00	0.00	0.00
4,900.00	4.30	195.63	4,887.87	-314.64	-88.04	326.73	0.00	0.00	0.00	0.00
5,000.00	4.30	195.63	4,987.58	-321.86	-90.06	334.23	0.00	0.00	0.00	0.00
5,100.00	4.30	195.63	5,087.30	-329.09	-92.09	341.73	0.00	0.00	0.00	0.00
5,200.00	4.30	195.63	5,187.02	-336.31	-94.11	349.23	0.00	0.00	0.00	0.00
5,300.00	4.30	195.63	5,286.74	-343.53	-96.13	356.73	0.00	0.00	0.00	0.00



Plan Report for Johnson 32-03B (Sec. 32-T7S-R93W) - Plan #1 Proposal

Measured Depth (ft)	Inclination (°)	Azimuth (°)	Vertical Depth (ft)	+N/-S (ft)	+E/-W (ft)	Vertical Section (ft)	Dogleg Rate (°/100ft)	Build Rate (°/100ft)	Turn Rate (°/100ft)	Toolface Azimuth (°)
5,400.00	4.30	195.63	5,386.46	-350.75	-98.15	364.23	0.00	0.00	0.00	0.00
5,500.00	4.30	195.63	5,486.18	-357.97	-100.17	371.73	0.00	0.00	0.00	0.00
5,600.00	4.30	195.63	5,585.89	-365.20	-102.19	379.22	0.00	0.00	0.00	0.00
5,700.00	4.30	195.63	5,685.61	-372.42	-104.21	386.72	0.00	0.00	0.00	0.00
5,800.00	4.30	195.63	5,785.33	-379.64	-106.23	394.22	0.00	0.00	0.00	0.00
5,900.00	4.30	195.63	5,885.05	-386.86	-108.25	401.72	0.00	0.00	0.00	0.00
6,000.00	4.30	195.63	5,984.77	-394.09	-110.27	409.22	0.00	0.00	0.00	0.00
6,100.00	4.30	195.63	6,084.49	-401.31	-112.29	416.72	0.00	0.00	0.00	0.00
6,200.00	4.30	195.63	6,184.21	-408.53	-114.32	424.22	0.00	0.00	0.00	0.00
6,226.87	4.30	195.63	6,211.00	-410.47	-114.86	426.24	0.00	0.00	0.00	0.00
Williams Fork										
6,300.00	4.30	195.63	6,283.92	-415.75	-116.34	431.72	0.00	0.00	0.00	0.00
6,400.00	4.30	195.63	6,383.64	-422.97	-118.36	439.22	0.00	0.00	0.00	0.00
6,500.00	4.30	195.63	6,483.36	-430.20	-120.38	446.72	0.00	0.00	0.00	0.00
6,600.00	4.30	195.63	6,583.08	-437.42	-122.40	454.22	0.00	0.00	0.00	0.00
6,700.00	4.30	195.63	6,682.80	-444.64	-124.42	461.72	0.00	0.00	0.00	0.00
6,800.00	4.30	195.63	6,782.52	-451.86	-126.44	469.22	0.00	0.00	0.00	0.00
6,900.00	4.30	195.63	6,882.23	-459.08	-128.46	476.72	0.00	0.00	0.00	0.00
7,000.00	4.30	195.63	6,981.95	-466.31	-130.48	484.22	0.00	0.00	0.00	0.00
7,100.00	4.30	195.63	7,081.67	-473.53	-132.50	491.72	0.00	0.00	0.00	0.00
7,200.00	4.30	195.63	7,181.39	-480.75	-134.52	499.22	0.00	0.00	0.00	0.00
7,300.00	4.30	195.63	7,281.11	-487.97	-136.54	506.72	0.00	0.00	0.00	0.00
7,315.09	4.30	195.63	7,296.15	-489.06	-136.85	507.85	0.00	0.00	0.00	0.00
Begin 2.0°/100' Drop to Vertical at 7315.09ft										
7,400.00	2.60	195.63	7,380.91	-493.98	-138.23	512.96	2.00	-2.00	0.00	180.00
7,500.00	0.60	195.63	7,480.86	-496.68	-138.98	515.76	2.00	-2.00	0.00	180.00
7,530.14	0.00	0.00	7,511.00	-496.83	-139.02	515.91	2.00	-2.00	545.40	180.00
End of Drop at 7530.14ft - ETOG										
7,600.00	0.00	0.00	7,580.86	-496.83	-139.02	515.91	0.00	0.00	0.00	180.00
7,700.00	0.00	0.00	7,680.86	-496.83	-139.02	515.91	0.00	0.00	0.00	0.00
7,800.00	0.00	0.00	7,780.86	-496.83	-139.02	515.91	0.00	0.00	0.00	0.00
7,900.00	0.00	0.00	7,880.86	-496.83	-139.02	515.91	0.00	0.00	0.00	0.00
8,000.00	0.00	0.00	7,980.86	-496.83	-139.02	515.91	0.00	0.00	0.00	0.00
8,100.00	0.00	0.00	8,080.86	-496.83	-139.02	515.91	0.00	0.00	0.00	0.00
8,200.00	0.00	0.00	8,180.86	-496.83	-139.02	515.91	0.00	0.00	0.00	0.00
8,300.00	0.00	0.00	8,280.86	-496.83	-139.02	515.91	0.00	0.00	0.00	0.00
8,400.00	0.00	0.00	8,380.86	-496.83	-139.02	515.91	0.00	0.00	0.00	0.00
8,500.00	0.00	0.00	8,480.86	-496.83	-139.02	515.91	0.00	0.00	0.00	0.00
8,600.00	0.00	0.00	8,580.86	-496.83	-139.02	515.91	0.00	0.00	0.00	0.00
8,700.00	0.00	0.00	8,680.86	-496.83	-139.02	515.91	0.00	0.00	0.00	0.00
8,800.00	0.00	0.00	8,780.86	-496.83	-139.02	515.91	0.00	0.00	0.00	0.00
8,880.14	0.00	0.00	8,861.00	-496.83	-139.02	515.91	0.00	0.00	0.00	0.00
Cameo										
8,900.00	0.00	0.00	8,880.86	-496.83	-139.02	515.91	0.00	0.00	0.00	0.00
9,000.00	0.00	0.00	8,980.86	-496.83	-139.02	515.91	0.00	0.00	0.00	0.00
9,100.00	0.00	0.00	9,080.86	-496.83	-139.02	515.91	0.00	0.00	0.00	0.00
9,200.00	0.00	0.00	9,180.86	-496.83	-139.02	515.91	0.00	0.00	0.00	0.00
9,300.00	0.00	0.00	9,280.86	-496.83	-139.02	515.91	0.00	0.00	0.00	0.00
9,400.00	0.00	0.00	9,380.86	-496.83	-139.02	515.91	0.00	0.00	0.00	0.00
9,500.00	0.00	0.00	9,480.86	-496.83	-139.02	515.91	0.00	0.00	0.00	0.00
9,600.00	0.00	0.00	9,580.86	-496.83	-139.02	515.91	0.00	0.00	0.00	0.00
9,700.00	0.00	0.00	9,680.86	-496.83	-139.02	515.91	0.00	0.00	0.00	0.00
9,730.14	0.00	0.00	9,711.00	-496.83	-139.02	515.91	0.00	0.00	0.00	0.00
Rollins										
9,800.00	0.00	0.00	9,780.86	-496.83	-139.02	515.91	0.00	0.00	0.00	0.00
9,880.14	0.00	0.00	9,861.00	-496.83	-139.02	515.91	0.00	0.00	0.00	0.00
Total Depth at 9880.14ft										

Plan Report for Johnson 32-03B (Sec. 32-T7S-R93W) - Plan #1 Proposal

Plan Annotations

Measured Depth (ft)	Vertical Depth (ft)	Local Coordinates		Comment
		+N/-S (ft)	+E/-W (ft)	
400.00	400.00	0.00	0.00	KOP - Begin 1.5°/100' Build at 400.00ft
686.73	686.46	-10.36	-2.90	End of Build at 686.73ft
4,000.00	3,990.40	-249.64	-69.86	Hold Angle at 4.30°
7,315.09	7,296.15	-489.06	-136.85	Begin 2.0°/100' Drop to Vertical at 7315.09ft
7,530.14	7,511.00	-496.83	-139.02	End of Drop at 7530.14ft
9,880.14	9,861.00	-496.83	-139.02	Total Depth at 9880.14ft

Vertical Section Information

Angle Type	Target	Azimuth (°)	Origin Type	Origin		Start TVD (ft)
				+N/-S (ft)	+E/-W (ft)	
Target	Johnson 32-03B_BHL Tgt	195.63	Slot	0.00	0.00	0.00

Survey tool program

From (ft)	To (ft)	Survey/Plan	Survey Tool
0.00	9,879.53	Plan #1 Proposal	MWD

Formation Details

Measured Depth (ft)	Vertical Depth (ft)	Name	Lithology	Dip (°)	Dip Direction (°)
6,226.87	6,211.00	Williams Fork		0.00	
7,530.14	7,511.00	ETOG		0.00	
8,880.14	8,861.00	Cameo		0.00	
9,730.14	9,711.00	Rollins		0.00	

Targets associated with this wellbore

Target Name	TVD (ft)	+N/-S (ft)	+E/-W (ft)	Shape
Johnson 32-03B_TOG Tgt	7,511.00	-496.83	-139.02	Circle
Johnson 32-03B_BHL Tgt	9,861.00	-496.83	-139.02	Point

North Reference Sheet for Johnson 32-03 PAD - Johnson 32-03B (Sec. 32-T7S-R93W) - Plan #1

All data is in US Feet unless otherwise stated. Directions and Coordinates are relative to True North Reference.

Vertical Depths are relative to KB @ 7871.00ft (Original Well Elev). Northing and Easting are relative to Johnson 32-03B (Sec. 32-T7S-R93W) - Slot A2

Coordinate System is US State Plane 1983, Colorado Central Zone using datum North American Datum 1983, ellipsoid GRS 1980

Projection method is Lambert Conformal Conic (2 parallel)

Central Meridian is -105.50°, Longitude Origin:0° 0' 0.000 E°, Latitude Origin:39° 45' 0.000 N°

False Easting: 3,000,000.00ft, False Northing: 1,000,000.00ft, Scale Reduction: 0.99995037

Grid Coordinates of Well: 1,582,260.85 ft N, 2,350,532.46 ft E

Geographical Coordinates of Well: 39° 24' 34.23" N, 107° 47' 55.90" W

Grid Convergence at Surface is: -1.45°

Based upon Minimum Curvature type calculations, at a Measured Depth of 9,880.14ft
the Bottom Hole Displacement is 515.91ft in the Direction of 195.63° (True).

Magnetic Convergence at surface is: -11.86° (26 February 2010, , BGGM2009)

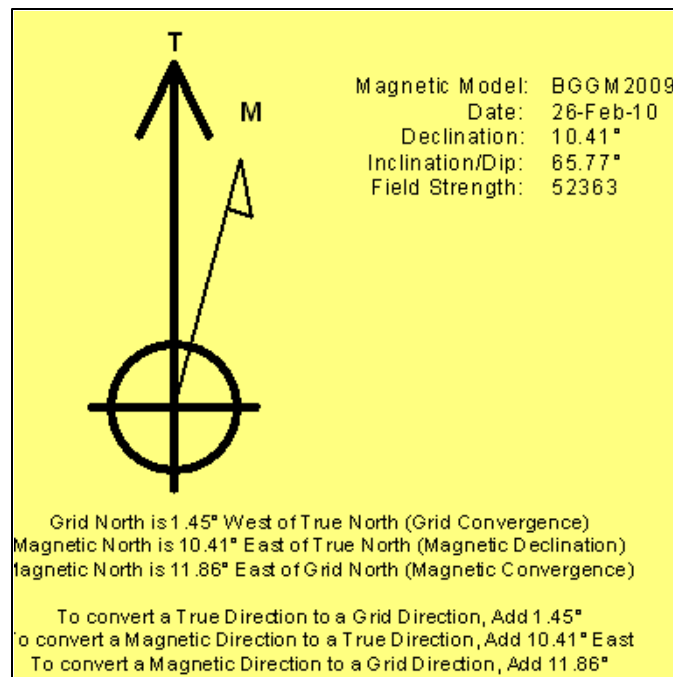

Project: Garfield County, CO
Site: Johnson 32-03 PAD
Well: Johnson 32-03B (Sec. 32-T7S-R93W)
Wellbore: Plan #1
Plan: Plan #1 Proposal

Laramie Energy II, LLC

HALLIBURTON
Sperry Drilling

SECTION DETAILS										
Sec	MD	Inc	Azi	TVD	+N/-S	+E/-W	DLeg	TFace	VSec	Target
1	0.00	0.00	0.00	0.00	0.00	0.00	0.00	0.00	0.00	
2	400.00	0.00	0.00	400.00	0.00	0.00	0.00	0.00	0.00	
3	686.73	4.30	195.63	686.46	-10.36	-2.90	1.50	195.63	10.76	
4	7315.09	4.30	195.63	7296.16	-489.06	-136.85	0.00	0.00	507.85	
5	7530.14	0.00	0.00	7511.00	-496.83	-139.02	2.00	180.00	515.91	Johnson 32-03B_TOG Tgt
6	9880.14	0.00	0.00	9861.00	-496.83	-139.02	0.00	0.00	515.91	Johnson 32-03B_BHL Tgt

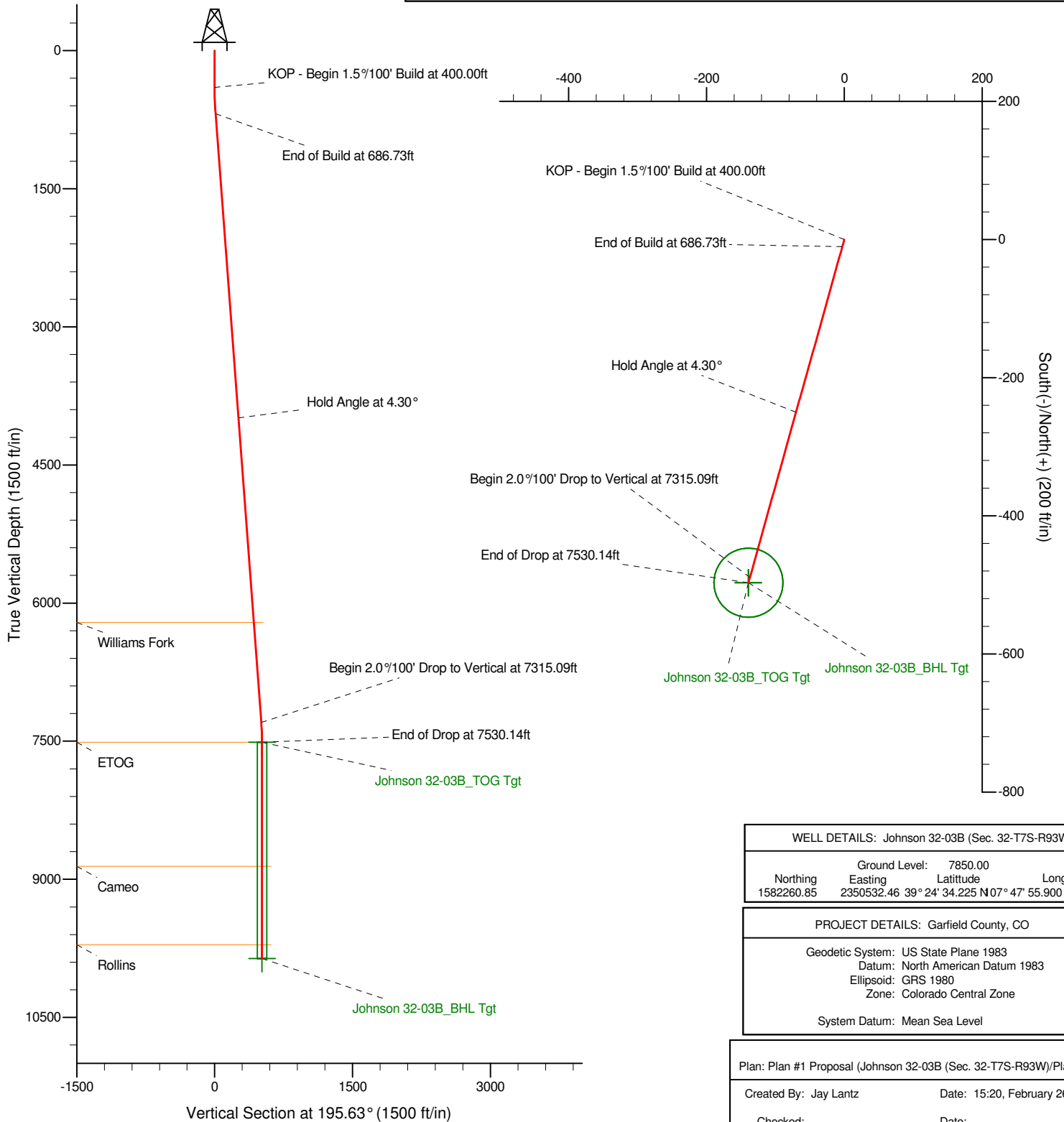

WELL DETAILS: Johnson 32-03B (Sec. 32-T7S-R93W)			
Northing	Ground Level:	Latitude	Longitude
1582260.85	2350532.46	39° 24' 34.225 N	07° 47' 55.900 W

PROJECT DETAILS: Garfield County, CO	
Geodetic System:	US State Plane 1983
Datum:	North American Datum 1983
Ellipsoid:	GRS 1980
Zone:	Colorado Central Zone
System Datum:	Mean Sea Level

Plan: Plan #1 Proposal (Johnson 32-03B (Sec. 32-T7S-R93W)/Plan #1)	
Created By: Jay Lantz	Date: 15:20, February 26 2010
Checked: _____	Date: _____
Reviewed: _____	Date: _____
Approved: _____	Date: _____