

Laramie Energy II, LLC

Garfield County, CO

Johnson 32-03 PAD

Johnson 29-14D (Sec. 32-T7S-R93W) - A3

Plan #1

Plan: Plan #1 Proposal

Sperry Drilling Services

Proposal Report

26 February, 2010

Well Coordinates: 1,582,266.53 N, 2,350,524.12 E (39° 24' 34.28" N, 107° 47' 56.01" W)

Ground Level: 7,850.00 ft

Local Coordinate Origin: Centered on Well Johnson 29-14D (Sec. 32-T7S-R93

Viewing Datum: KB @ 7871.00ft (Precision Drilling 706)

TVDs to System: N

North Reference: True

Unit System: API - US Survey Feet - Custom

Geodetic Scale Factor Applied

Version: 2003.16 Build: 43I

HALLIBURTON



Plan Report for Johnson 29-14D (Sec. 32-T7S-R93W) - Plan #1 Proposal

Measured Depth (ft)	Inclination (°)	Azimuth (°)	Vertical Depth (ft)	+N/-S (ft)	+E/-W (ft)	Vertical Section (ft)	Dogleg Rate (°/100ft)	Build Rate (°/100ft)	Turn Rate (°/100ft)	Toolface Azimuth (°)
0.00	0.00	0.00	0.00	0.00	0.00	0.00	0.00	0.00	0.00	0.00
100.00	0.00	0.00	100.00	0.00	0.00	0.00	0.00	0.00	0.00	0.00
200.00	0.00	0.00	200.00	0.00	0.00	0.00	0.00	0.00	0.00	0.00
KOP - Begin 2.0°/100' Build at 200.00ft										
267.72	1.35	311.05	267.71	0.53	-0.60	0.80	2.00	2.00	0.00	311.05
End of Build at 267.72ft										
300.00	1.35	311.05	299.98	1.03	-1.18	1.56	0.00	0.00	0.00	0.00
400.00	1.35	311.05	399.96	2.58	-2.96	3.93	0.00	0.00	0.00	0.00
500.00	1.35	311.05	499.93	4.13	-4.74	6.29	0.00	0.00	0.00	0.00
600.00	1.35	311.05	599.90	5.68	-6.53	8.65	0.00	0.00	0.00	0.00
700.00	1.35	311.05	699.87	7.23	-8.31	11.02	0.00	0.00	0.00	0.00
800.00	1.35	311.05	799.84	8.79	-10.09	13.38	0.00	0.00	0.00	0.00
900.00	1.35	311.05	899.82	10.34	-11.87	15.75	0.00	0.00	0.00	0.00
1,000.00	1.35	311.05	999.79	11.89	-13.66	18.11	0.00	0.00	0.00	0.00
1,100.00	1.35	311.05	1,099.76	13.44	-15.44	20.47	0.00	0.00	0.00	0.00
1,200.00	1.35	311.05	1,199.73	15.00	-17.22	22.84	0.00	0.00	0.00	0.00
1,300.00	1.35	311.05	1,299.71	16.55	-19.01	25.20	0.00	0.00	0.00	0.00
1,400.00	1.35	311.05	1,399.68	18.10	-20.79	27.56	0.00	0.00	0.00	0.00
1,500.00	1.35	311.05	1,499.65	19.65	-22.57	29.93	0.00	0.00	0.00	0.00
1,600.00	1.35	311.05	1,599.62	21.20	-24.35	32.29	0.00	0.00	0.00	0.00
1,700.00	1.35	311.05	1,699.59	22.76	-26.14	34.65	0.00	0.00	0.00	0.00
1,800.00	1.35	311.05	1,799.57	24.31	-27.92	37.02	0.00	0.00	0.00	0.00
1,900.00	1.35	311.05	1,899.54	25.86	-29.70	39.38	0.00	0.00	0.00	0.00
2,000.00	1.35	311.05	1,999.51	27.41	-31.48	41.74	0.00	0.00	0.00	0.00
2,100.00	1.35	311.05	2,099.48	28.96	-33.27	44.11	0.00	0.00	0.00	0.00
2,200.00	1.35	311.05	2,199.45	30.52	-35.05	46.47	0.00	0.00	0.00	0.00
2,300.00	1.35	311.05	2,299.43	32.07	-36.83	48.84	0.00	0.00	0.00	0.00
2,400.00	1.35	311.05	2,399.40	33.62	-38.61	51.20	0.00	0.00	0.00	0.00
2,500.00	1.35	311.05	2,499.37	35.17	-40.40	53.56	0.00	0.00	0.00	0.00
2,600.00	1.35	311.05	2,599.34	36.72	-42.18	55.93	0.00	0.00	0.00	0.00
2,700.00	1.35	311.05	2,699.31	38.28	-43.96	58.29	0.00	0.00	0.00	0.00
2,800.00	1.35	311.05	2,799.29	39.83	-45.74	60.65	0.00	0.00	0.00	0.00
2,900.00	1.35	311.05	2,899.26	41.38	-47.53	63.02	0.00	0.00	0.00	0.00
3,000.00	1.35	311.05	2,999.23	42.93	-49.31	65.38	0.00	0.00	0.00	0.00
3,100.00	1.35	311.05	3,099.20	44.48	-51.09	67.74	0.00	0.00	0.00	0.00
3,200.00	1.35	311.05	3,199.17	46.04	-52.88	70.11	0.00	0.00	0.00	0.00
3,300.00	1.35	311.05	3,299.15	47.59	-54.66	72.47	0.00	0.00	0.00	0.00
3,400.00	1.35	311.05	3,399.12	49.14	-56.44	74.84	0.00	0.00	0.00	0.00
3,500.00	1.35	311.05	3,499.09	50.69	-58.22	77.20	0.00	0.00	0.00	0.00
3,600.00	1.35	311.05	3,599.06	52.25	-60.01	79.56	0.00	0.00	0.00	0.00
3,700.00	1.35	311.05	3,699.03	53.80	-61.79	81.93	0.00	0.00	0.00	0.00
3,800.00	1.35	311.05	3,799.01	55.35	-63.57	84.29	0.00	0.00	0.00	0.00
3,900.00	1.35	311.05	3,898.98	56.90	-65.35	86.65	0.00	0.00	0.00	0.00
Hold Angle at 1.35°										
4,000.00	1.35	311.05	3,998.95	58.45	-67.14	89.02	0.00	0.00	0.00	0.00
4,100.00	1.35	311.05	4,098.92	60.01	-68.92	91.38	0.00	0.00	0.00	0.00
4,200.00	1.35	311.05	4,198.90	61.56	-70.70	93.74	0.00	0.00	0.00	0.00
4,300.00	1.35	311.05	4,298.87	63.11	-72.48	96.11	0.00	0.00	0.00	0.00
4,400.00	1.35	311.05	4,398.84	64.66	-74.27	98.47	0.00	0.00	0.00	0.00
4,500.00	1.35	311.05	4,498.81	66.21	-76.05	100.84	0.00	0.00	0.00	0.00
4,600.00	1.35	311.05	4,598.78	67.77	-77.83	103.20	0.00	0.00	0.00	0.00
4,700.00	1.35	311.05	4,698.76	69.32	-79.61	105.56	0.00	0.00	0.00	0.00
4,800.00	1.35	311.05	4,798.73	70.87	-81.40	107.93	0.00	0.00	0.00	0.00
4,900.00	1.35	311.05	4,898.70	72.42	-83.18	110.29	0.00	0.00	0.00	0.00
5,000.00	1.35	311.05	4,998.67	73.97	-84.96	112.65	0.00	0.00	0.00	0.00
5,100.00	1.35	311.05	5,098.64	75.53	-86.74	115.02	0.00	0.00	0.00	0.00
5,200.00	1.35	311.05	5,198.62	77.08	-88.53	117.38	0.00	0.00	0.00	0.00
5,300.00	1.35	311.05	5,298.59	78.63	-90.31	119.74	0.00	0.00	0.00	0.00



Plan Report for Johnson 29-14D (Sec. 32-T7S-R93W) - Plan #1 Proposal

Measured Depth (ft)	Inclination (°)	Azimuth (°)	Vertical Depth (ft)	+N-S (ft)	+E-W (ft)	Vertical Section (ft)	Dogleg Rate (°/100ft)	Build Rate (°/100ft)	Turn Rate (°/100ft)	Toolface Azimuth (°)
5,400.00	1.35	311.05	5,398.56	80.18	-92.09	122.11	0.00	0.00	0.00	0.00
5,500.00	1.35	311.05	5,498.53	81.73	-93.88	124.47	0.00	0.00	0.00	0.00
5,600.00	1.35	311.05	5,598.50	83.29	-95.66	126.84	0.00	0.00	0.00	0.00
5,700.00	1.35	311.05	5,698.48	84.84	-97.44	129.20	0.00	0.00	0.00	0.00
5,800.00	1.35	311.05	5,798.45	86.39	-99.22	131.56	0.00	0.00	0.00	0.00
5,900.00	1.35	311.05	5,898.42	87.94	-101.01	133.93	0.00	0.00	0.00	0.00
6,000.00	1.35	311.05	5,998.39	89.50	-102.79	136.29	0.00	0.00	0.00	0.00
6,100.00	1.35	311.05	6,098.36	91.05	-104.57	138.65	0.00	0.00	0.00	0.00
6,200.00	1.35	311.05	6,198.34	92.60	-106.35	141.02	0.00	0.00	0.00	0.00
6,242.68	1.35	311.05	6,241.00	93.26	-107.11	142.03	0.00	0.00	0.00	0.00
Williams Fork										
6,300.00	1.35	311.05	6,298.31	94.15	-108.14	143.38	0.00	0.00	0.00	0.00
6,400.00	1.35	311.05	6,398.28	95.70	-109.92	145.74	0.00	0.00	0.00	0.00
6,500.00	1.35	311.05	6,498.25	97.26	-111.70	148.11	0.00	0.00	0.00	0.00
6,600.00	1.35	311.05	6,598.22	98.81	-113.48	150.47	0.00	0.00	0.00	0.00
6,700.00	1.35	311.05	6,698.20	100.36	-115.27	152.83	0.00	0.00	0.00	0.00
6,800.00	1.35	311.05	6,798.17	101.91	-117.05	155.20	0.00	0.00	0.00	0.00
6,900.00	1.35	311.05	6,898.14	103.46	-118.83	157.56	0.00	0.00	0.00	0.00
7,000.00	1.35	311.05	6,998.11	105.02	-120.61	159.93	0.00	0.00	0.00	0.00
7,100.00	1.35	311.05	7,098.08	106.57	-122.40	162.29	0.00	0.00	0.00	0.00
7,200.00	1.35	311.05	7,198.06	108.12	-124.18	164.65	0.00	0.00	0.00	0.00
7,300.00	1.35	311.05	7,298.03	109.67	-125.96	167.02	0.00	0.00	0.00	0.00
7,400.00	1.35	311.05	7,398.00	111.22	-127.75	169.38	0.00	0.00	0.00	0.00
7,475.31	1.35	311.05	7,473.29	112.39	-129.09	171.16	0.00	0.00	0.00	0.00
Begin 2.0°/100' Drop to Vertical at 7475.31ft										
7,500.00	0.86	311.05	7,497.98	112.71	-129.45	171.64	2.00	-2.00	0.00	180.00
7,543.03	0.00	0.00	7,541.00	112.92	-129.69	171.96	2.00	-2.00	113.78	180.00
End of Drop at 7543.03ft - ETOG										
7,600.00	0.00	0.00	7,597.97	112.92	-129.69	171.96	0.00	0.00	0.00	180.00
7,700.00	0.00	0.00	7,697.97	112.92	-129.69	171.96	0.00	0.00	0.00	0.00
7,800.00	0.00	0.00	7,797.97	112.92	-129.69	171.96	0.00	0.00	0.00	0.00
7,900.00	0.00	0.00	7,897.97	112.92	-129.69	171.96	0.00	0.00	0.00	0.00
8,000.00	0.00	0.00	7,997.97	112.92	-129.69	171.96	0.00	0.00	0.00	0.00
8,100.00	0.00	0.00	8,097.97	112.92	-129.69	171.96	0.00	0.00	0.00	0.00
8,200.00	0.00	0.00	8,197.97	112.92	-129.69	171.96	0.00	0.00	0.00	0.00
8,300.00	0.00	0.00	8,297.97	112.92	-129.69	171.96	0.00	0.00	0.00	0.00
8,400.00	0.00	0.00	8,397.97	112.92	-129.69	171.96	0.00	0.00	0.00	0.00
8,500.00	0.00	0.00	8,497.97	112.92	-129.69	171.96	0.00	0.00	0.00	0.00
8,600.00	0.00	0.00	8,597.97	112.92	-129.69	171.96	0.00	0.00	0.00	0.00
8,700.00	0.00	0.00	8,697.97	112.92	-129.69	171.96	0.00	0.00	0.00	0.00
8,800.00	0.00	0.00	8,797.97	112.92	-129.69	171.96	0.00	0.00	0.00	0.00
8,893.03	0.00	0.00	8,891.00	112.92	-129.69	171.96	0.00	0.00	0.00	0.00
Cameo										
8,900.00	0.00	0.00	8,897.97	112.92	-129.69	171.96	0.00	0.00	0.00	0.00
9,000.00	0.00	0.00	8,997.97	112.92	-129.69	171.96	0.00	0.00	0.00	0.00
9,100.00	0.00	0.00	9,097.97	112.92	-129.69	171.96	0.00	0.00	0.00	0.00
9,200.00	0.00	0.00	9,197.97	112.92	-129.69	171.96	0.00	0.00	0.00	0.00
9,300.00	0.00	0.00	9,297.97	112.92	-129.69	171.96	0.00	0.00	0.00	0.00
9,400.00	0.00	0.00	9,397.97	112.92	-129.69	171.96	0.00	0.00	0.00	0.00
9,500.00	0.00	0.00	9,497.97	112.92	-129.69	171.96	0.00	0.00	0.00	0.00
9,600.00	0.00	0.00	9,597.97	112.92	-129.69	171.96	0.00	0.00	0.00	0.00
9,700.00	0.00	0.00	9,697.97	112.92	-129.69	171.96	0.00	0.00	0.00	0.00
9,743.03	0.00	0.00	9,741.00	112.92	-129.69	171.96	0.00	0.00	0.00	0.00
Rollins										
9,800.00	0.00	0.00	9,797.97	112.92	-129.69	171.96	0.00	0.00	0.00	0.00
9,893.03	0.00	0.00	9,891.00	112.92	-129.69	171.96	0.00	0.00	0.00	0.00
Total Depth at 9893.03ft										

Plan Report for Johnson 29-14D (Sec. 32-T7S-R93W) - Plan #1 Proposal

Plan Annotations

Measured Depth (ft)	Vertical Depth (ft)	Local Coordinates		Comment
		+N/-S (ft)	+E/-W (ft)	
200.00	200.00	0.00	0.00	KOP - Begin 2.0°/100' Build at 200.00ft
267.72	267.71	0.53	-0.60	End of Build at 267.72ft
3,900.00	3,898.98	56.90	-65.35	Hold Angle at 1.35°
7,475.31	7,473.29	112.39	-129.09	Begin 2.0°/100' Drop to Vertical at 7475.31ft
7,543.03	7,541.00	112.92	-129.69	End of Drop at 7543.03ft
9,893.03	9,891.00	112.92	-129.69	Total Depth at 9893.03ft

Vertical Section Information

Angle Type	Target	Azimuth (°)	Origin Type	Origin		Start TVD (ft)
				+N/-S (ft)	+E/-W (ft)	
Target	Johnson 29-14D_BHL Tgt	311.05	Slot	0.00	0.00	0.00

Survey tool program

From (ft)	To (ft)	Survey/Plan	Survey Tool
0.00	9,893.03	Plan #1 Proposal	MWD

Formation Details

Measured Depth (ft)	Vertical Depth (ft)	Name	Lithology	Dip (°)	Dip Direction (°)
6,242.68	6,241.00	Williams Fork		0.00	
7,543.03	7,541.00	ETOG		0.00	
8,893.03	8,891.00	Cameo		0.00	
9,743.03	9,741.00	Rollins		0.00	

Targets associated with this wellbore

Target Name	TVD (ft)	+N/-S (ft)	+E/-W (ft)	Shape
Johnson 29-14D_TOG Tgt	7,541.00	112.92	-129.69	Circle
Johnson 29-14D_BHL Tgt	9,891.00	112.92	-129.69	Point

North Reference Sheet for Johnson 32-03 PAD - Johnson 29-14D (Sec. 32-T7S-R93W) - Plan #1

All data is in US Feet unless otherwise stated. Directions and Coordinates are relative to True North Reference.

Vertical Depths are relative to KB @ 7871.00ft (Precision Drilling 706). Northing and Easting are relative to Johnson 29-14D (Sec. 32-T7S-R93W) - Slot A3

Coordinate System is US State Plane 1983, Colorado Central Zone using datum North American Datum 1983, ellipsoid GRS 1980

Projection method is Lambert Conformal Conic (2 parallel)

Central Meridian is -105.50°, Longitude Origin:0° 0' 0.000 E°, Latitude Origin:39° 45' 0.000 N°

False Easting: 3,000,000.00ft, False Northing: 1,000,000.00ft, Scale Reduction: 0.99995037

Grid Coordinates of Well: 1,582,266.53 ft N, 2,350,524.12 ft E

Geographical Coordinates of Well: 39° 24' 34.28" N, 107° 47' 56.01" W

Grid Convergence at Surface is: -1.45°

Based upon Minimum Curvature type calculations, at a Measured Depth of 9,893.03ft
the Bottom Hole Displacement is 171.96ft in the Direction of 311.05° (True).

Magnetic Convergence at surface is: -11.86° (26 February 2010, , BGGM2009)

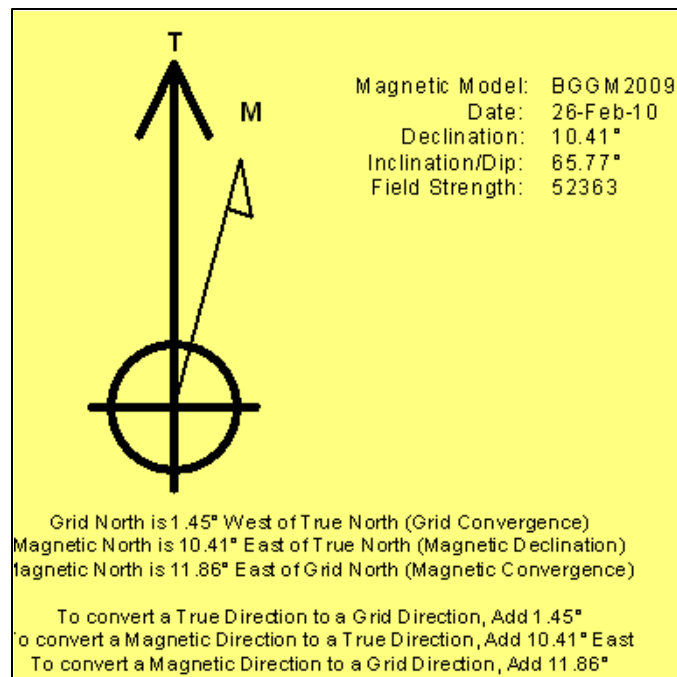

Project: Garfield County, CO
Site: Johnson 32-03 PAD
Well: Johnson 29-14D (Sec. 32-T7S-R93W)
Wellbore: Plan #1
Plan: Plan #1 Proposal

Laramie Energy II, LLC

HALLIBURTON

Sperry Drilling

SECTION DETAILS

Sec	MD	Inc	Azi	TVD	+N/-S	+E/-W	DLeg	TFace	VSec	Target
1	0.00	0.00	0.00	0.00	0.00	0.00	0.00	0.00	0.00	
2	200.00	0.00	0.00	200.00	0.00	0.00	0.00	0.00	0.00	
3	267.72	1.35	311.05	267.71	0.53	-0.60	2.00	311.05	0.80	
4	7475.31	1.35	311.05	7473.29	112.39	-129.09	0.00	0.00	171.16	
5	7543.03	0.00	0.00	7541.00	112.92	-129.69	2.00	180.00	171.96	Johnson 29-14D_TOG Tgt
6	9893.03	0.00	0.00	9891.00	112.92	-129.69	0.00	0.00	171.96	Johnson 29-14D_BHL Tgt

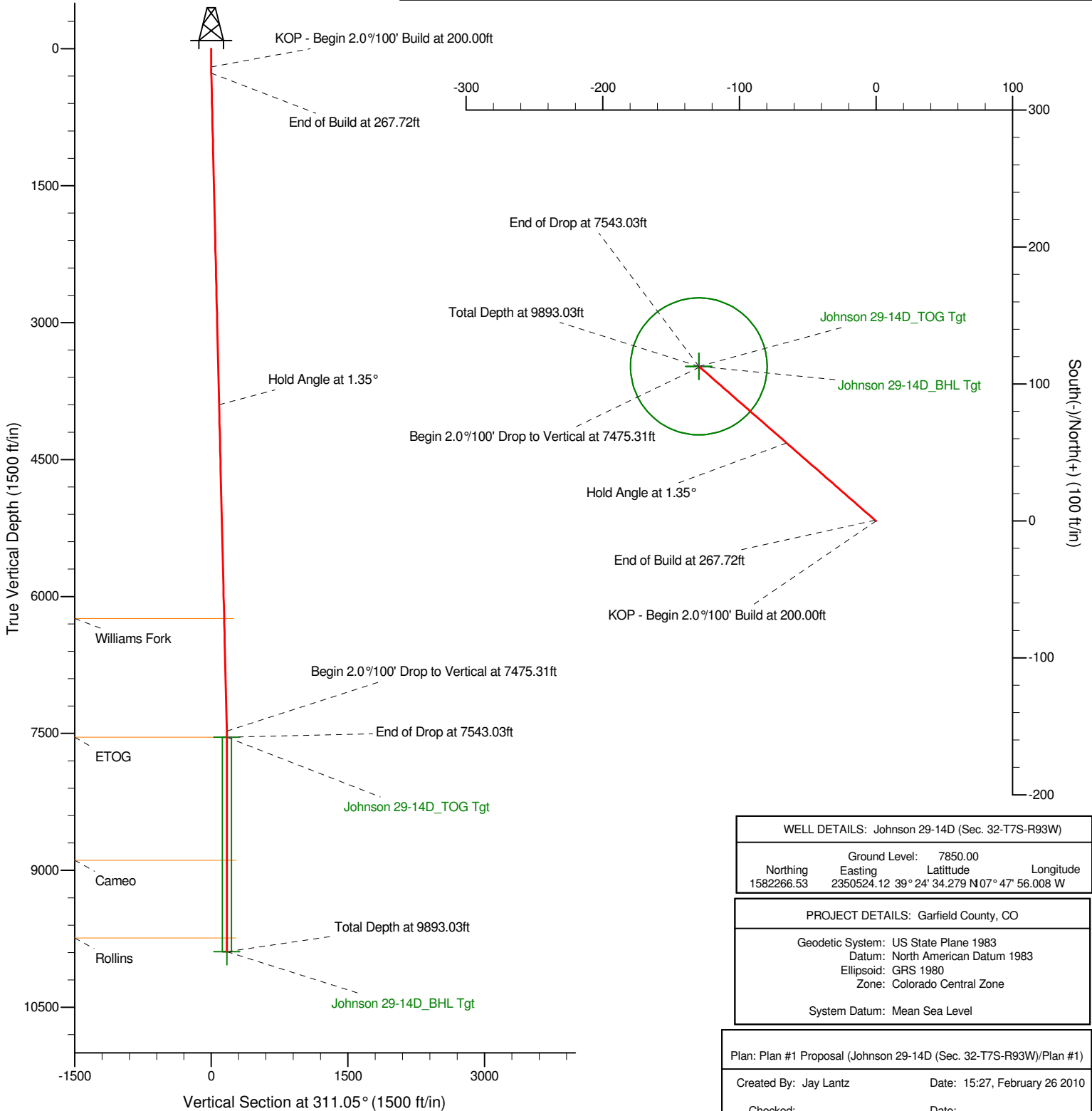

WELL DETAILS: Johnson 29-14D (Sec. 32-T7S-R93W)

Northing	Ground Level:	Latitude	Longitude
1582266.53	7850.00	39° 24' 34.279 N	07° 47' 56.008 W

PROJECT DETAILS: Garfield County, CO

Geodetic System: US State Plane 1983
Datum: North American Datum 1983
Ellipsoid: GRS 1980
Zone: Colorado Central Zone

System Datum: Mean Sea Level

Plan: Plan #1 Proposal (Johnson 29-14D (Sec. 32-T7S-R93W)/Plan #1)

Created By: Jay Lantz Date: 15:27, February 26 2010

Checked: _____ Date: _____

Reviewed: _____ Date: _____

Approved: _____ Date: _____