

Access Road Map

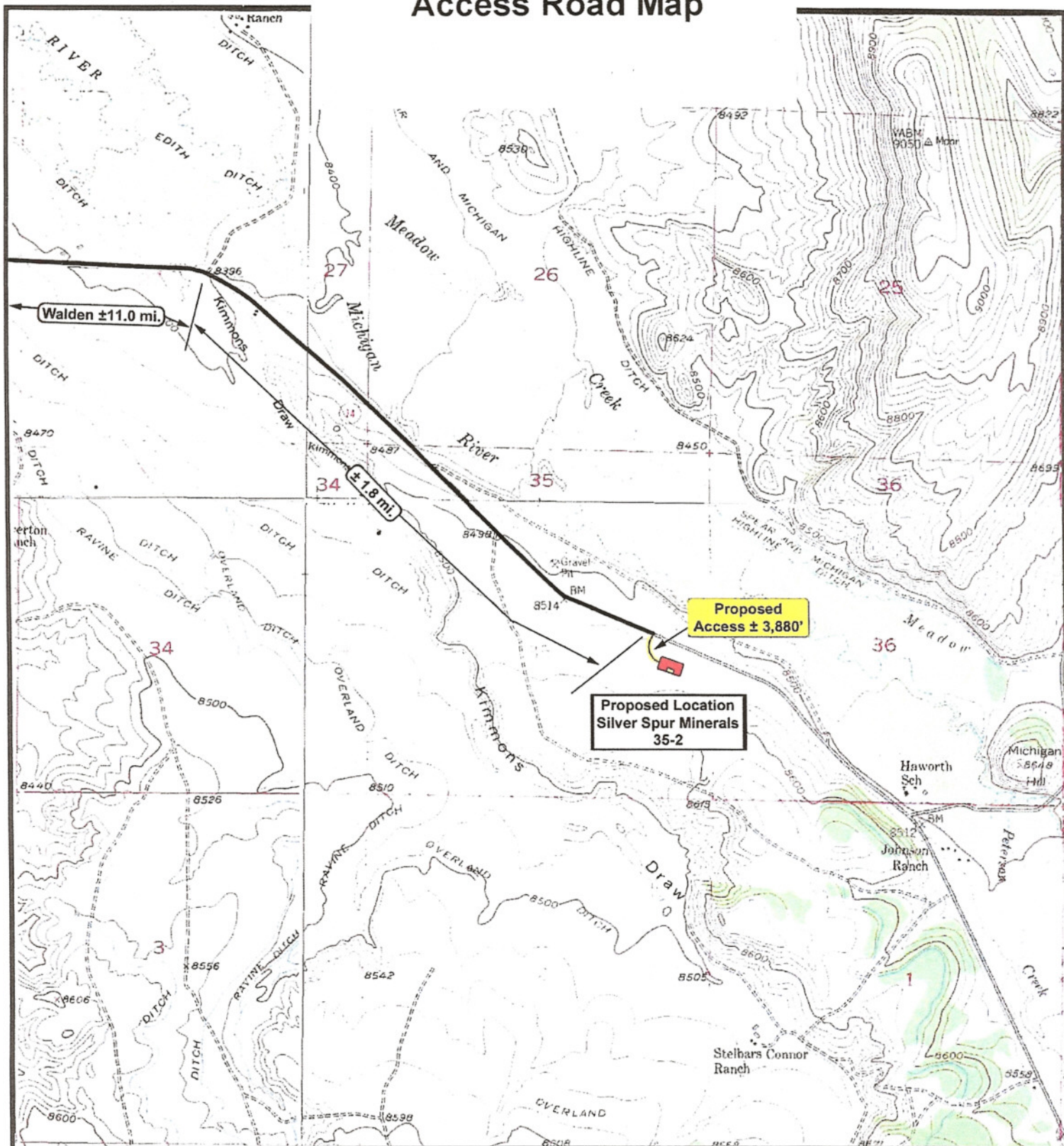

Wellstar Corporation

Silver Spur Minerals 35-2
SEC. 35, T8N, R78W, 6th P.M.



 **Tri-State**
Land Surveying Inc.
(435) 781-2501
180 North Vernal Ave. Vernal, Utah 84078

SCALE: 1" = 2,000'
DRAWN BY: JAS
DATE: 12-22-2008

Legend

Existing Road	Proposed Access
---------------	-----------------

TOPOGRAPHIC MAP

"B"

SHEET
6
OF 7