

Location Drawing

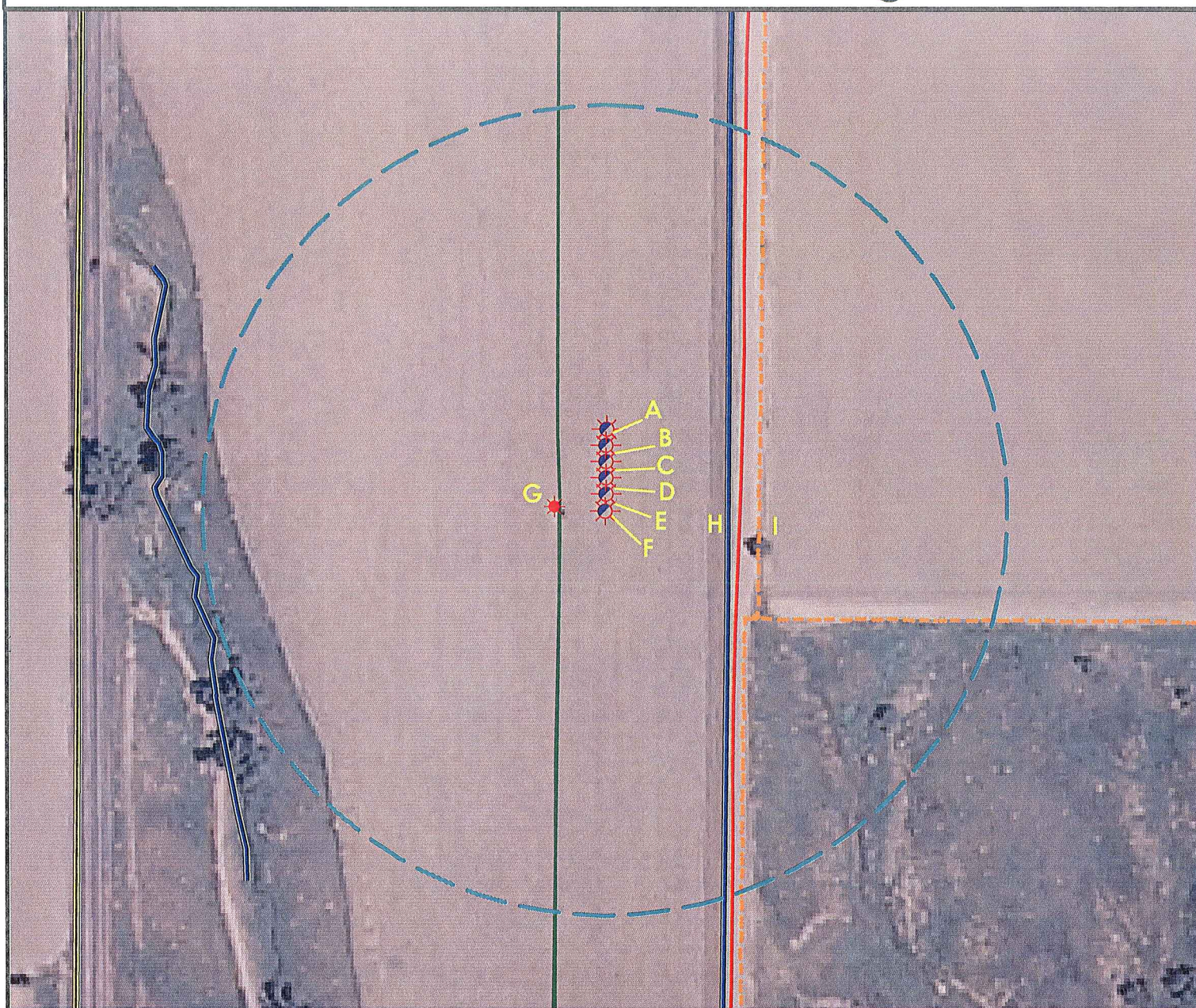

- | | | |
|--------------------------------|--|---------------------|
| A. Proposed well WINTERS 30-3. | E. Proposed well WINTERS 22-3. | I. Fence is 155' E. |
| B. Proposed well WINTERS 29-3. | F. Proposed well WINTERS 32-3. | |
| C. Proposed well WINTERS 31-3. | G. Existing well WINTERS 5-3 is 47' W. | |
| D. Proposed well WINTERS 18-3. | H. Ditch is 123' E. | |

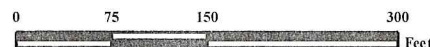

Legend

- | | |
|----------------------|---------------------|
| Proposed Well | Building/Residence |
| Existing Well | Oil & Gas Equipment |
| Plugged Well | Water Body |
| Water Well | Utility Box |
| CattleGuard/Gate | Fence |
| Bridge | Overhead Power Line |
| ECD | Pipeline |
| 400' Radius | Public Road |
| Facilities Enclosure | Access Road |
| | Ditch/Canal |
| | Concrete Ditch |

400ft Radius Map

WINTERS 32-3 Pad Multi Well Pad

Surface Location: T5N R65W S3
Description of surface uses : Open Field

Field Date: 02/16/2010
Drawing Date: 02/23/2010
Drafter: BHF
Checked By: BHF

Aerial Photo supplied by NAIP - 2009

Prepared for:
**KERR-MCGEE OIL &
GAS ONSHORE LP**



Use our resources to find yours!
www.petro-fs.com

1801 W. 13th Ave Suite 207
Denver, CO 80204
(303) 928-7128
111 E. Third Street
Rifle, CO 81650
(970) 625-4740