

# Map Unit Description

Weld County, Colorado, Southern Part

## 1 Altvan loam, 0 to 1 percent slopes

### Setting

Elevation: 4500 to 4900 feet  
Mean annual precipitation: 14 to 16 inches  
Mean annual air temperature: 46 to 48 degrees F  
Frost-free period: 130 to 150 days

### Composition

Altvan and similar soils: 90 percent  
Minor components: 1 percent

### Description of Altvan

#### Setting

Landform: Terraces  
Down-slope shape: Linear  
Across-slope shape: Linear  
Parent material: Old alluvium

#### Properties and Qualities

Slope: 0 to 1 percent  
Drainage class: Well drained  
Capacity of the most limiting layer to transmit water (Ksat): Moderately high or high (0.20 to 2.00 in/hr)  
Frequency of flooding: None  
Frequency of ponding: None  
Calcium carbonate maximum: 5 percent  
Gypsum maximum: 0 percent  
Available water capacity: Low (about 5.7 inches)

#### Interpretive Groups

Land capability classification (irrigated): 3s  
Land capability (non irrigated): 4e  
Ecological site: Loamy Plains (R067BY002CO)

#### Typical Profile

0 to 10 inches: loam  
10 to 25 inches: clay loam  
25 to 60 inches: gravelly sand

### Minor Components

Aquic haplustolls  
Percent of map unit: 1 percent  
Landform: Swales

Altvan loam, 0 to 1 percent slopes

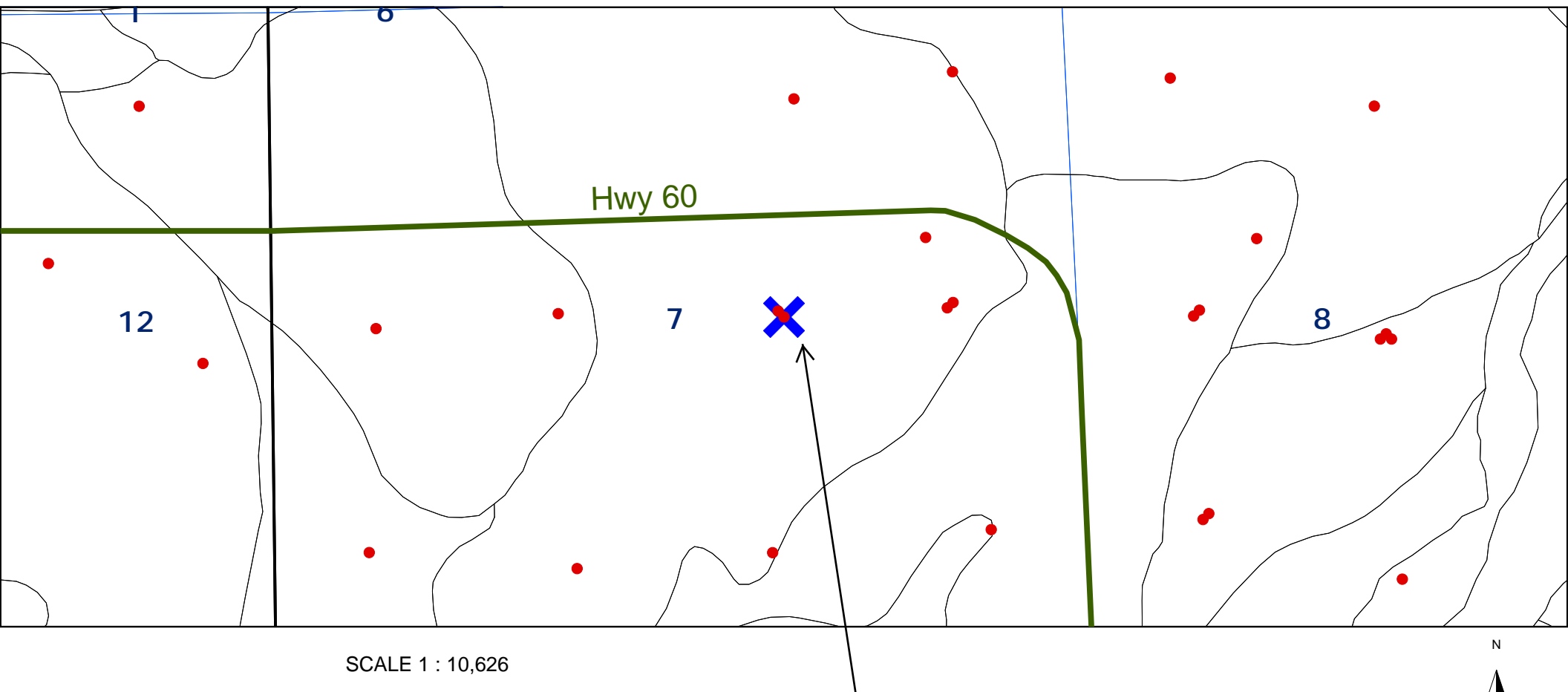

SCALE 1 : 10,626

1,000 0 1,000 2,000 3,000  
FEET

K. P. Kauffman Company, Inc.  
Soils map  
Kammerzell #7-7-24  
SWNE section 7-T4N-R66W  
Weld Co., Colorado

