

VISIBLE IMPROVEMENTS SKETCH BOOTH N25-20D

SECTION 25, TOWNSHIP 5 NORTH, RANGE 67 WEST OF THE 6TH PRINCIPAL MERIDIAN

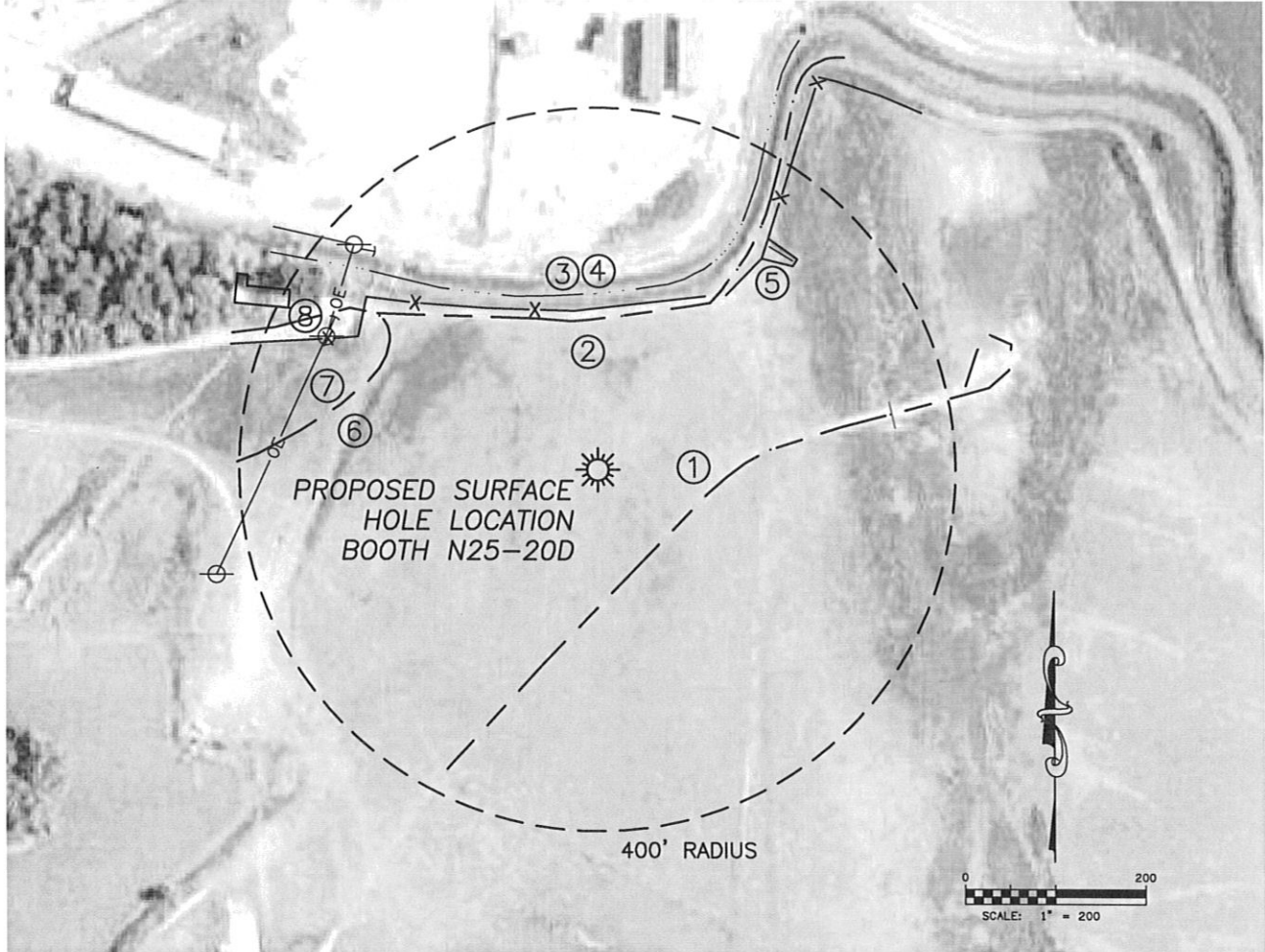

- | | | | | |
|---|--|----------------------------------|---|---|
| ①
CENTERLINE
<u>FIELD ROAD</u>
106' SE | ②
CENTERLINE
<u>FIELD ROAD</u>
166' N | ③
<u>WIRE FENCE</u>
177' N | ④
CENTERLINE
<u>CANAL</u>
195' N | ⑤
<u>CONCRETE
FLUME</u>
315' NE |
| ⑥
CENTERLINE
<u>FIELD ROAD</u>
290' NW | ⑦
<u>OVERHEAD
POWER LINE</u>
335' NW | ⑧
<u>HOUSE</u>
387' NW | | |

NEAREST OVERHEAD POWER 335'± NW