

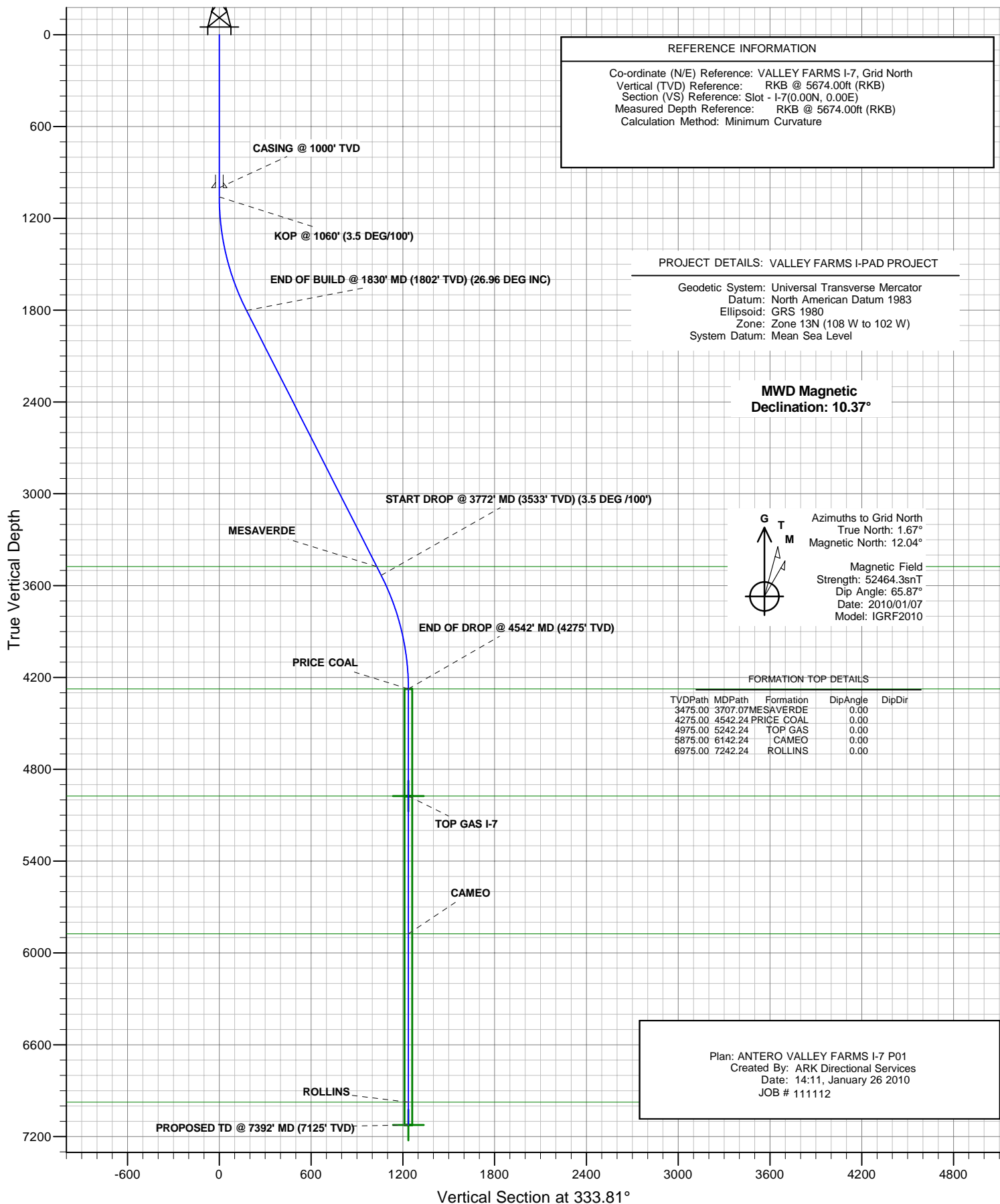

# ANTERO RESOURCES

## ANTERO VALLEY FARMS I-7





## ANTERO RESOURCES



### PLAN VIEW

Project: VALLEY FARMS I-PAD PROJECT  
Site: FRONTIER 12  
Well: VALLEY FARMS I-7 (111112)  
Wellbore: ANTERO VALLEY FARMS I-7  
Design: ANTERO VALLEY FARMS I-7 P01  
JOB # 111112

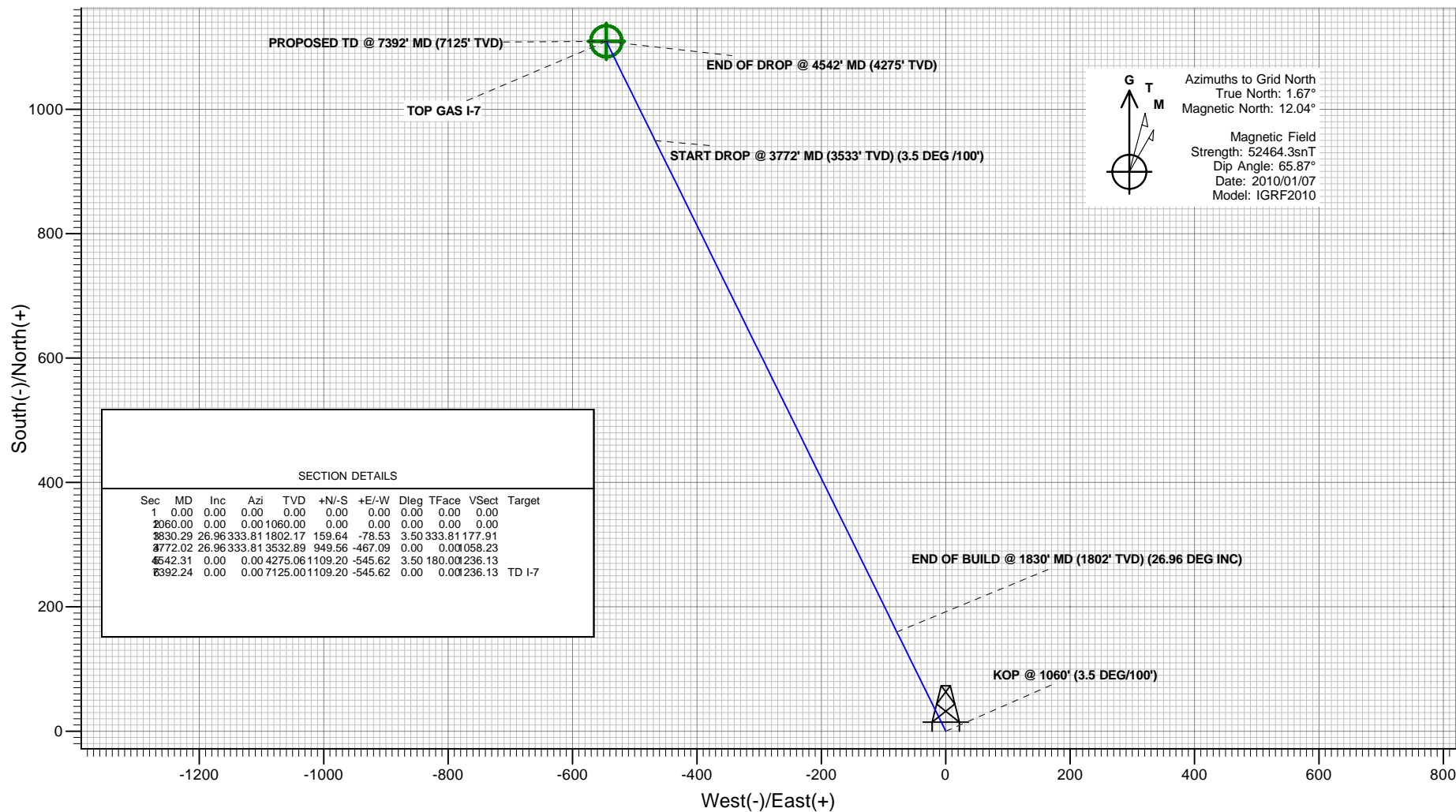

Plan: ANTERO VALLEY FARMS I-7 P01  
Created By: ARK Directional Services  
Date: 14:14, January 26 2010

#### PROJECT DETAILS: VALLEY FARMS I-PAD PROJECT

Geodetic System: Universal Transverse Mercator  
Datum: North American Datum 1983  
Ellipsoid: GRS 1980  
Zone: Zone 13N (108 W to 102 W)  
System Datum: Mean Sea Level

#### REFERENCE INFORMATION

Co-ordinate (N/E) Reference: VALLEY FARMS I-7, Grid North  
Vertical (TVD) Reference: RKB @ 5674.00ft (RKB)  
Section (VS) Reference: Slot - I-7(0.00N, 0.00E)  
Measured Depth Reference: RKB @ 5674.00ft (RKB)  
Calculation Method: Minimum Curvature



# ANTERO VALLEY FARMS I-7



## SPIDER PLOT

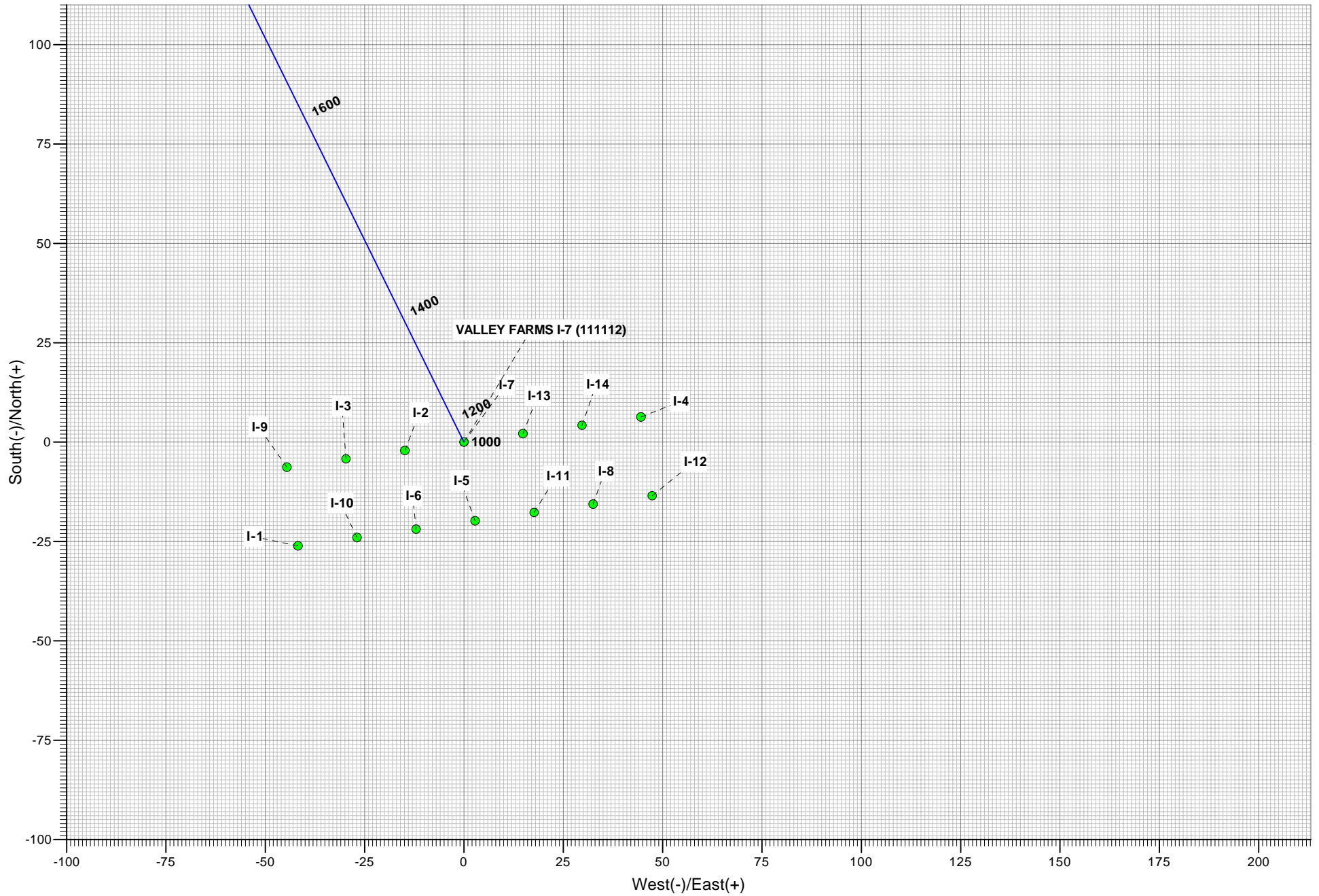

# **ANTERO RESOURCES**

**VALLEY FARMS I-PAD PROJECT  
FRONTIER 12**

**Plan: ANTERO VALLEY FARMS I-7 P01**

## **Standard Planning Report - Geographic**

**26 January, 2010**

# Ark Directional Services

## Planning Report - Geographic

<b>Database:</b>	EDM 5000.1 Single User Db	<b>Local Co-ordinate Reference:</b>	Well VALLEY FARMS I-7 (111112) - Slot I-7
<b>Company:</b>	ANTERO RESOURCES	<b>TVD Reference:</b>	RKB @ 5674.00ft (RKB)
<b>Project:</b>	VALLEY FARMS I-PAD PROJECT	<b>MD Reference:</b>	RKB @ 5674.00ft (RKB)
<b>Site:</b>	FRONTIER 12	<b>North Reference:</b>	Grid
<b>Well:</b>	VALLEY FARMS I-7 (111112)	<b>Survey Calculation Method:</b>	Minimum Curvature
<b>Wellbore:</b>	ANTERO VALLEY FARMS I-7		
<b>Design:</b>	ANTERO VALLEY FARMS I-7 P01		

<b>Project</b>	VALLEY FARMS I-PAD PROJECT		
<b>Map System:</b>	Universal Transverse Mercator	<b>System Datum:</b>	Mean Sea Level
<b>Geo Datum:</b>	North American Datum 1983		
<b>Map Zone:</b>	Zone 13N (108 W to 102 W)		

Site		FRONTIER 12			
Site Position:		Northing:	14,365,113.22 usft	Latitude:	39° 31' 35.888 N
From:	Lat/Long	Easting:	901,976.81 usft	Longitude:	107° 37' 7.093 W
Position Uncertainty:	0.00 ft	Slot Radius:	13.20 in	Grid Convergence:	-1.67 °

Well	VALLEY FARMS I-7 (111112) - Slot I-7					
Well Position	+N/-S	0.00 ft	Northing:	14,365,133.02 usft	Latitude:	39° 31' 36.082 N
	+E/-W	0.00 ft	Easting:	901,974.01 usft	Longitude:	107° 37' 7.136 W
Position Uncertainty		0.00 ft	Wellhead Elevation:		Ground Level:	5,650.00 ft

<b>Wellbore</b>	ANTERO VALLEY FARMS I-7				
<b>Magnetics</b>	<b>Model Name</b>	<b>Sample Date</b>	<b>Declination (°)</b>	<b>Dip Angle (°)</b>	<b>Field Strength (nT)</b>
	IGRF2010	2010/01/07	10.37	65.87	52,464

<b>Design</b>	ANTERO VALLEY FARMS I-7 P01			
<b>Audit Notes:</b>				
<b>Version:</b>	<b>Phase:</b>	PLAN	<b>Tie On Depth:</b>	0.00
<b>Vertical Section:</b>	<b>Depth From (TVD) (ft)</b>	<b>+N/-S (ft)</b>	<b>+E/-W (ft)</b>	<b>Direction (°)</b>
	0.00	0.00	0.00	333.81

<b>Plan Sections</b>										
Measured Depth (ft)	Inclination (°)	Azimuth (°)	Vertical Depth (ft)	+N/-S (ft)	+E/-W (ft)	Dogleg Rate (°/100ft)	Build Rate (°/100ft)	Turn Rate (°/100ft)	TFO (°)	Target
0.00	0.00	0.00	0.00	0.00	0.00	0.00	0.00	0.00	0.00	
1,060.00	0.00	0.00	1,060.00	0.00	0.00	0.00	0.00	0.00	0.00	
1,830.29	26.96	333.81	1,802.17	159.64	-78.53	3.50	3.50	0.00	333.81	
3,772.02	26.96	333.81	3,532.89	949.56	-467.09	0.00	0.00	0.00	0.00	
4,542.31	0.00	0.00	4,275.06	1,109.20	-545.62	3.50	-3.50	0.00	180.00	
7,392.24	0.00	0.00	7,125.00	1,109.20	-545.62	0.00	0.00	0.00	0.00	TD I-7

# Ark Directional Services

## Planning Report - Geographic

<b>Database:</b>	EDM 5000.1 Single User Db	<b>Local Co-ordinate Reference:</b>	Well VALLEY FARMS I-7 (111112) - Slot I-7
<b>Company:</b>	ANTERO RESOURCES	<b>TVD Reference:</b>	RKB @ 5674.00ft (RKB)
<b>Project:</b>	VALLEY FARMS I-PAD PROJECT	<b>MD Reference:</b>	RKB @ 5674.00ft (RKB)
<b>Site:</b>	FRONTIER 12	<b>North Reference:</b>	Grid
<b>Well:</b>	VALLEY FARMS I-7 (111112)	<b>Survey Calculation Method:</b>	Minimum Curvature
<b>Wellbore:</b>	ANTERO VALLEY FARMS I-7		
<b>Design:</b>	ANTERO VALLEY FARMS I-7 P01		

Planned Survey									
Measured Depth (ft)	Inclination (°)	Azimuth (°)	Vertical Depth (ft)	+N/-S (ft)	+E/-W (ft)	Map Northing (usft)	Map Easting (usft)	Latitude	Longitude
0.00	0.00	0.00	0.00	0.00	0.00	14,365,133.02	901,974.01	39° 31' 36.082 N	107° 37' 7.136 W
100.00	0.00	0.00	100.00	0.00	0.00	14,365,133.02	901,974.01	39° 31' 36.082 N	107° 37' 7.136 W
200.00	0.00	0.00	200.00	0.00	0.00	14,365,133.02	901,974.01	39° 31' 36.082 N	107° 37' 7.136 W
300.00	0.00	0.00	300.00	0.00	0.00	14,365,133.02	901,974.01	39° 31' 36.082 N	107° 37' 7.136 W
400.00	0.00	0.00	400.00	0.00	0.00	14,365,133.02	901,974.01	39° 31' 36.082 N	107° 37' 7.136 W
500.00	0.00	0.00	500.00	0.00	0.00	14,365,133.02	901,974.01	39° 31' 36.082 N	107° 37' 7.136 W
600.00	0.00	0.00	600.00	0.00	0.00	14,365,133.02	901,974.01	39° 31' 36.082 N	107° 37' 7.136 W
700.00	0.00	0.00	700.00	0.00	0.00	14,365,133.02	901,974.01	39° 31' 36.082 N	107° 37' 7.136 W
800.00	0.00	0.00	800.00	0.00	0.00	14,365,133.02	901,974.01	39° 31' 36.082 N	107° 37' 7.136 W
900.00	0.00	0.00	900.00	0.00	0.00	14,365,133.02	901,974.01	39° 31' 36.082 N	107° 37' 7.136 W
1,000.00	0.00	0.00	1,000.00	0.00	0.00	14,365,133.02	901,974.01	39° 31' 36.082 N	107° 37' 7.136 W
<b>CASING @ 1000' TVD</b>									
1,060.00	0.00	0.00	1,060.00	0.00	0.00	14,365,133.02	901,974.01	39° 31' 36.082 N	107° 37' 7.136 W
<b>KOP @ 1060' (3.5 DEG/100')</b>									
1,100.00	1.40	333.81	1,100.00	0.44	-0.22	14,365,133.46	901,973.79	39° 31' 36.087 N	107° 37' 7.139 W
1,200.00	4.90	333.81	1,199.83	5.37	-2.64	14,365,138.39	901,971.37	39° 31' 36.135 N	107° 37' 7.172 W
1,300.00	8.40	333.81	1,299.14	15.76	-7.75	14,365,148.78	901,966.26	39° 31' 36.236 N	107° 37' 7.241 W
1,400.00	11.90	333.81	1,397.56	31.57	-15.53	14,365,164.59	901,958.48	39° 31' 36.390 N	107° 37' 7.346 W
1,500.00	15.40	333.81	1,494.72	52.74	-25.94	14,365,185.76	901,948.07	39° 31' 36.596 N	107° 37' 7.487 W
1,600.00	18.90	333.81	1,590.26	79.20	-38.96	14,365,212.22	901,935.05	39° 31' 36.853 N	107° 37' 7.663 W
1,700.00	22.40	333.81	1,683.82	110.84	-54.52	14,365,243.86	901,919.49	39° 31' 37.161 N	107° 37' 7.873 W
1,800.00	25.90	333.81	1,775.05	147.54	-72.58	14,365,280.56	901,901.43	39° 31' 37.519 N	107° 37' 8.117 W
1,830.29	26.96	333.81	1,802.18	159.64	-78.53	14,365,292.66	901,895.48	39° 31' 37.637 N	107° 37' 8.197 W
<b>END OF BUILD @ 1830' MD (1802' TVD) (26.96 DEG INC)</b>									
1,900.00	26.96	333.81	1,864.31	188.00	-92.48	14,365,321.02	901,881.53	39° 31' 37.913 N	107° 37' 8.386 W
2,000.00	26.96	333.81	1,953.44	228.68	-112.49	14,365,361.70	901,861.52	39° 31' 38.309 N	107° 37' 8.656 W
2,100.00	26.96	333.81	2,042.58	269.36	-132.50	14,365,402.38	901,841.51	39° 31' 38.705 N	107° 37' 8.926 W
2,200.00	26.96	333.81	2,131.71	310.04	-152.51	14,365,443.06	901,821.50	39° 31' 39.101 N	107° 37' 9.197 W
2,300.00	26.96	333.81	2,220.84	350.72	-172.52	14,365,483.74	901,801.49	39° 31' 39.497 N	107° 37' 9.467 W
2,400.00	26.96	333.81	2,309.97	391.41	-192.53	14,365,524.43	901,781.48	39° 31' 39.893 N	107° 37' 9.737 W
2,500.00	26.96	333.81	2,399.11	432.09	-212.55	14,365,565.11	901,761.46	39° 31' 40.289 N	107° 37' 10.008 W
2,600.00	26.96	333.81	2,488.24	472.77	-232.56	14,365,605.79	901,741.45	39° 31' 40.685 N	107° 37' 10.278 W
2,700.00	26.96	333.81	2,577.37	513.45	-252.57	14,365,646.47	901,721.44	39° 31' 41.081 N	107° 37' 10.548 W
2,800.00	26.96	333.81	2,666.50	554.13	-272.58	14,365,687.15	901,701.43	39° 31' 41.477 N	107° 37' 10.819 W
2,900.00	26.96	333.81	2,755.64	594.81	-292.59	14,365,727.83	901,681.42	39° 31' 41.873 N	107° 37' 11.089 W
3,000.00	26.96	333.81	2,844.77	635.49	-312.60	14,365,768.51	901,661.41	39° 31' 42.269 N	107° 37' 11.359 W
3,100.00	26.96	333.81	2,933.90	676.17	-332.61	14,365,809.19	901,641.40	39° 31' 42.665 N	107° 37' 11.630 W
3,200.00	26.96	333.81	3,023.03	716.86	-352.63	14,365,849.88	901,621.39	39° 31' 43.061 N	107° 37' 11.900 W
3,300.00	26.96	333.81	3,112.16	757.54	-372.64	14,365,890.56	901,601.37	39° 31' 43.457 N	107° 37' 12.170 W
3,400.00	26.96	333.81	3,201.30	798.22	-392.65	14,365,931.24	901,581.36	39° 31' 43.853 N	107° 37' 12.441 W
3,500.00	26.96	333.81	3,290.43	838.90	-412.66	14,365,971.92	901,561.35	39° 31' 44.249 N	107° 37' 12.711 W
3,600.00	26.96	333.81	3,379.56	879.58	-432.67	14,366,012.60	901,541.34	39° 31' 44.645 N	107° 37' 12.981 W
3,700.00	26.96	333.81	3,468.69	920.26	-452.68	14,366,053.28	901,521.33	39° 31' 45.041 N	107° 37' 13.252 W
3,707.08	26.96	333.81	3,475.00	923.14	-454.10	14,366,056.16	901,519.91	39° 31' 45.069 N	107° 37' 13.271 W
<b>MESAVERDE</b>									
3,772.02	26.96	333.81	3,532.89	949.56	-467.09	14,366,082.58	901,506.92	39° 31' 45.327 N	107° 37' 13.446 W
<b>START DROP @ 3772' MD (3533' TVD) (3.5 DEG /100')</b>									
3,800.00	25.98	333.81	3,557.93	960.75	-472.60	14,366,093.77	901,501.41	39° 31' 45.436 N	107° 37' 13.521 W
3,900.00	22.48	333.81	3,649.11	997.57	-490.71	14,366,130.59	901,483.30	39° 31' 45.794 N	107° 37' 13.765 W
4,000.00	18.98	333.81	3,742.62	1,029.33	-506.33	14,366,162.35	901,467.68	39° 31' 46.103 N	107° 37' 13.977 W
4,100.00	15.48	333.81	3,838.12	1,055.91	-519.41	14,366,188.93	901,454.60	39° 31' 46.362 N	107° 37' 14.153 W
4,200.00	11.98	333.81	3,935.24	1,077.20	-529.88	14,366,210.22	901,444.13	39° 31' 46.569 N	107° 37' 14.295 W
4,300.00	8.48	333.81	4,033.64	1,093.14	-537.72	14,366,226.16	901,436.29	39° 31' 46.724 N	107° 37' 14.401 W
4,400.00	4.98	333.81	4,132.93	1,103.65	-542.89	14,366,236.67	901,431.12	39° 31' 46.827 N	107° 37' 14.470 W

# Ark Directional Services

## Planning Report - Geographic

<b>Database:</b>	EDM 5000.1 Single User Db	<b>Local Co-ordinate Reference:</b>	Well VALLEY FARMS I-7 (111112) - Slot I-7
<b>Company:</b>	ANTERO RESOURCES	<b>TVD Reference:</b>	RKB @ 5674.00ft (RKB)
<b>Project:</b>	VALLEY FARMS I-PAD PROJECT	<b>MD Reference:</b>	RKB @ 5674.00ft (RKB)
<b>Site:</b>	FRONTIER 12	<b>North Reference:</b>	Grid
<b>Well:</b>	VALLEY FARMS I-7 (111112)	<b>Survey Calculation Method:</b>	Minimum Curvature
<b>Wellbore:</b>	ANTERO VALLEY FARMS I-7		
<b>Design:</b>	ANTERO VALLEY FARMS I-7 P01		

Planned Survey									
Measured Depth (ft)	Inclination (°)	Azimuth (°)	Vertical Depth (ft)	+N/-S (ft)	+E/-W (ft)	Map Northing (usft)	Map Easting (usft)	Latitude	Longitude
4,500.00	1.48	333.81	4,232.76	1,108.71	-545.38	14,366,241.73	901,428.63	39° 31' 46.876 N	107° 37' 14.504 W
4,542.24	0.00	333.81	4,275.00	1,109.20	-545.62	14,366,242.22	901,428.39	39° 31' 46.881 N	107° 37' 14.507 W
<b>PRICE COAL</b>									
4,542.31	0.00	0.00	4,275.07	1,109.20	-545.62	14,366,242.22	901,428.39	39° 31' 46.881 N	107° 37' 14.507 W
<b>END OF DROP @ 4542' MD (4275' TVD)</b>									
4,600.00	0.00	0.00	4,332.76	1,109.20	-545.62	14,366,242.22	901,428.39	39° 31' 46.881 N	107° 37' 14.507 W
4,700.00	0.00	0.00	4,432.76	1,109.20	-545.62	14,366,242.22	901,428.39	39° 31' 46.881 N	107° 37' 14.507 W
4,800.00	0.00	0.00	4,532.76	1,109.20	-545.62	14,366,242.22	901,428.39	39° 31' 46.881 N	107° 37' 14.507 W
4,900.00	0.00	0.00	4,632.76	1,109.20	-545.62	14,366,242.22	901,428.39	39° 31' 46.881 N	107° 37' 14.507 W
5,000.00	0.00	0.00	4,732.76	1,109.20	-545.62	14,366,242.22	901,428.39	39° 31' 46.881 N	107° 37' 14.507 W
5,100.00	0.00	0.00	4,832.76	1,109.20	-545.62	14,366,242.22	901,428.39	39° 31' 46.881 N	107° 37' 14.507 W
5,200.00	0.00	0.00	4,932.76	1,109.20	-545.62	14,366,242.22	901,428.39	39° 31' 46.881 N	107° 37' 14.507 W
5,242.24	0.00	0.00	4,975.00	1,109.20	-545.62	14,366,242.22	901,428.39	39° 31' 46.881 N	107° 37' 14.507 W
<b>TOP GAS - TOP GAS I-7</b>									
5,300.00	0.00	0.00	5,032.76	1,109.20	-545.62	14,366,242.22	901,428.39	39° 31' 46.881 N	107° 37' 14.507 W
5,400.00	0.00	0.00	5,132.76	1,109.20	-545.62	14,366,242.22	901,428.39	39° 31' 46.881 N	107° 37' 14.507 W
5,500.00	0.00	0.00	5,232.76	1,109.20	-545.62	14,366,242.22	901,428.39	39° 31' 46.881 N	107° 37' 14.507 W
5,600.00	0.00	0.00	5,332.76	1,109.20	-545.62	14,366,242.22	901,428.39	39° 31' 46.881 N	107° 37' 14.507 W
5,700.00	0.00	0.00	5,432.76	1,109.20	-545.62	14,366,242.22	901,428.39	39° 31' 46.881 N	107° 37' 14.507 W
5,800.00	0.00	0.00	5,532.76	1,109.20	-545.62	14,366,242.22	901,428.39	39° 31' 46.881 N	107° 37' 14.507 W
5,900.00	0.00	0.00	5,632.76	1,109.20	-545.62	14,366,242.22	901,428.39	39° 31' 46.881 N	107° 37' 14.507 W
6,000.00	0.00	0.00	5,732.76	1,109.20	-545.62	14,366,242.22	901,428.39	39° 31' 46.881 N	107° 37' 14.507 W
6,100.00	0.00	0.00	5,832.76	1,109.20	-545.62	14,366,242.22	901,428.39	39° 31' 46.881 N	107° 37' 14.507 W
6,142.24	0.00	0.00	5,875.00	1,109.20	-545.62	14,366,242.22	901,428.39	39° 31' 46.881 N	107° 37' 14.507 W
<b>CAMEO</b>									
6,200.00	0.00	0.00	5,932.76	1,109.20	-545.62	14,366,242.22	901,428.39	39° 31' 46.881 N	107° 37' 14.507 W
6,300.00	0.00	0.00	6,032.76	1,109.20	-545.62	14,366,242.22	901,428.39	39° 31' 46.881 N	107° 37' 14.507 W
6,400.00	0.00	0.00	6,132.76	1,109.20	-545.62	14,366,242.22	901,428.39	39° 31' 46.881 N	107° 37' 14.507 W
6,500.00	0.00	0.00	6,232.76	1,109.20	-545.62	14,366,242.22	901,428.39	39° 31' 46.881 N	107° 37' 14.507 W
6,600.00	0.00	0.00	6,332.76	1,109.20	-545.62	14,366,242.22	901,428.39	39° 31' 46.881 N	107° 37' 14.507 W
6,700.00	0.00	0.00	6,432.76	1,109.20	-545.62	14,366,242.22	901,428.39	39° 31' 46.881 N	107° 37' 14.507 W
6,800.00	0.00	0.00	6,532.76	1,109.20	-545.62	14,366,242.22	901,428.39	39° 31' 46.881 N	107° 37' 14.507 W
6,900.00	0.00	0.00	6,632.76	1,109.20	-545.62	14,366,242.22	901,428.39	39° 31' 46.881 N	107° 37' 14.507 W
7,000.00	0.00	0.00	6,732.76	1,109.20	-545.62	14,366,242.22	901,428.39	39° 31' 46.881 N	107° 37' 14.507 W
7,100.00	0.00	0.00	6,832.76	1,109.20	-545.62	14,366,242.22	901,428.39	39° 31' 46.881 N	107° 37' 14.507 W
7,200.00	0.00	0.00	6,932.76	1,109.20	-545.62	14,366,242.22	901,428.39	39° 31' 46.881 N	107° 37' 14.507 W
7,242.24	0.00	0.00	6,975.00	1,109.20	-545.62	14,366,242.22	901,428.39	39° 31' 46.881 N	107° 37' 14.507 W
<b>ROLLINS</b>									
7,300.00	0.00	0.00	7,032.76	1,109.20	-545.62	14,366,242.22	901,428.39	39° 31' 46.881 N	107° 37' 14.507 W
7,392.22	0.00	0.00	7,124.98	1,109.20	-545.62	14,366,242.22	901,428.39	39° 31' 46.881 N	107° 37' 14.507 W
<b>PROPOSED TD @ 7392' MD (7125' TVD)</b>									
7,392.24	0.00	0.00	7,125.00	1,109.20	-545.62	14,366,242.22	901,428.39	39° 31' 46.881 N	107° 37' 14.507 W
<b>TD I-7</b>									

# Ark Directional Services

## Planning Report - Geographic

<b>Database:</b>	EDM 5000.1 Single User Db	<b>Local Co-ordinate Reference:</b>	Well VALLEY FARMS I-7 (111112) - Slot I-7
<b>Company:</b>	ANTERO RESOURCES	<b>TVD Reference:</b>	RKB @ 5674.00ft (RKB)
<b>Project:</b>	VALLEY FARMS I-PAD PROJECT	<b>MD Reference:</b>	RKB @ 5674.00ft (RKB)
<b>Site:</b>	FRONTIER 12	<b>North Reference:</b>	Grid
<b>Well:</b>	VALLEY FARMS I-7 (111112)	<b>Survey Calculation Method:</b>	Minimum Curvature
<b>Wellbore:</b>	ANTERO VALLEY FARMS I-7		
<b>Design:</b>	ANTERO VALLEY FARMS I-7 P01		

Design Targets									
Target Name									
- hit/miss target	Dip Angle	Dip Dir.	TVD	+N/-S	+E/-W	Northing	Easting	Latitude	Longitude
- Shape	(°)	(°)	(ft)	(ft)	(ft)	(usft)	(usft)		
TOP GAS I-7	0.00	360.00	4,975.00	1,109.20	-545.62	14,366,242.22	901,428.39	39° 31' 46.881 N	107° 37' 14.507 W
- plan hits target center									
- Circle (radius 25.00)									
TD I-7	0.00	360.00	7,125.00	1,109.20	-545.62	14,366,242.22	901,428.39	39° 31' 46.881 N	107° 37' 14.507 W
- plan hits target center									
- Circle (radius 25.00)									

Casing Points					
	Measured Depth	Vertical Depth		Casing Diameter	Hole Diameter
	(ft)	(ft)	Name	(in)	(in)
	1,000.00	1,000.00	CASING @ 1000' TVD	9.62	12.25

Formations					
	Measured Depth	Vertical Depth		Dip	Dip Direction
	(ft)	(ft)	Name	(°)	(°)
	3,707.08	3,475.00	MESAVERDE	0.00	
	4,542.24	4,275.00	PRICE COAL	0.00	
	5,242.24	4,975.00	TOP GAS	0.00	
	6,142.24	5,875.00	CAMEO	0.00	
	7,242.24	6,975.00	ROLLINS	0.00	

Plan Annotations					
	Measured Depth	Vertical Depth	Local Coordinates		
	(ft)	(ft)	+N/-S	+E/-W	Comment
	(ft)	(ft)	(ft)	(ft)	
	1,060.00	1,060.00	0.00	0.00	KOP @ 1060' (3.5 DEG/100')
	1,830.29	1,802.18	159.64	-78.53	END OF BUILD @ 1830' MD (1802' TVD) (26.96 DEG INC)
	3,772.02	3,532.89	949.56	-467.09	START DROP @ 3772' MD (3533' TVD) (3.5 DEG /100')
	4,542.31	4,275.07	1,109.20	-545.62	END OF DROP @ 4542' MD (4275' TVD)
	7,392.22	7,124.98	1,109.20	-545.62	PROPOSED TD @ 7392' MD (7125' TVD)