



Construction Layout Drawings  
**Volk 12-89-21 #1**

113

**Proposed Drilling Layout**

2581623 (2A)

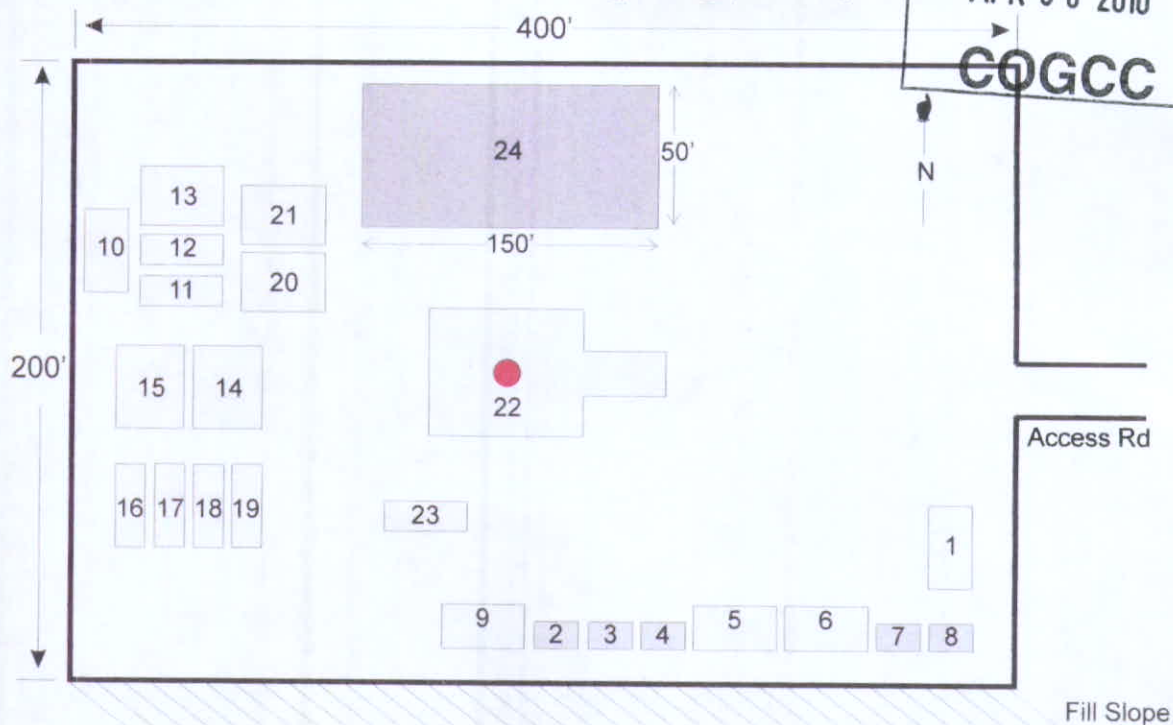
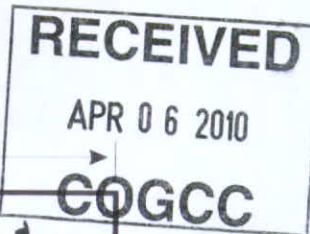

- |                                 |                                |                               |
|---------------------------------|--------------------------------|-------------------------------|
| 1. Co-man trailer               | 9. Mud engineer/Co-man trailer | 17. Fuel tank                 |
| 2. Potable water house          | 10. Trash bin                  | 18. Change house              |
| 3. Sewer house                  | 11. Frac tank for mud          | 19. Generator house           |
| 4. C-can                        | 12. Frac tank for water        | 20. Above ground cuttings pit |
| 5. Tool pusher trailer          | 13. Suction mud pit            | 21. Return mud pit            |
| 6. Close-loop/Mudlogger trailer | 14. Mud pump #1                | 22. Sub-structure foot print  |
| 7. Potable water house          | 15. Mud pump #2                | 23. Koomey house              |
| 8. Potable sewer house          | 16. Rig water tank             | 24. Pit                       |

Volk12-89-21 #1

RECEIVED

APR 06 2010

COGCC

Proposed Stormwater Management Layout

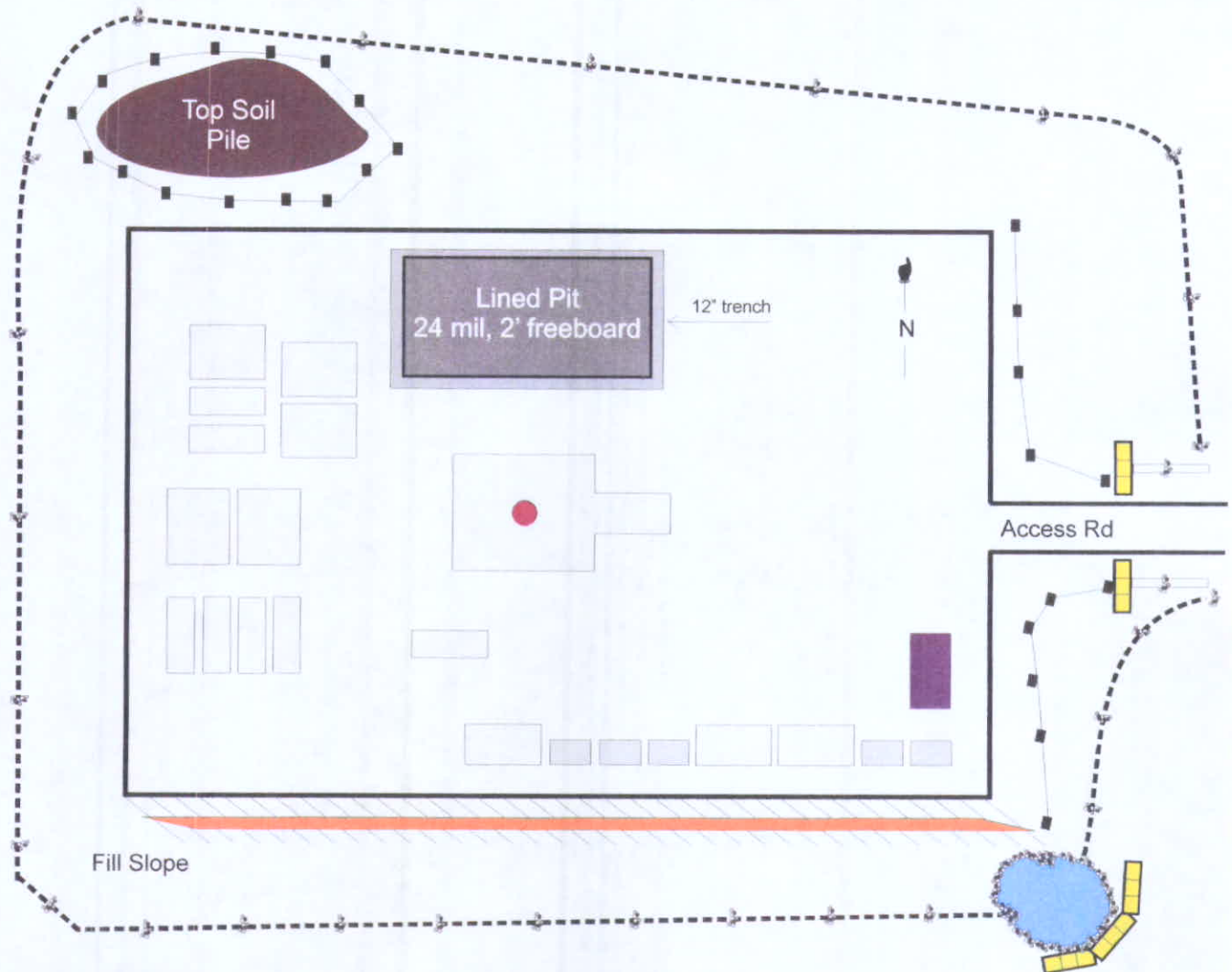

- |                         |                             |
|-------------------------|-----------------------------|
| ----- Clear Water Ditch | Wattle or Excelsior Log     |
| Straw Bale              | Silt Fence                  |
| Rock Check Dam          | Bar Ditch w/ Rock Check Dam |
| Holding Pond            |                             |
| Trash Bin               |                             |
- Legend**

# GAS WELL LOCATION RECEIVED

APR 06 2010

COGCC

SG INTERESTS 1, LTD.

VOLK 12-89-21 #1

1454' FNL & 2554' FWL

LOCATED IN S. 21, T. 12 S., R. 89 W., 6th P.M.

GUNNISON COUNTY, COLORADO

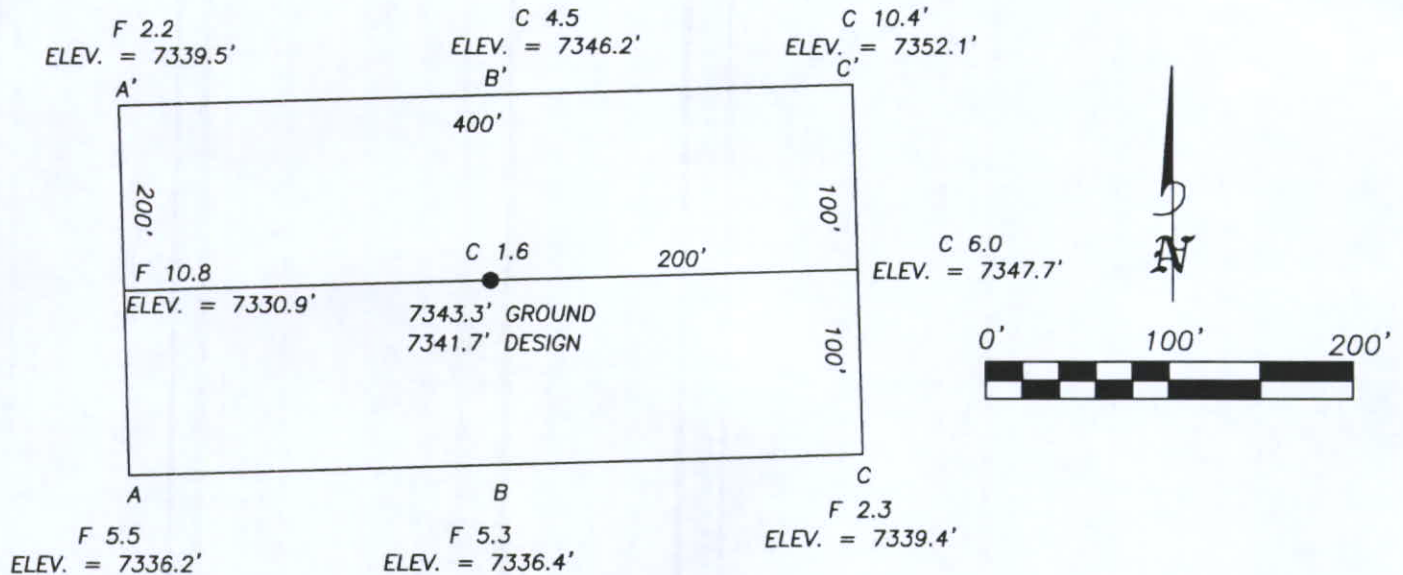

A-A'

Vert: 1" = 30' Horiz.: 1" = 50'

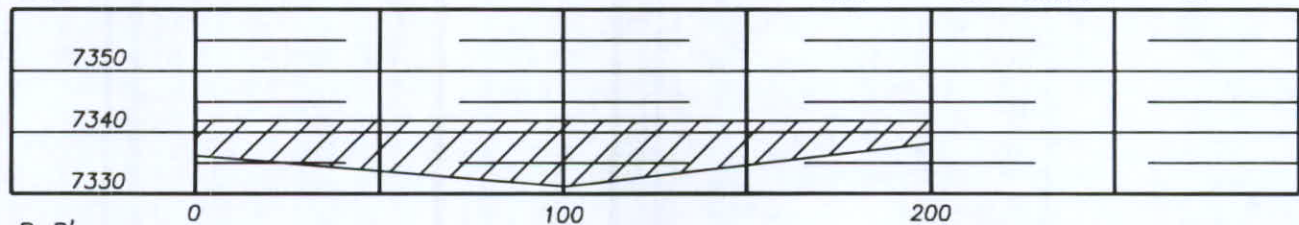

B-B'

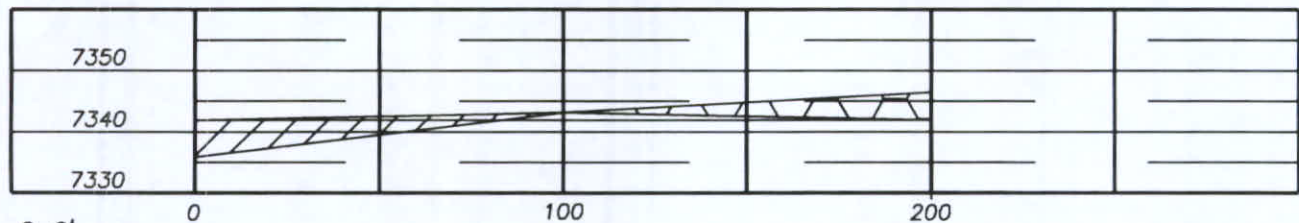

C-C'

