

WELL PAD E22 697
SECTION 22, T6S, R97W, 6th P.M.
SW 1/4 NW 1/4

60' 30' 0' 30' 60'

SCALE

Sheet 2 of 12

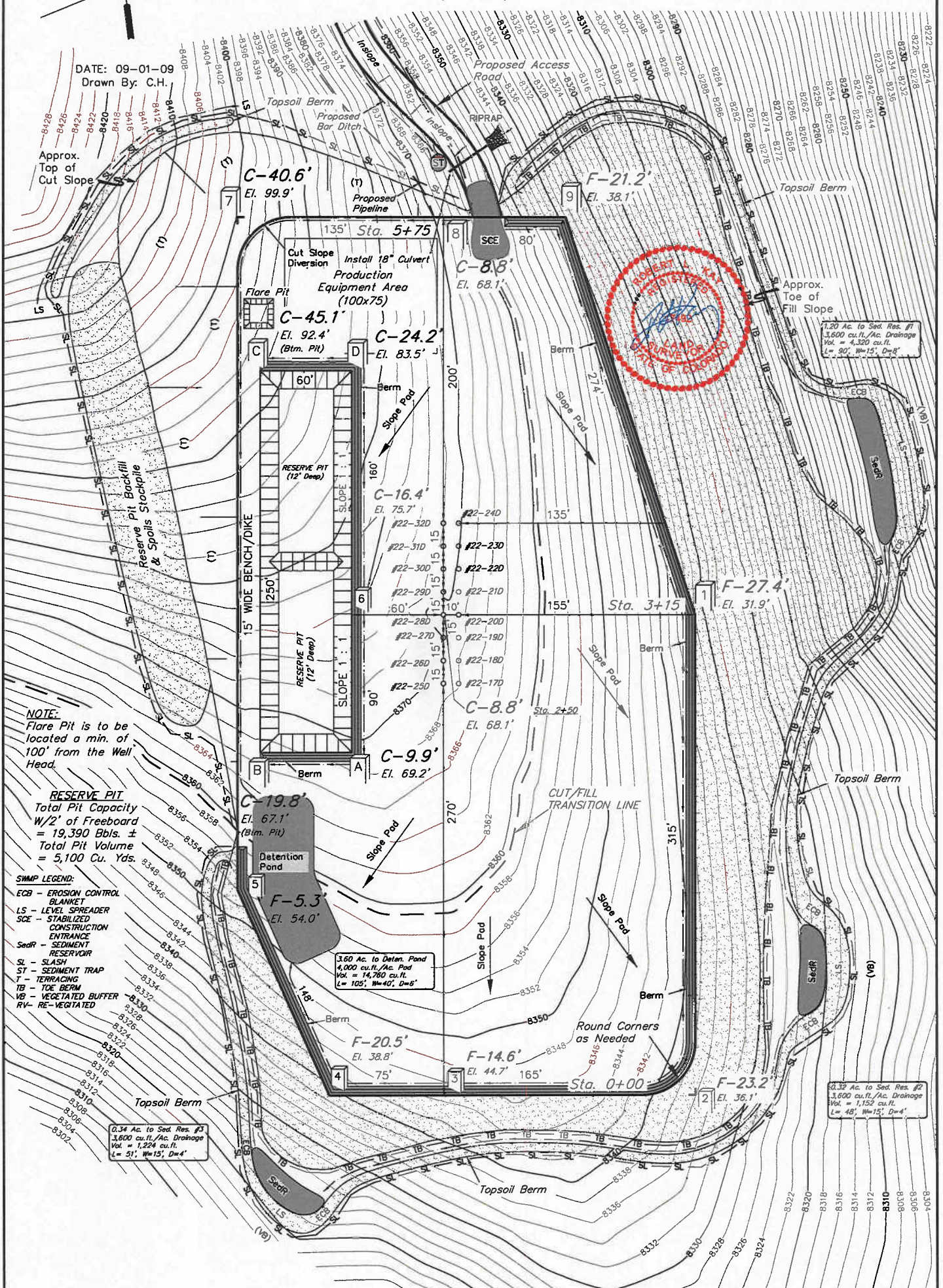

Elev. Ungraded Ground At #22-28D Loc. Stake = 8368.1'
FINISHED GRADE ELEV. AT #22-28D LOC. STAKE = 8359.3'

UINTAH ENGINEERING & LAND SURVEYING
85 So. 200 East * Vernal, Utah 84078 * (435) 789-1017