

R. 98 W.

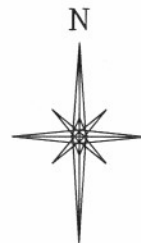

SCALE 1" = 1000'

T. 1 S.

NOTES

HIGH PLATEAU DESERT
NO EXISTING FEATURES WITHIN
400' RADIUS OF WELL SITE.

GPS OPERATOR MARK BESSIE
OBSERVED A PDOP OF 2.4.
ALL GPS OBSERVATIONS ARE IN
COMPLIANCE WITH COGCC RULE No.215.

FEDERAL RGU

331-25-198

UNGRADED ELEVATION:

6640.6'

BASIS OF ELEVATION: USGS SPOT
ELEVATION LOCATED AT THE NW
CORNER SECTION 25, T1S, R98W,
ELEVATION: 6568'

25

BHL

LATITUDE (NAD 83)

NORTH 39.940008 DEG.

LONGITUDE (NAD 83)

WEST 108.340053 DEG.

LATITUDE (NAD 27)

NORTH 39.940036 DEG.

LONGITUDE (NAD 27)

WEST 108.339408 DEG.

NORTHING

233746

EASTING

1203945

LATITUDE (NAD 83)

NORTH 39.940819 DEG.

LONGITUDE (NAD 83)

WEST 108.340184 DEG.

LATITUDE (NAD 27)

NORTH 39.940847 DEG.

LONGITUDE (NAD 27)

WEST 108.339539 DEG.

NORTHING

234041.95

EASTING

1203918.18

BASIS OF BEARING/DATUM

SPCS CO NORTH NAD 27

BASED ON NGS TRIANGULATION
STATION "BINER"

1000 500 0 1000 2000

SCALE FEET

SURVEYOR'S STATEMENT

I, CLEMENT R. WILLIAMS, OF ROCK SPRINGS, WYOMING, HEREBY STATE: THIS MAP WAS MADE FROM NOTES TAKEN DURING AN ACTUAL FIELD SURVEY DONE UNDER MY DIRECT SUPERVISION ON OCTOBER 8, 2008 AND THAT THIS PLAT CORRECTLY SHOWS THE LOCATION OF FEDERAL RGU 331-25-198 AS STAKED ON THE GROUND.

LEGEND

- ◆ WELL LOCATION
- BOTTOM HOLE LOC. (APPROX)
- FOUND MONUMENT
- ▲ PREVIOUSLY FOUND MONUMENT

FEDERAL RGU 31-25-198 PAD

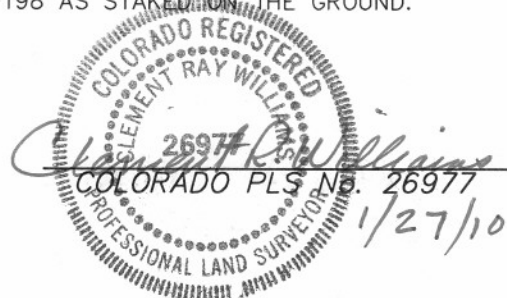

RIFFIN & ASSOCIATES, INC.

(307) 362-5028

1414 ELK ST., ROCK SPRINGS, WY 82901

DRAWN: 1/27/09 - MMM

SCALE: 1" = 1000'

REVISED: 1/26/10 - MMM

DRG JOB No. 17148

REVISED BHL

EXHIBIT 1

**PLAT OF DRILLING LOCATION
FOR
WILLIAMS PRODUCTION RMT COMPANY**

**288' F/NL & 1945' F/EL, SECTION 25,
T. 1 S., R. 98 W., 6th P.M.
RIO BLANCO COUNTY, COLORADO**