

WELL DETAILS: 697-26A-16						
GL 8400' & RKB 24' @ 8424.00ft (H&P 324)8400.00						
+N/-S	+E/-W	Northing	Easting	Latitude	Longitude	Slot
0.00	0.00	1617746.81	2242991.13	39° 29' 55.687 N	108° 10' 58.866 W	D

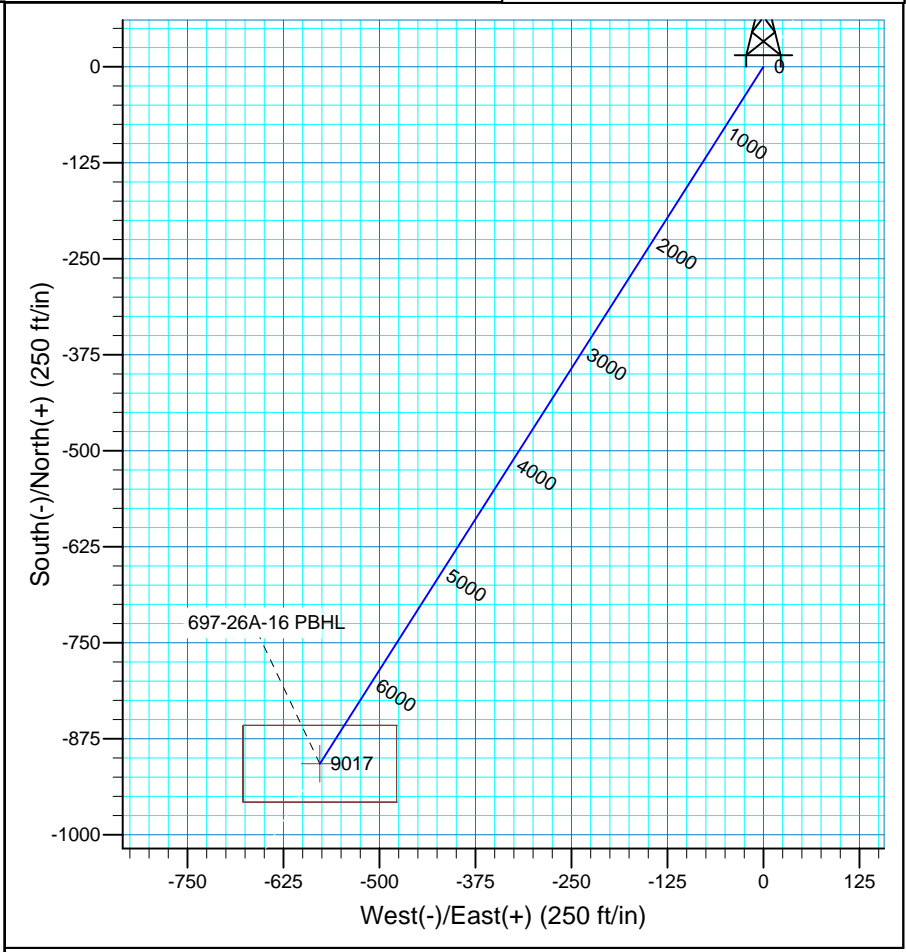

FORMATION TOP DETAILS			Plan: Plan #1 (697-26A-16/OH)
TVDPPath 5939.00 8841.00	MDPath 6017.05 8929.69	Formation Mesaverde Rollins	Created By: Rex Hall Date: 2010-02-10
			PROJECT DETAILS: Garfield County, CO NAD 83
			Geodetic System: US State Plane 1983 Datum: North American Datum 1983 Ellipsoid: GRS 1980 Zone: Colorado Central Zone System Datum: Mean Sea Level Local North: True

SECTION DETAILS										
Sec	MD	Inc	Azi	TVD	+N/-S	+E/-W	DLeg	TFace	VSec	Target
1	0.00	0.00	0.00	0.00	0.00	0.00	0.00	0.00	0.00	
2	200.00	0.00	0.00	200.00	0.00	0.00	0.00	0.00	0.00	
3	683.42	9.67	212.48	681.13	-34.33	-21.85	2.00	212.48	40.69	
4	6605.27	9.67	212.48	6518.87	-873.29	-555.97	0.00	0.00	1035.24	
5	7088.69	0.00	0.00	7000.00	-907.61	-577.82	2.00	180.00	1075.93	
6	9105.69	0.00	0.00	9017.00	-907.61	-577.82	0.00	0.00	1075.93	697-26A-16 PBHL

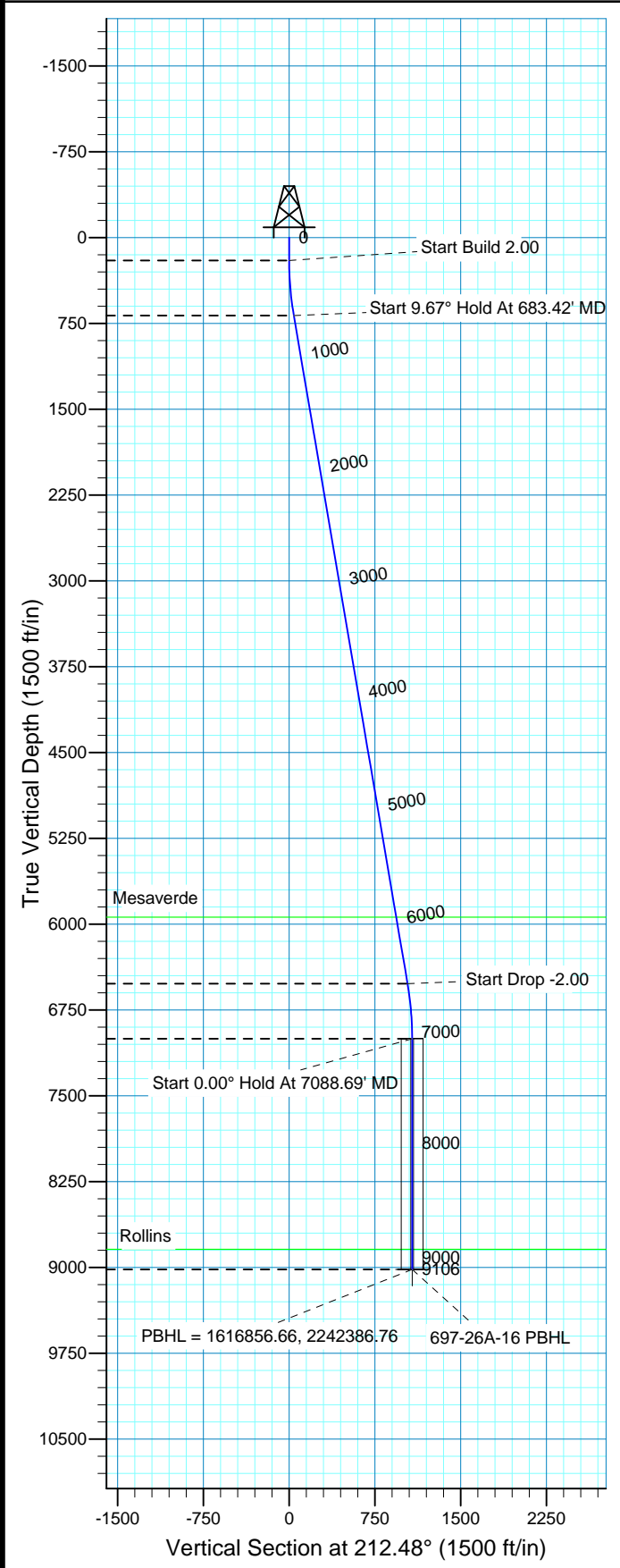

Marathon Oil Co.

Garfield County, CO NAD 83

697-26A Pad

697-26A-16 - Slot D

OH

Plan: Plan #1

Standard Planning Report

10 February, 2010



Database:	EDM 2003.16 Multi-User Db	Local Co-ordinate Reference:	Well 697-26A-16 - Slot D
Company:	Marathon Oil Co.	TVD Reference:	GL 8400' & RKB 24' @ 8424.00ft (H&P 324)
Project:	Garfield County, CO NAD 83	MD Reference:	GL 8400' & RKB 24' @ 8424.00ft (H&P 324)
Site:	697-26A Pad	North Reference:	True
Well:	697-26A-16	Survey Calculation Method:	Minimum Curvature
Wellbore:	OH		
Design:	Plan #1		

Project	Garfield County, CO NAD 83		
Map System:	US State Plane 1983	System Datum:	Mean Sea Level
Geo Datum:	North American Datum 1983		
Map Zone:	Colorado Central Zone		

Site	697-26A Pad, Sec 26 T6S R97W			
Site Position:		Northing:	1,617,794.11 ft	Latitude: 39° 29' 56.147 N
From: Map		Easting:	2,242,966.23 ft	Longitude: 108° 10' 59.202 W
Position Uncertainty:	0.00 ft	Slot Radius:	in	Grid Convergence: -1.69 °

Well	697-26A-16 - Slot D, 888' FNL & 1400' FWL			
Well Position	+N/-S	0.00 ft	Northing:	1,617,746.81 ft
	+E/-W	0.00 ft	Easting:	2,242,991.13 ft
Position Uncertainty	0.00 ft		Wellhead Elevation:	ft
			Ground Level:	8,400.00 ft

Wellbore	OH				
Magnetics	Model Name	Sample Date	Declination (°)	Dip Angle (°)	Field Strength (nT)
	IGRF200510	12/31/2009	10.60	65.76	52,382

Design	Plan #1			
Audit Notes:				
Version:	Phase:	PLAN	Tie On Depth:	0.00
Vertical Section:	Depth From (TVD) (ft)	+N/-S (ft)	+E/-W (ft)	Direction (°)
	0.00	0.00	0.00	212.48

Plan Sections										
Measured Depth (ft)	Inclination (°)	Azimuth (°)	Vertical Depth (ft)	+N/-S (ft)	+E/-W (ft)	Dogleg Rate (°/100ft)	Build Rate (°/100ft)	Turn Rate (°/100ft)	TFO (°)	Target
0.00	0.00	0.00	0.00	0.00	0.00	0.00	0.00	0.00	0.00	
200.00	0.00	0.00	200.00	0.00	0.00	0.00	0.00	0.00	0.00	
683.42	9.67	212.48	681.13	-34.33	-21.85	2.00	2.00	0.00	212.48	
6,605.27	9.67	212.48	6,518.87	-873.29	-555.97	0.00	0.00	0.00	0.00	
7,088.69	0.00	0.00	7,000.00	-907.61	-577.82	2.00	-2.00	0.00	180.00	
9,105.69	0.00	0.00	9,017.00	-907.61	-577.82	0.00	0.00	0.00	0.00	697-26A-16 PBHL

Database:	EDM 2003.16 Multi-User Db	Local Co-ordinate Reference:	Well 697-26A-16 - Slot D
Company:	Marathon Oil Co.	TVD Reference:	GL 8400' & RKB 24' @ 8424.00ft (H&P 324)
Project:	Garfield County, CO NAD 83	MD Reference:	GL 8400' & RKB 24' @ 8424.00ft (H&P 324)
Site:	697-26A Pad	North Reference:	True
Well:	697-26A-16	Survey Calculation Method:	Minimum Curvature
Wellbore:	OH		
Design:	Plan #1		

Planned Survey

Measured Depth (ft)	Inclination (°)	Azimuth (°)	Vertical Depth (ft)	+N/-S (ft)	+E/-W (ft)	Vertical Section (ft)	Dogleg Rate (°/100ft)	Build Rate (°/100ft)	Turn Rate (°/100ft)
0.00	0.00	0.00	0.00	0.00	0.00	0.00	0.00	0.00	0.00
100.00	0.00	0.00	100.00	0.00	0.00	0.00	0.00	0.00	0.00
200.00	0.00	0.00	200.00	0.00	0.00	0.00	0.00	0.00	0.00
Start Build 2.00									
300.00	2.00	212.48	299.98	-1.47	-0.94	1.75	2.00	2.00	0.00
400.00	4.00	212.48	399.84	-5.89	-3.75	6.98	2.00	2.00	0.00
500.00	6.00	212.48	499.45	-13.24	-8.43	15.69	2.00	2.00	0.00
600.00	8.00	212.48	598.70	-23.52	-14.97	27.88	2.00	2.00	0.00
683.42	9.67	212.48	681.13	-34.33	-21.85	40.69	2.00	2.00	0.00
Start 9.67° Hold At 683.42' MD									
700.00	9.67	212.48	697.47	-36.67	-23.35	43.48	0.00	0.00	0.00
800.00	9.67	212.48	796.05	-50.84	-32.37	60.27	0.00	0.00	0.00
900.00	9.67	212.48	894.63	-65.01	-41.39	77.06	0.00	0.00	0.00
1,000.00	9.67	212.48	993.21	-79.18	-50.41	93.86	0.00	0.00	0.00
1,100.00	9.67	212.48	1,091.79	-93.34	-59.43	110.65	0.00	0.00	0.00
1,200.00	9.67	212.48	1,190.37	-107.51	-68.45	127.45	0.00	0.00	0.00
1,300.00	9.67	212.48	1,288.95	-121.68	-77.46	144.24	0.00	0.00	0.00
1,400.00	9.67	212.48	1,387.53	-135.84	-86.48	161.04	0.00	0.00	0.00
1,500.00	9.67	212.48	1,486.11	-150.01	-95.50	177.83	0.00	0.00	0.00
1,600.00	9.67	212.48	1,584.69	-164.18	-104.52	194.63	0.00	0.00	0.00
1,700.00	9.67	212.48	1,683.27	-178.35	-113.54	211.42	0.00	0.00	0.00
1,800.00	9.67	212.48	1,781.85	-192.51	-122.56	228.22	0.00	0.00	0.00
1,900.00	9.67	212.48	1,880.43	-206.68	-131.58	245.01	0.00	0.00	0.00
2,000.00	9.67	212.48	1,979.01	-220.85	-140.60	261.81	0.00	0.00	0.00
2,100.00	9.67	212.48	2,077.59	-235.01	-149.62	278.60	0.00	0.00	0.00
2,200.00	9.67	212.48	2,176.17	-249.18	-158.64	295.39	0.00	0.00	0.00
2,300.00	9.67	212.48	2,274.75	-263.35	-167.66	312.19	0.00	0.00	0.00
2,400.00	9.67	212.48	2,373.33	-277.52	-176.68	328.98	0.00	0.00	0.00
2,500.00	9.67	212.48	2,471.91	-291.68	-185.70	345.78	0.00	0.00	0.00
2,600.00	9.67	212.48	2,570.49	-305.85	-194.72	362.57	0.00	0.00	0.00
2,700.00	9.67	212.48	2,669.07	-320.02	-203.74	379.37	0.00	0.00	0.00
2,800.00	9.67	212.48	2,767.65	-334.18	-212.76	396.16	0.00	0.00	0.00
2,900.00	9.67	212.48	2,866.23	-348.35	-221.78	412.96	0.00	0.00	0.00
3,000.00	9.67	212.48	2,964.80	-362.52	-230.79	429.75	0.00	0.00	0.00
3,100.00	9.67	212.48	3,063.38	-376.69	-239.81	446.55	0.00	0.00	0.00
3,200.00	9.67	212.48	3,161.96	-390.85	-248.83	463.34	0.00	0.00	0.00
3,300.00	9.67	212.48	3,260.54	-405.02	-257.85	480.14	0.00	0.00	0.00
3,400.00	9.67	212.48	3,359.12	-419.19	-266.87	496.93	0.00	0.00	0.00
3,500.00	9.67	212.48	3,457.70	-433.36	-275.89	513.72	0.00	0.00	0.00
3,600.00	9.67	212.48	3,556.28	-447.52	-284.91	530.52	0.00	0.00	0.00
3,700.00	9.67	212.48	3,654.86	-461.69	-293.93	547.31	0.00	0.00	0.00
3,800.00	9.67	212.48	3,753.44	-475.86	-302.95	564.11	0.00	0.00	0.00
3,900.00	9.67	212.48	3,852.02	-490.02	-311.97	580.90	0.00	0.00	0.00
4,000.00	9.67	212.48	3,950.60	-504.19	-320.99	597.70	0.00	0.00	0.00
4,100.00	9.67	212.48	4,049.18	-518.36	-330.01	614.49	0.00	0.00	0.00
4,200.00	9.67	212.48	4,147.76	-532.53	-339.03	631.29	0.00	0.00	0.00
4,300.00	9.67	212.48	4,246.34	-546.69	-348.05	648.08	0.00	0.00	0.00
4,400.00	9.67	212.48	4,344.92	-560.86	-357.07	664.88	0.00	0.00	0.00
4,500.00	9.67	212.48	4,443.50	-575.03	-366.09	681.67	0.00	0.00	0.00
4,600.00	9.67	212.48	4,542.08	-589.19	-375.11	698.47	0.00	0.00	0.00
4,700.00	9.67	212.48	4,640.66	-603.36	-384.12	715.26	0.00	0.00	0.00
4,800.00	9.67	212.48	4,739.24	-617.53	-393.14	732.05	0.00	0.00	0.00
4,900.00	9.67	212.48	4,837.82	-631.70	-402.16	748.85	0.00	0.00	0.00

Database: EDM 2003.16 Multi-User Db
Company: Marathon Oil Co.
Project: Garfield County, CO NAD 83
Site: 697-26A Pad
Well: 697-26A-16
Wellbore: OH
Design: Plan #1

Local Co-ordinate Reference: Well 697-26A-16 - Slot D
TVD Reference: GL 8400' & RKB 24' @ 8424.00ft (H&P 324)
MD Reference: GL 8400' & RKB 24' @ 8424.00ft (H&P 324)
North Reference: True
Survey Calculation Method: Minimum Curvature

Planned Survey

Measured Depth (ft)	Inclination (°)	Azimuth (°)	Vertical Depth (ft)	+N/-S (ft)	+E/-W (ft)	Vertical Section (ft)	Dogleg Rate (°/100ft)	Build Rate (°/100ft)	Turn Rate (°/100ft)
5,000.00	9.67	212.48	4,936.40	-645.86	-411.18	765.64	0.00	0.00	0.00
5,100.00	9.67	212.48	5,034.98	-660.03	-420.20	782.44	0.00	0.00	0.00
5,200.00	9.67	212.48	5,133.56	-674.20	-429.22	799.23	0.00	0.00	0.00
5,300.00	9.67	212.48	5,232.14	-688.36	-438.24	816.03	0.00	0.00	0.00
5,400.00	9.67	212.48	5,330.72	-702.53	-447.26	832.82	0.00	0.00	0.00
5,500.00	9.67	212.48	5,429.30	-716.70	-456.28	849.62	0.00	0.00	0.00
5,600.00	9.67	212.48	5,527.87	-730.87	-465.30	866.41	0.00	0.00	0.00
5,700.00	9.67	212.48	5,626.45	-745.03	-474.32	883.21	0.00	0.00	0.00
5,800.00	9.67	212.48	5,725.03	-759.20	-483.34	900.00	0.00	0.00	0.00
5,900.00	9.67	212.48	5,823.61	-773.37	-492.36	916.80	0.00	0.00	0.00
6,000.00	9.67	212.48	5,922.19	-787.53	-501.38	933.59	0.00	0.00	0.00
6,017.05	9.67	212.48	5,939.00	-789.95	-502.91	936.45	0.00	0.00	0.00
Mesaverde									
6,100.00	9.67	212.48	6,020.77	-801.70	-510.40	950.38	0.00	0.00	0.00
6,200.00	9.67	212.48	6,119.35	-815.87	-519.42	967.18	0.00	0.00	0.00
6,300.00	9.67	212.48	6,217.93	-830.04	-528.44	983.97	0.00	0.00	0.00
6,400.00	9.67	212.48	6,316.51	-844.20	-537.45	1,000.77	0.00	0.00	0.00
6,500.00	9.67	212.48	6,415.09	-858.37	-546.47	1,017.56	0.00	0.00	0.00
6,600.00	9.67	212.48	6,513.67	-872.54	-555.49	1,034.36	0.00	0.00	0.00
6,605.27	9.67	212.48	6,518.87	-873.29	-555.97	1,035.24	0.00	0.00	0.00
Start Drop -2.00									
6,700.00	7.77	212.48	6,612.50	-885.40	-563.68	1,049.61	2.00	-2.00	0.00
6,800.00	5.77	212.48	6,711.79	-895.35	-570.02	1,061.40	2.00	-2.00	0.00
6,900.00	3.77	212.48	6,811.44	-902.37	-574.49	1,069.72	2.00	-2.00	0.00
7,000.00	1.77	212.48	6,911.32	-906.45	-577.08	1,074.56	2.00	-2.00	0.00
7,088.69	0.00	0.00	7,000.00	-907.61	-577.82	1,075.93	2.00	-2.00	0.00
Start 0.00° Hold At 7088.69' MD									
7,100.00	0.00	0.00	7,011.31	-907.61	-577.82	1,075.93	0.00	0.00	0.00
7,200.00	0.00	0.00	7,111.31	-907.61	-577.82	1,075.93	0.00	0.00	0.00
7,300.00	0.00	0.00	7,211.31	-907.61	-577.82	1,075.93	0.00	0.00	0.00
7,400.00	0.00	0.00	7,311.31	-907.61	-577.82	1,075.93	0.00	0.00	0.00
7,500.00	0.00	0.00	7,411.31	-907.61	-577.82	1,075.93	0.00	0.00	0.00
7,600.00	0.00	0.00	7,511.31	-907.61	-577.82	1,075.93	0.00	0.00	0.00
7,700.00	0.00	0.00	7,611.31	-907.61	-577.82	1,075.93	0.00	0.00	0.00
7,800.00	0.00	0.00	7,711.31	-907.61	-577.82	1,075.93	0.00	0.00	0.00
7,900.00	0.00	0.00	7,811.31	-907.61	-577.82	1,075.93	0.00	0.00	0.00
8,000.00	0.00	0.00	7,911.31	-907.61	-577.82	1,075.93	0.00	0.00	0.00
8,100.00	0.00	0.00	8,011.31	-907.61	-577.82	1,075.93	0.00	0.00	0.00
8,200.00	0.00	0.00	8,111.31	-907.61	-577.82	1,075.93	0.00	0.00	0.00
8,300.00	0.00	0.00	8,211.31	-907.61	-577.82	1,075.93	0.00	0.00	0.00
8,400.00	0.00	0.00	8,311.31	-907.61	-577.82	1,075.93	0.00	0.00	0.00
8,500.00	0.00	0.00	8,411.31	-907.61	-577.82	1,075.93	0.00	0.00	0.00
8,600.00	0.00	0.00	8,511.31	-907.61	-577.82	1,075.93	0.00	0.00	0.00
8,700.00	0.00	0.00	8,611.31	-907.61	-577.82	1,075.93	0.00	0.00	0.00
8,800.00	0.00	0.00	8,711.31	-907.61	-577.82	1,075.93	0.00	0.00	0.00
8,900.00	0.00	0.00	8,811.31	-907.61	-577.82	1,075.93	0.00	0.00	0.00
8,929.69	0.00	0.00	8,841.00	-907.61	-577.82	1,075.93	0.00	0.00	0.00
Rollins									
9,000.00	0.00	0.00	8,911.31	-907.61	-577.82	1,075.93	0.00	0.00	0.00
9,100.00	0.00	0.00	9,011.31	-907.61	-577.82	1,075.93	0.00	0.00	0.00
9,105.69	0.00	0.00	9,017.00	-907.61	-577.82	1,075.93	0.00	0.00	0.00
PBHL = 1616856.66, 2242386.76 - 697-26A-16 PBHL									

Database:	EDM 2003.16 Multi-User Db	Local Co-ordinate Reference:	Well 697-26A-16 - Slot D
Company:	Marathon Oil Co.	TVD Reference:	GL 8400' & RKB 24' @ 8424.00ft (H&P 324)
Project:	Garfield County, CO NAD 83	MD Reference:	GL 8400' & RKB 24' @ 8424.00ft (H&P 324)
Site:	697-26A Pad	North Reference:	True
Well:	697-26A-16	Survey Calculation Method:	Minimum Curvature
Wellbore:	OH		
Design:	Plan #1		

Targets									
Target Name									
- hit/miss target	Dip Angle	Dip Dir.	TVD	+N/-S	+E/-W	Northing	Easting	Latitude	Longitude
- Shape	(°)	(°)	(ft)	(ft)	(ft)	(ft)	(ft)		
697-26A-16 PBHL	0.00	0.00	9,017.00	-907.61	-577.82	1,616,856.66	2,242,386.76	39° 29' 46.716 N	108° 11' 6.238 W
- plan hits target center									
- Rectangle (sides W100.00 H200.00 D0.00)									

Formations						
Measured Depth	Vertical Depth					
(ft)	(ft)	Name	Lithology	Dip	Dip Direction	
				(°)	(°)	
6,017.05	5,939.00	Mesaverde		0.00		
8,929.69	8,841.00	Rollins		0.00		

Plan Annotations					
Measured Depth	Vertical Depth	Local Coordinates			
(ft)	(ft)	+N/-S	+E/-W		
		(ft)	(ft)	Comment	
200.00	200.00	0.00	0.00	Start Build 2.00	
683.42	681.13	-34.33	-21.85	Start 9.67° Hold At 683.42' MD	
6,605.27	6,518.87	-873.29	-555.97	Start Drop -2.00	
7,088.69	7,000.00	-907.61	-577.82	Start 0.00° Hold At 7088.69' MD	
9,105.69	9,017.00	-907.61	-577.82	PBHL = 1616856.66, 2242386.76	