

DALEY LAND SURVEYING, INC. 10727 FLAGLER DR. PARKER, CO. 80134

HYDROLOGY MAP ARENS G26-18D

SECTION 26, TOWNSHIP 4 NORTH, RANGE 65 WEST OF THE 6TH PRINCIPLE MERIDIAN

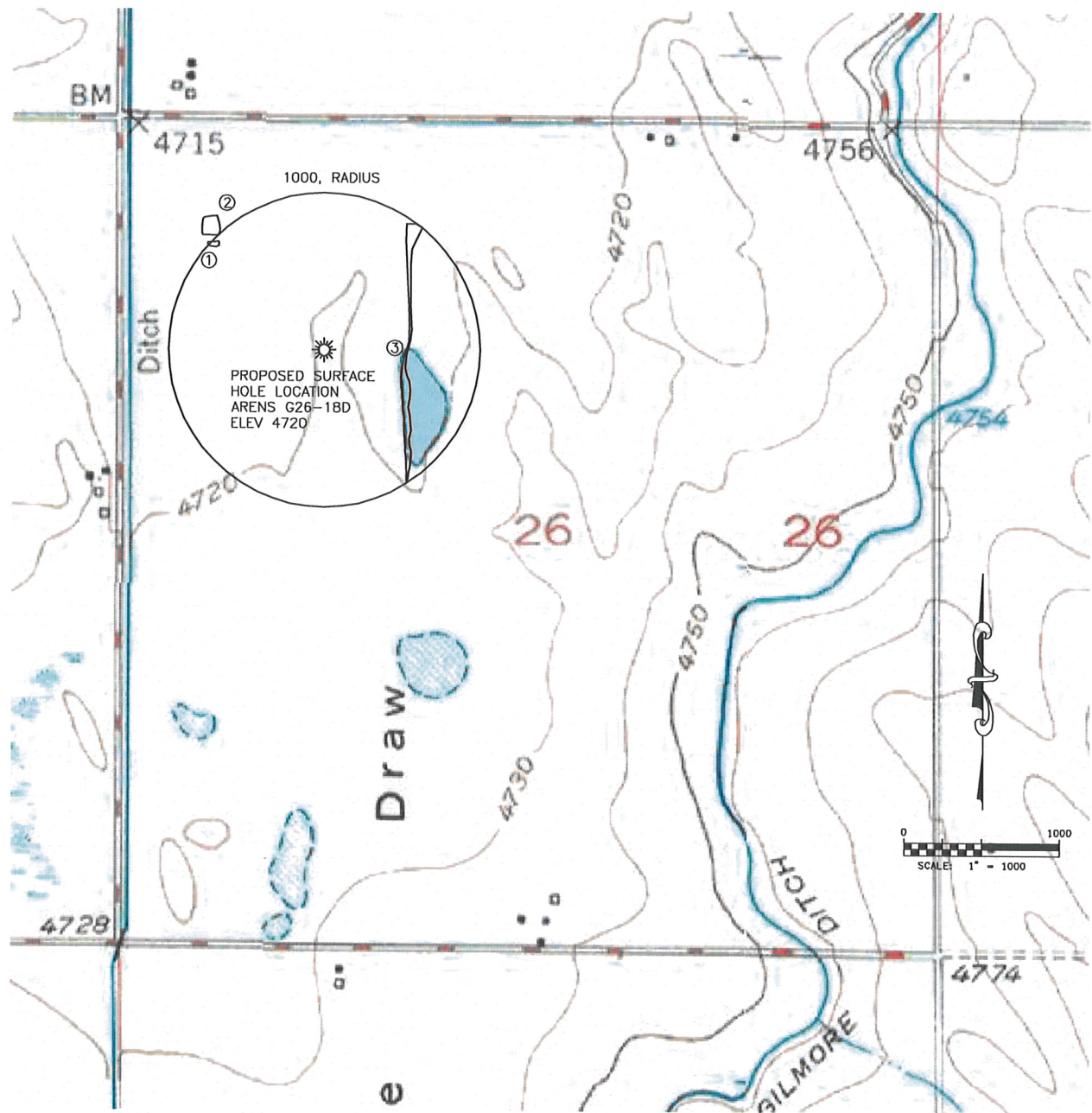

①
POND
949' - N46°07'W

②
POND
998' - N43°22'W

③
SURFACE WATER - SEEP
513' S78°37'E