

TABLE 1
SOIL SAMPLE ANALYTICAL RESULTS
GREAT WESTERN SUGAR NO. 1
WELD COUNTY
PETROLEUM DEVELOPMENT CORPORATION

Sample ID	Depth (ft bgs)	Date Sampled	Benzene (mg/kg)	Toluene (mg/kg)	Ethyl- benzene (mg/kg)	Xylenes (mg/kg)	TPH (mg/kg)
SB01		11/29/2007	NA	NA	NA	NA	70
Basic Standards for Soil			0.17	85	100	175	500

Notes: < - less than stated laboratory reporting limit

TPH - Total Petroleum Hydrocarbons (C6-C28)

API - American Petroleum Institute

Bold numbers indicate result equalled or exceeded standard.

Basic Standards for Soil are taken from 2 CCR 404-1, Table 910-1, Dec 2008.

NA - Not Analyzed

mg/kg - milligrams per kilogram

ft bgs - feet below ground surface



TABLE 2
GROUNDWATER ANALYTICAL AND FIELD RESULTS
GREAT WESTERN SUGAR NO. 1
WELD COUNTY
PETROLEUM DEVELOPMENT CORPORATION

Sample ID	Date Sampled	Benzene (ug/L)	Toluene (ug/L)	Ethyl-benzene (ug/L)	Xylenes (ug/L)	Depth to Water (ft btoc)
MW01	11/27/2007	9.6	110	50	560	9.80
	01/29/2008	34	3.2	10	140	NM
	04/17/2008	20	<1.0	8.7	370	12.22
	07/29/2008	3.0	<1.0	<1.0	430	7.91
	10/16/2008	12	<1.0	8.1	1300	7.93
	01/15/2009	1.5	<1.0	1.0	20	9.79
	04/21/2009	1.8	<1.0	1.1	12	10.07
	07/02/2009	<1.0	<1.0	<1.0	43	8.24
	10/21/2009	4.5	1.0	<1.0	87	8.23
MW02	01/29/2008	<1.0	<1.0	<1.0	<1.0	NM
	04/17/2008	<1.0	<1.0	<1.0	<1.0	13.48
	07/29/2008	<1.0	<1.0	<1.0	<1.0	9.31
	10/16/2008	<1.0	<1.0	<1.0	<1.0	9.20
	01/15/2009	<1.0	<1.0	<1.0	<1.0	11.18
	04/21/2009	<1.0	<1.0	<1.0	<1.0	11.48
	07/02/2009	<1.0	<1.0	<1.0	<1.0	9.72
	10/21/2009	<1.0	<1.0	<1.0	<1.0	9.53
MW03	01/29/2008	<1.0	<1.0	<1.0	<1.0	NM
	04/17/2008	<1.0	<1.0	<1.0	<1.0	12.96
	07/29/2008	<1.0	<1.0	<1.0	<1.0	8.95
	10/16/2008	<1.0	<1.0	<1.0	<1.0	8.79
	01/15/2009	<1.0	<1.0	<1.0	<1.0	10.79
	04/21/2009	<1.0	<1.0	<1.0	<1.0	11.08
	07/02/2009	<1.0	<1.0	<1.0	<1.0	9.27
	10/21/2009	<1.0	<1.0	<1.0	<1.0	9.23
MW04	01/29/2008	<1.0	<1.0	<1.0	<1.0	NM
	04/17/2008	<1.0	<1.0	<1.0	<1.0	12.50
	07/29/2008	<1.0	<1.0	<1.0	<1.0	8.84
	10/16/2008	<1.0	<1.0	<1.0	<1.0	8.84
	01/15/2009	<1.0	<1.0	<1.0	<1.0	10.74
	04/21/2009	<1.0	<1.0	<1.0	<1.0	11.02
	07/02/2009	2.1	<1.0	<1.0	<1.0	9.22
	10/21/2009	<1.0	<1.0	<1.0	<1.0	9.18



TABLE 2
GROUNDWATER ANALYTICAL AND FIELD RESULTS
GREAT WESTERN SUGAR NO. 1
WELD COUNTY
PETROLEUM DEVELOPMENT CORPORATION

Sample ID	Date Sampled	Benzene (ug/L)	Toluene (ug/L)	Ethyl-benzene (ug/L)	Xylenes (ug/L)	Depth to Water (ft btoc)
-----------	--------------	----------------	----------------	----------------------	----------------	--------------------------

Basic Standards for Groundwater:	5	560	700	1400		
---	----------	------------	------------	-------------	--	--

Notes: < - less than ug/L - micrograms per Liter NA - Not Analyzed/Not Available
ft btoc - feet below top of casing NM - Not measured API - American Petroleum Institute
Basic Standards for Groundwater are taken from the Colorado Department of Health and Environment (CDPHE) -
Water Quality Control Commission (WQCC) Regulation 41, May 2008
Bold numbers indicate result equaled or exceeded standard.



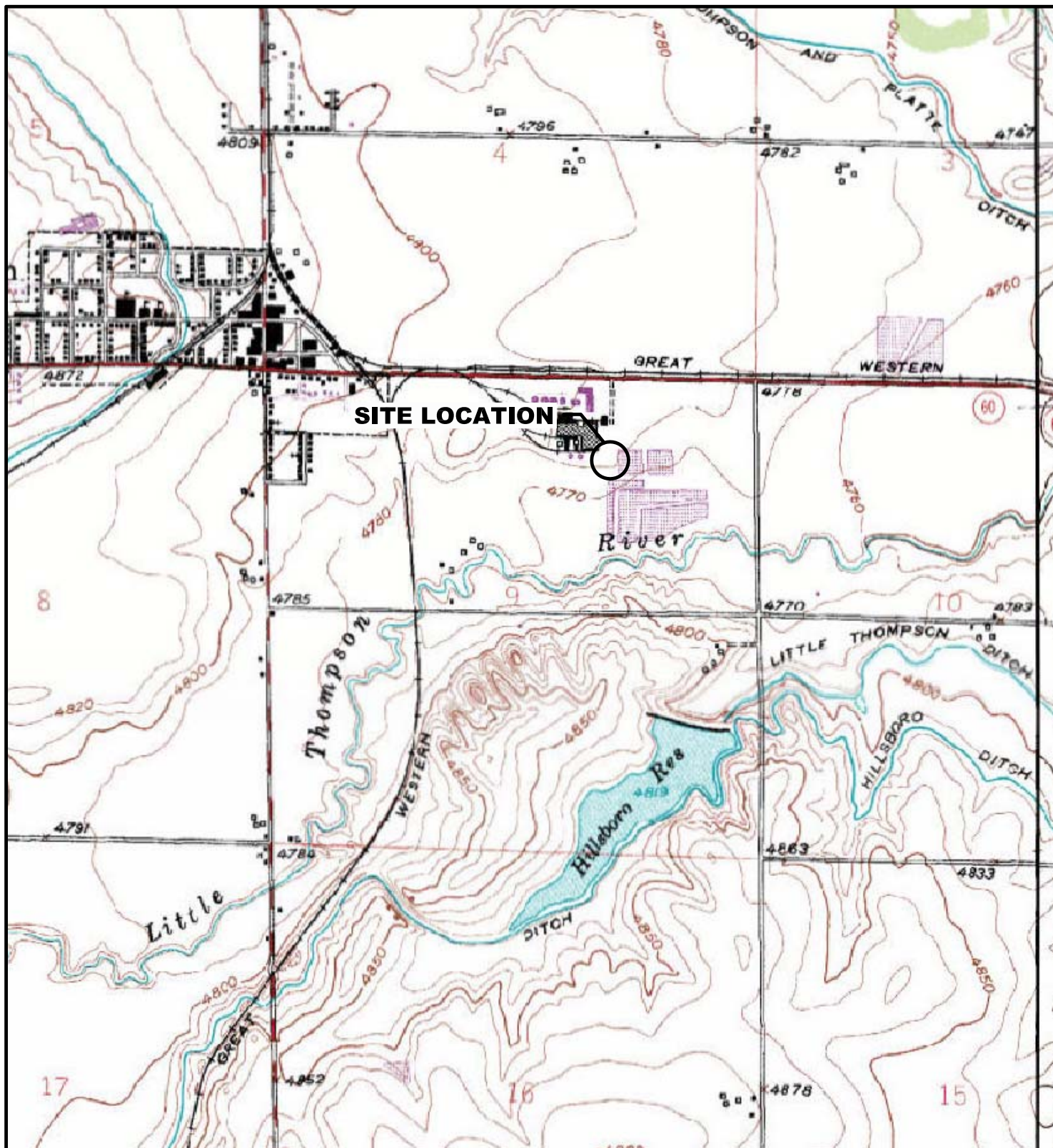

LEGEND

○ SITE LOCATION



0 375 750 1500
FEET

FIGURE 1
SITE LOCATION MAP
GREAT WESTERN SUGAR #1
NENE 9-T4N-R67W
WELD COUNTY, CO
PETROLEUM DEVELOPMENT CORPORATION

SOURCE: TOPOZONE.COM
USGS 7.5' QUADRANGLE
(NAD27)



PDC076001_sl 4/08

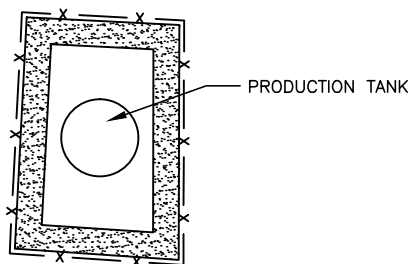

PRODUCTION TANK

LEASE ROAD

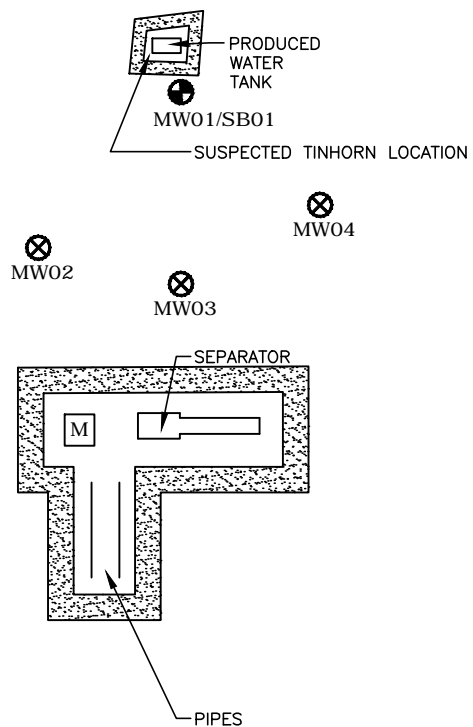

LEGEND

- MW01/SB01 MONITORING WELL AND SOIL BORING LOCATION
- MW02 MONITORING WELL LOCATION
- WELL HEAD
- METER HOUSE
- BERM
- FENCE
- ESTIMATED GROUNDWATER FLOW DIRECTION

NOTE:
SOIL SAMPLE SB01 WAS TAKEN FROM
THE SAME LOCATION AS MW01.

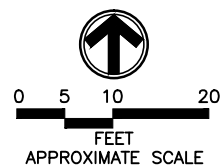

FIGURE 2
SITE MAP
GREAT WESTERN SUGAR #1
NENE 9-T4N-R67W
WELD COUNTY, CO
PETROLEUM DEVELOPMENT CORPORATION



Summit Scientific

741 Corporate Circle – Suite I ♦ Golden, Colorado 80401

303.277.9310 - laboratory ♦ 303.374.5933 - fax

November 28, 2007

John Cocroft

LT Environmental, Inc.

4600 West 60th Avenue

Arvada, CO 80003

RE: PDC - Great Western Sugar #1

Enclosed are the results of analyses for samples received by Summit Scientific on 11/27/07 17:00. If you have any questions concerning this report, please feel free to contact me.

Sincerely,

A handwritten signature in black ink, appearing to be 'BS' with a long, sweeping horizontal line extending to the right.

Ben Shrewsbury

Laboratory Director

LT Environmental, Inc.
4600 West 60th Avenue
Arvada CO, 80003

Project: PDC - Great Western Sugar #1

Project Number: PDC 0760
Project Manager: John Cocroft

Reported:
11/28/07 06:21

ANALYTICAL REPORT FOR SAMPLES

Sample ID	Laboratory ID	Matrix	Date Sampled	Date Received
MW01	R711107-01	Water	11/27/07 00:00	11/27/07 17:00

Summit Scientific
R711/07

741 Corporate Circle Suite I ♦ Golden, Colorado 80401
303-277-9310 ♦ 303-277-9531 Fax

Page (of)

LT Environmental, Inc.

Address: 4600 West 60th Avenue

ate/Zip: Arvada, CO 80003

(303) 433-9788

er Name: Matt Gar

2017/10/17

Project Manager: John Cocroft

E-Mail: icocroft@ltenv.com

Project Name: Great Western Sugar No. 1

Project Number: 00C0760

1	2	3	4	5	6	7	8	9	10	11	12	13	14	15	16	17	18	19	20	21	22	23	24	25	26	27	28	29	30	31	32	33	34	35	36	37	38	39	40	41	42	43	44	45	46	47	48	49	50	51	52	53	54	55	56	57	58	59	60	61	62	63	64	65	66	67	68	69	70	71	72	73	74	75	76	77	78	79	80	81	82	83	84	85	86	87	88	89	90	91	92	93	94	95	96	97	98	99	100
---	---	---	---	---	---	---	---	---	----	----	----	----	----	----	----	----	----	----	----	----	----	----	----	----	----	----	----	----	----	----	----	----	----	----	----	----	----	----	----	----	----	----	----	----	----	----	----	----	----	----	----	----	----	----	----	----	----	----	----	----	----	----	----	----	----	----	----	----	----	----	----	----	----	----	----	----	----	----	----	----	----	----	----	----	----	----	----	----	----	----	----	----	----	----	----	----	----	----	-----

[illegible]

www.s2scientific.com

Summit Scientific

The results in this report apply to the samples analyzed in accordance with the chain of custody document. This analytical report must be reproduced in its entirety.





LT Environmental, Inc.
4600 West 60th Avenue
Arvada CO, 80003

Project: PDC - Great Western Sugar #1
Project Number: PDC 0760
Project Manager: John Cocroft

Reported:
11/28/07 06:21

MW01
R711107-01 (Water)

Summit Scientific

Volatile Organic Compounds by EPA Method 8260B

Date Sampled: 11/27/07 00:00

Analyte	Result	Reporting		Units	Dilution	Batch	Prepared	Analyzed	Method	Notes
		Limit								
Benzene	9.6	1.0		ug/l	1	7112706	11/27/07	11/28/07	EPA 8260B	
Toluene	110	1.0		"	"	"	"	"	"	
Ethylbenzene	50	1.0		"	"	"	"	"	"	
Xylenes (total)	560	1.0		"	"	"	"	"	"	

Date Sampled: 11/27/07 00:00

Analyte	Result	Reporting		Units	Dilution	Batch	Prepared	Analyzed	Method	Notes
		Limit								
<i>Surrogate: 1,2-Dichloroethane-d4</i>		104 %		61.6-147		"	"	"	"	
<i>Surrogate: Toluene-d8</i>		106 %		89.3-110		"	"	"	"	
<i>Surrogate: 4-Bromofluorobenzene</i>		88.5 %		75.4-130		"	"	"	"	

Summit Scientific

The results in this report apply to the samples analyzed in accordance with the chain of custody document. This analytical report must be reproduced in its entirety.



LT Environmental, Inc.
4600 West 60th Avenue
Arvada CO, 80003

Project: PDC - Great Western Sugar #1
Project Number: PDC 0760
Project Manager: John Cocroft

Reported:
11/28/07 06:21

Volatile Organic Compounds by EPA Method 8260B - Quality Control

Summit Scientific

Analyte	Reporting			Spike	Source		%REC		RPD	
	Result	Limit	Units	Level	Result	%REC	Limits	RPD	Limit	Notes

Batch 7112706 - EPA 5030 Water MS

Blank (7112706-BLK1)

Prepared: 11/27/07 Analyzed: 11/28/07

Benzene	ND	1.0	ug/l							
Toluene	ND	1.0	"							
Ethylbenzene	ND	1.0	"							
Xylenes (total)	ND	1.0	"							
Surrogate: 1,2-Dichloroethane-d4	39.2		"	40.0		98.0	61.6-147			
Surrogate: Toluene-d8	39.4		"	40.0		98.5	89.3-110			
Surrogate: 4-Bromofluorobenzene	39.8		"	40.0		99.5	75.4-130			

LCS (7112706-BS1)

Prepared: 11/27/07 Analyzed: 11/28/07

Benzene	101	1.0	ug/l	100		101	60.5-95.9			
Toluene	99.5	1.0	"	100		99.5	58.3-99.4			
Surrogate: 1,2-Dichloroethane-d4	38.4		"	40.0		96.0	61.6-147			
Surrogate: Toluene-d8	39.4		"	40.0		98.5	89.3-110			
Surrogate: 4-Bromofluorobenzene	41.1		"	40.0		103	75.4-130			

LCS Dup (7112706-BSD1)

Prepared: 11/27/07 Analyzed: 11/28/07

Benzene	99.1	1.0	ug/l	100		99.1	60.5-95.9	1.90	15.6	
Toluene	100	1.0	"	100		100	58.3-99.4	0.501	18.1	
Surrogate: 1,2-Dichloroethane-d4	38.6		"	40.0		96.5	61.6-147			
Surrogate: Toluene-d8	40.3		"	40.0		101	89.3-110			
Surrogate: 4-Bromofluorobenzene	40.3		"	40.0		101	75.4-130			

Summit Scientific

The results in this report apply to the samples analyzed in accordance with the chain of custody document. This analytical report must be reproduced in its entirety.



LT Environmental, Inc.
4600 West 60th Avenue
Arvada CO, 80003

Project: PDC - Great Western Sugar #1

Project Number: PDC 0760
Project Manager: John Cocroft

Reported:
11/28/07 06:21

Notes and Definitions

DET Analyte DETECTED
ND Analyte NOT DETECTED at or above the reporting limit
NR Not Reported
dry Sample results reported on a dry weight basis
RPD Relative Percent Difference

A handwritten signature in black ink, appearing to be 'JMC'.

Summit Scientific

741 Corporate Circle – Suite I ♦ Golden, Colorado 80401

303.277.9310 - laboratory ♦ 303.374.5933 - fax

December 03, 2007

John Cocroft

LT Environmental, Inc.

4600 West 60th Avenue

Arvada, CO 80003

RE: PDC - Great Western Sugar #1

Enclosed are the results of analyses for samples received by Summit Scientific on 11/29/07 17:40. If you have any questions concerning this report, please feel free to contact me.

Sincerely,

A handwritten signature in black ink, appearing to be 'BS' or 'Shrewsbury', written in a cursive style.

Ben Shrewsbury

Laboratory Director

LT Environmental, Inc.
4600 West 60th Avenue
Arvada CO, 80003

Project: PDC - Great Western Sugar #1

Project Number: PDC 0760
Project Manager: John Cocroft

Reported:
12/03/07 17:58

ANALYTICAL REPORT FOR SAMPLES

Sample ID	Laboratory ID	Matrix	Date Sampled	Date Received
SBO1	R711120-01	Soil	11/29/07 08:30	11/29/07 17:40

Summit Scientific
271120
0
741 Cemento Cielo Suite 1A Golden Colorado 80401

741 Corporate Circle Suite I ♦ Golden, Colorado 80401
303-277-9310 ♦ 303-277-9531 Fax

Page 1 of 1

Client: LT Environmental, Inc.

Address: 4600 West 60th Avenue

City/State/Zip: Arvada, CO 80003

Phone: (303) 433-9788

Sampler Name: CANTON

Project Manager: John Cocroft

E-Mail: jcrocroft@ltenv.com

Project Name: GWS #1

Project Number: PDC 0760

[illegible]

www.s2scientific.com

Summit Scientific

The results in this report apply to the samples analyzed in accordance with the chain of custody document. This analytical report must be reproduced in its entirety.



LT Environmental, Inc.
4600 West 60th Avenue
Arvada CO, 80003

Project: PDC - Great Western Sugar #1
Project Number: PDC 0760
Project Manager: John Cocroft

Reported:
12/03/07 17:58

SBO1
R711120-01 (Soil)

Summit Scientific

Extractable Petroleum Hydrocarbons by 8015

Date Sampled: 11/29/07 08:30

Analyte	Result	Reporting Limit	Units	Dilution	Batch	Prepared	Analyzed	Method	Notes
C6-C10 (TEPH-GRO)	ND	50	mg/kg	1	7112904	11/29/07	11/30/07	8015 Full Carbon Chain	
C10-C28 (TEPH-DRO)	70	50	"	"	"	"	"	"	
C28-C36 (TEPH-ORO)	ND	50	"	"	"	"	"	"	

Date Sampled: 11/29/07 08:30

Analyte	Result	Reporting Limit	Units	Dilution	Batch	Prepared	Analyzed	Method	Notes
C6-C36 Total TEPH	70		"	"	[CALC]	"	"	EPA 8015	

Summit Scientific

The results in this report apply to the samples analyzed in accordance with the chain of custody document. This analytical report must be reproduced in its entirety.



LT Environmental, Inc.
4600 West 60th Avenue
Arvada CO, 80003

Project: PDC - Great Western Sugar #1
Project Number: PDC 0760
Project Manager: John Cocroft

Reported:
12/03/07 17:58

Extractable Petroleum Hydrocarbons by 8015 - Quality Control
Summit Scientific

Analyte	Reporting			Spike	Source		%REC		RPD	
	Result	Limit	Units	Level	Result	%REC	Limits	RPD	Limit	Notes

Batch 7112904 - EPA 3550A

Blank (7112904-BLK1)

Prepared & Analyzed: 11/29/07

C6-C10 (TEPH-GRO)	ND	50	mg/kg
C10-C28 (TEPH-DRO)	ND	50	"
C28-C36 (TEPH-ORO)	ND	50	"

LCS (7112904-BS1)

Prepared & Analyzed: 11/29/07

C10-C28 (TEPH-DRO)	466	50	mg/kg	500	93.2	65.3-142
--------------------	-----	----	-------	-----	------	----------

LCS Dup (7112904-BSD1)

Prepared & Analyzed: 11/29/07

C10-C28 (TEPH-DRO)	526	50	mg/kg	500	105	65.3-142	12.1	19.7
--------------------	-----	----	-------	-----	-----	----------	------	------

Matrix Spike (7112904-MS1)

Source: R711119-01

Prepared & Analyzed: 11/29/07

C10-C28 (TEPH-DRO)	897	50	mg/kg	500	370	105	55.2-139
--------------------	-----	----	-------	-----	-----	-----	----------

Matrix Spike Dup (7112904-MSD1)

Source: R711119-01

Prepared & Analyzed: 11/29/07

C10-C28 (TEPH-DRO)	765	50	mg/kg	500	370	79.0	55.2-139	15.9	16.7
--------------------	-----	----	-------	-----	-----	------	----------	------	------

Summit Scientific

The results in this report apply to the samples analyzed in accordance with the chain of custody document. This analytical report must be reproduced in its entirety.



LT Environmental, Inc.
4600 West 60th Avenue
Arvada CO, 80003

Project: PDC - Great Western Sugar #1
Project Number: PDC 0760
Project Manager: John Cocroft

Reported:
12/03/07 17:58

Notes and Definitions

DET Analyte DETECTED
ND Analyte NOT DETECTED at or above the reporting limit
NR Not Reported
dry Sample results reported on a dry weight basis
RPD Relative Percent Difference

A handwritten signature in black ink, appearing to be 'JMC'.

Summit Scientific

741 Corporate Circle – Suite I ♦ Golden, Colorado 80401

303.277.9310 - laboratory ♦ 303.374.5933 - fax

February 06, 2008

John Cocroft

LT Environmental, Inc.

4600 West 60th Avenue

Arvada, CO 80003

RE: PDC - Great Western Sugar #1

Enclosed are the results of analyses for samples received by Summit Scientific on 01/30/08 08:00. If you have any questions concerning this report, please feel free to contact me.

Sincerely,

A handwritten signature in black ink, appearing to be 'BS' or 'Shrewsbury', with a long, sweeping horizontal line extending to the right.

Ben Shrewsbury

Laboratory Director



LT Environmental, Inc.
4600 West 60th Avenue
Arvada CO, 80003

Project: PDC - Great Western Sugar #1

Project Number: PDC 0760
Project Manager: John Cocroft

Reported:
02/06/08 20:16

ANALYTICAL REPORT FOR SAMPLES

Sample ID	Laboratory ID	Matrix	Date Sampled	Date Received
MW01	R801115-01	Water	01/29/08 13:30	01/30/08 08:00
MW02	R801115-02	Water	01/29/08 13:35	01/30/08 08:00
MW03	R801115-03	Water	01/29/08 13:45	01/30/08 08:00
MW04	R801115-04	Water	01/29/08 13:55	01/30/08 08:00

Summit Scientific

The results in this report apply to the samples analyzed in accordance with the chain of custody document. This analytical report must be reproduced in its entirety.



LT Environmental, Inc.
4600 West 60th Avenue
Arvada CO, 80003

Project: PDC - Great Western Sugar #1

Project Number: PDC 0760
Project Manager: John Cocroft

Reported:
02/06/08 20:16

Summit Scientific R80115

741 Corporate Circle Suite 1 • Golden, Colorado 80401
303-277-9310 • 303-277-9531 Fax

LT Environmental, Inc.

Address: 4600 West 60th Avenue

City/Zip: Arvada, CO 80003

Phone: (303) 433-9788

Fax: (303) 433-1432

Project Name: Great Western Sugar No. 1

Project Number: PDC 0760

Project Manager: John Cocroft

E-Mail:

Project Name: Great Western Sugar No. 1

Project Number: PDC 0760

Sample Description	Date Sampled	Time Sampled	Number of Containers	Preservative				Matrix				Analyze For:				Special Instructions																	
				HCl	HNO ₃	None	Other (Specify)	Groundwater	Soil	Air - Canister Serial #	Other (Specify)	Total Carbon Chain	BTEX																				
WW01	1-29-08	1330	2	X				X								R80115																	
WW02	1-29-08	1335	2	X				X																									
WW03	1-29-08	1345	2	X				X																									
WW04	1-29-08	1355	2	X				X																									
Issued by: [Signature]				Date/Time: 1/29/08 1200				Received by: [Signature]				Date/Time: 1-30-08 8:00				Turn Around Time (Check)	Notes:																
Issued by: [Signature]				Date/Time: 1-29-08				Received by: [Signature]				Date/Time: 1-30-08 8:00				<input type="checkbox"/> Same Day <input type="checkbox"/> 24 Hours <input checked="" type="checkbox"/> 72 Hours <input type="checkbox"/> Standard																	
Issued by: [Signature]				Date/Time: 1/30/08				Received in Lab by: [Signature]				Date/Time: 1/30/08				Sample Integrity: Temperature Upon Receipt: <u>4.2</u> Intact: <input checked="" type="radio"/> Yes <input type="radio"/> No																	

www.s2scientific.com

Summit Scientific

The results in this report apply to the samples analyzed in accordance with the chain of custody document. This analytical report must be reproduced in its entirety.



LT Environmental, Inc.
4600 West 60th Avenue
Arvada CO, 80003

Project: PDC - Great Western Sugar #1
Project Number: PDC 0760
Project Manager: John Cocroft

Reported:
02/06/08 20:16

MW01
R801115-01 (Water)

Summit Scientific

Volatile Organic Compounds by EPA Method 8260B

Date Sampled: **01/29/08 13:30**

Analyte	Result	Reporting Limit	Units	Dilution	Batch	Prepared	Analyzed	Method	Notes
Benzene	34	1.0	ug/l	1	8020105	02/01/08	02/05/08	EPA 8260B	
Toluene	3.2	1.0	"	"	"	"	"	"	
Ethylbenzene	10	1.0	"	"	"	"	"	"	
Xylenes (total)	140	1.0	"	"	"	"	"	"	

Date Sampled: **01/29/08 13:30**

Analyte	Result	Reporting Limit	Units	Dilution	Batch	Prepared	Analyzed	Method	Notes
<i>Surrogate: 1,2-Dichloroethane-d4</i>		98.5 %	90.2-124		"	"	"	"	
<i>Surrogate: Toluene-d8</i>		109 %	92.1-106		"	"	"	"	S-04
<i>Surrogate: 4-Bromofluorobenzene</i>		95.5 %	84.5-110		"	"	"	"	

Summit Scientific

The results in this report apply to the samples analyzed in accordance with the chain of custody document. This analytical report must be reproduced in its entirety.



LT Environmental, Inc.
4600 West 60th Avenue
Arvada CO, 80003

Project: PDC - Great Western Sugar #1
Project Number: PDC 0760
Project Manager: John Cocroft

Reported:
02/06/08 20:16

MW02
R801115-02 (Water)

Summit Scientific

Volatile Organic Compounds by EPA Method 8260B

Date Sampled: **01/29/08 13:35**

Analyte	Result	Reporting	Units	Dilution	Batch	Prepared	Analyzed	Method	Notes
		Limit							
Benzene	ND	1.0	ug/l	1	8020105	02/01/08	02/05/08	EPA 8260B	
Toluene	ND	1.0	"	"	"	"	"	"	
Ethylbenzene	ND	1.0	"	"	"	"	"	"	
Xylenes (total)	ND	1.0	"	"	"	"	"	"	

Date Sampled: **01/29/08 13:35**

Analyte	Result	Reporting	Units	Dilution	Batch	Prepared	Analyzed	Method	Notes
		Limit							
Surrogate: 1,2-Dichloroethane-d4		101 %	90.2-124		"	"	"	"	
Surrogate: Toluene-d8		99.2 %	92.1-106		"	"	"	"	
Surrogate: 4-Bromofluorobenzene		97.0 %	84.5-110		"	"	"	"	

Summit Scientific

The results in this report apply to the samples analyzed in accordance with the chain of custody document. This analytical report must be reproduced in its entirety.



LT Environmental, Inc.
4600 West 60th Avenue
Arvada CO, 80003

Project: PDC - Great Western Sugar #1
Project Number: PDC 0760
Project Manager: John Cocroft

Reported:
02/06/08 20:16

MW03
R801115-03 (Water)

Summit Scientific

Volatile Organic Compounds by EPA Method 8260B

Date Sampled: **01/29/08 13:45**

Analyte	Result	Reporting		Units	Dilution	Batch	Prepared	Analyzed	Method	Notes
		Limit								
Benzene	ND	1.0		ug/l	1	8020105	02/01/08	02/05/08	EPA 8260B	
Toluene	ND	1.0		"	"	"	"	"	"	
Ethylbenzene	ND	1.0		"	"	"	"	"	"	
Xylenes (total)	ND	1.0		"	"	"	"	"	"	

Date Sampled: **01/29/08 13:45**

Analyte	Result	Reporting		Units	Dilution	Batch	Prepared	Analyzed	Method	Notes
		Limit								
Surrogate: 1,2-Dichloroethane-d4		100 %		90.2-124		"	"	"	"	
Surrogate: Toluene-d8		100 %		92.1-106		"	"	"	"	
Surrogate: 4-Bromofluorobenzene		101 %		84.5-110		"	"	"	"	

Summit Scientific

The results in this report apply to the samples analyzed in accordance with the chain of custody document. This analytical report must be reproduced in its entirety.



LT Environmental, Inc.
4600 West 60th Avenue
Arvada CO, 80003

Project: PDC - Great Western Sugar #1
Project Number: PDC 0760
Project Manager: John Cocroft

Reported:
02/06/08 20:16

MW04
R801115-04 (Water)

Summit Scientific

Volatile Organic Compounds by EPA Method 8260B

Date Sampled: **01/29/08 13:55**

Analyte	Result	Reporting		Units	Dilution	Batch	Prepared	Analyzed	Method	Notes
		Limit								
Benzene	ND	1.0		ug/l	1	8020105	02/01/08	02/05/08	EPA 8260B	
Toluene	ND	1.0		"	"	"	"	"	"	
Ethylbenzene	ND	1.0		"	"	"	"	"	"	
Xylenes (total)	ND	1.0		"	"	"	"	"	"	

Date Sampled: **01/29/08 13:55**

Analyte	Result	Reporting		Units	Dilution	Batch	Prepared	Analyzed	Method	Notes
		Limit								
Surrogate: 1,2-Dichloroethane-d4		98.5 %		90.2-124		"	"	"	"	
Surrogate: Toluene-d8		99.2 %		92.1-106		"	"	"	"	
Surrogate: 4-Bromofluorobenzene		88.7 %		84.5-110		"	"	"	"	

Summit Scientific

The results in this report apply to the samples analyzed in accordance with the chain of custody document. This analytical report must be reproduced in its entirety.



LT Environmental, Inc.
4600 West 60th Avenue
Arvada CO, 80003

Project: PDC - Great Western Sugar #1
Project Number: PDC 0760
Project Manager: John Cocroft

Reported:
02/06/08 20:16

Volatile Organic Compounds by EPA Method 8260B - Quality Control

Summit Scientific

Analyte	Reporting			Spike	Source		%REC		RPD	
	Result	Limit	Units	Level	Result	%REC	Limits	RPD	Limit	Notes

Batch 8020105 - EPA 5030 Water MS

Blank (8020105-BLK1)

Prepared: 02/01/08 Analyzed: 02/05/08

Benzene	ND	1.0	ug/l							
Toluene	ND	1.0	"							
Ethylbenzene	ND	1.0	"							
Xylenes (total)	ND	1.0	"							
Surrogate: 1,2-Dichloroethane-d4	13.3		"	13.3	100	90.2-124				
Surrogate: Toluene-d8	13.3		"	13.3	100	92.1-106				
Surrogate: 4-Bromofluorobenzene	13.3		"	13.3	100	84.5-110				

LCS (8020105-BS1)

Prepared: 02/01/08 Analyzed: 02/06/08

Benzene	25.5	1.0	ug/l	33.3	76.6	61.4-110				
Toluene	29.3	1.0	"	33.3	88.0	54.2-116				
Surrogate: 1,2-Dichloroethane-d4	12.8		"	13.3	96.2	90.2-124				
Surrogate: Toluene-d8	13.3		"	13.3	100	92.1-106				
Surrogate: 4-Bromofluorobenzene	13.3		"	13.3	100	84.5-110				

LCS Dup (8020105-BSD1)

Prepared: 02/01/08 Analyzed: 02/06/08

Benzene	23.8	1.0	ug/l	33.3	71.5	61.4-110	6.90	11.8		
Toluene	27.6	1.0	"	33.3	82.9	54.2-116	5.98	12.2		
Surrogate: 1,2-Dichloroethane-d4	13.1		"	13.3	98.5	90.2-124				
Surrogate: Toluene-d8	13.2		"	13.3	99.2	92.1-106				
Surrogate: 4-Bromofluorobenzene	13.3		"	13.3	100	84.5-110				

Summit Scientific

The results in this report apply to the samples analyzed in accordance with the chain of custody document. This analytical report must be reproduced in its entirety.



LT Environmental, Inc.
4600 West 60th Avenue
Arvada CO, 80003

Project: PDC - Great Western Sugar #1
Project Number: PDC 0760
Project Manager: John Cocroft

Reported:
02/06/08 20:16

Notes and Definitions

S-04 The surrogate recovery for this sample is outside of established control limits due to a sample matrix effect.

DET Analyte DETECTED

ND Analyte NOT DETECTED at or above the reporting limit

NR Not Reported

dry Sample results reported on a dry weight basis

RPD Relative Percent Difference

A handwritten signature in black ink, appearing to be 'J.M.' with a long, sweeping horizontal line extending to the right.

Summit Scientific

741 Corporate Circle – Suite I ♦ Golden, Colorado 80401

303.277.9310 - laboratory ♦ 303.277.9531 - fax

April 28, 2008

John Peterson

LT Environmental, Inc.

4600 West 60th Avenue

Arvada, CO 80003

RE: PDC - Great Western Sugar #1

Enclosed are the results of analyses for samples received by Summit Scientific on 04/18/08 16:00. If you have any questions concerning this report, please feel free to contact me.

Sincerely,

A handwritten signature in black ink, appearing to be 'BS' or 'Shrewsbury', written in a cursive style.

Ben Shrewsbury

Vice President / Laboratory Director



LT Environmental, Inc.
4600 West 60th Avenue
Arvada CO, 80003

Project: PDC - Great Western Sugar #1

Project Number: PDC 0760
Project Manager: John Peterson

Reported:
04/28/08 15:16

ANALYTICAL REPORT FOR SAMPLES

Sample ID	Laboratory ID	Matrix	Date Sampled	Date Received
MW01	R804136-01	Water	04/17/08 12:30	04/18/08 16:00
MW02	R804136-02	Water	04/17/08 12:40	04/18/08 16:00
MW03	R804136-03	Water	04/17/08 12:50	04/18/08 16:00
MW04	R804136-04	Water	04/17/08 13:00	04/18/08 16:00

Summit Scientific

The results in this report apply to the samples analyzed in accordance with the chain of custody document. This analytical report must be reproduced in its entirety.



LT Environmental, Inc.
4600 West 60th Avenue
Arvada CO, 80003

Project: PDC - Great Western Sugar #1

Project Number: PDC 0760
Project Manager: John Peterson

Reported:
04/28/08 15:16

Summit Scientific **2804036**

741 Corporate Circle Suite 1 ♦ Golden, Colorado 80401
303-277-9310 ♦ 303-277-9331 Fax

Client: LT Environmental, Inc.

Address: 4600 West 60th Avenue

City/State/Zip: Arvada, CO 80003

Phone: (303) 433-9788

Fax: (303) 433-1432

Sampler Name: **F44d**

Project Manager: **John Escott**

E-Mail: **jescott@ltenv.com**

Project Name: **Great Western Sugar #01**

Project Number: **PDC 0760**

Page **1** of **1**

Sample Description	Date Sampled	Time Sampled	Number of Containers	Preservative				Matrix			Analyze For:	Special Instructions
				HCl	HNO ₃	None	Other (Specify)	Groundwater	Soil	Air - Canister Serial #		
NW001	4-17-08	1230	2	X				X				
NW002	4-17-08	1240	2	X				X				
NW003	4-17-08	1250	2	X				X				
NW004	4-17-08	1300	2	X				X				
Notes:												
Relinquished by: [Signature] Date/Time: 4-17-08 1630				Received by: [Signature] Date/Time: 4/18/08 1600				Turn Around Time (Check) Same Day <input type="checkbox"/> 24 Hours <input type="checkbox"/> 48 Hours <input checked="" type="checkbox"/> 72 Hours <input type="checkbox"/> Standard <input type="checkbox"/>			Sample Integrity: Temperature Upon Receipt: 4.1 Intact: Yes <input checked="" type="checkbox"/> No <input type="checkbox"/>	
Relinquished by: [Signature] Date/Time: 4-17-08 16:00				Received by: [Signature] Date/Time: 4-17-08								
Relinquished by: [Signature] Date/Time: 4-17-08				Received in Lab by: [Signature] Date/Time: 4-17-08								

www.s2scientific.com

Summit Scientific

The results in this report apply to the samples analyzed in accordance with the chain of custody document. This analytical report must be reproduced in its entirety.



LT Environmental, Inc.
4600 West 60th Avenue
Arvada CO, 80003

Project: PDC - Great Western Sugar #1
Project Number: PDC 0760
Project Manager: John Peterson

Reported:
04/28/08 15:16

MW01
R804136-01 (Water)

Summit Scientific

Volatile Organic Compounds by EPA Method 8260B

Date Sampled: **04/17/08 12:30**

Analyte	Result	Reporting Limit	Units	Dilution	Batch	Prepared	Analyzed	Method	Notes
Benzene	20	1.0	ug/l	1	8042504	04/25/08	04/27/08	EPA 8260B	
Toluene	ND	1.0	"	"	"	"	"	"	
Ethylbenzene	8.7	1.0	"	"	"	"	"	"	
Xylenes (total)	370	1.0	"	"	"	"	"	"	

Date Sampled: **04/17/08 12:30**

Analyte	Result	Reporting Limit	Units	Dilution	Batch	Prepared	Analyzed	Method	Notes
<i>Surrogate: 1,2-Dichloroethane-d4</i>		<i>116 %</i>	<i>90.2-124</i>		"	"	"	"	
<i>Surrogate: Toluene-d8</i>		<i>105 %</i>	<i>92.1-106</i>		"	"	"	"	
<i>Surrogate: 4-Bromofluorobenzene</i>		<i>97.0 %</i>	<i>84.5-110</i>		"	"	"	"	

Summit Scientific

The results in this report apply to the samples analyzed in accordance with the chain of custody document. This analytical report must be reproduced in its entirety.



LT Environmental, Inc.
4600 West 60th Avenue
Arvada CO, 80003

Project: PDC - Great Western Sugar #1
Project Number: PDC 0760
Project Manager: John Peterson

Reported:
04/28/08 15:16

MW02
R804136-02 (Water)

Summit Scientific

Volatile Organic Compounds by EPA Method 8260B

Date Sampled: **04/17/08 12:40**

Analyte	Result	Reporting		Units	Dilution	Batch	Prepared	Analyzed	Method	Notes
		Limit								
Benzene	ND	1.0		ug/l	1	8042504	04/25/08	04/27/08	EPA 8260B	
Toluene	ND	1.0		"	"	"	"	"	"	
Ethylbenzene	ND	1.0		"	"	"	"	"	"	
Xylenes (total)	ND	1.0		"	"	"	"	"	"	

Date Sampled: **04/17/08 12:40**

Analyte	Result	Reporting		Units	Dilution	Batch	Prepared	Analyzed	Method	Notes
		Limit								
Surrogate: 1,2-Dichloroethane-d4		114 %		90.2-124		"	"	"	"	
Surrogate: Toluene-d8		103 %		92.1-106		"	"	"	"	
Surrogate: 4-Bromofluorobenzene		105 %		84.5-110		"	"	"	"	

Summit Scientific

The results in this report apply to the samples analyzed in accordance with the chain of custody document. This analytical report must be reproduced in its entirety.



LT Environmental, Inc.
4600 West 60th Avenue
Arvada CO, 80003

Project: PDC - Great Western Sugar #1
Project Number: PDC 0760
Project Manager: John Peterson

Reported:
04/28/08 15:16

MW03
R804136-03 (Water)

Summit Scientific

Volatile Organic Compounds by EPA Method 8260B

Date Sampled: **04/17/08 12:50**

Analyte	Result	Reporting		Units	Dilution	Batch	Prepared	Analyzed	Method	Notes
		Limit								
Benzene	ND	1.0		ug/l	1	8042504	04/25/08	04/27/08	EPA 8260B	
Toluene	ND	1.0		"	"	"	"	"	"	
Ethylbenzene	ND	1.0		"	"	"	"	"	"	
Xylenes (total)	ND	1.0		"	"	"	"	"	"	

Date Sampled: **04/17/08 12:50**

Analyte	Result	Reporting		Units	Dilution	Batch	Prepared	Analyzed	Method	Notes
		Limit								
Surrogate: 1,2-Dichloroethane-d4		113 %		90.2-124		"	"	"	"	
Surrogate: Toluene-d8		105 %		92.1-106		"	"	"	"	
Surrogate: 4-Bromofluorobenzene		107 %		84.5-110		"	"	"	"	

Summit Scientific

The results in this report apply to the samples analyzed in accordance with the chain of custody document. This analytical report must be reproduced in its entirety.



LT Environmental, Inc.
4600 West 60th Avenue
Arvada CO, 80003

Project: PDC - Great Western Sugar #1
Project Number: PDC 0760
Project Manager: John Peterson

Reported:
04/28/08 15:16

MW04
R804136-04 (Water)

Summit Scientific

Volatile Organic Compounds by EPA Method 8260B

Date Sampled: **04/17/08 13:00**

Analyte	Result	Reporting	Units	Dilution	Batch	Prepared	Analyzed	Method	Notes
		Limit							
Benzene	ND	1.0	ug/l	1	8042504	04/25/08	04/27/08	EPA 8260B	
Toluene	ND	1.0	"	"	"	"	"	"	
Ethylbenzene	ND	1.0	"	"	"	"	"	"	
Xylenes (total)	ND	1.0	"	"	"	"	"	"	

Date Sampled: **04/17/08 13:00**

Analyte	Result	Reporting	Units	Dilution	Batch	Prepared	Analyzed	Method	Notes
		Limit							
Surrogate: 1,2-Dichloroethane-d4		114 %	90.2-124		"	"	"	"	
Surrogate: Toluene-d8		104 %	92.1-106		"	"	"	"	
Surrogate: 4-Bromofluorobenzene		96.2 %	84.5-110		"	"	"	"	

Summit Scientific

The results in this report apply to the samples analyzed in accordance with the chain of custody document. This analytical report must be reproduced in its entirety.



LT Environmental, Inc.
4600 West 60th Avenue
Arvada CO, 80003

Project: PDC - Great Western Sugar #1
Project Number: PDC 0760
Project Manager: John Peterson

Reported:
04/28/08 15:16

Volatile Organic Compounds by EPA Method 8260B - Quality Control

Summit Scientific

Analyte	Reporting			Spike	Source		%REC		RPD	
	Result	Limit	Units	Level	Result	%REC	Limits	RPD	Limit	Notes

Batch 8042504 - EPA 5030 Water MS

Blank (8042504-BLK1)

Prepared: 04/25/08 Analyzed: 04/26/08

Benzene	ND	1.0	ug/l							
Toluene	ND	1.0	"							
Ethylbenzene	ND	1.0	"							
Xylenes (total)	ND	1.0	"							
Surrogate: 1,2-Dichloroethane-d4	15.3		"	13.3	115	90.2-124				
Surrogate: Toluene-d8	14.0		"	13.3	105	92.1-106				
Surrogate: 4-Bromofluorobenzene	13.9		"	13.3	105	84.5-110				

LCS (8042504-BS1)

Prepared: 04/25/08 Analyzed: 04/26/08

Benzene	34.6	1.0	ug/l	33.3	104	61.4-110				
Toluene	34.3	1.0	"	33.3	103	54.2-116				
Surrogate: 1,2-Dichloroethane-d4	15.3		"	13.3	115	90.2-124				
Surrogate: Toluene-d8	13.9		"	13.3	105	92.1-106				
Surrogate: 4-Bromofluorobenzene	13.8		"	13.3	104	84.5-110				

LCS Dup (8042504-BSD1)

Prepared: 04/25/08 Analyzed: 04/26/08

Benzene	33.3	1.0	ug/l	33.3	100	61.4-110	3.83	11.8		
Toluene	33.7	1.0	"	33.3	101	54.2-116	1.76	12.2		
Surrogate: 1,2-Dichloroethane-d4	15.2		"	13.3	114	90.2-124				
Surrogate: Toluene-d8	13.9		"	13.3	105	92.1-106				
Surrogate: 4-Bromofluorobenzene	13.9		"	13.3	105	84.5-110				

Matrix Spike (8042504-MS1)

Source: R804129-01

Prepared: 04/25/08 Analyzed: 04/26/08

Benzene	45.6	1.0	ug/l	33.3	11	104	61.5-109			
Toluene	33.3	1.0	"	33.3	ND	100	55.6-113			
Surrogate: 1,2-Dichloroethane-d4	15.2		"	13.3		114	90.2-124			
Surrogate: Toluene-d8	14.2		"	13.3		107	92.1-106			S-04
Surrogate: 4-Bromofluorobenzene	12.9		"	13.3		97.0	84.5-110			

Summit Scientific

The results in this report apply to the samples analyzed in accordance with the chain of custody document. This analytical report must be reproduced in its entirety.



LT Environmental, Inc.
4600 West 60th Avenue
Arvada CO, 80003

Project: PDC - Great Western Sugar #1
Project Number: PDC 0760
Project Manager: John Peterson

Reported:
04/28/08 15:16

Volatile Organic Compounds by EPA Method 8260B - Quality Control
Summit Scientific

Analyte	Reporting			Spike	Source		%REC		RPD	
	Result	Limit	Units	Level	Result	%REC	Limits	RPD	Limit	Notes

Batch 8042504 - EPA 5030 Water MS

Matrix Spike Dup (8042504-MSD1)		Source: R804129-01			Prepared: 04/25/08		Analyzed: 04/26/08			
Benzene	36.9	1.0	ug/l	33.3	11	77.8	61.5-109	21.1	21.7	
Toluene	31.0	1.0	"	33.3	ND	93.1	55.6-113	7.15	9.18	
Surrogate: 1,2-Dichloroethane-d4	17.4		"	13.3		131	90.2-124			S-04
Surrogate: Toluene-d8	14.1		"	13.3		106	92.1-106			
Surrogate: 4-Bromofluorobenzene	14.4		"	13.3		108	84.5-110			

Summit Scientific

The results in this report apply to the samples analyzed in accordance with the chain of custody document. This analytical report must be reproduced in its entirety.



LT Environmental, Inc.
4600 West 60th Avenue
Arvada CO, 80003

Project: PDC - Great Western Sugar #1
Project Number: PDC 0760
Project Manager: John Peterson

Reported:
04/28/08 15:16

Notes and Definitions

S-04 The surrogate recovery for this sample is outside of established control limits due to a sample matrix effect.

DET Analyte DETECTED

ND Analyte NOT DETECTED at or above the reporting limit

NR Not Reported

dry Sample results reported on a dry weight basis

RPD Relative Percent Difference

A handwritten signature in black ink, appearing to be 'JMP'.

Summit Scientific

741 Corporate Circle – Suite I ♦ Golden, Colorado 80401

303.277.9310 - laboratory ♦ 303.277.9531 - fax

August 05, 2008

John Peterson

LT Environmental, Inc.

4600 West 60th Avenue

Arvada, CO 80003

RE: PDC - Great Western Sugar #1

Enclosed are the results of analyses for samples received by Summit Scientific on 07/29/08 15:47. If you have any questions concerning this report, please feel free to contact me.

Sincerely,

A handwritten signature in black ink, appearing to be 'PS' followed by a long, sweeping horizontal line.

Paul Shrewsbury For Ben Shrewsbury
Vice President / Laboratory Director



LT Environmental, Inc.
4600 West 60th Avenue
Arvada CO, 80003

Project: PDC - Great Western Sugar #1

Project Number: PDC 0760
Project Manager: John Peterson

Reported:
08/05/08 10:24

ANALYTICAL REPORT FOR SAMPLES

Sample ID	Laboratory ID	Matrix	Date Sampled	Date Received
MW01	R807185-01	Water	07/29/08 10:30	07/29/08 15:47
MW02	R807185-02	Water	07/29/08 10:35	07/29/08 15:47
MW03	R807185-03	Water	07/29/08 10:40	07/29/08 15:47
MW04	R807185-04	Water	07/29/08 10:45	07/29/08 15:47

Summit Scientific

The results in this report apply to the samples analyzed in accordance with the chain of custody document. This analytical report must be reproduced in its entirety.

LT Environmental, Inc.
4600 West 60th Avenue
Arvada CO, 80003

Project: PDC - Great Western Sugar #1

Project Number: PDC 0760
Project Manager: John Peterson

Reported:
08/05/08 10:24

Summit Scientific R907185

741 Corporate Circle Suite I ♦ Golden, Colorado 80401
303-277-9310 ♦ 303-277-9531 Fax

Page / of

Client: LT Environmental, Inc.

Address: 4600 West 60th Avenue

City/State/Zip: Arvada, CO 80003

Phone: (303) 433-9788

Sampler Name: W. 1400

1. 1. M. A. M.

Project Manager: John Peterson

E-Mail: ipeterson@ltenv.comProject Name: 1-NOV-11-1051000 Sec- NO 1

Project Name:	U/Cal Western wayfarer
Project Number:	06C071

Project Number: PCV 160

Sample Description	Date Sampled	Time Sampled	Number of Containers	Preservative					Matrix					Analyze For:	Special Instructions
				HCl	HNO ₃	None	Other (Specify)	Groundwater	Soil	Air - Canister Serial #	Other (Specify)	Total Carbon Chain	BTEX		
MW01	7-29-08	1030	3	X											
MW02		1035	1	X											
MW03		1040	1	X											
MW04		1045	1	X											
<div style="border: 1px solid black; padding: 5px; display: inline-block;"> Analyzed by: MKT </div>															
Relinquished by:	Date/Time:	Received by:				Date/Time:	Turn Around Time (Check)				Notes:				
MKT	7-29-08 1547	JES				7-29-08 1547	<div style="display: flex; justify-content: space-around;"> <div>Same Day</div> <div>72 Hours</div> <div>Standard</div> </div>				<div style="display: flex; justify-content: space-between;"> <div>Temperature Upon Receipt: 4.3</div> <div>Interact: <input checked="" type="checkbox"/> Yes <input type="checkbox"/> No</div> </div>				
Relinquished by:	Date/Time:	Received by:				Date/Time:	Sample Integrity:								
Relinquished by:	Date/Time:	Received in Lab by:				Date/Time:	Sample Integrity:								

www.s2scientific.com

Summit Scientific

The results in this report apply to the samples analyzed in accordance with the chain of custody document. This analytical report must be reproduced in its entirety.



LT Environmental, Inc.
4600 West 60th Avenue
Arvada CO, 80003

Project: PDC - Great Western Sugar #1
Project Number: PDC 0760
Project Manager: John Peterson

Reported:
08/05/08 10:24

MW01
R807185-01 (Water)

Summit Scientific

Volatile Organic Compounds by EPA Method 8260B

Date Sampled: **07/29/08 10:30**

Analyte	Result	Reporting Limit	Units	Dilution	Batch	Prepared	Analyzed	Method	Notes
Benzene	3.0	1.0	ug/l	1	8080303	08/03/08	08/04/08	EPA 8260B	
Toluene	ND	1.0	"	"	"	"	"	"	
Ethylbenzene	ND	1.0	"	"	"	"	"	"	
Xylenes (total)	430	1.0	"	"	"	"	"	"	

Date Sampled: **07/29/08 10:30**

Analyte	Result	Reporting Limit	Units	Dilution	Batch	Prepared	Analyzed	Method	Notes
<i>Surrogate: 1,2-Dichloroethane-d4</i>		<i>107 %</i>	<i>80-120</i>		"	"	"	"	
<i>Surrogate: Toluene-d8</i>		<i>105 %</i>	<i>92.1-106</i>		"	"	"	"	
<i>Surrogate: 4-Bromofluorobenzene</i>		<i>113 %</i>	<i>84.5-110</i>		"	"	"	"	<i>S-04</i>

Summit Scientific

The results in this report apply to the samples analyzed in accordance with the chain of custody document. This analytical report must be reproduced in its entirety.



LT Environmental, Inc.
4600 West 60th Avenue
Arvada CO, 80003

Project: PDC - Great Western Sugar #1
Project Number: PDC 0760
Project Manager: John Peterson

Reported:
08/05/08 10:24

MW02
R807185-02 (Water)

Summit Scientific

Volatile Organic Compounds by EPA Method 8260B

Date Sampled: **07/29/08 10:35**

Analyte	Result	Reporting Limit	Units	Dilution	Batch	Prepared	Analyzed	Method	Notes
Benzene	ND	1.0	ug/l	1	8080303	08/03/08	08/04/08	EPA 8260B	
Toluene	ND	1.0	"	"	"	"	"	"	
Ethylbenzene	ND	1.0	"	"	"	"	"	"	
Xylenes (total)	ND	1.0	"	"	"	"	"	"	

Date Sampled: **07/29/08 10:35**

Analyte	Result	Reporting Limit	Units	Dilution	Batch	Prepared	Analyzed	Method	Notes
Surrogate: 1,2-Dichloroethane-d4		96.2 %	80-120		"	"	"	"	
Surrogate: Toluene-d8		94.7 %	92.1-106		"	"	"	"	
Surrogate: 4-Bromofluorobenzene		92.5 %	84.5-110		"	"	"	"	

Summit Scientific

The results in this report apply to the samples analyzed in accordance with the chain of custody document. This analytical report must be reproduced in its entirety.



LT Environmental, Inc.
4600 West 60th Avenue
Arvada CO, 80003

Project: PDC - Great Western Sugar #1
Project Number: PDC 0760
Project Manager: John Peterson

Reported:
08/05/08 10:24

MW03
R807185-03 (Water)

Summit Scientific

Volatile Organic Compounds by EPA Method 8260B

Date Sampled: **07/29/08 10:40**

Analyte	Result	Reporting		Units	Dilution	Batch	Prepared	Analyzed	Method	Notes
		Limit								
Benzene	ND	1.0		ug/l	1	8080303	08/03/08	08/04/08	EPA 8260B	
Toluene	ND	1.0		"	"	"	"	"	"	
Ethylbenzene	ND	1.0		"	"	"	"	"	"	
Xylenes (total)	ND	1.0		"	"	"	"	"	"	

Date Sampled: **07/29/08 10:40**

Analyte	Result	Reporting		Units	Dilution	Batch	Prepared	Analyzed	Method	Notes
		Limit								
Surrogate: 1,2-Dichloroethane-d4		98.5 %		80-120		"	"	"	"	
Surrogate: Toluene-d8		99.2 %		92.1-106		"	"	"	"	
Surrogate: 4-Bromofluorobenzene		96.2 %		84.5-110		"	"	"	"	

Summit Scientific

The results in this report apply to the samples analyzed in accordance with the chain of custody document. This analytical report must be reproduced in its entirety.



LT Environmental, Inc.
4600 West 60th Avenue
Arvada CO, 80003

Project: PDC - Great Western Sugar #1
Project Number: PDC 0760
Project Manager: John Peterson

Reported:
08/05/08 10:24

MW04
R807185-04 (Water)

Summit Scientific

Volatile Organic Compounds by EPA Method 8260B

Date Sampled: **07/29/08 10:45**

Analyte	Result	Reporting	Units	Dilution	Batch	Prepared	Analyzed	Method	Notes
		Limit							
Benzene	ND	1.0	ug/l	1	8080303	08/03/08	08/04/08	EPA 8260B	
Toluene	ND	1.0	"	"	"	"	"	"	
Ethylbenzene	ND	1.0	"	"	"	"	"	"	
Xylenes (total)	ND	1.0	"	"	"	"	"	"	

Date Sampled: **07/29/08 10:45**

Analyte	Result	Reporting	Units	Dilution	Batch	Prepared	Analyzed	Method	Notes
		Limit							
Surrogate: 1,2-Dichloroethane-d4		104 %	80-120		"	"	"	"	
Surrogate: Toluene-d8		101 %	92.1-106		"	"	"	"	
Surrogate: 4-Bromofluorobenzene		99.2 %	84.5-110		"	"	"	"	

Summit Scientific

The results in this report apply to the samples analyzed in accordance with the chain of custody document. This analytical report must be reproduced in its entirety.



LT Environmental, Inc.
4600 West 60th Avenue
Arvada CO, 80003

Project: PDC - Great Western Sugar #1
Project Number: PDC 0760
Project Manager: John Peterson

Reported:
08/05/08 10:24

Volatile Organic Compounds by EPA Method 8260B - Quality Control

Summit Scientific

Analyte	Reporting			Spike	Source	%REC		RPD		
	Result	Limit	Units	Level	Result	%REC	Limits	RPD	Limit	Notes

Batch 8080303 - EPA 5030 Water MS

Blank (8080303-BLK1)

Prepared & Analyzed: 08/03/08

Benzene	ND	1.0	ug/l							
Toluene	ND	1.0	"							
Ethylbenzene	ND	1.0	"							
Xylenes (total)	ND	1.0	"							
Surrogate: 1,2-Dichloroethane-d4	13.5		"	13.3		102	80-120			
Surrogate: Toluene-d8	12.3		"	13.3		92.5	92.1-106			
Surrogate: 4-Bromofluorobenzene	11.9		"	13.3		89.5	84.5-110			

LCS (8080303-BS1)

Prepared & Analyzed: 08/03/08

Benzene	25.2	1.0	ug/l	33.3		75.7	61.4-110			
Toluene	27.8	1.0	"	33.3		83.5	54.2-116			
Surrogate: 1,2-Dichloroethane-d4	13.1		"	13.3		98.5	80-120			
Surrogate: Toluene-d8	12.6		"	13.3		94.7	92.1-106			
Surrogate: 4-Bromofluorobenzene	12.0		"	13.3		90.2	84.5-110			

LCS Dup (8080303-BSD1)

Prepared & Analyzed: 08/03/08

Benzene	24.7	1.0	ug/l	33.3		74.2	61.4-110	2.00	11.8	
Toluene	27.0	1.0	"	33.3		81.1	54.2-116	2.92	12.2	
Surrogate: 1,2-Dichloroethane-d4	13.1		"	13.3		98.5	80-120			
Surrogate: Toluene-d8	12.2		"	13.3		91.7	92.1-106			
Surrogate: 4-Bromofluorobenzene	11.8		"	13.3		88.7	84.5-110			

Matrix Spike (8080303-MS1)

Source: R807186-01

Prepared & Analyzed: 08/03/08

Benzene	609	1.0	ug/l	33.3	680	NR	61.5-109			QM-05
Toluene	28.4	1.0	"	33.3	ND	85.3	55.6-113			
Surrogate: 1,2-Dichloroethane-d4	13.2		"	13.3		99.2	80-120			
Surrogate: Toluene-d8	13.0		"	13.3		97.7	92.1-106			
Surrogate: 4-Bromofluorobenzene	12.9		"	13.3		97.0	84.5-110			

Summit Scientific

The results in this report apply to the samples analyzed in accordance with the chain of custody document. This analytical report must be reproduced in its entirety.



LT Environmental, Inc.
4600 West 60th Avenue
Arvada CO, 80003

Project: PDC - Great Western Sugar #1
Project Number: PDC 0760
Project Manager: John Peterson

Reported:
08/05/08 10:24

Volatile Organic Compounds by EPA Method 8260B - Quality Control
Summit Scientific

Analyte	Reporting			Spike	Source		%REC		RPD	
	Result	Limit	Units	Level	Result	%REC	Limits	RPD	Limit	Notes

Batch 8080303 - EPA 5030 Water MS

Matrix Spike Dup (8080303-MSD1)		Source: R807186-01			Prepared & Analyzed: 08/03/08					
Benzene	481	1.0	ug/l	33.3	680	NR	61.5-109	23.5	21.7	QM-05
Toluene	26.2	1.0	"	33.3	ND	78.7	55.6-113	8.06	9.18	
Surrogate: 1,2-Dichloroethane-d4	14.0		"	13.3		105	80-120			
Surrogate: Toluene-d8	12.8		"	13.3		96.2	92.1-106			
Surrogate: 4-Bromofluorobenzene	13.2		"	13.3		99.2	84.5-110			

Summit Scientific

The results in this report apply to the samples analyzed in accordance with the chain of custody document. This analytical report must be reproduced in its entirety.



LT Environmental, Inc.
4600 West 60th Avenue
Arvada CO, 80003

Project: PDC - Great Western Sugar #1
Project Number: PDC 0760
Project Manager: John Peterson

Reported:
08/05/08 10:24

Notes and Definitions

S-04 The surrogate recovery for this sample is outside of established control limits due to a sample matrix effect.

QM-05 The spike recovery was outside acceptance limits for the MS and/or MSD due to matrix interference. The associated LCS and/or LCSD were within acceptance limits, therefore the data are considered valid.

DET Analyte DETECTED

ND Analyte NOT DETECTED at or above the reporting limit

NR Not Reported

dry Sample results reported on a dry weight basis

RPD Relative Percent Difference

Summit Scientific

The results in this report apply to the samples analyzed in accordance with the chain of custody document. This analytical report must be reproduced in its entirety.

Summit Scientific

741 Corporate Circle – Suite I ♦ Golden, Colorado 80401

303.277.9310 - laboratory ♦ 303.277.9531 - fax

October 29, 2008

John Peterson

LT Environmental, Inc.

4600 West 60th Avenue

Arvada, CO 80003

RE: PDC - Great Western Sugar #1

Enclosed are the results of analyses for samples received by Summit Scientific on 10/20/08 15:45. If you have any questions concerning this report, please feel free to contact me.

Sincerely,

A handwritten signature in black ink, appearing to be 'PS' followed by a long, sweeping horizontal line.

Paul Shrewsbury For Ben Shrewsbury
Vice President / Laboratory Director



LT Environmental, Inc.
4600 West 60th Avenue
Arvada CO, 80003

Project: PDC - Great Western Sugar #1

Project Number: PDC 0760
Project Manager: John Peterson

Reported:
10/29/08 10:01

ANALYTICAL REPORT FOR SAMPLES

Sample ID	Laboratory ID	Matrix	Date Sampled	Date Received
MW01	R810089-01	Water	10/16/08 10:40	10/20/08 15:45
MW02	R810089-02	Water	10/16/08 10:45	10/20/08 15:45
MW03	R810089-03	Water	10/16/08 10:50	10/20/08 15:45
MW04	R810089-04	Water	10/16/08 10:55	10/20/08 15:45

Summit Scientific

The results in this report apply to the samples analyzed in accordance with the chain of custody document. This analytical report must be reproduced in its entirety.

LT Environmental, Inc.
4600 West 60th Avenue
Arvada CO, 80003

Project: PDC - Great Western Sugar #1

Project Number: PDC 0760
Project Manager: John Peterson

Reported:
10/29/08 10:01

Summit Scientific R210089

S₂
741 Corporate Circle Suite I ♦ Golden, Colorado 80401
303-277-9310 ♦ 303-277-9531 Fax

Page / of

Client: LT Environmental, Inc.

Address: 4600 West 60th Avenue

City/State/Zip: Arvada, CO 80003

one: (303) 433-9788

Sampler Name: _____

--	--

Project Manager: John Peterson

E-Mail: jpeterson@ltenv.com

Project Name: Great Western Sugar #1

Project Number: PNC0760

100

Sample Description	Date Sampled	Time Sampled	Number of Containers	Preservative						Matrix				Analyze For:	Special Instructions
				HCl	HNO ₃	None	Other (Specify)	Groundwater	Soil	Air - Canister Serial #	Other (Specify)	Total Carbon Chain	BTEX		
MW01	10-1-08	1040	2	X				X							
MW02	I	1045	2	X				X							
MW03	I	1050	2	X				X							
MW04	I	1055	2	X				X							
Inquired by: MWG	Date/Time: 10-1-08 1757	Received by: [Signature]				Date/Time: 10/1/08 1805				Turn Around Time (Check) Same Day <input type="checkbox"/> 24 Hours <input type="checkbox"/> 48 Hours <input checked="" type="checkbox"/>				Notes:	
Inquired by:	Date/Time:	Received by:				Date/Time:				Sample Integrity: Temperature Upon Receipt: 42 Intact: Yes No					
Inquired by:	Date/Time:	Received by:				Date/Time:									

www.s2scientific.com

Summit Scientific

The results in this report apply to the samples analyzed in accordance with the chain of custody document. This analytical report must be reproduced in its entirety.



LT Environmental, Inc.
4600 West 60th Avenue
Arvada CO, 80003

Project: PDC - Great Western Sugar #1
Project Number: PDC 0760
Project Manager: John Peterson

Reported:
10/29/08 10:01

MW01
R810089-01 (Water)

Summit Scientific

Volatile Organic Compounds by EPA Method 8260B

Date Sampled: **10/16/08 10:40**

Analyte	Result	Reporting Limit	Units	Dilution	Batch	Prepared	Analyzed	Method	Notes
Benzene	12	1.0	ug/l	1	8102307	10/23/08	10/24/08	EPA 8260B	
Toluene	ND	1.0	"	"	"	"	"	"	
Ethylbenzene	8.1	1.0	"	"	"	"	"	"	
Xylenes (total)	1300	10	"	10	"	"	"	"	

Date Sampled: **10/16/08 10:40**

Analyte	Result	Reporting Limit	Units	Dilution	Batch	Prepared	Analyzed	Method	Notes
<i>Surrogate: 1,2-Dichloroethane-d4</i>		101 %	77.3-121		"	"	"	"	
<i>Surrogate: Toluene-d8</i>		96.2 %	91.4-107		"	"	"	"	
<i>Surrogate: 4-Bromofluorobenzene</i>		95.5 %	85.3-109		"	"	"	"	

Summit Scientific

The results in this report apply to the samples analyzed in accordance with the chain of custody document. This analytical report must be reproduced in its entirety.



LT Environmental, Inc.
4600 West 60th Avenue
Arvada CO, 80003

Project: PDC - Great Western Sugar #1
Project Number: PDC 0760
Project Manager: John Peterson

Reported:
10/29/08 10:01

MW02
R810089-02 (Water)

Summit Scientific

Volatile Organic Compounds by EPA Method 8260B

Date Sampled: **10/16/08 10:45**

Analyte	Result	Reporting	Units	Dilution	Batch	Prepared	Analyzed	Method	Notes
		Limit							
Benzene	ND	1.0	ug/l	1	8102307	10/23/08	10/24/08	EPA 8260B	
Toluene	ND	1.0	"	"	"	"	"	"	
Ethylbenzene	ND	1.0	"	"	"	"	"	"	
Xylenes (total)	ND	1.0	"	"	"	"	"	"	

Date Sampled: **10/16/08 10:45**

Analyte	Result	Reporting	Units	Dilution	Batch	Prepared	Analyzed	Method	Notes
		Limit							
Surrogate: 1,2-Dichloroethane-d4		97.7 %	77.3-121		"	"	"	"	
Surrogate: Toluene-d8		92.5 %	91.4-107		"	"	"	"	
Surrogate: 4-Bromofluorobenzene		97.0 %	85.3-109		"	"	"	"	

Summit Scientific

The results in this report apply to the samples analyzed in accordance with the chain of custody document. This analytical report must be reproduced in its entirety.



LT Environmental, Inc.
4600 West 60th Avenue
Arvada CO, 80003

Project: PDC - Great Western Sugar #1
Project Number: PDC 0760
Project Manager: John Peterson

Reported:
10/29/08 10:01

MW03
R810089-03 (Water)

Summit Scientific

Volatile Organic Compounds by EPA Method 8260B

Date Sampled: **10/16/08 10:50**

Analyte	Result	Reporting	Units	Dilution	Batch	Prepared	Analyzed	Method	Notes
		Limit							
Benzene	ND	1.0	ug/l	1	8102307	10/23/08	10/24/08	EPA 8260B	
Toluene	ND	1.0	"	"	"	"	"	"	
Ethylbenzene	ND	1.0	"	"	"	"	"	"	
Xylenes (total)	ND	1.0	"	"	"	"	"	"	

Date Sampled: **10/16/08 10:50**

Analyte	Result	Reporting	Units	Dilution	Batch	Prepared	Analyzed	Method	Notes
		Limit							
Surrogate: 1,2-Dichloroethane-d4		99.2 %	77.3-121		"	"	"	"	
Surrogate: Toluene-d8		91.7 %	91.4-107		"	"	"	"	
Surrogate: 4-Bromofluorobenzene		98.5 %	85.3-109		"	"	"	"	

Summit Scientific

The results in this report apply to the samples analyzed in accordance with the chain of custody document. This analytical report must be reproduced in its entirety.



LT Environmental, Inc.
4600 West 60th Avenue
Arvada CO, 80003

Project: PDC - Great Western Sugar #1
Project Number: PDC 0760
Project Manager: John Peterson

Reported:
10/29/08 10:01

MW04
R810089-04 (Water)

Summit Scientific

Volatile Organic Compounds by EPA Method 8260B

Date Sampled: **10/16/08 10:55**

Analyte	Result	Reporting Limit	Units	Dilution	Batch	Prepared	Analyzed	Method	Notes
Benzene	ND	1.0	ug/l	1	8102307	10/23/08	10/25/08	EPA 8260B	
Toluene	ND	1.0	"	"	"	"	"	"	
Ethylbenzene	ND	1.0	"	"	"	"	"	"	
Xylenes (total)	ND	1.0	"	"	"	"	"	"	

Date Sampled: **10/16/08 10:55**

Analyte	Result	Reporting Limit	Units	Dilution	Batch	Prepared	Analyzed	Method	Notes
Surrogate: 1,2-Dichloroethane-d4		97.7 %	77.3-121		"	"	"	"	
Surrogate: Toluene-d8		91.7 %	91.4-107		"	"	"	"	
Surrogate: 4-Bromofluorobenzene		103 %	85.3-109		"	"	"	"	

Summit Scientific

The results in this report apply to the samples analyzed in accordance with the chain of custody document. This analytical report must be reproduced in its entirety.



LT Environmental, Inc.
4600 West 60th Avenue
Arvada CO, 80003

Project: PDC - Great Western Sugar #1
Project Number: PDC 0760
Project Manager: John Peterson

Reported:
10/29/08 10:01

Volatile Organic Compounds by EPA Method 8260B - Quality Control

Summit Scientific

Analyte	Reporting			Spike	Source		%REC		RPD	
	Result	Limit	Units	Level	Result	%REC	Limits	RPD	Limit	Notes

Batch 8102307 - EPA 5030 Water MS

Blank (8102307-BLK1)

Prepared: 10/23/08 Analyzed: 10/24/08

Benzene	ND	1.0	ug/l							
Toluene	ND	1.0	"							
Ethylbenzene	ND	1.0	"							
Xylenes (total)	ND	1.0	"							
Surrogate: 1,2-Dichloroethane-d4	13.4		"	13.3	101	77.3-121				
Surrogate: Toluene-d8	12.5		"	13.3	94.0	91.4-107				
Surrogate: 4-Bromofluorobenzene	13.5		"	13.3	102	85.3-109				

LCS (8102307-BS1)

Prepared: 10/23/08 Analyzed: 10/24/08

Benzene	26.4	1.0	ug/l	33.3	79.3	70-114				
Toluene	28.1	1.0	"	33.3	84.4	72.7-116				
Surrogate: 1,2-Dichloroethane-d4	13.4		"	13.3	101	77.3-121				
Surrogate: Toluene-d8	12.6		"	13.3	94.7	91.4-107				
Surrogate: 4-Bromofluorobenzene	13.6		"	13.3	102	85.3-109				

LCS Dup (8102307-BSD1)

Prepared: 10/23/08 Analyzed: 10/24/08

Benzene	25.5	1.0	ug/l	33.3	76.6	70-114	3.47	8.14		
Toluene	27.4	1.0	"	33.3	82.3	72.7-116	2.52	7.88		
Surrogate: 1,2-Dichloroethane-d4	13.6		"	13.3	102	77.3-121				
Surrogate: Toluene-d8	12.5		"	13.3	94.0	91.4-107				
Surrogate: 4-Bromofluorobenzene	13.3		"	13.3	100	85.3-109				

Matrix Spike (8102307-MS1)

Source: R810088-01

Prepared: 10/23/08 Analyzed: 10/24/08

Benzene	25.6	1.0	ug/l	33.3	ND	76.9	66.8-117			
Toluene	27.3	1.0	"	33.3	ND	82.0	71.5-117			
Surrogate: 1,2-Dichloroethane-d4	14.0		"	13.3		105	77.3-121			
Surrogate: Toluene-d8	12.6		"	13.3		94.7	91.4-107			
Surrogate: 4-Bromofluorobenzene	13.3		"	13.3		100	85.3-109			

Summit Scientific

The results in this report apply to the samples analyzed in accordance with the chain of custody document. This analytical report must be reproduced in its entirety.



LT Environmental, Inc.
4600 West 60th Avenue
Arvada CO, 80003

Project: PDC - Great Western Sugar #1
Project Number: PDC 0760
Project Manager: John Peterson

Reported:
10/29/08 10:01

Volatile Organic Compounds by EPA Method 8260B - Quality Control
Summit Scientific

Analyte	Reporting			Spike	Source		%REC		RPD	
	Result	Limit	Units	Level	Result	%REC	Limits	RPD	Limit	Notes

Batch 8102307 - EPA 5030 Water MS

Matrix Spike Dup (8102307-MSD1)		Source: R810088-01			Prepared: 10/23/08		Analyzed: 10/24/08			
Benzene	25.5	1.0	ug/l	33.3	ND	76.6	66.8-117	0.391	17.8	
Toluene	27.4	1.0	"	33.3	ND	82.3	71.5-117	0.366	14.4	
Surrogate: 1,2-Dichloroethane-d4	15.9		"	13.3		120	77.3-121			
Surrogate: Toluene-d8	12.4		"	13.3		93.2	91.4-107			
Surrogate: 4-Bromofluorobenzene	13.6		"	13.3		102	85.3-109			

Summit Scientific

The results in this report apply to the samples analyzed in accordance with the chain of custody document. This analytical report must be reproduced in its entirety.



LT Environmental, Inc.
4600 West 60th Avenue
Arvada CO, 80003

Project: PDC - Great Western Sugar #1

Project Number: PDC 0760
Project Manager: John Peterson

Reported:
10/29/08 10:01

Notes and Definitions

DET Analyte DETECTED
ND Analyte NOT DETECTED at or above the reporting limit
NR Not Reported
dry Sample results reported on a dry weight basis
RPD Relative Percent Difference

Summit Scientific

A handwritten signature in black ink, appearing to be 'JM' followed by a long horizontal stroke.

The results in this report apply to the samples analyzed in accordance with the chain of custody document. This analytical report must be reproduced in its entirety.

Summit Scientific

741 Corporate Circle – Suite I ♦ Golden, Colorado 80401

303.277.9310 - laboratory ♦ 303.374.5933 - fax

January 20, 2009

John Peterson

LT Environmental, Inc.

4600 West 60th Avenue

Arvada, CO 80003

RE: PDC - Great Western Sugar #1

Enclosed are the results of analyses for samples received by Summit Scientific on 01/15/09 17:03. If you have any questions concerning this report, please feel free to contact me.

Sincerely,

A handwritten signature in black ink, appearing to be 'BS' with a long, sweeping horizontal line extending to the right.

Ben Shrewsbury

Vice President / Laboratory Director

LT Environmental, Inc.
4600 West 60th Avenue
Arvada CO, 80003

Project: PDC - Great Western Sugar #1
Project Number: PDC 0760
Project Manager: John Peterson

Reported:
01/20/09 09:26

ANALYTICAL REPORT FOR SAMPLES

Sample ID	Laboratory ID	Matrix	Date Sampled	Date Received
MW01	R901077-01	Water	01/15/09 10:30	01/15/09 17:03
MW02	R901077-02	Water	01/15/09 10:40	01/15/09 17:03
MW03	R901077-03	Water	01/15/09 10:50	01/15/09 17:03
MW04	R901077-04	Water	01/15/09 11:00	01/15/09 17:03

Summit Scientific

The results in this report apply to the samples analyzed in accordance with the chain of custody document. This analytical report must be reproduced in its entirety.



LT Environmental, Inc.
4600 West 60th Avenue
Arvada CO, 80003

Project: PDC - Great Western Sugar #1

Project Number: PDC 0760
Project Manager: John Peterson

Reported:
01/20/09 09:26

Summit Scientific R901077

S₂
741 Corporate Circle Suite I ♦ Golden, Colorado 80401
303-277-9310 ♦ 303-277-9531 Fax

Page 1 of 1

Client: LT Environmental, Inc.

Address: 4600 West 60th Avenue

City/State/Zip: Arvada, CO 80003

Phone: (303) 433-9788

Computer Name: 73

Sample Name: 2010-2011

Project Manager:

E-Mail:

Project Name:

Project Number:

100

John Peterson

jpeterson@lter.berkeley.edu

arent West

99C-0760

100

100

nv.com

5

10

1. *Staphylococcus aureus* (100%)

10

100

三

100

100



100

100

10

100

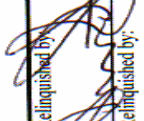
100

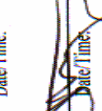
Sample Description	Date Sampled	Time Sampled	Number of Containers	Preservative					Matrix		Analyze For:					Special Instructions
				HCl	HNO ₃	None	Other (Specify)	Groundwater	Soil	Air - Canister Serial #	Other (Specify)	Total Carbon Chain	BTEX			
MW01	11/5/09	10:30	2	X				X								
MW02	"	10:40	2	X				X								
MW03	"	10:50	2	X				X								
MW04	"	11:00	2	X				X								
Relinquished by: 	Date/Time: 11/5/09	10:30		Received by: 	Date/Time: 11/5/09	1703										
Relinquished by: 	Date/Time: 11/5/09			Received by:	Date/Time:											
Relinquished by:	Date/Time:			Received in Lab by:	Date/Time:											
Turn Around Time (Check) Same Day <input type="checkbox"/> 72 Hours <input checked="" type="checkbox"/> 24 Hours <input type="checkbox"/> Standard <input type="checkbox"/> 48 Hours <input type="checkbox"/>							Notes:									
Sample Integrity: Temperature Upon Receipt: 4.5 Intact: Yes <input checked="" type="checkbox"/> No <input type="checkbox"/>																

www.s2scientific.com

LT Environmental, Inc.
4600 West 60th Avenue
Arvada CO, 80003

Project: PDC - Great Western Sugar #1
Project Number: PDC 0760
Project Manager: John Peterson

Reported:
01/20/09 09:26

MW01
R901077-01 (Water)

Summit Scientific

Volatile Organic Compounds by EPA Method 8260B

Date Sampled: **01/15/09 10:30**

Analyte	Result	Reporting Limit	Units	Dilution	Batch	Prepared	Analyzed	Method	Notes
Benzene	1.5	1.0	ug/l	1	9011901	01/19/09	01/20/09	EPA 8260B	
Toluene	ND	1.0	"	"	"	"	"	"	
Ethylbenzene	1.0	1.0	"	"	"	"	"	"	
Xylenes (total)	20	1.0	"	"	"	"	"	"	

Date Sampled: **01/15/09 10:30**

Analyte	Result	Reporting Limit	Units	Dilution	Batch	Prepared	Analyzed	Method	Notes
<i>Surrogate: 1,2-Dichloroethane-d4</i>		94.7 %	77.3-121		"	"	"	"	
<i>Surrogate: Toluene-d8</i>		95.5 %	91.4-107		"	"	"	"	
<i>Surrogate: 4-Bromofluorobenzene</i>		97.0 %	85.3-109		"	"	"	"	

Summit Scientific

The results in this report apply to the samples analyzed in accordance with the chain of custody document. This analytical report must be reproduced in its entirety.



LT Environmental, Inc.
4600 West 60th Avenue
Arvada CO, 80003

Project: PDC - Great Western Sugar #1
Project Number: PDC 0760
Project Manager: John Peterson

Reported:
01/20/09 09:26

MW02
R901077-02 (Water)

Summit Scientific

Volatile Organic Compounds by EPA Method 8260B

Date Sampled: **01/15/09 10:40**

Analyte	Result	Reporting Limit	Units	Dilution	Batch	Prepared	Analyzed	Method	Notes
Benzene	ND	1.0	ug/l	1	9011901	01/19/09	01/20/09	EPA 8260B	
Toluene	ND	1.0	"	"	"	"	"	"	
Ethylbenzene	ND	1.0	"	"	"	"	"	"	
Xylenes (total)	ND	1.0	"	"	"	"	"	"	

Date Sampled: **01/15/09 10:40**

Analyte	Result	Reporting Limit	Units	Dilution	Batch	Prepared	Analyzed	Method	Notes
Surrogate: 1,2-Dichloroethane-d4		96.2 %	77.3-121		"	"	"	"	
Surrogate: Toluene-d8		96.2 %	91.4-107		"	"	"	"	
Surrogate: 4-Bromofluorobenzene		99.2 %	85.3-109		"	"	"	"	

Summit Scientific

The results in this report apply to the samples analyzed in accordance with the chain of custody document. This analytical report must be reproduced in its entirety.



LT Environmental, Inc.
4600 West 60th Avenue
Arvada CO, 80003

Project: PDC - Great Western Sugar #1
Project Number: PDC 0760
Project Manager: John Peterson

Reported:
01/20/09 09:26

MW03
R901077-03 (Water)

Summit Scientific

Volatile Organic Compounds by EPA Method 8260B

Date Sampled: **01/15/09 10:50**

Analyte	Result	Reporting Limit	Units	Dilution	Batch	Prepared	Analyzed	Method	Notes
Benzene	ND	1.0	ug/l	1	9011901	01/19/09	01/20/09	EPA 8260B	
Toluene	ND	1.0	"	"	"	"	"	"	
Ethylbenzene	ND	1.0	"	"	"	"	"	"	
Xylenes (total)	ND	1.0	"	"	"	"	"	"	

Date Sampled: **01/15/09 10:50**

Analyte	Result	Reporting Limit	Units	Dilution	Batch	Prepared	Analyzed	Method	Notes
Surrogate: 1,2-Dichloroethane-d4		91.0 %	77.3-121		"	"	"	"	
Surrogate: Toluene-d8		94.7 %	91.4-107		"	"	"	"	
Surrogate: 4-Bromofluorobenzene		97.0 %	85.3-109		"	"	"	"	

Summit Scientific

The results in this report apply to the samples analyzed in accordance with the chain of custody document. This analytical report must be reproduced in its entirety.



LT Environmental, Inc.
4600 West 60th Avenue
Arvada CO, 80003

Project: PDC - Great Western Sugar #1
Project Number: PDC 0760
Project Manager: John Peterson

Reported:
01/20/09 09:26

MW04
R901077-04 (Water)

Summit Scientific

Volatile Organic Compounds by EPA Method 8260B

Date Sampled: **01/15/09 11:00**

Analyte	Result	Reporting Limit	Units	Dilution	Batch	Prepared	Analyzed	Method	Notes
Benzene	ND	1.0	ug/l	1	9011901	01/19/09	01/20/09	EPA 8260B	
Toluene	ND	1.0	"	"	"	"	"	"	
Ethylbenzene	ND	1.0	"	"	"	"	"	"	
Xylenes (total)	ND	1.0	"	"	"	"	"	"	

Date Sampled: **01/15/09 11:00**

Analyte	Result	Reporting Limit	Units	Dilution	Batch	Prepared	Analyzed	Method	Notes
Surrogate: 1,2-Dichloroethane-d4		91.7 %	77.3-121		"	"	"	"	
Surrogate: Toluene-d8		94.7 %	91.4-107		"	"	"	"	
Surrogate: 4-Bromofluorobenzene		97.0 %	85.3-109		"	"	"	"	

Summit Scientific

The results in this report apply to the samples analyzed in accordance with the chain of custody document. This analytical report must be reproduced in its entirety.



LT Environmental, Inc.
4600 West 60th Avenue
Arvada CO, 80003

Project: PDC - Great Western Sugar #1
Project Number: PDC 0760
Project Manager: John Peterson

Reported:
01/20/09 09:26

Volatile Organic Compounds by EPA Method 8260B - Quality Control

Summit Scientific

Analyte	Reporting			Spike	Source		%REC		RPD	
	Result	Limit	Units	Level	Result	%REC	Limits	RPD	Limit	Notes

Batch 9011901 - EPA 5030 Water MS

Blank (9011901-BLK1)

Prepared & Analyzed: 01/19/09

Benzene	ND	1.0	ug/l							
Toluene	ND	1.0	"							
Ethylbenzene	ND	1.0	"							
Xylenes (total)	ND	1.0	"							
Surrogate: 1,2-Dichloroethane-d4	13.8		"	13.3	104	77.3-121				
Surrogate: Toluene-d8	13.1		"	13.3	98.5	91.4-107				
Surrogate: 4-Bromofluorobenzene	14.4		"	13.3	108	85.3-109				

LCS (9011901-BS1)

Prepared & Analyzed: 01/19/09

Benzene	30.8	1.0	ug/l	33.3	92.5	70-114				
Toluene	32.3	1.0	"	33.3	97.0	72.7-116				
Surrogate: 1,2-Dichloroethane-d4	13.9		"	13.3	105	77.3-121				
Surrogate: Toluene-d8	13.8		"	13.3	104	91.4-107				
Surrogate: 4-Bromofluorobenzene	13.5		"	13.3	102	85.3-109				

LCS Dup (9011901-BSD1)

Prepared & Analyzed: 01/19/09

Benzene	33.0	1.0	ug/l	33.3	99.1	70-114	6.90	8.14		
Toluene	35.8	1.0	"	33.3	108	72.7-116	10.3	7.88		
Surrogate: 1,2-Dichloroethane-d4	14.8		"	13.3	111	77.3-121				
Surrogate: Toluene-d8	14.5		"	13.3	109	91.4-107				
Surrogate: 4-Bromofluorobenzene	14.2		"	13.3	107	85.3-109				

Matrix Spike (9011901-MS1)

Source: R901063-02

Prepared & Analyzed: 01/19/09

Benzene	26.9	1.0	ug/l	33.3	ND	80.8	66.8-117			
Toluene	28.6	1.0	"	33.3	ND	85.9	71.5-117			
Surrogate: 1,2-Dichloroethane-d4	14.2		"	13.3		107	77.3-121			
Surrogate: Toluene-d8	13.1		"	13.3		98.5	91.4-107			
Surrogate: 4-Bromofluorobenzene	13.3		"	13.3		100	85.3-109			

Summit Scientific

The results in this report apply to the samples analyzed in accordance with the chain of custody document. This analytical report must be reproduced in its entirety.



LT Environmental, Inc.
4600 West 60th Avenue
Arvada CO, 80003

Project: PDC - Great Western Sugar #1
Project Number: PDC 0760
Project Manager: John Peterson

Reported:
01/20/09 09:26

Volatile Organic Compounds by EPA Method 8260B - Quality Control
Summit Scientific

Analyte	Reporting			Spike	Source		%REC		RPD	
	Result	Limit	Units	Level	Result	%REC	Limits	RPD	Limit	Notes

Batch 9011901 - EPA 5030 Water MS

Matrix Spike Dup (9011901-MSD1)		Source: R901063-02			Prepared & Analyzed: 01/19/09					
Benzene	26.4	1.0	ug/l	33.3	ND	79.3	66.8-117	1.88	17.8	
Toluene	27.1	1.0	"	33.3	ND	81.4	71.5-117	5.39	14.4	
Surrogate: 1,2-Dichloroethane-d4	14.6		"	13.3		110	77.3-121			
Surrogate: Toluene-d8	13.0		"	13.3		97.7	91.4-107			
Surrogate: 4-Bromofluorobenzene	13.2		"	13.3		99.2	85.3-109			

Summit Scientific

The results in this report apply to the samples analyzed in accordance with the chain of custody document. This analytical report must be reproduced in its entirety.



LT Environmental, Inc.
4600 West 60th Avenue
Arvada CO, 80003

Project: PDC - Great Western Sugar #1
Project Number: PDC 0760
Project Manager: John Peterson

Reported:
01/20/09 09:26

Notes and Definitions

DET Analyte DETECTED
ND Analyte NOT DETECTED at or above the reporting limit
NR Not Reported
dry Sample results reported on a dry weight basis
RPD Relative Percent Difference



Summit Scientific

741 Corporate Circle – Suite I ♦ Golden, Colorado 80401

303.277.9310 - laboratory ♦ 303.277.9531 - fax

April 24, 2009

John Peterson

LT Environmental, Inc.

4600 West 60th Avenue

Arvada, CO 80003

RE: PDC - Great Western Sugar #1

Enclosed are the results of analyses for samples received by Summit Scientific on 04/21/09 15:40. If you have any questions concerning this report, please feel free to contact me.

Sincerely,

A handwritten signature in black ink, appearing to be 'PS' followed by a long, sweeping horizontal line.

Paul Shrewsbury For Ben Shrewsbury
Vice President / Laboratory Director



LT Environmental, Inc.
4600 West 60th Avenue
Arvada CO, 80003

Project: PDC - Great Western Sugar #1

Project Number: PDC 0760
Project Manager: John Peterson

Reported:
04/24/09 16:13

ANALYTICAL REPORT FOR SAMPLES

Sample ID	Laboratory ID	Matrix	Date Sampled	Date Received
MW01	R904103-01	Water	04/21/09 09:50	04/21/09 15:40
MW02	R904103-02	Water	04/21/09 10:00	04/21/09 15:40
MW03	R904103-03	Water	04/21/09 10:10	04/21/09 15:40
MW04	R904103-04	Water	04/21/09 10:20	04/21/09 15:40

Summit Scientific

The results in this report apply to the samples analyzed in accordance with the chain of custody document. This analytical report must be reproduced in its entirety.



LT Environmental, Inc.
4600 West 60th Avenue
Arvada CO, 80003

Project: PDC - Great Western Sugar #1

Project Number: PDC 0760
Project Manager: John Peterson

Reported:
04/24/09 16:13

Summit Scientific R904003

S₂

741 Corporate Circle Suite 1 • Golden, Colorado 80401
303-277-9310 • 303-277-9531 Fax

Page 1 of 1

Client: LT Environmental, Inc.
Address: 4600 West 60th Avenue
City/State/Zip: Arvada, CO 80003
Phone: (303) 433-9788
Fax: (303) 433-1432
Project Name: Great Western Sugar #1
Project Number: PDC0760
Project Manager: John Peterson
E-Mail: jpeterson@ltenv.com
Sampler Name: MB

Sample Description	Date Sampled	Time Sampled	Number of Containers	Preservative	Matrix	Analyze For:	Special Instructions
MW01	4-21-09	850	2	X HCl	X Groundwater	Total Carbon Chain	
MW02	4-21-09	1000	1	X HNO ₃	X Groundwater	Other (Specify)	
MW03	4-21-09	1010	1	X HNO ₃	X Groundwater	Other (Specify)	
MW04	4-21-09	1020	1	X HNO ₃	X Groundwater	Other (Specify)	
Relinquished by: WPA	Date/Time: 4/21/09 1540	Received by: JPS	Date/Time: 4/21/09 1540	Turn Around Time (Check): <input type="checkbox"/> Same Day <input type="checkbox"/> 24 Hours <input checked="" type="checkbox"/> 72 Hours <input type="checkbox"/> Standard	Notes:		
Relinquished by:	Date/Time:	Received by:	Date/Time:	Sample Integrity: Temperature Upon Receipt: 4.8 Intact: <input checked="" type="checkbox"/> Yes <input type="checkbox"/> No			
Relinquished by:	Date/Time:	Received in Lab by:	Date/Time:				

www.s2scientific.com

Summit Scientific

The results in this report apply to the samples analyzed in accordance with the chain of custody document. This analytical report must be reproduced in its entirety.



LT Environmental, Inc.
4600 West 60th Avenue
Arvada CO, 80003

Project: PDC - Great Western Sugar #1
Project Number: PDC 0760
Project Manager: John Peterson

Reported:
04/24/09 16:13

MW01
R904103-01 (Water)

Summit Scientific

Volatile Organic Compounds by EPA Method 8260B

Date Sampled: **04/21/09 09:50**

Analyte	Result	Reporting		Units	Dilution	Batch	Prepared	Analyzed	Method	Notes
		Limit								
Benzene	1.8	1.0		ug/l	1	9042301	04/23/09	04/23/09	EPA 8260B	
Toluene	ND	1.0		"	"	"	"	"	"	
Ethylbenzene	1.1	1.0		"	"	"	"	"	"	
Xylenes (total)	12	1.0		"	"	"	"	"	"	

Date Sampled: **04/21/09 09:50**

Analyte	Result	Reporting		Units	Dilution	Batch	Prepared	Analyzed	Method	Notes
		Limit								
Surrogate: 1,2-Dichloroethane-d4		107 %		77.3-121		"	"	"	"	
Surrogate: Toluene-d8		102 %		91.4-107		"	"	"	"	
Surrogate: 4-Bromofluorobenzene		108 %		85.3-109		"	"	"	"	

Summit Scientific

The results in this report apply to the samples analyzed in accordance with the chain of custody document. This analytical report must be reproduced in its entirety.



LT Environmental, Inc.
4600 West 60th Avenue
Arvada CO, 80003

Project: PDC - Great Western Sugar #1
Project Number: PDC 0760
Project Manager: John Peterson

Reported:
04/24/09 16:13

MW02
R904103-02 (Water)

Summit Scientific

Volatile Organic Compounds by EPA Method 8260B

Date Sampled: **04/21/09 10:00**

Analyte	Result	Reporting	Units	Dilution	Batch	Prepared	Analyzed	Method	Notes
		Limit							
Benzene	ND	1.0	ug/l	1	9042301	04/23/09	04/23/09	EPA 8260B	
Toluene	ND	1.0	"	"	"	"	"	"	
Ethylbenzene	ND	1.0	"	"	"	"	"	"	
Xylenes (total)	ND	1.0	"	"	"	"	"	"	

Date Sampled: **04/21/09 10:00**

Analyte	Result	Reporting	Units	Dilution	Batch	Prepared	Analyzed	Method	Notes
		Limit							
Surrogate: 1,2-Dichloroethane-d4		113 %	77.3-121		"	"	"	"	
Surrogate: Toluene-d8		99.2 %	91.4-107		"	"	"	"	
Surrogate: 4-Bromofluorobenzene		104 %	85.3-109		"	"	"	"	

Summit Scientific

The results in this report apply to the samples analyzed in accordance with the chain of custody document. This analytical report must be reproduced in its entirety.



LT Environmental, Inc.
4600 West 60th Avenue
Arvada CO, 80003

Project: PDC - Great Western Sugar #1
Project Number: PDC 0760
Project Manager: John Peterson

Reported:
04/24/09 16:13

MW03
R904103-03 (Water)

Summit Scientific

Volatile Organic Compounds by EPA Method 8260B

Date Sampled: **04/21/09 10:10**

Analyte	Result	Reporting	Units	Dilution	Batch	Prepared	Analyzed	Method	Notes
		Limit							
Benzene	ND	1.0	ug/l	1	9042301	04/23/09	04/24/09	EPA 8260B	
Toluene	ND	1.0	"	"	"	"	"	"	
Ethylbenzene	ND	1.0	"	"	"	"	"	"	
Xylenes (total)	ND	1.0	"	"	"	"	"	"	

Date Sampled: **04/21/09 10:10**

Analyte	Result	Reporting	Units	Dilution	Batch	Prepared	Analyzed	Method	Notes
		Limit							
Surrogate: 1,2-Dichloroethane-d4		112 %	77.3-121		"	"	"	"	
Surrogate: Toluene-d8		99.2 %	91.4-107		"	"	"	"	
Surrogate: 4-Bromofluorobenzene		102 %	85.3-109		"	"	"	"	

Summit Scientific

The results in this report apply to the samples analyzed in accordance with the chain of custody document. This analytical report must be reproduced in its entirety.



LT Environmental, Inc.
4600 West 60th Avenue
Arvada CO, 80003

Project: PDC - Great Western Sugar #1
Project Number: PDC 0760
Project Manager: John Peterson

Reported:
04/24/09 16:13

MW04
R904103-04 (Water)

Summit Scientific

Volatile Organic Compounds by EPA Method 8260B

Date Sampled: **04/21/09 10:20**

Analyte	Result	Reporting	Units	Dilution	Batch	Prepared	Analyzed	Method	Notes
		Limit							
Benzene	ND	1.0	ug/l	1	9042301	04/23/09	04/24/09	EPA 8260B	
Toluene	ND	1.0	"	"	"	"	"	"	
Ethylbenzene	ND	1.0	"	"	"	"	"	"	
Xylenes (total)	ND	1.0	"	"	"	"	"	"	

Date Sampled: **04/21/09 10:20**

Analyte	Result	Reporting	Units	Dilution	Batch	Prepared	Analyzed	Method	Notes
		Limit							
Surrogate: 1,2-Dichloroethane-d4		113 %	77.3-121		"	"	"	"	
Surrogate: Toluene-d8		101 %	91.4-107		"	"	"	"	
Surrogate: 4-Bromofluorobenzene		104 %	85.3-109		"	"	"	"	

Summit Scientific

The results in this report apply to the samples analyzed in accordance with the chain of custody document. This analytical report must be reproduced in its entirety.



LT Environmental, Inc.
4600 West 60th Avenue
Arvada CO, 80003

Project: PDC - Great Western Sugar #1
Project Number: PDC 0760
Project Manager: John Peterson

Reported:
04/24/09 16:13

Volatile Organic Compounds by EPA Method 8260B - Quality Control

Summit Scientific

Analyte	Reporting			Spike	Source		%REC		RPD	
	Result	Limit	Units	Level	Result	%REC	Limits	RPD	Limit	Notes

Batch 9042301 - EPA 5030 Water MS

Blank (9042301-BLK1)

Prepared & Analyzed: 04/23/09

Benzene	ND	1.0	ug/l							
Toluene	ND	1.0	"							
Ethylbenzene	ND	1.0	"							
Xylenes (total)	ND	1.0	"							
Surrogate: 1,2-Dichloroethane-d4	14.4		"	13.3	108	77.3-121				
Surrogate: Toluene-d8	12.9		"	13.3	97.0	91.4-107				
Surrogate: 4-Bromofluorobenzene	13.8		"	13.3	104	85.3-109				

LCS (9042301-BS1)

Prepared & Analyzed: 04/23/09

Benzene	28.1	1.0	ug/l	33.3	84.4	70-114				
Toluene	31.8	1.0	"	33.3	95.5	72.7-116				
Surrogate: 1,2-Dichloroethane-d4	15.2		"	13.3	114	77.3-121				
Surrogate: Toluene-d8	14.1		"	13.3	106	91.4-107				
Surrogate: 4-Bromofluorobenzene	13.9		"	13.3	105	85.3-109				

LCS Dup (9042301-BSD1)

Prepared & Analyzed: 04/23/09

Benzene	27.5	1.0	ug/l	33.3	82.6	70-114	2.16	8.14		
Toluene	31.2	1.0	"	33.3	93.7	72.7-116	1.90	7.88		
Surrogate: 1,2-Dichloroethane-d4	15.7		"	13.3	118	77.3-121				
Surrogate: Toluene-d8	13.5		"	13.3	102	91.4-107				
Surrogate: 4-Bromofluorobenzene	13.7		"	13.3	103	85.3-109				

Matrix Spike (9042301-MS1)

Source: R904101-01

Prepared & Analyzed: 04/23/09

Benzene	29.2	1.0	ug/l	33.3	2.3	80.8	66.8-117			
Toluene	29.8	1.0	"	33.3	ND	89.5	71.5-117			
Surrogate: 1,2-Dichloroethane-d4	14.4		"	13.3		108	77.3-121			
Surrogate: Toluene-d8	13.3		"	13.3		100	91.4-107			
Surrogate: 4-Bromofluorobenzene	13.8		"	13.3		104	85.3-109			

Summit Scientific

The results in this report apply to the samples analyzed in accordance with the chain of custody document. This analytical report must be reproduced in its entirety.



LT Environmental, Inc.
4600 West 60th Avenue
Arvada CO, 80003

Project: PDC - Great Western Sugar #1
Project Number: PDC 0760
Project Manager: John Peterson

Reported:
04/24/09 16:13

Volatile Organic Compounds by EPA Method 8260B - Quality Control
Summit Scientific

Analyte	Reporting			Spike	Source		%REC		RPD	
	Result	Limit	Units	Level	Result	%REC	Limits	RPD	Limit	Notes

Batch 9042301 - EPA 5030 Water MS

Matrix Spike Dup (9042301-MSD1)		Source: R904101-01			Prepared & Analyzed: 04/23/09					
Benzene	26.7	1.0	ug/l	33.3	2.3	73.3	66.8-117	8.94	17.8	
Toluene	28.7	1.0	"	33.3	ND	86.2	71.5-117	3.76	14.4	
Surrogate: 1,2-Dichloroethane-d4	14.9		"	13.3		112	77.3-121			
Surrogate: Toluene-d8	13.3		"	13.3		100	91.4-107			
Surrogate: 4-Bromofluorobenzene	13.7		"	13.3		103	85.3-109			

Summit Scientific

The results in this report apply to the samples analyzed in accordance with the chain of custody document. This analytical report must be reproduced in its entirety.



LT Environmental, Inc.
4600 West 60th Avenue
Arvada CO, 80003

Project: PDC - Great Western Sugar #1

Project Number: PDC 0760
Project Manager: John Peterson

Reported:
04/24/09 16:13

Notes and Definitions

DET Analyte DETECTED
ND Analyte NOT DETECTED at or above the reporting limit
NR Not Reported
dry Sample results reported on a dry weight basis
RPD Relative Percent Difference

Summit Scientific

A handwritten signature in black ink, appearing to be 'JM' followed by a long horizontal stroke.

The results in this report apply to the samples analyzed in accordance with the chain of custody document. This analytical report must be reproduced in its entirety.

Summit Scientific

741 Corporate Circle – Suite I ♦ Golden, Colorado 80401

303.277.9310 - laboratory ♦ 303.277.9531 - fax

July 07, 2009

John Peterson

LT Environmental, Inc.

4600 West 60th Avenue

Arvada, CO 80003

RE: PDC - Great Western Sugar #1

Enclosed are the results of analyses for samples received by Summit Scientific on 07/02/09 14:50. If you have any questions concerning this report, please feel free to contact me.

Sincerely,

A handwritten signature in black ink, appearing to be 'LS' or 'Logan Shrewsbury', with a long, sweeping horizontal line extending to the right.

Logan Shrewsbury For Ben Shrewsbury
Vice President / Laboratory Director



LT Environmental, Inc.
4600 West 60th Avenue
Arvada CO, 80003

Project: PDC - Great Western Sugar #1

Project Number: PDC 0760
Project Manager: John Peterson

Reported:
07/07/09 19:53

ANALYTICAL REPORT FOR SAMPLES

Sample ID	Laboratory ID	Matrix	Date Sampled	Date Received
MW01	R907017-01	Water	07/02/09 10:10	07/02/09 14:50
MW02	R907017-02	Water	07/02/09 10:15	07/02/09 14:50
MW03	R907017-03	Water	07/02/09 10:20	07/02/09 14:50
MW04	R907017-04	Water	07/02/09 10:25	07/02/09 14:50

Summit Scientific

The results in this report apply to the samples analyzed in accordance with the chain of custody document. This analytical report must be reproduced in its entirety.

LT Environmental, Inc.
4600 West 60th Avenue
Arvada CO, 80003

Project: PDC - Great Western Sugar #1

Project Number: PDC 0760
Project Manager: John Peterson

Reported:
07/07/09 19:53

Summit Scientific
2907017

741 Corporate Circle Suite I ♦ Golden, Colorado 80401
303-277-9310 ♦ 303-277-9531 Fax

Page 1 of 1

Client: LT Environmental, Inc.

Address: 4600 West 60th Avenue

City/State/Zip: Arvada, CO 80003

Phone: (303) 433-0788

Phone: (303) 433-9188

Sampler Name: M.H.

Project Manager: John Peterson

E-Mail: ineterson@liteny.com

E-Mail: peter.sou@kewiv.com

District Number: 6-1-10-1-8-42

Project Name: Great Western Jugar #2

Project Number: PDC0766

Sample Description	Date Sampled	Time Sampled	Number of Containers	Preservative						Matrix			Analyze For:		Special Instructions		
				HCl	HNO ₃	None	Other (Specify)	Groundwater	Soil	Air - Canister Serial #	Other (Specify)	GRO/DRO				BTEX	
MW01	7-2-09	1010	2		X			X									
MW02	I	1015	2		X			X									
MW03	I	1020	2		X			X									
MW04	I	1025	2		X			X									
Relinquished by: <i>[Signature]</i>	Date/Time: 7-2-09 1450	Received by: <i>[Signature]</i> 7-2-09 1450								Date/Time:			Turn Around Time (Check) Same Day <input type="checkbox"/> 72 Hours <input checked="" type="checkbox"/> 24 Hours <input type="checkbox"/> Standard <input type="checkbox"/> 48 Hours <input type="checkbox"/>			Notes:	
Relinquished by:	Date/Time:	Received by:								Date/Time:			Sample Integrity: Temperature Upon Receipt: 4.3 Intact: Yes <input checked="" type="radio"/> No <input type="radio"/>				
Relinquished by:	Date/Time:	Received in Lab by:								Date/Time:							

www.s2scientific.com

Summit Scientific

The results in this report apply to the samples analyzed in accordance with the chain of custody document. This analytical report must be reproduced in its entirety.



LT Environmental, Inc.
4600 West 60th Avenue
Arvada CO, 80003

Project: PDC - Great Western Sugar #1
Project Number: PDC 0760
Project Manager: John Peterson

Reported:
07/07/09 19:53

MW01
R907017-01 (Water)

Summit Scientific

Volatile Organic Compounds by EPA Method 8260B

Date Sampled: **07/02/09 10:10**

Analyte	Result	Reporting Limit	Units	Dilution	Batch	Prepared	Analyzed	Method	Notes
Benzene	ND	1.0	ug/l	1	9070606	07/06/09	07/07/09	EPA 8260B	
Toluene	ND	1.0	"	"	"	"	"	"	
Ethylbenzene	ND	1.0	"	"	"	"	"	"	
Xylenes (total)	43	1.0	"	"	"	"	"	"	

Date Sampled: **07/02/09 10:10**

Analyte	Result	Reporting Limit	Units	Dilution	Batch	Prepared	Analyzed	Method	Notes
Surrogate: 1,2-Dichloroethane-d4		105 %	77.3-121		"	"	"	"	
Surrogate: Toluene-d8		102 %	91.4-107		"	"	"	"	
Surrogate: 4-Bromofluorobenzene		103 %	85.3-109		"	"	"	"	

Summit Scientific

The results in this report apply to the samples analyzed in accordance with the chain of custody document. This analytical report must be reproduced in its entirety.



LT Environmental, Inc.
4600 West 60th Avenue
Arvada CO, 80003

Project: PDC - Great Western Sugar #1
Project Number: PDC 0760
Project Manager: John Peterson

Reported:
07/07/09 19:53

MW02
R907017-02 (Water)

Summit Scientific

Volatile Organic Compounds by EPA Method 8260B

Date Sampled: **07/02/09 10:15**

Analyte	Result	Reporting		Units	Dilution	Batch	Prepared	Analyzed	Method	Notes
		Limit								
Benzene	ND	1.0		ug/l	1	9070606	07/06/09	07/07/09	EPA 8260B	
Toluene	ND	1.0		"	"	"	"	"	"	
Ethylbenzene	ND	1.0		"	"	"	"	"	"	
Xylenes (total)	ND	1.0		"	"	"	"	"	"	

Date Sampled: **07/02/09 10:15**

Analyte	Result	Reporting		Units	Dilution	Batch	Prepared	Analyzed	Method	Notes
		Limit								
Surrogate: 1,2-Dichloroethane-d4		105 %		77.3-121		"	"	"	"	
Surrogate: Toluene-d8		98.5 %		91.4-107		"	"	"	"	
Surrogate: 4-Bromofluorobenzene		94.0 %		85.3-109		"	"	"	"	

Summit Scientific

The results in this report apply to the samples analyzed in accordance with the chain of custody document. This analytical report must be reproduced in its entirety.



LT Environmental, Inc.
4600 West 60th Avenue
Arvada CO, 80003

Project: PDC - Great Western Sugar #1
Project Number: PDC 0760
Project Manager: John Peterson

Reported:
07/07/09 19:53

MW03
R907017-03 (Water)

Summit Scientific

Volatile Organic Compounds by EPA Method 8260B

Date Sampled: **07/02/09 10:20**

Analyte	Result	Reporting Limit	Units	Dilution	Batch	Prepared	Analyzed	Method	Notes
Benzene	ND	1.0	ug/l	1	9070606	07/06/09	07/07/09	EPA 8260B	
Toluene	ND	1.0	"	"	"	"	"	"	
Ethylbenzene	ND	1.0	"	"	"	"	"	"	
Xylenes (total)	ND	1.0	"	"	"	"	"	"	

Date Sampled: **07/02/09 10:20**

Analyte	Result	Reporting Limit	Units	Dilution	Batch	Prepared	Analyzed	Method	Notes
Surrogate: 1,2-Dichloroethane-d4		107 %	77.3-121		"	"	"	"	
Surrogate: Toluene-d8		100 %	91.4-107		"	"	"	"	
Surrogate: 4-Bromofluorobenzene		94.7 %	85.3-109		"	"	"	"	

Summit Scientific

The results in this report apply to the samples analyzed in accordance with the chain of custody document. This analytical report must be reproduced in its entirety.



LT Environmental, Inc.
4600 West 60th Avenue
Arvada CO, 80003

Project: PDC - Great Western Sugar #1
Project Number: PDC 0760
Project Manager: John Peterson

Reported:
07/07/09 19:53

MW04
R907017-04 (Water)

Summit Scientific

Volatile Organic Compounds by EPA Method 8260B

Date Sampled: **07/02/09 10:25**

Analyte	Result	Reporting Limit	Units	Dilution	Batch	Prepared	Analyzed	Method	Notes
Benzene	2.1	1.0	ug/l	1	9070606	07/06/09	07/07/09	EPA 8260B	
Toluene	ND	1.0	"	"	"	"	"	"	
Ethylbenzene	ND	1.0	"	"	"	"	"	"	
Xylenes (total)	ND	1.0	"	"	"	"	"	"	

Date Sampled: **07/02/09 10:25**

Analyte	Result	Reporting Limit	Units	Dilution	Batch	Prepared	Analyzed	Method	Notes
<i>Surrogate: 1,2-Dichloroethane-d4</i>		<i>107 %</i>	<i>77.3-121</i>		<i>"</i>	<i>"</i>	<i>"</i>	<i>"</i>	
<i>Surrogate: Toluene-d8</i>		<i>100 %</i>	<i>91.4-107</i>		<i>"</i>	<i>"</i>	<i>"</i>	<i>"</i>	
<i>Surrogate: 4-Bromofluorobenzene</i>		<i>94.0 %</i>	<i>85.3-109</i>		<i>"</i>	<i>"</i>	<i>"</i>	<i>"</i>	

Summit Scientific

The results in this report apply to the samples analyzed in accordance with the chain of custody document. This analytical report must be reproduced in its entirety.



LT Environmental, Inc.
4600 West 60th Avenue
Arvada CO, 80003

Project: PDC - Great Western Sugar #1
Project Number: PDC 0760
Project Manager: John Peterson

Reported:
07/07/09 19:53

Volatile Organic Compounds by EPA Method 8260B - Quality Control

Summit Scientific

Analyte	Reporting			Spike	Source		%REC		RPD	
	Result	Limit	Units	Level	Result	%REC	Limits	RPD	Limit	Notes

Batch 9070606 - EPA 5030 Water MS

Blank (9070606-BLK1)

Prepared: 07/06/09 Analyzed: 07/07/09

Benzene	ND	1.0	ug/l							
Toluene	ND	1.0	"							
Ethylbenzene	ND	1.0	"							
Xylenes (total)	ND	1.0	"							
Surrogate: 1,2-Dichloroethane-d4	13.8		"	13.3	104	77.3-121				
Surrogate: Toluene-d8	13.8		"	13.3	104	91.4-107				
Surrogate: 4-Bromofluorobenzene	12.0		"	13.3	90.2	85.3-109				

LCS (9070606-BS1)

Prepared: 07/06/09 Analyzed: 07/07/09

Benzene	25.8	1.0	ug/l	33.3	77.5	70-114				
Toluene	28.8	1.0	"	33.3	86.5	72.7-116				
Surrogate: 1,2-Dichloroethane-d4	13.2		"	13.3	99.2	77.3-121				
Surrogate: Toluene-d8	12.6		"	13.3	94.7	91.4-107				
Surrogate: 4-Bromofluorobenzene	11.7		"	13.3	88.0	85.3-109				

LCS Dup (9070606-BSD1)

Prepared: 07/06/09 Analyzed: 07/07/09

Benzene	26.4	1.0	ug/l	33.3	79.3	70-114	2.30	8.14		
Toluene	29.7	1.0	"	33.3	89.2	72.7-116	3.08	7.88		
Surrogate: 1,2-Dichloroethane-d4	13.1		"	13.3	98.5	77.3-121				
Surrogate: Toluene-d8	13.3		"	13.3	100	91.4-107				
Surrogate: 4-Bromofluorobenzene	11.8		"	13.3	88.7	85.3-109				

Matrix Spike (9070606-MS1)

Source: R906208-01

Prepared: 07/06/09 Analyzed: 07/07/09

Benzene	26.6	1.0	ug/l	33.3	ND	79.9	66.8-117			
Toluene	29.5	1.0	"	33.3	ND	88.6	71.5-117			
Surrogate: 1,2-Dichloroethane-d4	14.0		"	13.3		105	77.3-121			
Surrogate: Toluene-d8	13.1		"	13.3		98.5	91.4-107			
Surrogate: 4-Bromofluorobenzene	11.9		"	13.3		89.5	85.3-109			

Summit Scientific

The results in this report apply to the samples analyzed in accordance with the chain of custody document. This analytical report must be reproduced in its entirety.



LT Environmental, Inc.
4600 West 60th Avenue
Arvada CO, 80003

Project: PDC - Great Western Sugar #1
Project Number: PDC 0760
Project Manager: John Peterson

Reported:
07/07/09 19:53

Volatile Organic Compounds by EPA Method 8260B - Quality Control
Summit Scientific

Analyte	Reporting			Spike	Source		%REC		RPD	
	Result	Limit	Units	Level	Result	%REC	Limits	RPD	Limit	Notes

Batch 9070606 - EPA 5030 Water MS

Matrix Spike Dup (9070606-MSD1)				Source: R906208-01		Prepared: 07/06/09		Analyzed: 07/07/09		
Benzene	24.8	1.0	ug/l	33.3	ND	74.5	66.8-117	7.00	17.8	
Toluene	27.7	1.0	"	33.3	ND	83.2	71.5-117	6.29	14.4	
Surrogate: 1,2-Dichloroethane-d4	13.7		"	13.3		103	77.3-121			
Surrogate: Toluene-d8	12.8		"	13.3		96.2	91.4-107			
Surrogate: 4-Bromofluorobenzene	12.2		"	13.3		91.7	85.3-109			

Summit Scientific

The results in this report apply to the samples analyzed in accordance with the chain of custody document. This analytical report must be reproduced in its entirety.



LT Environmental, Inc.
4600 West 60th Avenue
Arvada CO, 80003

Project: PDC - Great Western Sugar #1

Project Number: PDC 0760
Project Manager: John Peterson

Reported:
07/07/09 19:53

Notes and Definitions

DET Analyte DETECTED
ND Analyte NOT DETECTED at or above the reporting limit
NR Not Reported
dry Sample results reported on a dry weight basis
RPD Relative Percent Difference

Summit Scientific

A handwritten signature in black ink, appearing to be 'JP' or similar, with a long horizontal stroke extending to the right.

The results in this report apply to the samples analyzed in accordance with the chain of custody document. This analytical report must be reproduced in its entirety.

Summit Scientific

741 Corporate Circle – Suite I ♦ Golden, Colorado 80401

303.277.9310 - laboratory ♦ 303.277.9531 - fax

October 26, 2009

John Peterson

LT Environmental, Inc.

4600 West 60th Avenue

Arvada, CO 80003

RE: PDC - Great Western Sugar #1

Enclosed are the results of analyses for samples received by Summit Scientific on 10/21/09 17:00. If you have any questions concerning this report, please feel free to contact me.

Sincerely,

A handwritten signature in black ink, appearing to be 'PS' followed by a long, sweeping horizontal line.

Paul Shrewsbury For Ben Shrewsbury
President / Laboratory Director



LT Environmental, Inc.
4600 West 60th Avenue
Arvada CO, 80003

Project: PDC - Great Western Sugar #1

Project Number: PDC 0760
Project Manager: John Peterson

Reported:
10/26/09 14:45

ANALYTICAL REPORT FOR SAMPLES

Sample ID	Laboratory ID	Matrix	Date Sampled	Date Received
MW01	R910126-01	Water	10/21/09 11:20	10/21/09 17:00
MW02	R910126-02	Water	10/21/09 11:25	10/21/09 17:00
MW03	R910126-03	Water	10/21/09 11:30	10/21/09 17:00
MW04	R910126-04	Water	10/21/09 11:35	10/21/09 17:00

Summit Scientific

The results in this report apply to the samples analyzed in accordance with the chain of custody document. This analytical report must be reproduced in its entirety.

LT Environmental, Inc.
4600 West 60th Avenue
Arvada CO, 80003

Project: PDC - Great Western Sugar #1

Project Number: PDC 0760
Project Manager: John Peterson

Reported:
10/26/09 14:45

Summit Scientific
29/10/20

741 Corporate Circle Suite I ♦ Golden, Colorado 80401
303-277-9310 ♦ 303-277-9531 Fax

Client: LT Environmental, Inc.

Address: 4600 West 60th Avenue

City/State/Zip: Arvada, CO 80003

Phone: (303) 433-9788

Sampler Name: P. K.

Sample Name: AYEA

Project Manager:

E-Mail: info@pauline.com

Project Name:

Project Number:

Project number.

5

John Peterson

Person @ nos 24

front Westch

Ans 27/00

05/07/20

1

100

工

1

[illegible]

www.s2scientific.com

Summit Scientific

The results in this report apply to the samples analyzed in accordance with the chain of custody document. This analytical report must be reproduced in its entirety.



LT Environmental, Inc.
4600 West 60th Avenue
Arvada CO, 80003

Project: PDC - Great Western Sugar #1
Project Number: PDC 0760
Project Manager: John Peterson

Reported:
10/26/09 14:45

MW01
R910126-01 (Water)

Summit Scientific

Volatile Organic Compounds by EPA Method 8260B

Date Sampled: **10/21/09 11:20**

Analyte	Result	Reporting Limit	Units	Dilution	Batch	Prepared	Analyzed	Method	Notes
Benzene	4.5	1.0	ug/l	1	9102303	10/23/09	10/24/09	EPA 8260B	
Toluene	1.0	1.0	"	"	"	"	"	"	
Ethylbenzene	ND	1.0	"	"	"	"	"	"	
Xylenes (total)	87	1.0	"	"	"	"	"	"	

Date Sampled: **10/21/09 11:20**

Analyte	Result	Reporting Limit	Units	Dilution	Batch	Prepared	Analyzed	Method	Notes
<i>Surrogate: 1,2-Dichloroethane-d4</i>		95.9 %	74.3-129		"	"	"	"	
<i>Surrogate: Toluene-d8</i>		98.9 %	87.7-110		"	"	"	"	
<i>Surrogate: 4-Bromofluorobenzene</i>		103 %	83.5-115		"	"	"	"	

Summit Scientific

The results in this report apply to the samples analyzed in accordance with the chain of custody document. This analytical report must be reproduced in its entirety.



LT Environmental, Inc.
4600 West 60th Avenue
Arvada CO, 80003

Project: PDC - Great Western Sugar #1
Project Number: PDC 0760
Project Manager: John Peterson

Reported:
10/26/09 14:45

MW02
R910126-02 (Water)

Summit Scientific

Volatile Organic Compounds by EPA Method 8260B

Date Sampled: **10/21/09 11:25**

Analyte	Result	Reporting		Units	Dilution	Batch	Prepared	Analyzed	Method	Notes
		Limit								
Benzene	ND	1.0		ug/l	1	9102303	10/23/09	10/24/09	EPA 8260B	
Toluene	ND	1.0		"	"	"	"	"	"	
Ethylbenzene	ND	1.0		"	"	"	"	"	"	
Xylenes (total)	ND	1.0		"	"	"	"	"	"	

Date Sampled: **10/21/09 11:25**

Analyte	Result	Reporting		Units	Dilution	Batch	Prepared	Analyzed	Method	Notes
		Limit								
Surrogate: 1,2-Dichloroethane-d4		95.0 %		74.3-129		"	"	"	"	
Surrogate: Toluene-d8		97.4 %		87.7-110		"	"	"	"	
Surrogate: 4-Bromofluorobenzene		96.1 %		83.5-115		"	"	"	"	

Summit Scientific

The results in this report apply to the samples analyzed in accordance with the chain of custody document. This analytical report must be reproduced in its entirety.



LT Environmental, Inc.
4600 West 60th Avenue
Arvada CO, 80003

Project: PDC - Great Western Sugar #1
Project Number: PDC 0760
Project Manager: John Peterson

Reported:
10/26/09 14:45

MW03
R910126-03 (Water)

Summit Scientific

Volatile Organic Compounds by EPA Method 8260B

Date Sampled: **10/21/09 11:30**

Analyte	Result	Reporting Limit	Units	Dilution	Batch	Prepared	Analyzed	Method	Notes
Benzene	ND	1.0	ug/l	1	9102303	10/23/09	10/24/09	EPA 8260B	
Toluene	ND	1.0	"	"	"	"	"	"	
Ethylbenzene	ND	1.0	"	"	"	"	"	"	
Xylenes (total)	ND	1.0	"	"	"	"	"	"	

Date Sampled: **10/21/09 11:30**

Analyte	Result	Reporting Limit	Units	Dilution	Batch	Prepared	Analyzed	Method	Notes
Surrogate: 1,2-Dichloroethane-d4		95.4 %	74.3-129		"	"	"	"	
Surrogate: Toluene-d8		96.9 %	87.7-110		"	"	"	"	
Surrogate: 4-Bromofluorobenzene		94.3 %	83.5-115		"	"	"	"	

Summit Scientific

The results in this report apply to the samples analyzed in accordance with the chain of custody document. This analytical report must be reproduced in its entirety.



LT Environmental, Inc.
4600 West 60th Avenue
Arvada CO, 80003

Project: PDC - Great Western Sugar #1
Project Number: PDC 0760
Project Manager: John Peterson

Reported:
10/26/09 14:45

MW04
R910126-04 (Water)

Summit Scientific

Volatile Organic Compounds by EPA Method 8260B

Date Sampled: **10/21/09 11:35**

Analyte	Result	Reporting		Units	Dilution	Batch	Prepared	Analyzed	Method	Notes
		Limit								
Benzene	ND	1.0		ug/l	1	9102303	10/23/09	10/24/09	EPA 8260B	
Toluene	ND	1.0		"	"	"	"	"	"	
Ethylbenzene	ND	1.0		"	"	"	"	"	"	
Xylenes (total)	ND	1.0		"	"	"	"	"	"	

Date Sampled: **10/21/09 11:35**

Analyte	Result	Reporting		Units	Dilution	Batch	Prepared	Analyzed	Method	Notes
		Limit								
Surrogate: 1,2-Dichloroethane-d4		95.2 %		74.3-129		"	"	"	"	
Surrogate: Toluene-d8		97.8 %		87.7-110		"	"	"	"	
Surrogate: 4-Bromofluorobenzene		94.0 %		83.5-115		"	"	"	"	

Summit Scientific

The results in this report apply to the samples analyzed in accordance with the chain of custody document. This analytical report must be reproduced in its entirety.



LT Environmental, Inc.
4600 West 60th Avenue
Arvada CO, 80003

Project: PDC - Great Western Sugar #1
Project Number: PDC 0760
Project Manager: John Peterson

Reported:
10/26/09 14:45

Volatile Organic Compounds by EPA Method 8260B - Quality Control

Summit Scientific

Analyte	Reporting			Spike	Source		%REC		RPD	
	Result	Limit	Units	Level	Result	%REC	Limits	RPD	Limit	Notes

Batch 9102303 - EPA 5030 Water MS

Blank (9102303-BLK1)

Prepared & Analyzed: 10/23/09

Benzene	ND	1.0	ug/l							
Toluene	ND	1.0	"							
Ethylbenzene	ND	1.0	"							
Xylenes (total)	ND	1.0	"							
Surrogate: 1,2-Dichloroethane-d4	12.3		"	13.3		92.3	74.3-129			
Surrogate: Toluene-d8	12.9		"	13.3		96.9	87.7-110			
Surrogate: 4-Bromofluorobenzene	12.5		"	13.3		94.0	83.5-115			

LCS (9102303-BS1)

Prepared & Analyzed: 10/23/09

Benzene	28.9	1.0	ug/l	33.3		86.8	70-114		8.14	
Toluene	32.0	1.0	"	33.3		96.0	72.7-116		7.88	
Surrogate: 1,2-Dichloroethane-d4	12.7		"	13.3		95.3	74.3-129			
Surrogate: Toluene-d8	12.9		"	13.3		96.7	87.7-110			
Surrogate: 4-Bromofluorobenzene	12.5		"	13.3		93.5	83.5-115			

LCS Dup (9102303-BSD1)

Prepared & Analyzed: 10/23/09

Benzene	29.0	1.0	ug/l	33.3		87.2	70-114	0.414	8.14	
Toluene	32.2	1.0	"	33.3		96.5	72.7-116	0.561	7.88	
Surrogate: 1,2-Dichloroethane-d4	12.6		"	13.3		94.6	74.3-129			
Surrogate: Toluene-d8	12.9		"	13.3		96.7	87.7-110			
Surrogate: 4-Bromofluorobenzene	12.2		"	13.3		91.6	83.5-115			

Matrix Spike (9102303-MS1)

Source: R910124-01

Prepared & Analyzed: 10/23/09

Benzene	29.0	1.0	ug/l	33.3	ND	86.9	66.8-117		17.8	
Toluene	32.2	1.0	"	33.3	ND	96.7	71.5-117		14.4	
Surrogate: 1,2-Dichloroethane-d4	13.3		"	13.3		99.8	74.3-129			
Surrogate: Toluene-d8	13.0		"	13.3		97.7	87.7-110			
Surrogate: 4-Bromofluorobenzene	12.6		"	13.3		94.4	83.5-115			

Summit Scientific

The results in this report apply to the samples analyzed in accordance with the chain of custody document. This analytical report must be reproduced in its entirety.



LT Environmental, Inc.
4600 West 60th Avenue
Arvada CO, 80003

Project: PDC - Great Western Sugar #1
Project Number: PDC 0760
Project Manager: John Peterson

Reported:
10/26/09 14:45

Volatile Organic Compounds by EPA Method 8260B - Quality Control
Summit Scientific

Analyte	Reporting			Spike	Source		%REC		RPD	
	Result	Limit	Units	Level	Result	%REC	Limits	RPD	Limit	Notes

Batch 9102303 - EPA 5030 Water MS

Matrix Spike Dup (9102303-MSD1)		Source: R910124-01			Prepared & Analyzed: 10/23/09					
Benzene	25.0	1.0	ug/l	33.3	ND	74.9	66.8-117	14.8	17.8	
Toluene	27.7	1.0	"	33.3	ND	83.0	71.5-117	15.2	14.4	
Surrogate: 1,2-Dichloroethane-d4	14.8		"	13.3		111	74.3-129			
Surrogate: Toluene-d8	13.0		"	13.3		97.6	87.7-110			
Surrogate: 4-Bromofluorobenzene	12.8		"	13.3		95.9	83.5-115			

Summit Scientific

The results in this report apply to the samples analyzed in accordance with the chain of custody document. This analytical report must be reproduced in its entirety.



LT Environmental, Inc.
4600 West 60th Avenue
Arvada CO, 80003

Project: PDC - Great Western Sugar #1

Project Number: PDC 0760
Project Manager: John Peterson

Reported:
10/26/09 14:45

Notes and Definitions

DET Analyte DETECTED
ND Analyte NOT DETECTED at or above the reporting limit
NR Not Reported
dry Sample results reported on a dry weight basis
RPD Relative Percent Difference

Summit Scientific

A handwritten signature in black ink, appearing to be 'JM' followed by a long horizontal stroke.

The results in this report apply to the samples analyzed in accordance with the chain of custody document. This analytical report must be reproduced in its entirety.