

**EOG RESOURCES, INC.  
CRITTER CREEK #08-14H  
SECTION 14, T11N, R63W, 6th P.M.**

PROCEED IN A WESTERLY DIRECTION FROM HEREFORD, COLORADO ON COUNTY ROAD 136 APPROXIMATELY 1.5 MILES TO THE JUNCTION OF COUNTY ROAD 136 AND HIGHWAY 77 TO THE SOUTH; TURN LEFT AND PROCEED IN A SOUTHERLY DIRECTION APPROXIMATELY 2.0 MILES TO THE JUNCTION OF HIGHWAY 77 AND COUNTY ROAD 132 TO THE WEST; TURN RIGHT AND PROCEED IN A WESTERLY DIRECTION APPROXIMATELY 3.0 MILES TO THE JUNCTION OF COUNTY ROAD 132 AND COUNTY ROAD 71 TO THE SOUTH; TURN LEFT AND PROCEED IN A SOUTHERLY DIRECTION APPROXIMATELY 1.0 MILES TO THE BEGINNING OF THE PROPOSED ACCESS ROAD TO THE SOUTH; FOLLOW ROAD FLAGS IN A SOUTHERLY, THEN WESTERLY, THEN NORTHRLY DIRECTION APPROXIMATELY 1.1 MILES TO THE PROPOSED LOCATION.

TOTAL DISTANCE FROM HEREFORD, COLORADO TO THE PROPOSED LOCATION IS APPROXIMATELY 8.6 MILES.

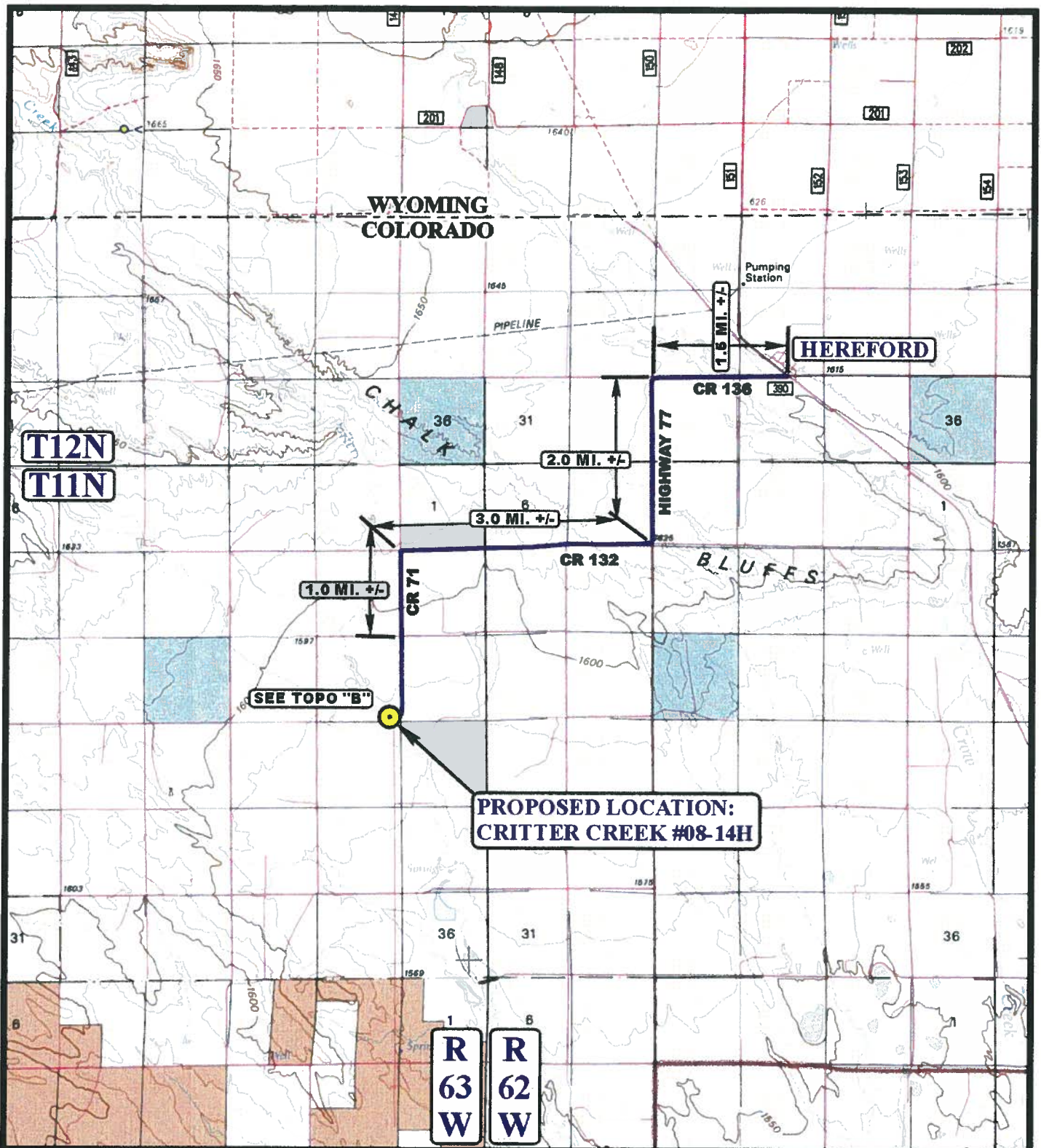

**LEGEND:**

**PROPOSED LOCATION**



**EOG RESOURCES, INC.**

**CRITTER CREEK #08-14H**  
**SECTION 14, T11N, R63W, 6th P.M.**  
**600' FSL 600' FEL**



**Utah Engineering & Land Surveying**  
85 South 200 East Vernal, Utah 84078  
(435) 789-1017 \* FAX (435) 789-1813

**ACCESS ROAD**  
**MAP**

**12 22 09**  
MONTH DAY YEAR

**SCALE: 1:100,000** **DRAWN BY: J.H.** **REVISED: 00-00-00**



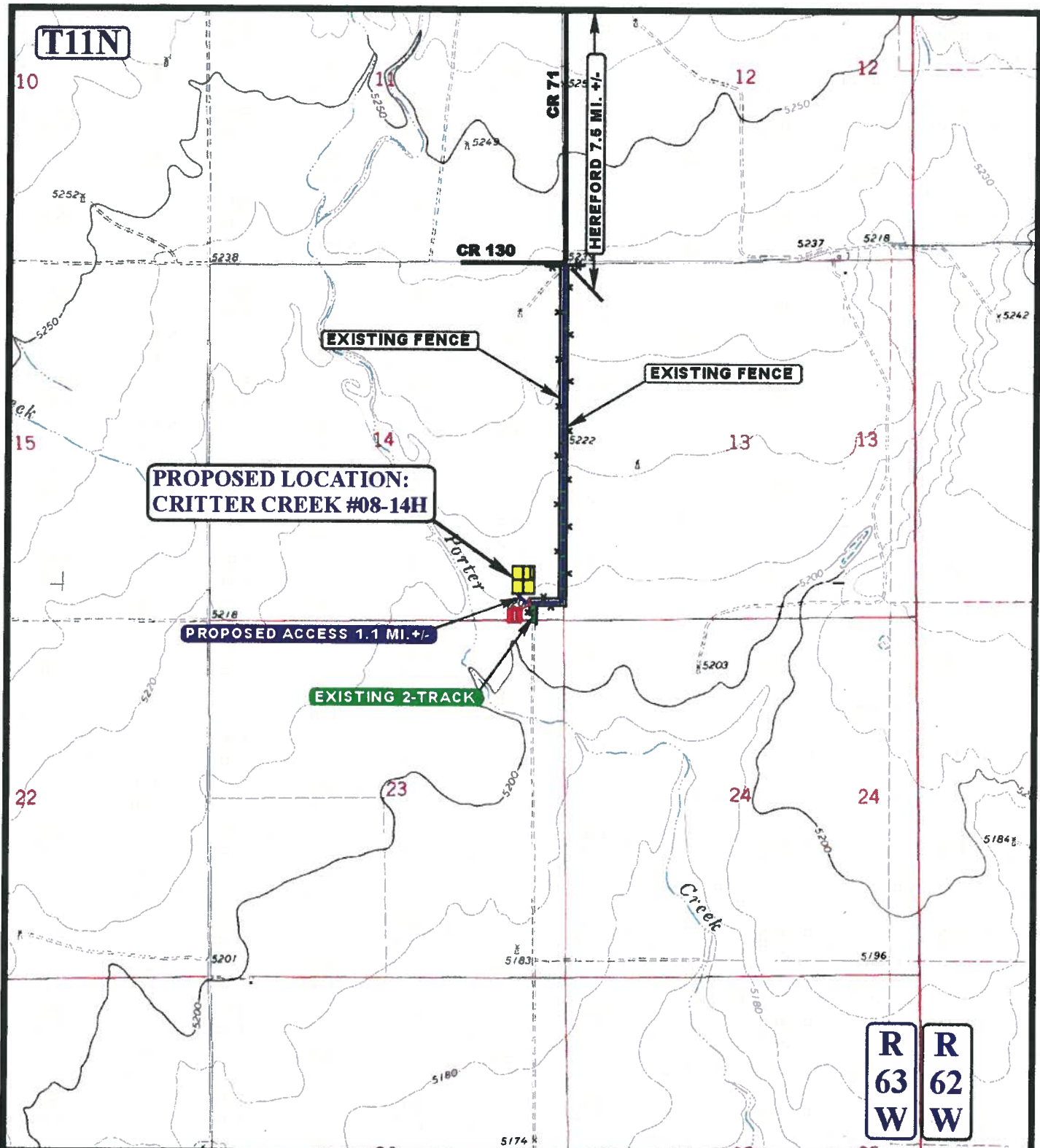

# **LEGEND:**

- EXISTING ROAD
- EXISTING 2-TRACK
- PROPOSED ACCESS ROAD
- \* \* \* \* EXISTING FENCE
- INSTALL CATTLE GUARD

**EOG RESOURCES, INC.**

**CRITTER CREEK #08-14H**  
**SECTION 14, T11N, R63W, 6th P.M.**  
**600' FSL 600' FEL**

**U  
E  
L  
S**

Uintah Engineering & Land Surveying  
 85 South 200 East Vernal, Utah 84078  
 (435) 789-1017 \* FAX (435) 789-1813



**ACCESS ROAD  
MAP**

**12 22 09**  
 MONTH DAY YEAR

**B  
TOPO**

SCALE: 1" = 2000' DRAWN BY: J.H. REVISED: 00-00-00