

EOG RESOURCES, INC.
FOX CREEK #05-28H
SECTION 28, T12N, R63W, 6th P.M.

PROCEED IN A WESTERLY DIRECTION FROM HEREFORD, COLORADO ON COUNTY ROAD #136 APPROXIMATELY 4.5 MILES TO THE JUNCTION OF COUNTY ROAD #136 AND COUNTY ROAD #204 TO THE NORTH; TURN RIGHT AND PROCEED IN A NORTHERLY DIRECTION APPROXIMATELY 0.5 MILES TO THE JUNCTION OF COUNTY ROAD #204 AND COUNTY ROAD #136.5 TO THE WEST; TURN LEFT AND PROCEED IN A WESTERLY, THEN SOUTHWESTERLY DIRECTION APPROXIMATELY 1.7 MILES TO THE BEGINNING OF THE PROPOSED ACCESS ROAD FOR THE ELSIE #7-34H TO THE WEST; FOLLOW ROAD FLAGS IN A WESTERLY, THEN SOUTHWESTERLY DIRECTION APPROXIMATELY 0.5 MILES TO THE BEGINNING OF THE PROPOSED ACCESS TO THE NORTHWEST; FOLLOW ROAD FLAGS IN A NORTHWESTERLY DIRECTION APPROXIMATELY 320' TO THE PROPOSED LOCATION.

TOTAL DISTANCE FROM HEREFORD, COLORADO TO THE PROPOSED LOCATION IS APPROXIMATELY 7.2 MILES.

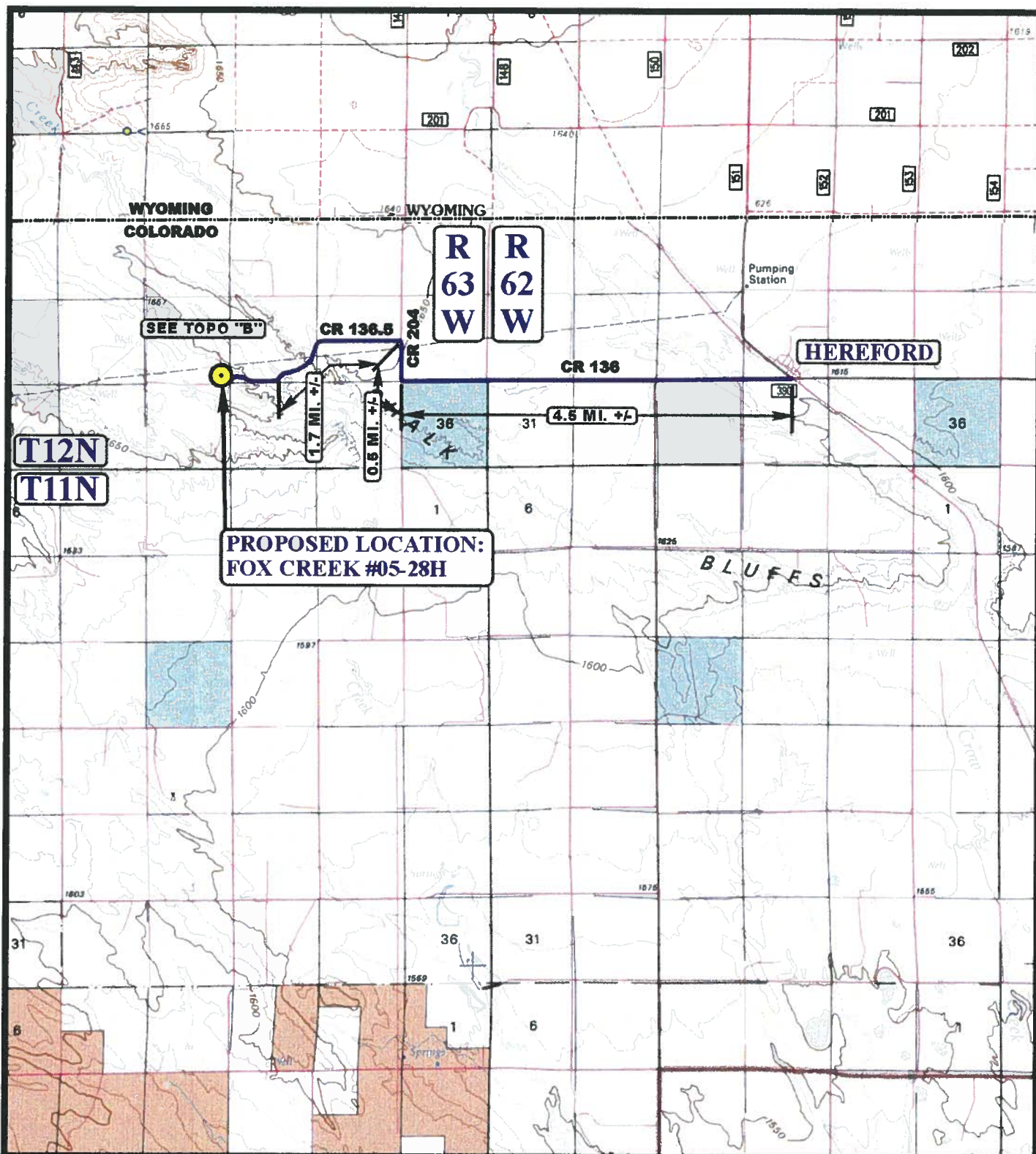

LEGEND:

 PROPOSED LOCATION

EOG RESOURCES, INC.

FOX CREEK #05-28H
SECTION 28, T12N, R63W, 6th P.M.
501' FSL 501' FEL

U
E
S

Uintah Engineering & Land Surveying
 85 South 200 East Vernal, Utah 84078
 (435) 789-1017 * FAX (435) 789-1813



ACCESS ROAD
MAP

01 **11** **10**
 MONTH DAY YEAR

SCALE: 1:100,000 DRAWN BY: J.H. REVISED: 00-00-00

A
TOPO

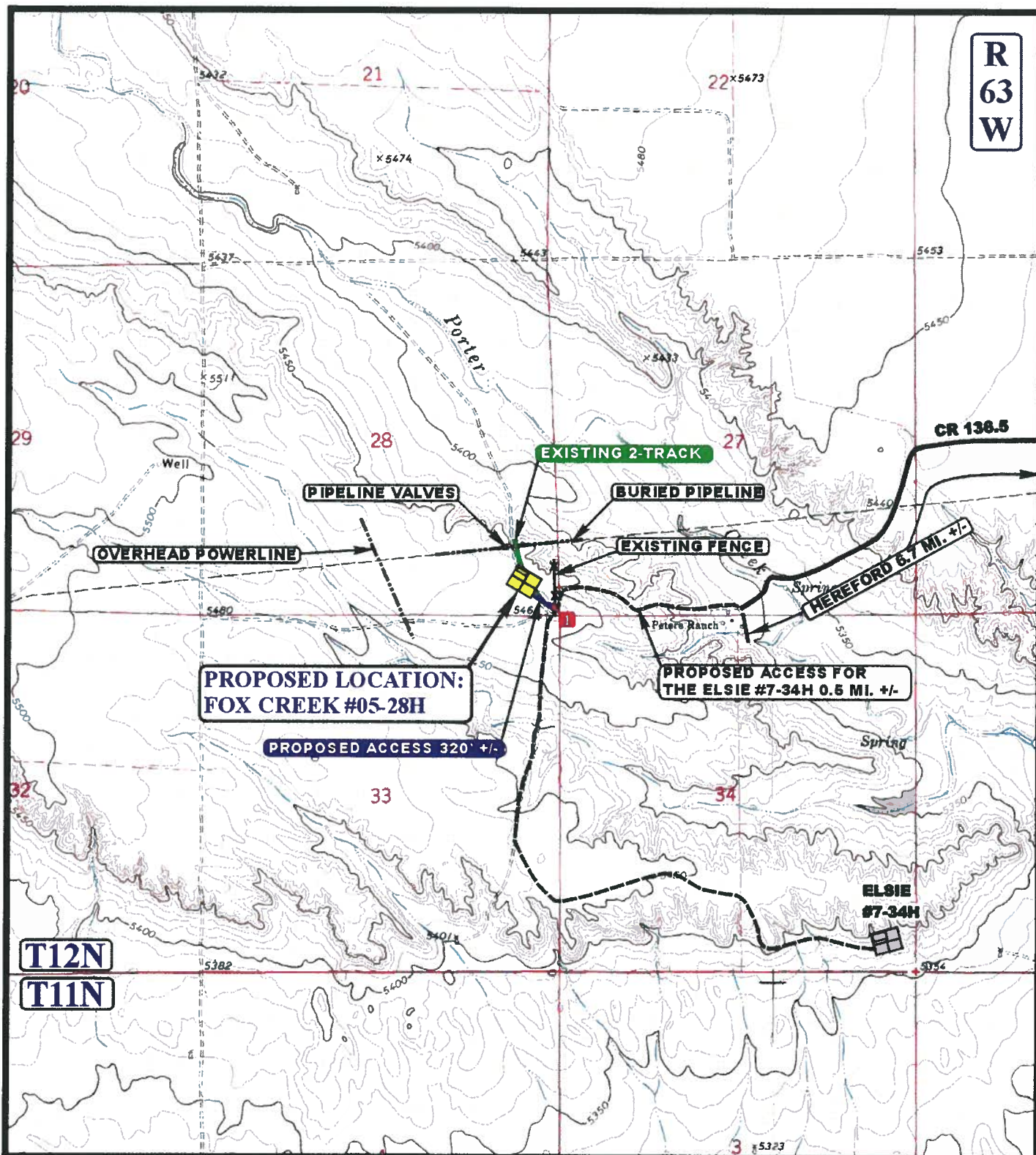

LEGEND:

- EXISTING ROAD
- EXISTING 2-TRACK
- PROPOSED ACCESS ROAD
- EXISTING UTILITY
- EXISTING FENCE
- EXISTING CATTLE GUARD



Uintah Engineering & Land Surveying
 85 South 200 East Vernal, Utah 84078
 (435) 789-1017 * FAX (435) 789-1813



EOG RESOURCES, INC.

FOX CREEK #05-28H
 SECTION 28, T12N, R63W, 6th P.M.
 501' FSL 501' FEL

ACCESS ROAD
 MAP

01 11 10
 MONTH DAY YEAR

SCALE: 1" = 2000' DRAWN BY: J.H. REVISED: 00-00-00

B
 TOPO