

EOG RESOURCES, INC.

CONSTRUCTION LAYOUT FOR

GARDEN CREEK #03-05H
SECTION 5, T11N, R62W, 6th P.M.
600' FSL 600' FEL

FIGURE #1

SCALE: 1" = 60'
DATE: 01-06-10
DRAWN BY: D.R.B.

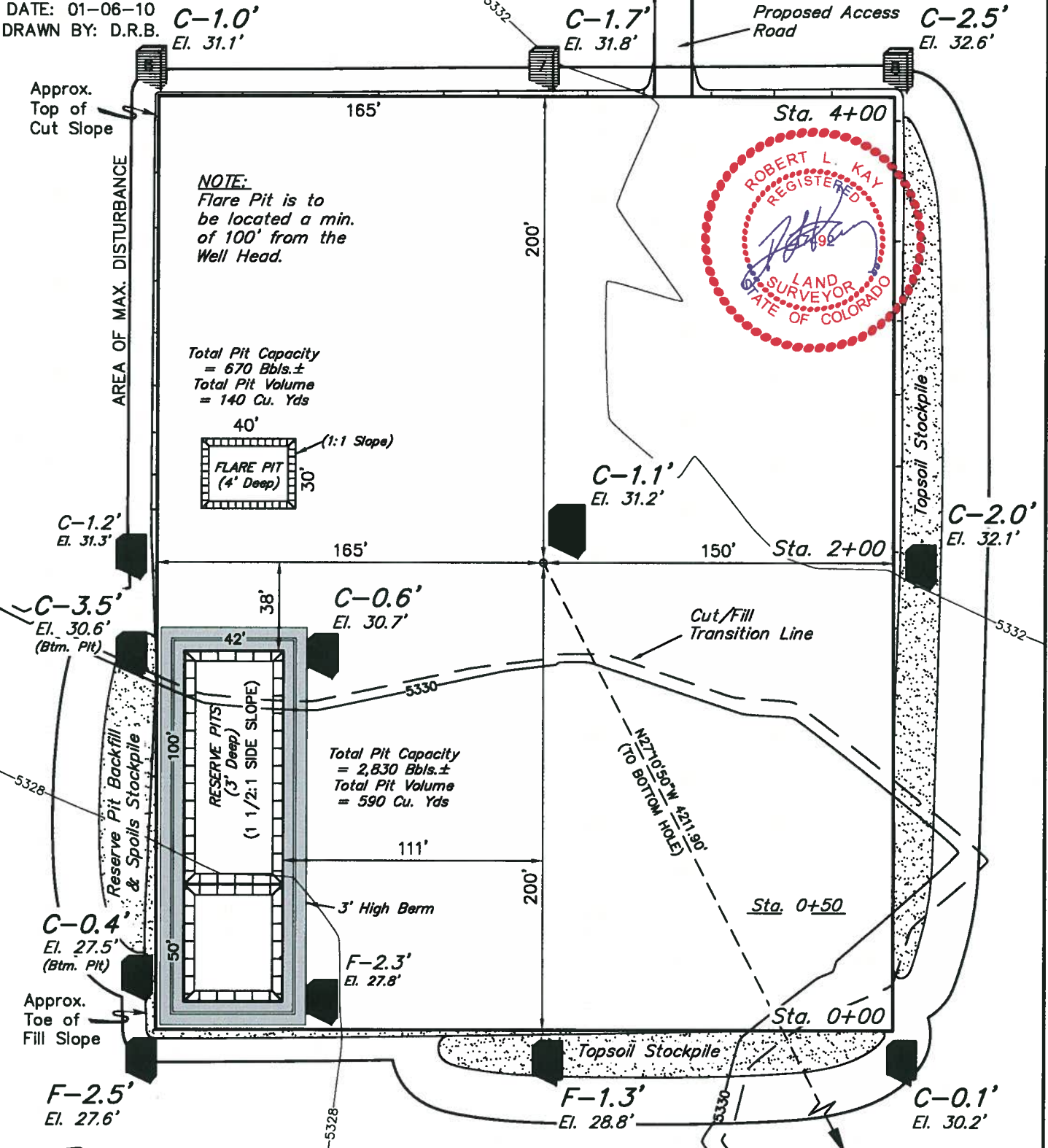

Elev. Ungraded Ground At Loc. Stake = 5331.2'
FINISHED GRADE ELEV. AT LOC. STAKE = 5330.1'

UINTAH ENGINEERING & LAND SURVEYING
85 So. 200 East * Vernal, Utah 84078 * (435) 789-1017

1" = 40'
X-Section
Scale
1" = 100'

DATE: 01-06-10
DRAWN BY: D.R.B.

EOG RESOURCES, INC.
CONSTRUCTION LAYOUT CROSS SECTION FOR
GARDEN CREEK #03-05H
SECTION 5, T11N, R62W, 6th P.M.
600' FSL 600' FEL

FIGURE #2

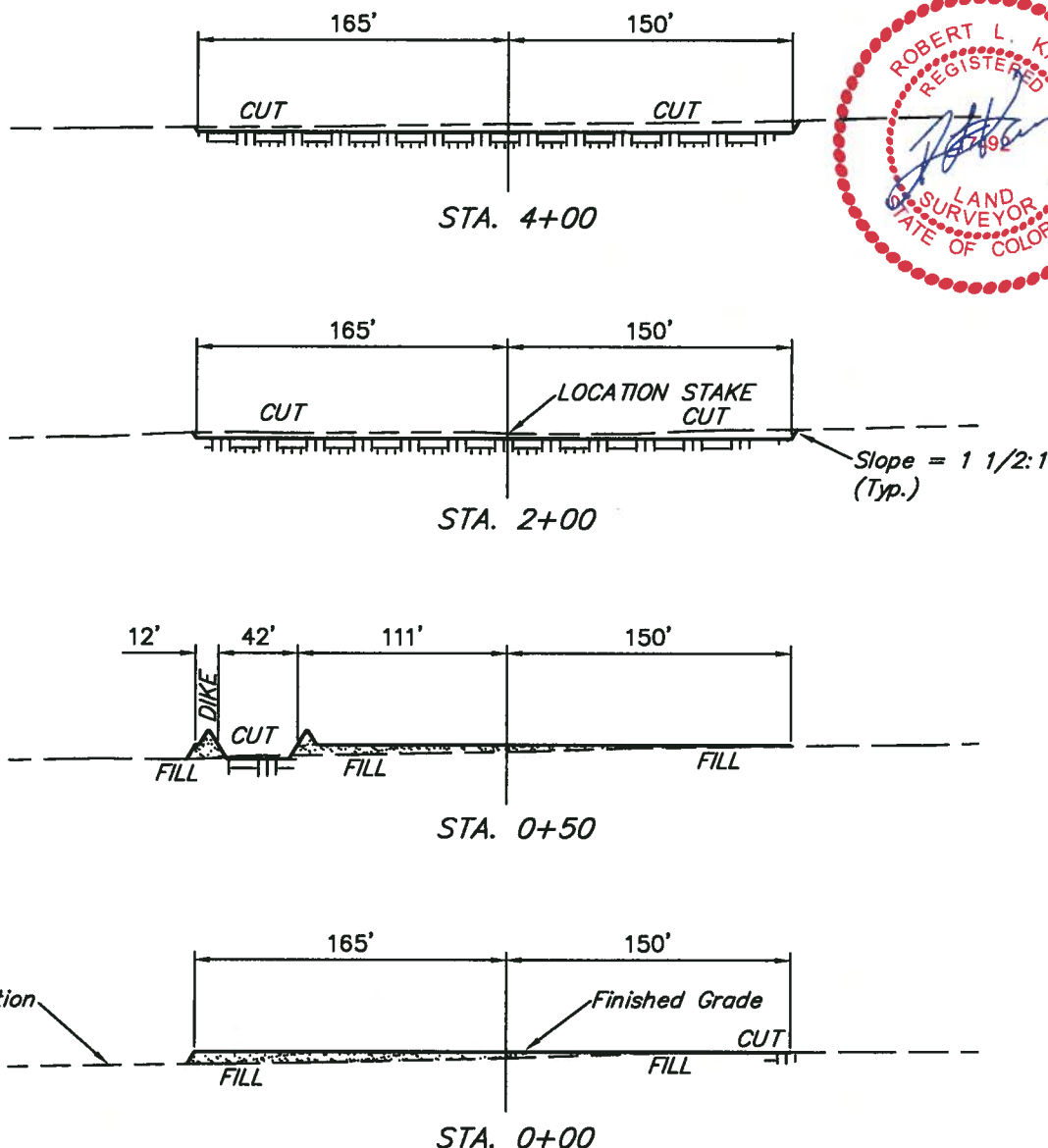

NOTE:

Topsoil should not be
Stripped Below Finished
Grade on Substructure Area.

APPROXIMATE ACREAGES
WELL SITE DISTURBANCE = ± 3.773 ACRES
ACCESS ROAD DISTURBANCE = ± 0.265 ACRES
TOTAL = ± 4.038 ACRES

* NOTE:
FILL QUANTITY INCLUDES
5% FOR COMPACTION

APPROXIMATE YARDAGES

(6") Topsoil Stripping = 2,420 Cu. Yds.
Remaining Location = 3,150 Cu. Yds.
TOTAL CUT = 5,570 CU.YDS.
FILL = 2,850 CU.YDS.

EXCESS MATERIAL = 2,720 Cu. Yds.
Topsoil & Pit Backfill = 2,720 Cu. Yds.
(1/2 Pit Vol.)
EXCESS UNBALANCE = 0 Cu. Yds.
(After Interim Rehabilitation)

UINTAH ENGINEERING & LAND SURVEYING
85 So. 200 East * Vernal, Utah 84078 * (435) 789-1017

EOG RESOURCES, INC.

FIGURE #3

SCALE: 1" = 60'
DATE: 01-06-10
DRAWN BY: D.R.B.

TYPICAL RIG LAYOUT FOR
GARDEN CREEK #03-05H
SECTION 5, T11N, R62W, 6th P.M.
600' FSL 600' FEL



Access Road

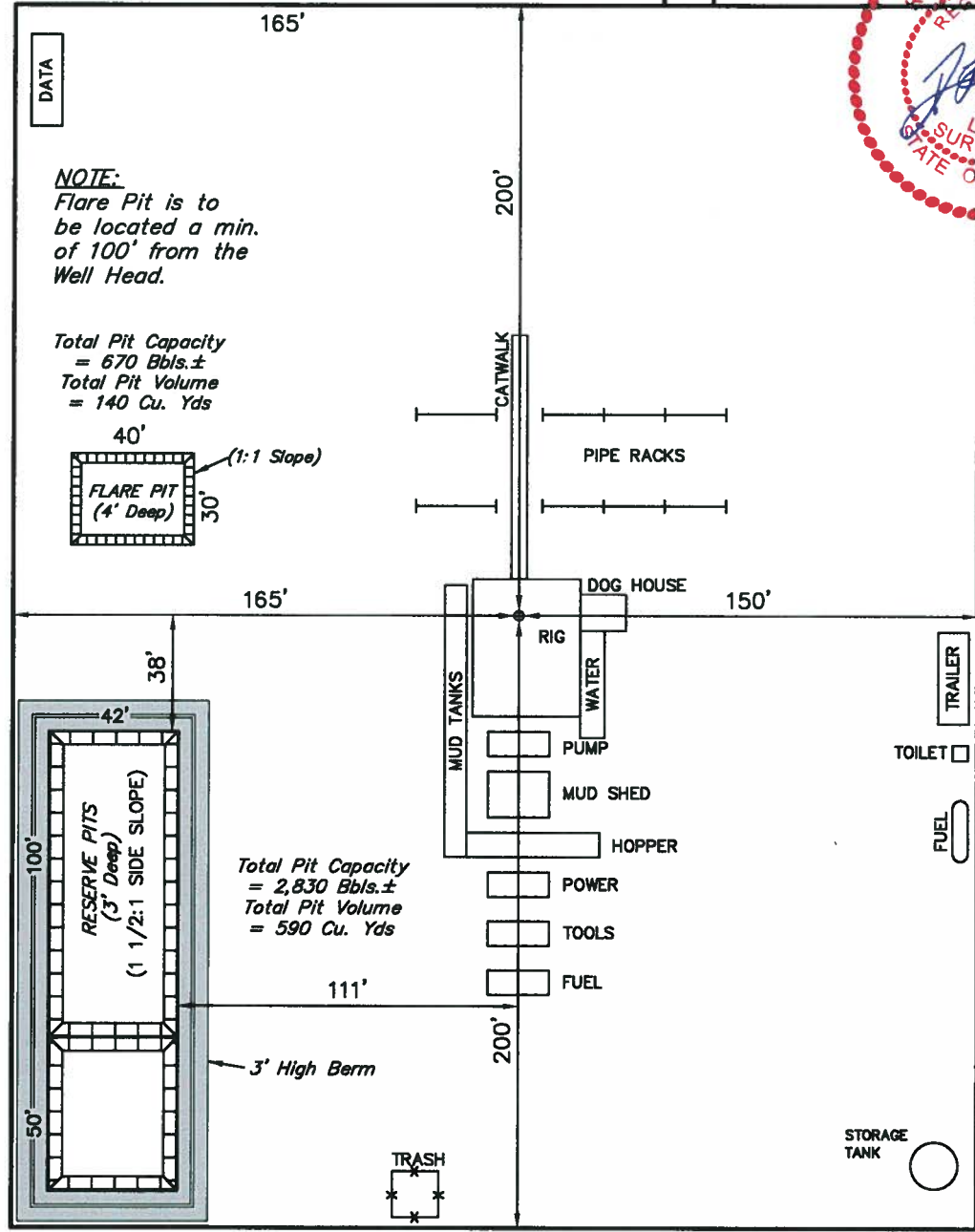



SCALE: 1" = 60'
DATE: 01-06-10
DRAWN BY: D.R.B.

EOG RESOURCES, INC.
RECLAMATION DIAGRAM FOR
GARDEN CREEK #03-05H
SECTION 5, T11N, R62W, 6th P.M.
600' FSL 600' FEL

FIGURE #4

Access Road

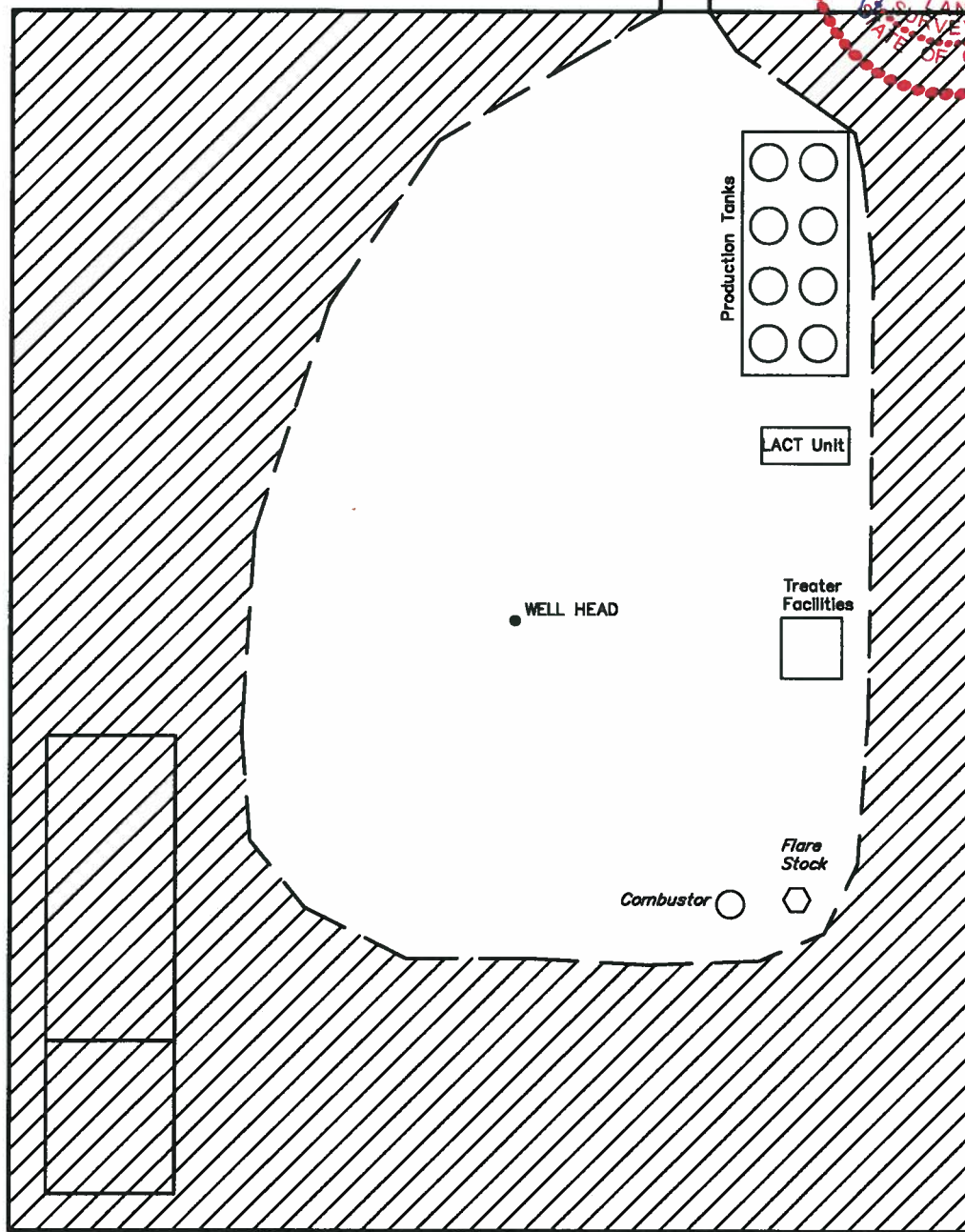

APPROXIMATE ACREAGES
UN-RECLAIMED AREA = \pm 1.220 ACRES



RE-HABBED AREA

UINTAH ENGINEERING & LAND SURVEYING
85 So. 200 East * Vernal, Utah 84078 * (435) 789-1017