

KING SURVEYORS, INC. 650 GARDEN DR. WINDSOR, CO 80550
VISIBLE IMPROVEMENTS

SECTION: 6
TOWNSHIP: 4N
RANGE: 64W

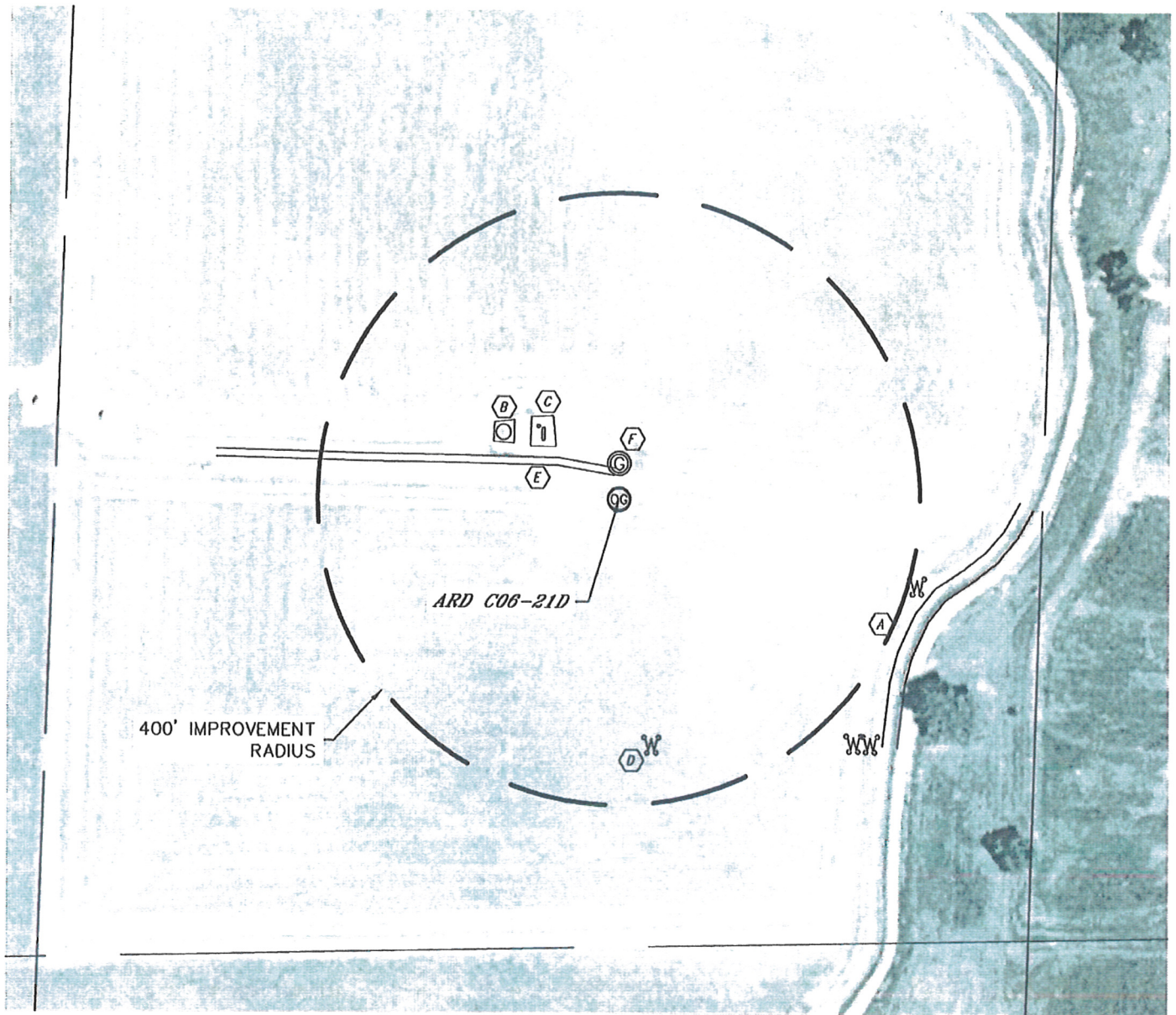

IMPROVEMENTS:

- (A) PROPERTY LINE 403' SOUTHEAST
- (B) TANK BATTERY ENCLOSURE 158' NORTHWEST
- (C) SEPARATOR ENCLOSURE 109' NORTHWEST
- (D) WOOD POST 324' SOUTH
- (E) FIELD ROAD 32' NORTH
- (F) COBB 6-1 47' NORTH

