

**Figure 3**

# **BILL BARRETT CORPORATION**

LOCATION DRAWING  
FOR

## **MCAFEE 16-12-38-17 PAD**

SECTION 12, T38N, R17W, N.M.P.M.

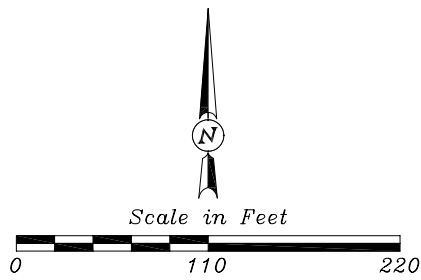

SURFACE USE OF THE PROPOSED WELL SITE		
<input checked="" type="checkbox"/> CROP LAND	<input type="checkbox"/> NON-CROP LAND	<input type="checkbox"/> SUBDIVIDED
<input type="checkbox"/> IRRIGATED	<input type="checkbox"/> RANGELAND	<input type="checkbox"/> INDUSTRIAL
<input checked="" type="checkbox"/> DRY LAND	<input type="checkbox"/> TIMBER	<input type="checkbox"/> COMMERCIAL
<input type="checkbox"/> IMPROVED PASTURE	<input type="checkbox"/> RECREATIONAL	<input type="checkbox"/> RESIDENTIAL
<input type="checkbox"/> HAY MEADOW	<input type="checkbox"/> OTHER (Describe)	
<input type="checkbox"/> CRP		

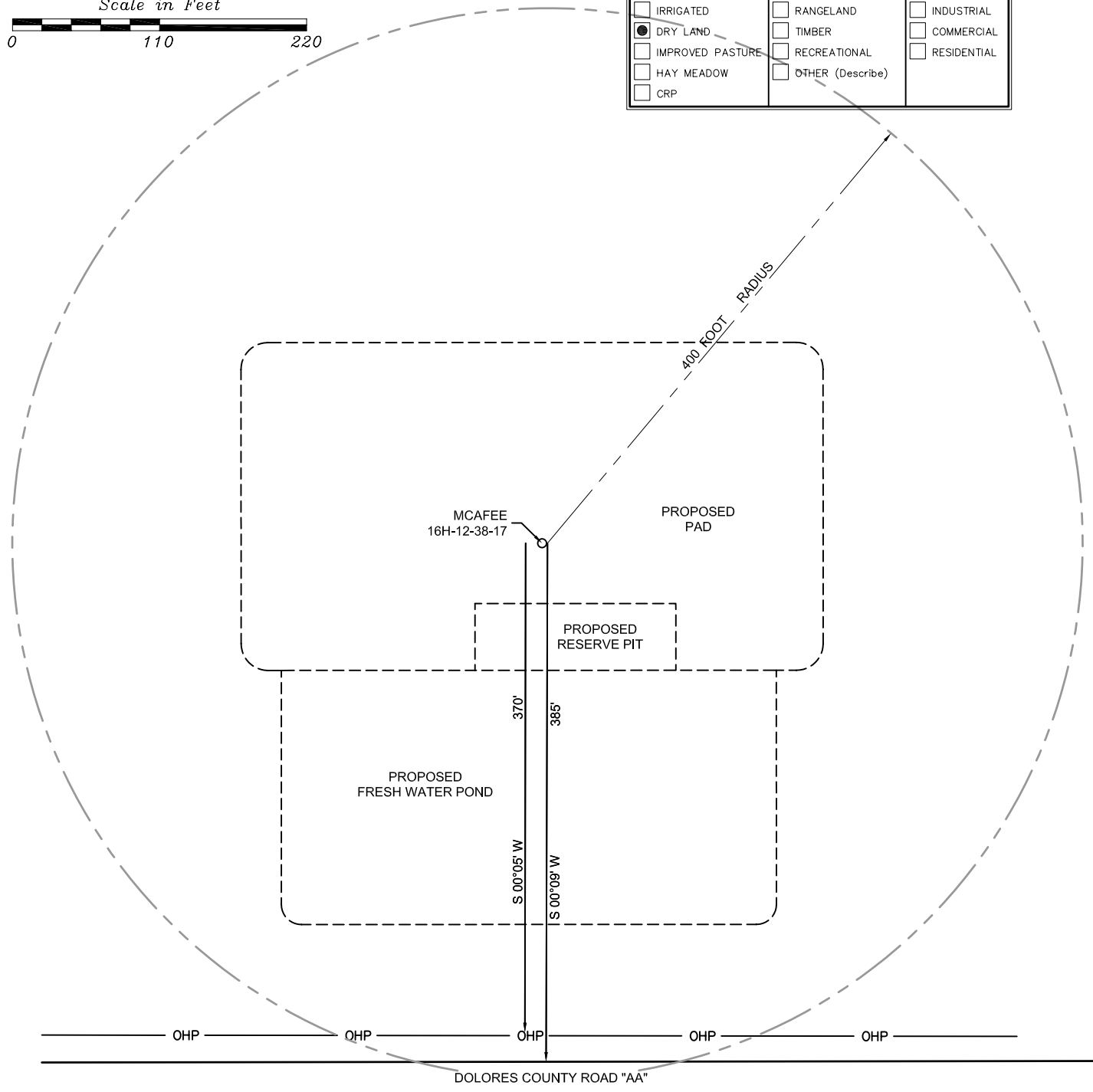

NEAREST VISIBLE IMPROVEMENTS  
OVERHEAD POWER LINE: 370'  
COUNTY ROAD AA: 385'  
NEAREST BUILDING: 1270'  
NEAREST RAILROAD: >30 MILES  
NEAREST PROPERTY LINE: 400'

REVISED: 11-6-09  
REVISED: 1-12-10

**ANDERSON**  
ENGINEERING COMPANY, INC.  
(801) 972-6222  
www.andersoneng.com