

DRY CREEK 21-35

TOPO

HYDROLOGY MAP-A

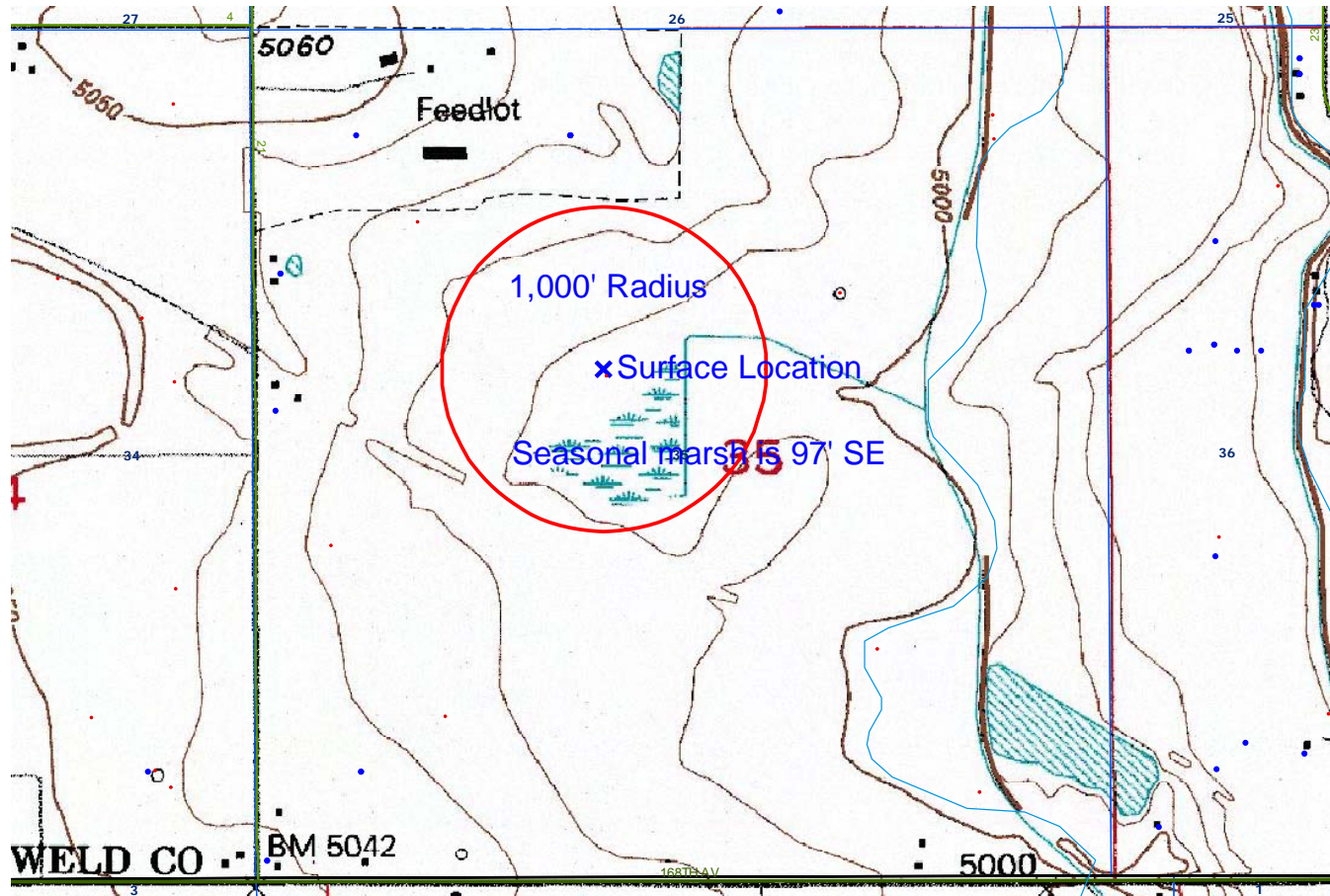

TOWNSHIP 1 NORTH, RANGE 67 WEST

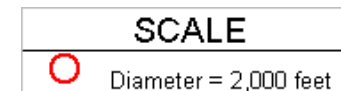

LEGEND A

WATER RESOURCES

- Water Wells
- Lakes
- Major Rivers
- Streams
- 300-Foot Stream Buffers

LEGEND B

1200-SEARIES WILDLIFE AREAS

- RSO Areas
- RSO_Osprey_Curren
- SWH Areas
- State Wildlife Areas

DRY CREEK 21-35

TOPO

HYDROLOGY MAP-B-

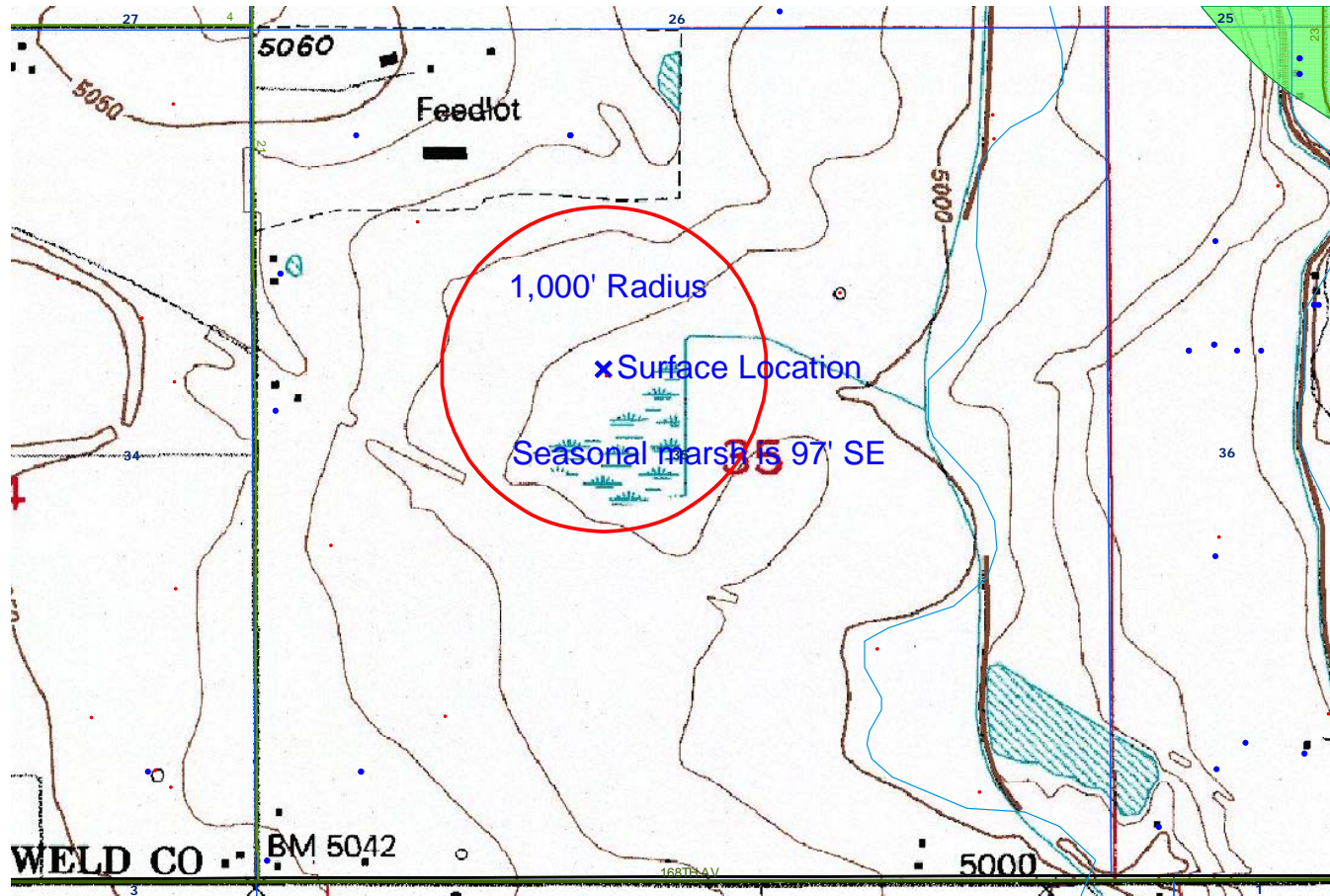

TOWNSHIP 1 NORTH, RANGE 67 WEST

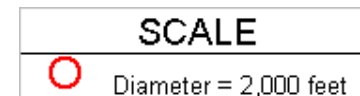

LEGEND A

WATER RESOURCES

- Water Wells
- Lakes
- Major Rivers
- Streams
- 300-Foot Stream Buffers

LEGEND B

1200-SEARIES WILDLIFE AREAS

- RSO Areas
- RSO_Osprey_Curren
- SWH Areas
- State Wildlife Areas

DRY CREEK 21-35

AERIAL

HYDROLOGY MAP-A



TOWNSHIP 1 NORTH, RANGE 67 WEST

SCALE



Diameter = 2,000 feet





LEGEND A

WATER RESOURCES

- Water Wells
- Lakes
- Major Rivers
- Streams
- 300-Foot Stream Buffers

LEGEND B

1200-SEARIES WILDLIFE AREAS

-  RSO Areas
 RSO_Osprey_Curren
 SWH Areas
 State Wildlife Areas

DRY CREEK 21-35

AERIAL

HYDROLOGY MAP-B



TOWNSHIP 1 NORTH, RANGE 67 WEST

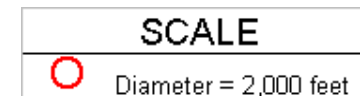

LEGEND A	LEGEND B
WATER RESOURCES	1200-SEARIES WILDLIFE AREAS
Water Wells	RSO Areas
Lakes	RSO_Osprey_Curren
Major Rivers	SWH Areas
Streams	State Wildlife Areas
300-Foot Stream Buffers	