

correspondence

Stanczyk, Jane

From: Craig, Jack [Jack.Craig@lm.doe.gov]
Sent: Thursday, December 24, 2009 5:52 AM
To: Stanczyk, Jane
Cc: Hutton, Rick
Subject: Rulison APDs

Jane:

The Office of Legacy Management (LM) is reviewing aforementioned applications and the location map provided by COGCC for the following wells and their respective locations:

APDs IN PROCESSING		BOTTOM HOLE LOCATION	
WELL NAME	WELL #	SURFACE LOCATION	N
LATITUDE	W LONGITUDE	QQ SEC T R	
RULISON FEDERAL	19-31CSWNW	SEC 20	39.429584
107.925929	NWNE	SEC 19 7S 94W	
RULISON FEDERAL	19-31DSENE	SEC 19	39.428678
107.925955	NWNE	SEC 19 7S 94W	
DOGHEAD	19-32ASENE	SEC 19	39.427659
107.9268791	SWNE	SEC 19 7S 94W	
DOGHEAD	19-32BSENE	SEC 19	39.426774
107.926881	SWNE	SEC 19 7S 94W	
DOGHEAD	19-32CSENE	SEC 19	39.425876
107.92682	SWNE	SEC 19 7S 94W	
DOGHEAD	19-32DSWNW	SEC 20	39.425018
107.92688	SWNE	SEC 19 7S 94W	
DOGHEAD	19-33ASWNW	SEC 20	39.424159
107.926879	NWSE	SEC 19 7S 94W	
DOGHEAD	19-33BSWNW	SEC 20	39.423247
107.92688	NWSE	SEC 19 7S 94W	
RULISON FEDERAL	19-41DSWNW	SEC 20	39.428678
107.921538	NENE	SEC 19 7S 94W	
RULISON FEDERAL	19-42ASWNW	SEC 20	39.427712
107.922199	SENE	SEC 19 7S 94W	
RULISON FEDERAL	19-42BSENE	SEC 19	39.426814
107.922199	SENE	SEC 19 7S 94W	
RULISON FEDERAL	19-42CSWNW	SEC 20	39.425929
107.922198	SENE	SEC 19 7S 94W	
RULISON FEDERAL	19-42DSWNW	SEC 20	39.425006
107.922197	SENE	SEC 19 7S 94W	
RULISON FEDERAL	19-43ASWNW	SEC 20	39.424121
107.922197	NESE	SEC 19 7S 94W	

At this time, DOE does not request any additional information but would encourage COGCC to place general language in the permit such that the company would accommodate DOE sampling requests in the future. DOE agrees with the COGCC assessment that the pad is located approximately 2.0 miles from the Rulison site on a new pad located at NESE Section 19 7S 94W and SWNW Section 20 7S 94W, and the bottom-hole-locations range approximately from 1.6 to 2.1 miles from Project Rulison. Accordingly, DOE agrees with COGCC that all wells fall under the Tier 2 sampling and monitoring of the COGCC Rulison Sample and Analysis Plan and are located in Sector 2 of the Rulison SAP. DOE will continue to review the proposed locations and subsurface orientations of the propose drilling for documentation when sampling occurs. Thank you for the opportunity to comment on these permit applications. Please e-mail or call at 240-252-8506 if you require further information.

Stanczyk, Jane

From: Stanczyk, Jane
Sent: Saturday, December 12, 2009 9:58 AM
To: 'Rick Hutton'; 'Craig, Jack'
Cc: Neslin, David; Willis, Rob; Ahlstrand, Dennis; Yokley, Bill; Andrews, David; Krabacher, Jay; King, Kevin; Halstead, Mary; Kubeczko, Dave; Fischer, Alex; Canfield, Chris; Baldwin, Debbie; 'luke@ldanielsonlaw.com'; 'LPavelka@nobleenergyinc.com'; Kate Fay (kcfay@smtpgate.dphe.state.co.us)
Subject: Noble permits in Project Rulison padn in NESE Sec 19 7S 94W & SWNW Sec 20 7S 94W
Attachments: Project Rulison NOBLE APDs SENE Sec 19 SWNW Sec 20 12-12-09.xls; image001.png; image002.png

Jack and Rick

Noble has submitted permits for a new pad in the Project Rulison 3 mile area.

The surface location is in the NESE Section 19 7S 94W & SWNW Sec 20 7S 94W, approximately 2 miles from the project well.

There are permits for 14 wells with bottom hole locations in Section 19 7S 94W, approximately 1.6 to 2.1 miles from the project well.

All the wells are in Tier 2, Sector 2 of the Project Rulison Sampling and Analysis Plan.

The permits include Noble's DOE notification letter to Jack dated November 9, 2009.

The well list spreadsheet is attached.

Please let me know if you need any additional information.

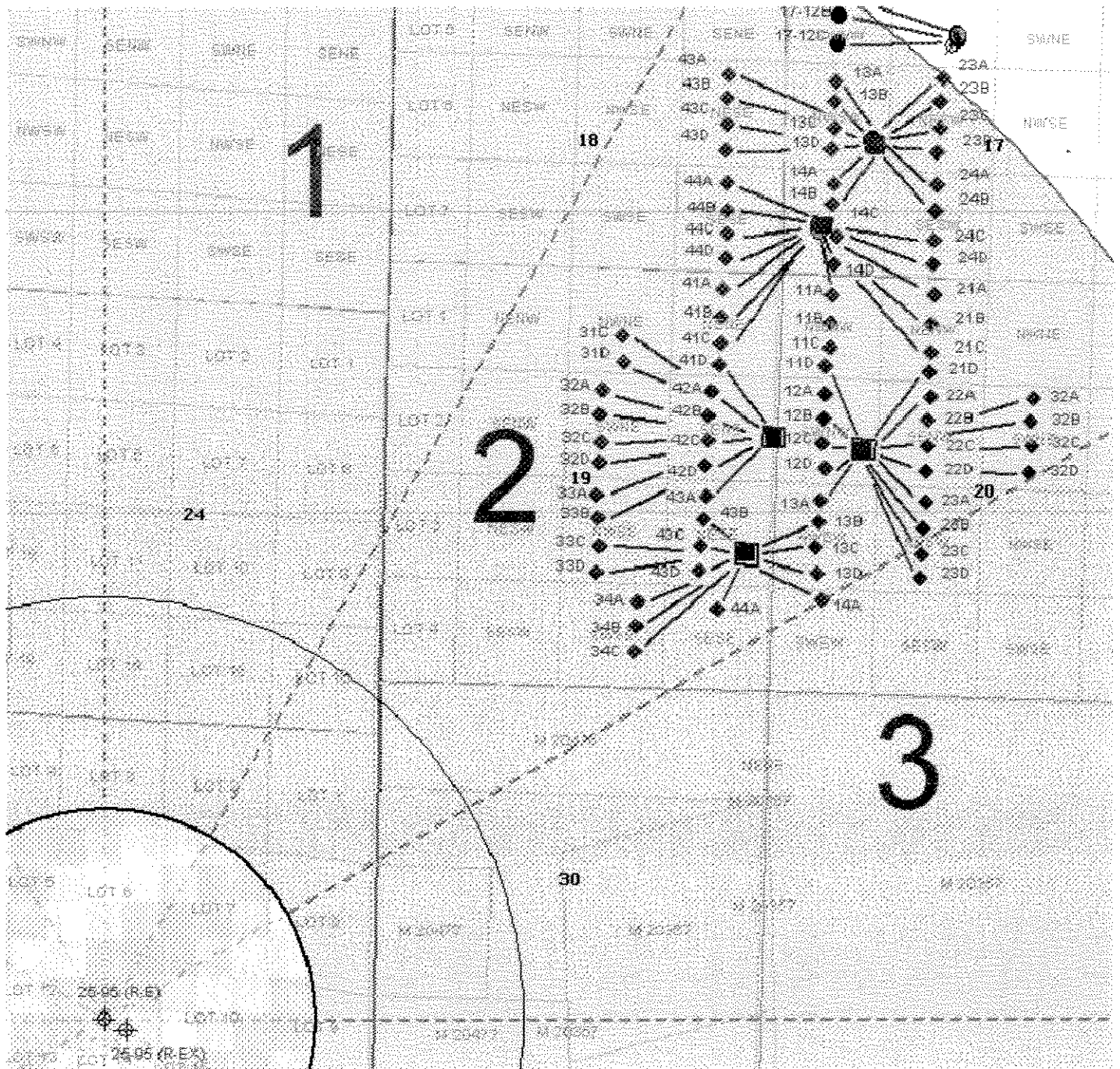

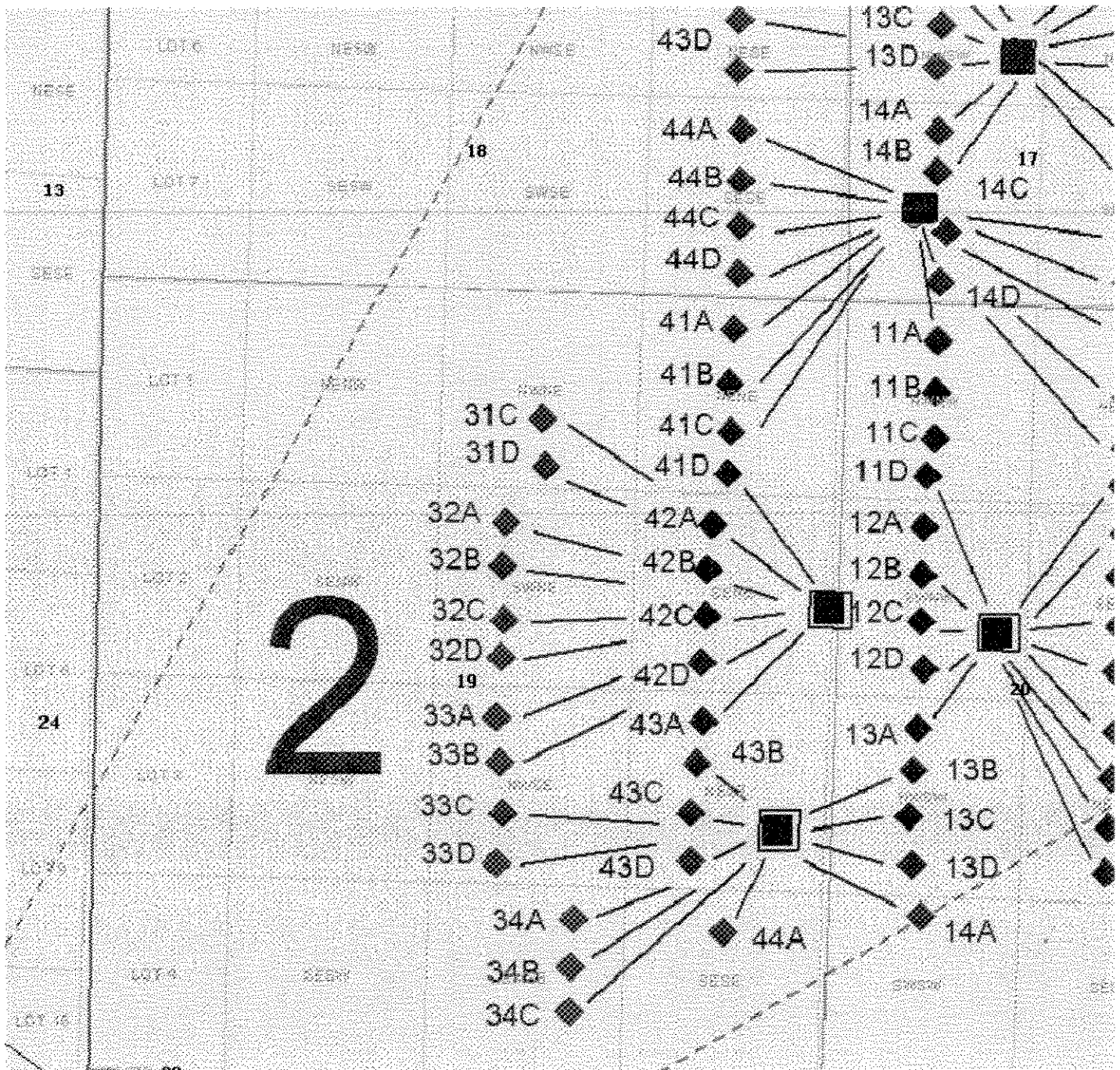

Jane Stanczyk
 Permit Supervisor
 Colorado Oil and Gas Conservation Commission
 Phone: (303) 894 2100 ext. 5119
 FAX: (303) 894 2109
 E-mail: jane.stanczyk@state.co.us