

DRG RIFFIN & ASSOCIATES, INC.
 (307) 362-5028 1414 ELK ST., ROCK SPRINGS, WY 82901

DRAWN: 3/09/09 - WWG

SCALE: 1" = 2000'

REVISED: 12/4/09 - RCR

DRG JOB No. 13846

REVISE TITLE BLOCK

EXHIBIT/TOPO 8

PROPOSED ACCESS ROAD MAP

NOBLE ENERGY, INC.

SGV FEDERAL 6-44C, 6-44D, 7-41A, 7-41B, 7-41C, 8-11A, 8-11B, 8-11C, 8-11D, 8-12A, 8-12B

NW1/4 OF NW1/4 OF SECTION 8, T8S, R95W, 6th P.M.

GARFIELD COUNTY, COLORADO

TOTAL EXISTING LENGTH: EXISTING

EXISTING PIPELINE - - - - -

EXISTING ROAD - - - - -

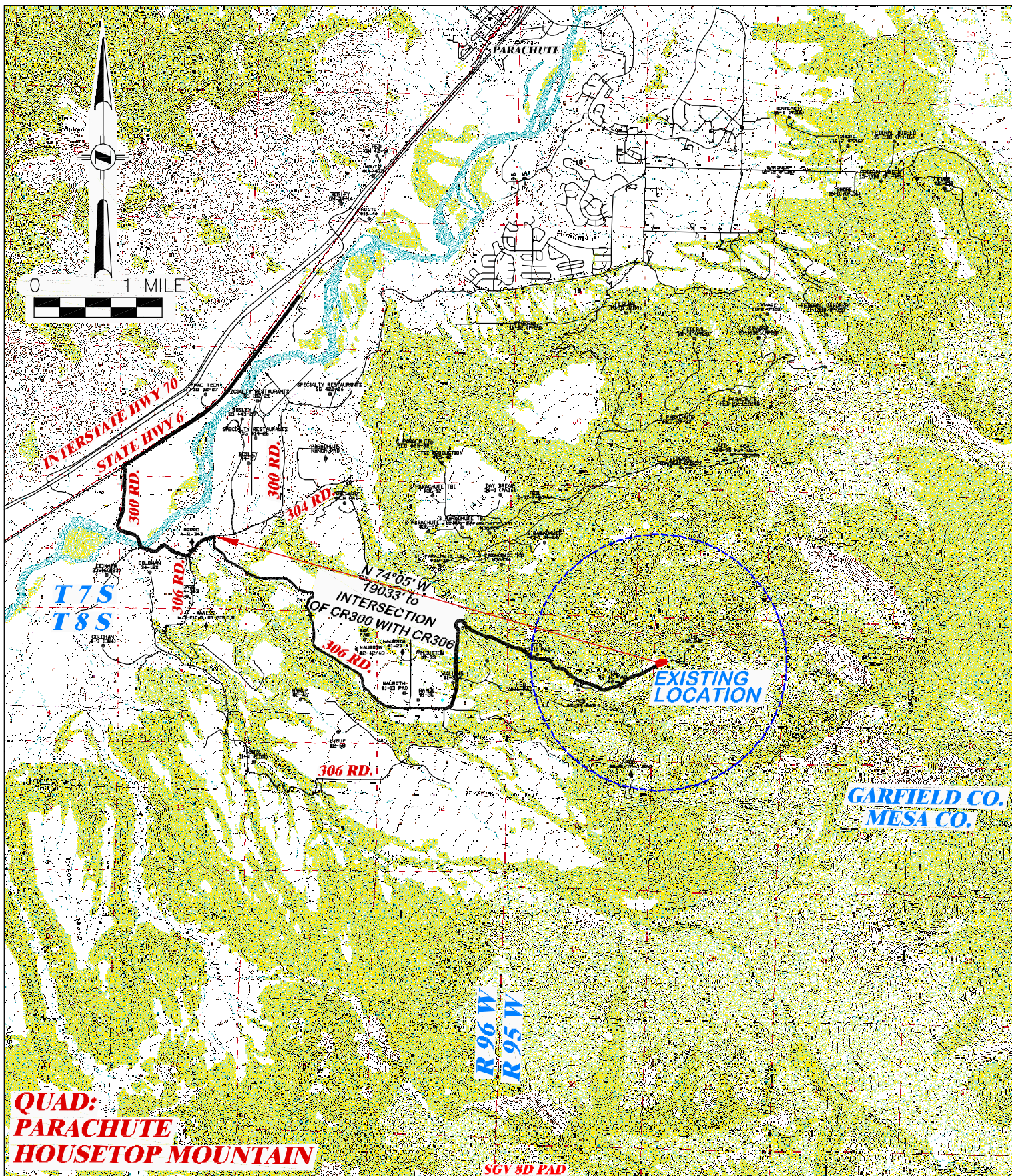

DRG RIFFIN & ASSOCIATES, INC. (307) 362-5028 1414 ELK ST., ROCK SPRINGS, WY 82901		ACCESS ROAD MAP NOBLE ENERGY, INC. SGV FEDERAL 6-44C, 6-44D, 7-41A, 7-41B, 7-41C, 8-11A, 8-11B, 8-11C, 8-11D, 8-12A, 8-12B NW1/4 OF NW1/4 OF SECTION 8, T8S, R95W, 6th P.M. GARFIELD COUNTY, COLORADO	
		EXISTING ROAD 	
DRAWN: 3/24/09 - WWG. REVISED: 12/04/09-RCR REVISE TITLE BLOCK	SCALE: 1" = MILE DRG JOB No. 13846 EXHIBIT/TOPO 9		

DRIVING DIRECTIONS

NOBLE ENERGY, INC.

8D PAD

SGV FEDERAL 6-44C, 6-44D, 7-41A, 7-41B, 7-41C, 8-11A,

8-11B, 8-11C, 8-11D, 8-12A, 8-12B,

NW1/4 OF NW1/4 OF SECTION 8, T 8 S, R 95 W, 6th P.M.

GARFIELD COUNTY, COLORADO

DECEMBER 4, 2009

Beginning at the town of Parachute, Colorado; travel southwesterly on State Highway No. 6 for 4.4 miles to County Road 300. Turn left and travel southerly, then southeasterly for 1.4 miles to the intersection with the east loop of County Road 306 (aka Spring Creek Road). Turn right and travel southeasterly, then easterly for 2.7 miles to an existing gravel road known as Walling Road. Turn left and travel northerly, then southeasterly for 2.3 miles to the proposed location.