

# LEGEND:

EXISTING LOCATION

EnCana OIL & GAS (USA) INC.

WELL PAD F25 496  
SECTION 25, T4S, R96W, 6th P.M.  
SE 1/4 NW 1/4



**Uintah Engineering & Land Surveying**  
85 South 200 East Vernal, Utah 84078  
(435) 789-1017 \* FAX (435) 789-1813

**TOPOGRAPHIC**  
**MAP**

**8** **5** **09**  
MONTH DAY YEAR

SCALE: 1:100,000 DRAWN BY: J.L.G. REVISED: 8-18-09





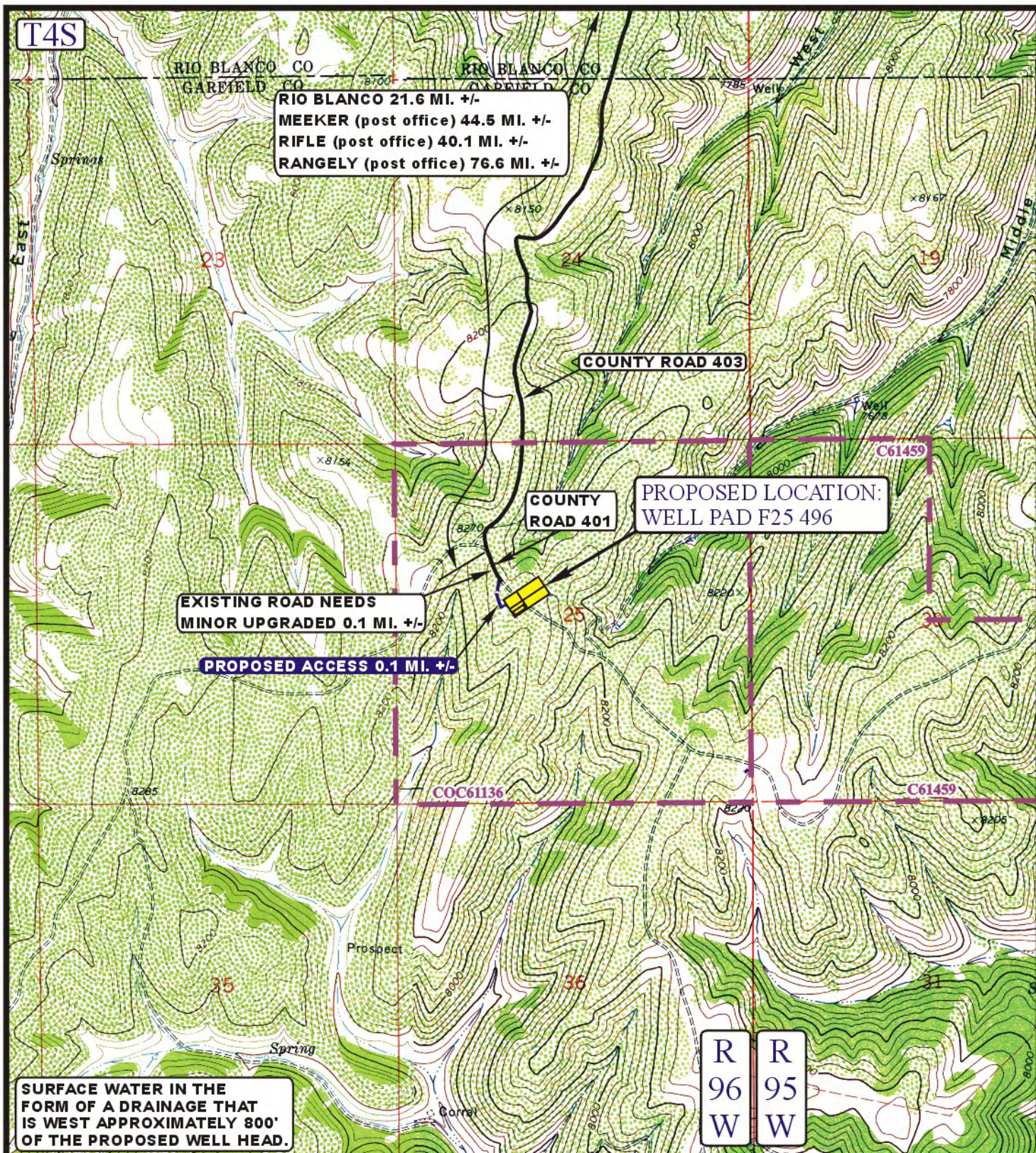

**LEGEND:**

----- PROPOSED ACCESS ROAD  
————— EXISTING ROAD



EnCana OIL & GAS (USA) INC.

WELL PAD F25 496

SECTION 25, T4S, R96W, 6th P.M.

SE 1/4 NW 1/4

SHEET 9 of 11



Uintah Engineering & Land Surveying  
85 South 200 East Vernal, Utah 84078  
(435) 789-1017 \* FAX (435) 789-1813

**TOPOGRAPHIC  
MAP**

**8 5 09**  
MONTH DAY YEAR

**B  
TOPO**

SCALE: 1" = 2000' DRAWN BY: J.L.G. REVISED: 9-18-09



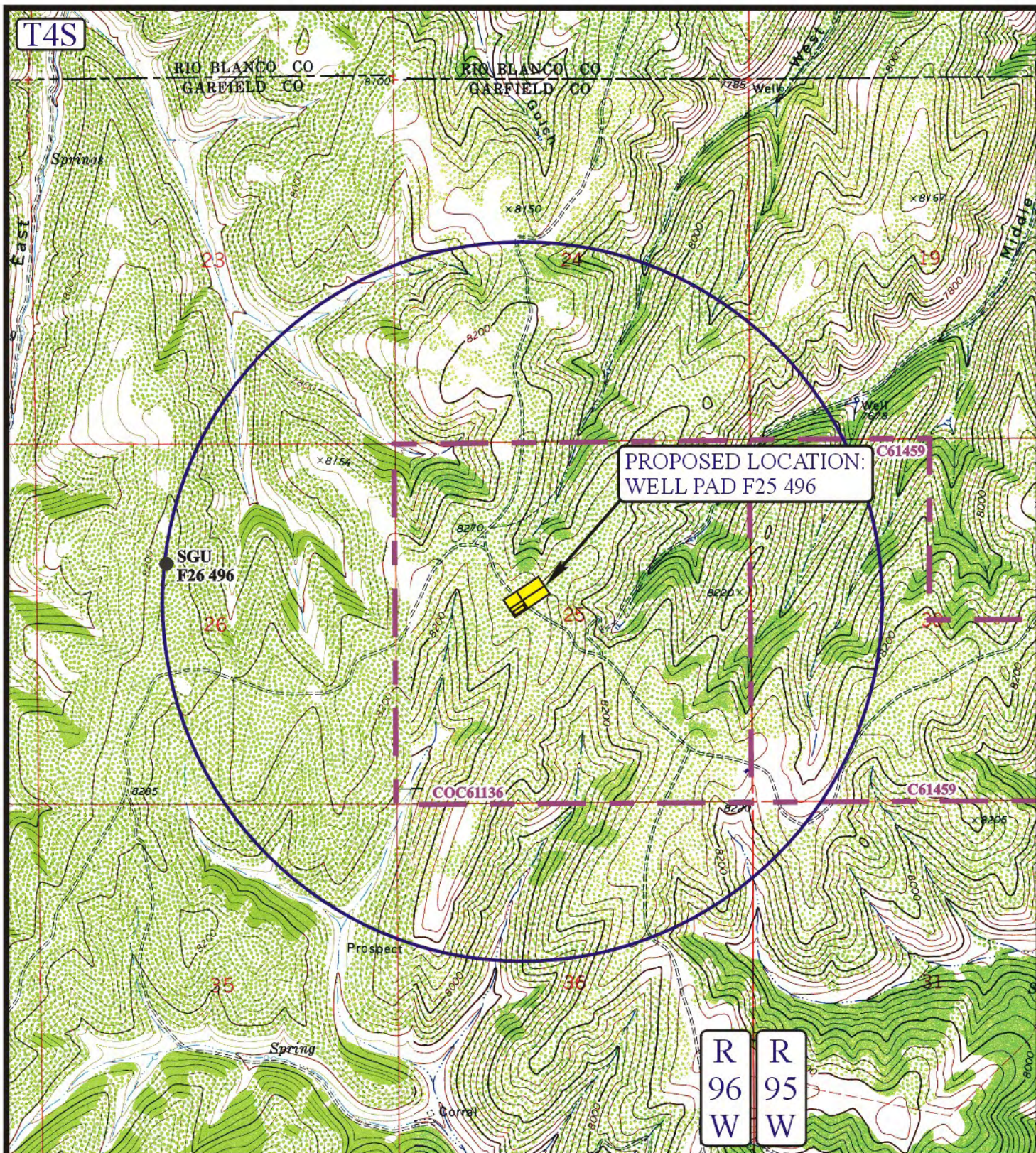

# LEGEND:

- |                   |                         |
|-------------------|-------------------------|
| ⊗ DISPOSAL WELLS  | ⊗ WATER WELLS           |
| ● PRODUCING WELLS | ● ABANDONED WELLS       |
| ● SHUT IN WELLS   | ● TEMPORARILY ABANDONED |



Uintah Engineering & Land Surveying  
 85 South 200 East Vernal, Utah 84078  
 (435) 789-1017 \* FAX (435) 789-1813



EnCana OIL & GAS (USA) INC.

WELL PAD F25 496  
 SECTION 25, T4S, R96W, 6th P.M.  
 SE 1/4 NW 1/4

**TOPOGRAPHIC**  
**MAP**

**8** **5** **09**  
 MONTH DAY YEAR

SCALE: 1" = 2000' DRAWN BY: J.L.G. REVISED: 9-1-09

**C**  
 TOPO



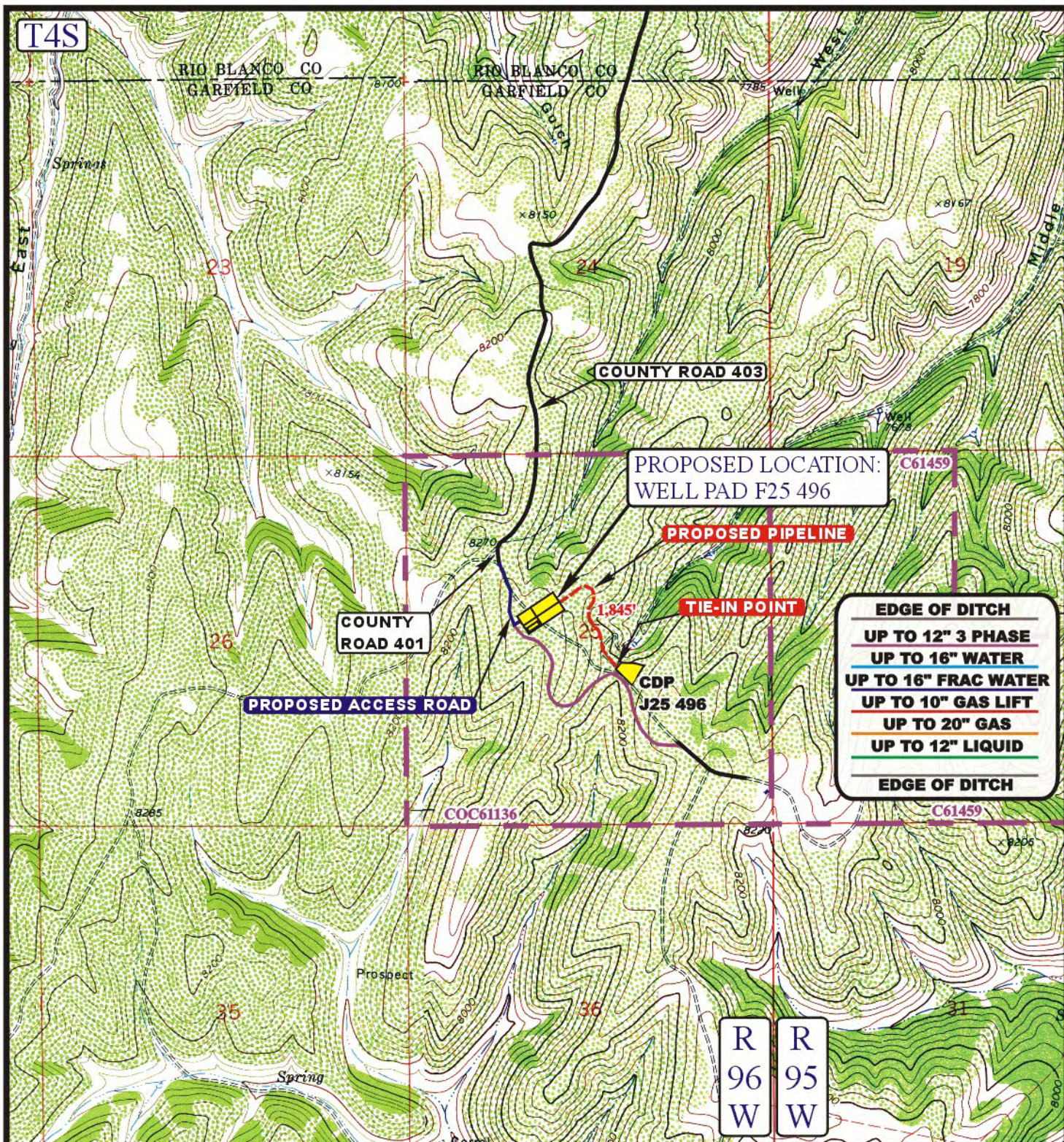

**APPROXIMATE TOTAL PIPELINE DISTANCE = 1,845' +/-**

**LEGEND:**

- EXISTING PIPELINE
- - - PROPOSED PIPELINE
- PROPOSED ACCESS



EnCana OIL & GAS (USA) INC.

WELL PAD F25 496

SECTION 25, T4S, R96W, 6th P.M.

SE 1/4 NW 1/4

SHEET 11 of 11



Uintah Engineering & Land Surveying  
85 South 200 East Vernal, Utah 84078  
(435) 789-1017 \* FAX (435) 789-1813

**TOPOGRAPHIC  
MAP**

**9 8 09**  
MONTH DAY YEAR

SCALE: 1" = 2000'

DRAWN BY: J.L.G.

REVISED: 11-5-09

**D**  
TOPO



EnCana OIL & GAS (USA) INC.  
WELL PAD F25 496  
SECTION 25, T4S, R96W, 6<sup>th</sup> P.M.

PROCEED IN A NORTHERLY, THEN NORTHWESTERLY, THEN NORTHERLY DIRECTION FROM THE POST OFFICE IN RIFLE, COLORADO ALONG HIGHWAY 13 APPROXIMATELY 18.5 MILES TO THE JUNCTION OF THIS ROAD AND PICEANCE CREEK ROAD OR COUNTY ROAD 5 TO THE WEST; TURN LEFT AND PROCEED IN A WESTERLY, THEN NORTHWESTERLY DIRECTION APPROXIMATELY 11.9 MILES TO THE JUNCTION OF THIS ROAD AND THE EXISTING SPRAGUE GULCH ROAD TO THE SOUTH; TURN LEFT AND PROCEED IN A SOUTHERLY, THEN NORTHWESTERLY, THEN SOUTHERLY DIRECTION APPROXIMATELY 9.7 MILES TO THE JUNCTION OF THIS ROAD AND EXISTING COUNTY ROAD 401 TO THE SOUTHEAST; TURN LEFT AND PROCEED IN A SOUTHEASTERLY DIRECTION APPROXIMATELY 0.1 MILES TO THE BEGINNING OF THE PROPOSED ACCESS ROAD TO THE SOUTH; FOLLOW ROAD FLAGS IN A SOUTHERLY, THEN NORTHEASTERLY DIRECTION APPROXIMATELY 0.1 MILES TO THE PROPOSED LOCATION.

TOTAL DISTANCE FROM RIFLE, COLORADO TO THE PROPOSED WELL LOCATION IS APPROXIMATELY 40.3 MILES.