

LOCATION DRAWING

SECTION: 7
TOWNSHIP: 2S
RANGE: 44W

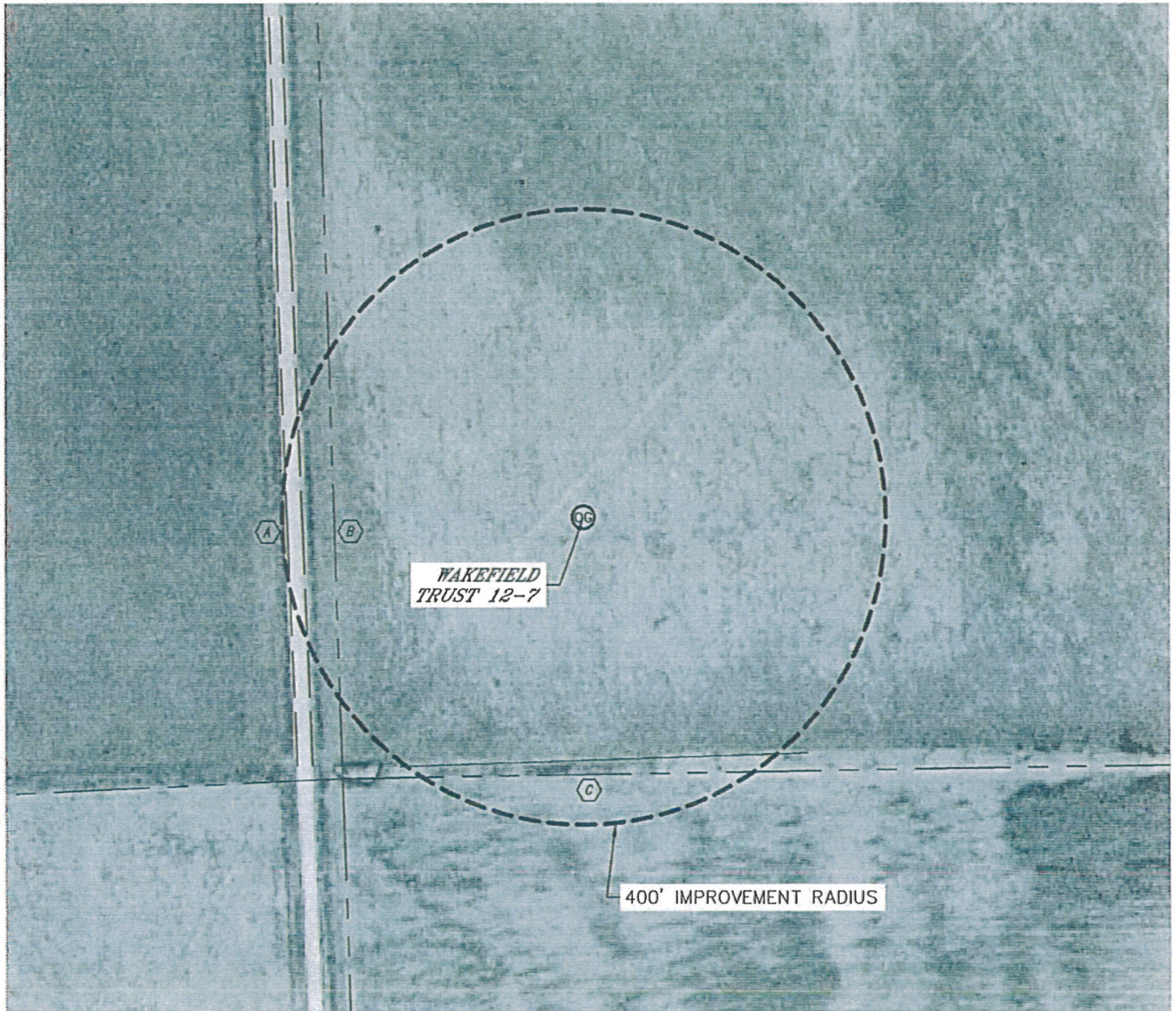

IMPROVEMENTS:

- (A) COUNTY ROAD AA 383' WEST
- (B) PROPERTY LINE 300' WEST
- (C) PROPERTY LINE 334' SOUTH
- (D) FIELD ROAD 316' SOUTH