

Kubeczko, Dave

From: Head, Jennifer [Jennifer.Head@williams.com]
Sent: Thursday, October 22, 2009 7:16 AM
To: Kubeczko, Dave
Cc: Stanczyk, Jane
Subject: RE: Williams Production RMT, RGU 13-24-198 PAD (Multiple Wells), 1S 98W Sec 24 NWSW, Rio Blanco County, Form 2A #1712264 Review
Attachments: 2A Corrections RGU 13-24-198.doc; 17149-2D.pdf; RGU 13-24-198 Pad Layout Aug0510.ppt

Please see attachments addressing the items below. Let me know if you need anything further. We will make adjustments to reflect the requests below on all future submittals.

Thank you,

Jennifer Head
Williams Production RMT Co.
Direct 303-606-4342
Mobile 970-218-3512

From: Kubeczko, Dave [mailto:Dave.Kubeczko@state.co.us]
Sent: Thursday, October 08, 2009 10:06 AM
To: Head, Jennifer
Cc: Stanczyk, Jane
Subject: Williams Production RMT, RGU 13-24-198 PAD (Multiple Wells), 1S 98W Sec 24 NWSW, Rio Blanco County, Form 2A #1712264 Review

Jennifer,

I have been reviewing the RGU 13-24-198 PAD (#1712264) Form 2A. COGCC requests the following clarifications regarding the data Williams has submitted on or attached to the Form 2A prior to passing the Oil and Gas Location Assessment.

1. **Facilities (Section 5):** The facilities list should include equipment used during drilling and production both existing and to be constructed. As such, I would expect gas or diesel motors, generators, and fuel tanks might be on the equipment list. Can you please provide an updated list of equipment for this location (primarily equipment that will be onsite during drilling operations, e.g., water tanks, electric motors, gas or diesel motors, electric generators, fuel tanks). This information will be included as semi-permanent facilities during drilling and listed under the Other: category.
2. **Construction (Section 6):** Mud Disposal: Since Onsite was selected for mud disposal, a method to be used should be indicated on the Form 2A (i.e., Land Farming, Land Spreading, Other: and specify).
3. **Cultural (Section 9):** The Form 2A indicates a distance to nearest building of 18,269 feet; COGCC review of the 2005 aerial photograph indicates a structure approximately 5,179 feet to the south-southwest. I couldn't verify the distance to the nearest above ground utilities based on the aerial photograph; however, I have estimated them to be associated with the nearest building. Could you let me know where and how the above ground utility was located (indicated to be 10,718 feet from the proposed well pad). Please let me know if you are okay with the revisions or propose your own numbers.
4. **Current Land Use (Section 10) and Future Land Use (Section 11):** Form 2A indicates that the current and future land use is marked as both Dry Land (Crop Land) and Rangeland (Non-Crop Land). Based on a review of the location pictures, as well as the reference area pictures, COGCC believes that this location is primarily Rangeland. There are more separation of topsoil issues associated with crop land, as opposed to non-crop land. If you concur, I can make this change if you send me an email.

5. **Rule 303.d.(3).C.:** Neither the scaled construction layout drawing (Exhibit 2) nor the Location Drawing (Exhibit 2D) show the location of the proposed gas (1) and water (2) pipelines, or the pigging station. One of these drawings should show the anticipated locations of these new facilities.
6. **Rule 303d.(3).I.:** The multiwell plan drawing should show the proposed well pad (RGU 13-24-198 PAD) to scale, similar to the existing well pad (RGU 34-24-198) to the east. This map should also include Township, Range, and Section.

These are overall, minor changes and I would like to get this passed. If you have any questions, please do not hesitate to call me at (970) 625-2497 x5 (office) or (970) 309-2514 (cell), or email. Thanks.

Dave

David A. Kubeczko, PG
Oil and Gas Location Assessment Specialist

Colorado Oil & Gas Conservation Commission
Northwest Area Office
707 Wapiti Court, Suite 204
Rifle, CO 81650
Phone: (970) 625-2497x5
FAX: (970) 625-5682
Cell: (970) 309-2514
dave.kubeczko@state.co.us

 **Please consider the environment before printing this e-mail**

Scan No.



CORRESPONDENCE

Supplemental and Corrected Information to 2A Submittal

Williams Production RMT Company

RGU 13-24-198 Pad, Document #1712264

RECEIVED

OCT 22 2009

COGCC/Rifle Office

Facilities Section 5:

Semi-permanent equipment/facilities used during the drilling operation would include 2 water tanks, 15 electric motors, 0 gas motors, 4 diesel motors, 4 electric generator, and 2 fuel tanks.

Construction Section 6:

This section was incorrectly marked as onsite mud disposal, as drilling mud is continually recycled and used for drilling operations throughout the field. The correct selection for Williams' operations is offsite disposal. The second selection would be Other, Recycled.

Cultural Section 9:

The nearest building is approx. 5179' to the SSW, and is the American Soda mining facility. We incorrectly measured to the nearest ranch house. The nearest above ground utility is a White River Electric power line running approx. E/W on the north side of CR 83 in Section 35, T1S, R98W. Williams has obtained a copy of White River Electric's facilities in the region and would be happy to supply this map to the COGCC for inclusion of that data in the website.

Current Land Use Section 10 and Future Land Use Section 11:

The correct notation for both sections is Non-Crop Land, Rangeland. Please delete or mark out the notations for Crop Land, Dry Land.

Location Drawing:

Please see attached revised Location Drawing indicating the proposed location of the buried single gas and two water lines. No pigging station is proposed at the location or within 400 feet of the pad.

Multiwell Plan Drawing:

See attached revised Multiwell Plan drawing showing Sec, T&R, and a scaled depiction of the proposed well pad.

Scan. No.



02032633

COGCC 2

UNGRADED ELEVATION: 6538.9'
FINISHED ELEVATION: 6536.8'
APPROX. DISTURBANCE: 5.5± ACRES

LOCATION DRAWING

RECEIVED

OCT 22 2009

COGCC/Rifle Office

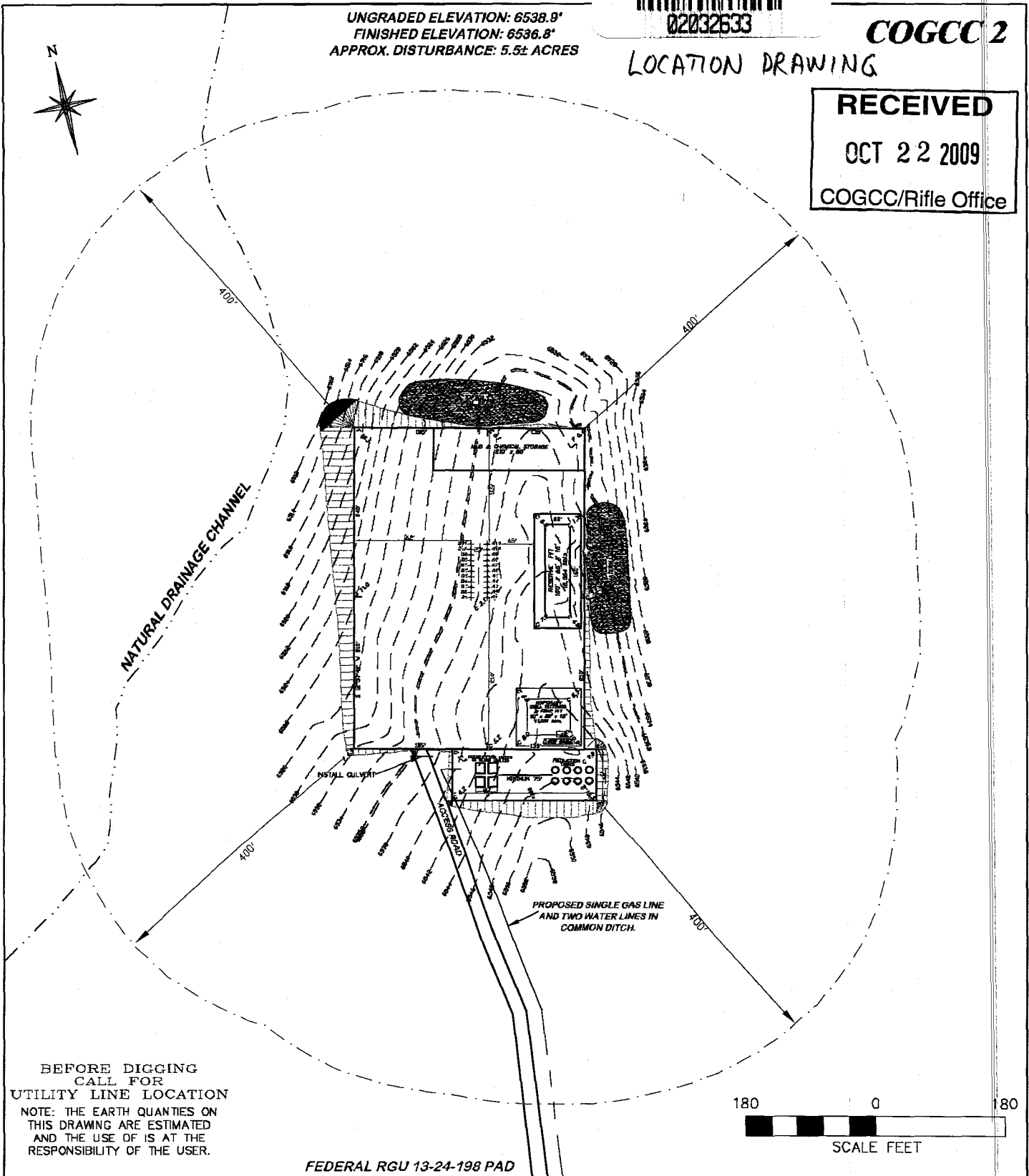

DRG RIFFIN & ASSOCIATES, INC.
1414 ELK ST., ROCK SPRINGS, WY 82901

(307) 382-5028

DRAWN: 8/5/09 - MMM

SCALE: 1" = 180'

REVISED: 10/22/09 - MMM

DRG JOB No. 17149

ADDED PIPELINE NOTE

EXHIBIT 2D

LOCATION DRAWING

WILLIAMS PRODUCTION RMT COMPANY
**FEDERAL RGU 13-, -24, -423-, 23-, 422-, 14-, 413-,
412-24-198**

UNGRADED ELEVATION: 6538.9'
FINISHED ELEVATION: 6536.8'

Scan No.



MULTIWELL PLAN

Multi Well Plan

Section 24, T1S, R98W

RECEIVED

OCT 22 2009

COGCC/Rifle Office

