



02109015

Exhibit(s) for order
no(s)

416-1

S16-2

5 -14

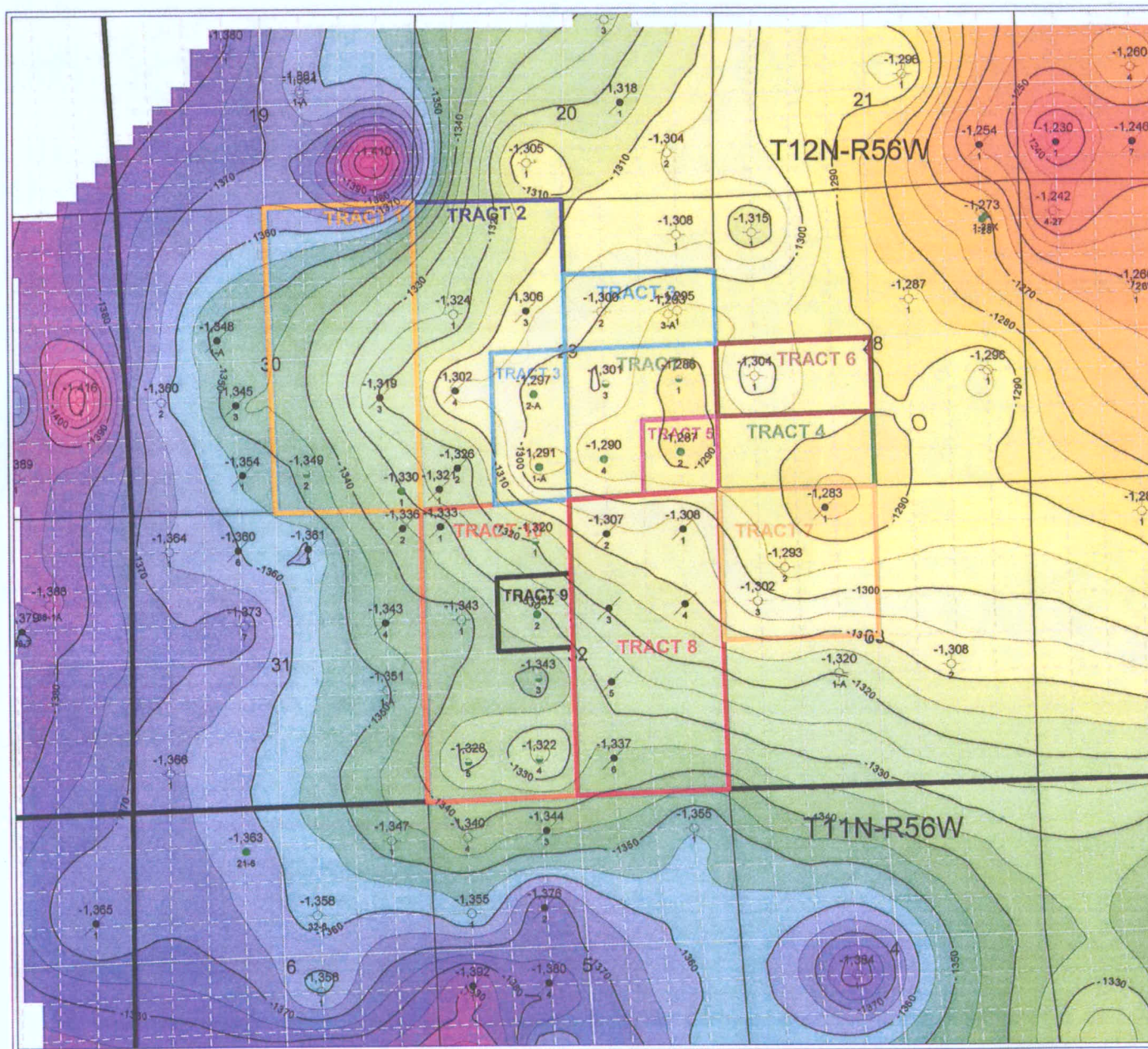

Beren Corp.

Moyer Unit

D Sand Structure

12N - 86W

Wells County, CO

POSTED WELL DATA

www.beren.com

CONTOURS
FISCONS - D SAND (JRS) - D Sand
Elder D-Sand
Contour Interval = 5

WELL SYMBOLS
Oil Well
Plugged and Abandoned
Dry Hole
TA - Oil
Oil and Gas Well
Shut-In Oil Well

By JRE

July 28, 2009 4:50 PM

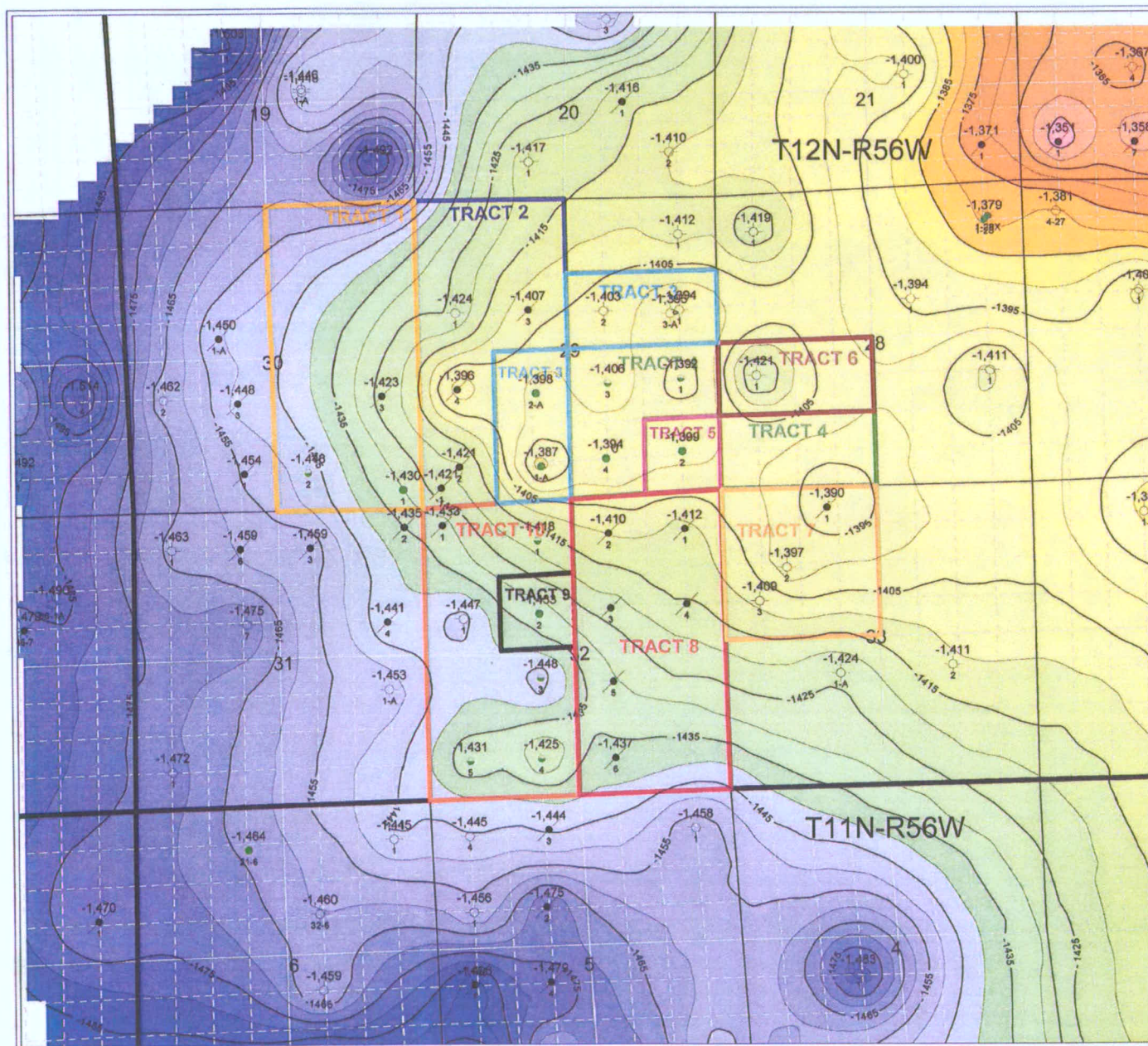

Beren Corp.

Moyer Unit

J Sand Structure

12N - 86W

Weld County, CO

POSTED WELL DATA

CONTOURS

POSTOP - J-1 SAND (SRE) - J-1

Moyer J-1 ORO

Contour Interval = 5

WELL SYMBOLS

Oil Well

Plugged and Abandoned

Dry Hole

TA - Oil

Oil and Gas Well

Shut In Oil Well

By: JRE

July 28, 2009 4:53 PM

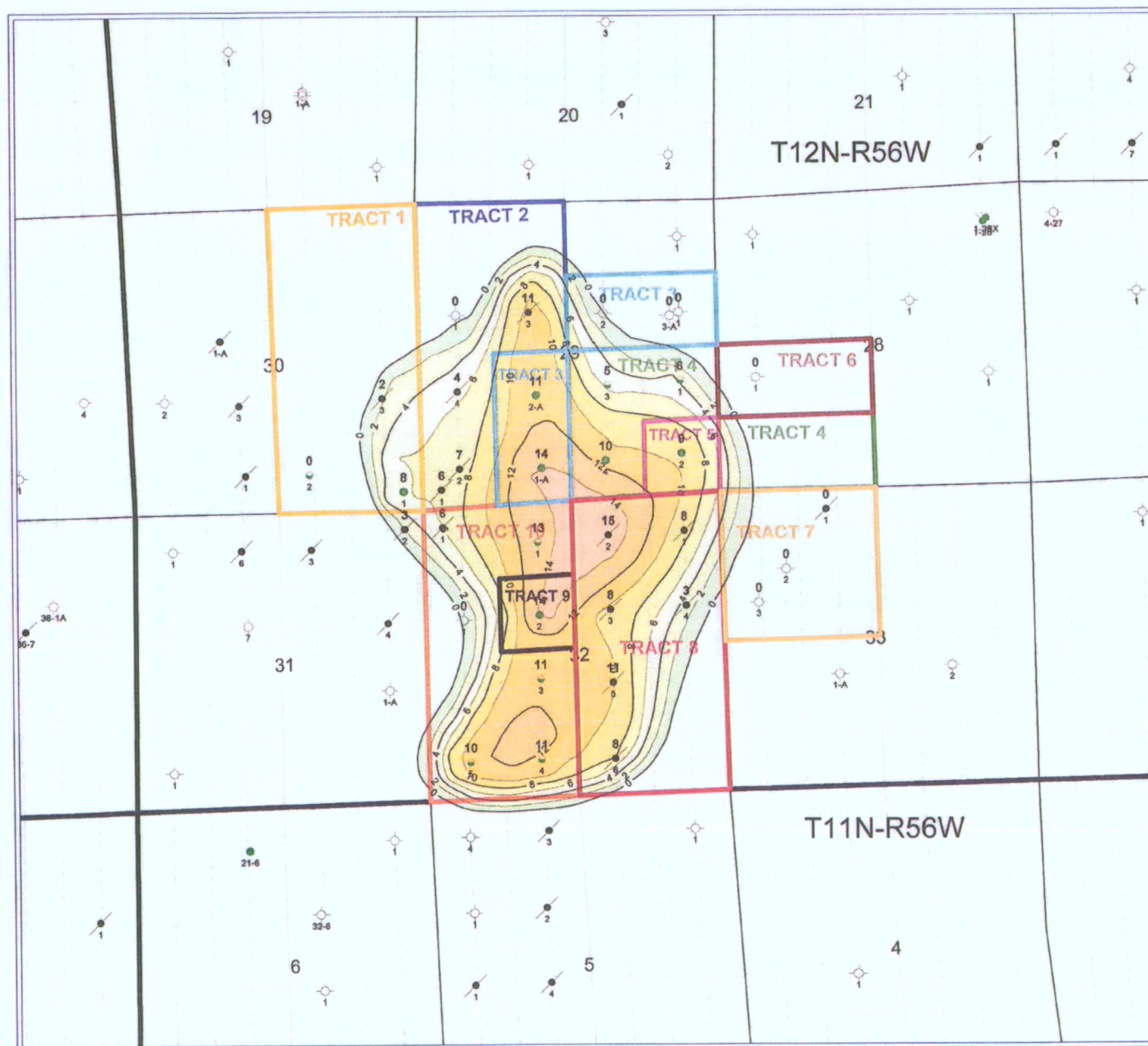

Beren Corp.
Moyer Unit
J1 Sand Net Pay (ft)
12N - 56W
Weld County, CO
POSTED WELL DATA
NET_PAY - D SAND (ft) - D Sand Net Pay
Moyer J1 Net Pay GRD
Contour Interval = 2
CONTOURS
NET_PAY - D SAND (ft) - D Sand Net Pay
Moyer J1 Net Pay GRD
Contour Interval = 2
WELL SYMBOLS
Oil Well
Plugged and Abandoned
Dry Hole
TA - Oil
Oil and Gas Well
Shut In Oil Well
By: JRE
July 28, 2009 4:55 PM

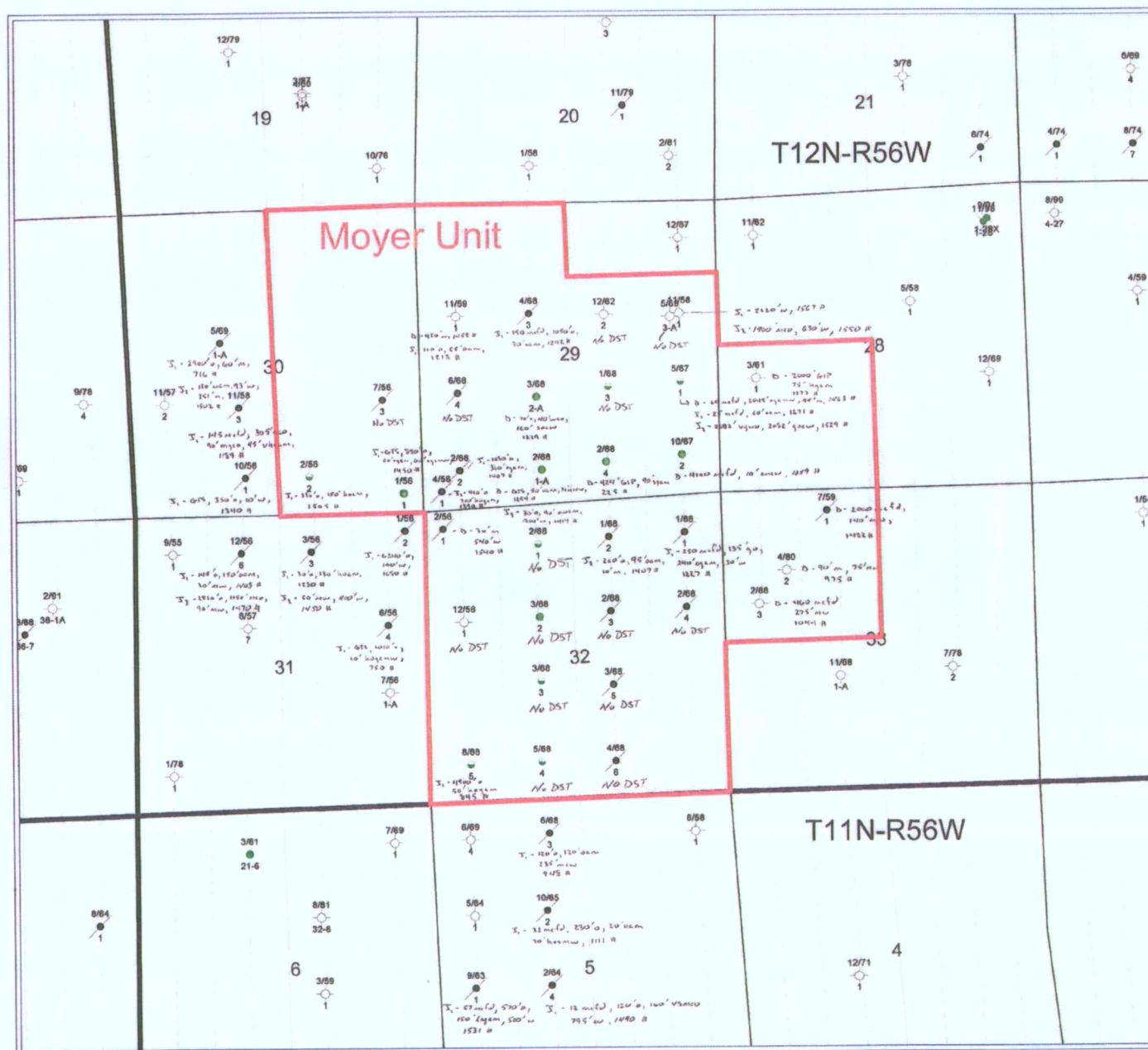

Beren Corp.

Moyer Unit

Spud Date and DST

12N - 86W

Weld County, CO

POSTED WELL DATA

● = ~~Producing~~

Well Number

WELL SYMBOLS

- Oil Well
- Plugged and Abandoned
- Dry Hole
- TA - Oil
- Oil and Gas Well
- Shut in Oil Well

By: JRE

July 28, 2009 5:02 PM

Moyer Unit

Spud Date and DST

12N - 56W

Weld County, CO

POSTED WELL DATA

المجلة

100

WELL SYMBOLS

- **Oil Well**
- **Plugged and Abandoned**

 Dry Hole

- **TA - Oil**
- **Oil and Gas Well**

- **Shut In Oil Well**

Dr JRE

July 28, 2009 5:02 PM

100

APPENDIX A

Moyer Unit Original Oil in Place Calculations

Zone	Net Pay (acre-ft)	Avg. Porosity (%)	Avg. Sw (%)	FVF	OOIP (STBO)
D Sand	1848.37	15.7	27.8	1.281	1,268,897
J1 Sand	7895.70	15.7	27.8	1.281	5,420,360
					6,689,257

APPENDIX B

Moyer Unit Cumulative Production and Remaining Primary Reserves

Tract #	Tract Name	Cumulative Oil As of 12/31/2008	Remaining Primary Reserves as of 12/31/08	Ultimate Primary Recovery
1	Gerry	190,716	300	191,016
2	Moyer W	53,296	0	53,296
3	Moyer A	411,495	63,897	475,392
4	Moyer 4	132,615	2,504	135,119
5	Moyer 2	104,833	16,967	121,799
6	Moyer E.	0	0	0
7	Moyer SE	5,604	0	5,604
8	Durland Trust	400,309	0	400,309
9	Moyer B-2	279,290	5,441	284,731
10	Moyer B	232,741	0	232,741
		1,810,899	89,108	1,900,007

Tract 1, Gerry

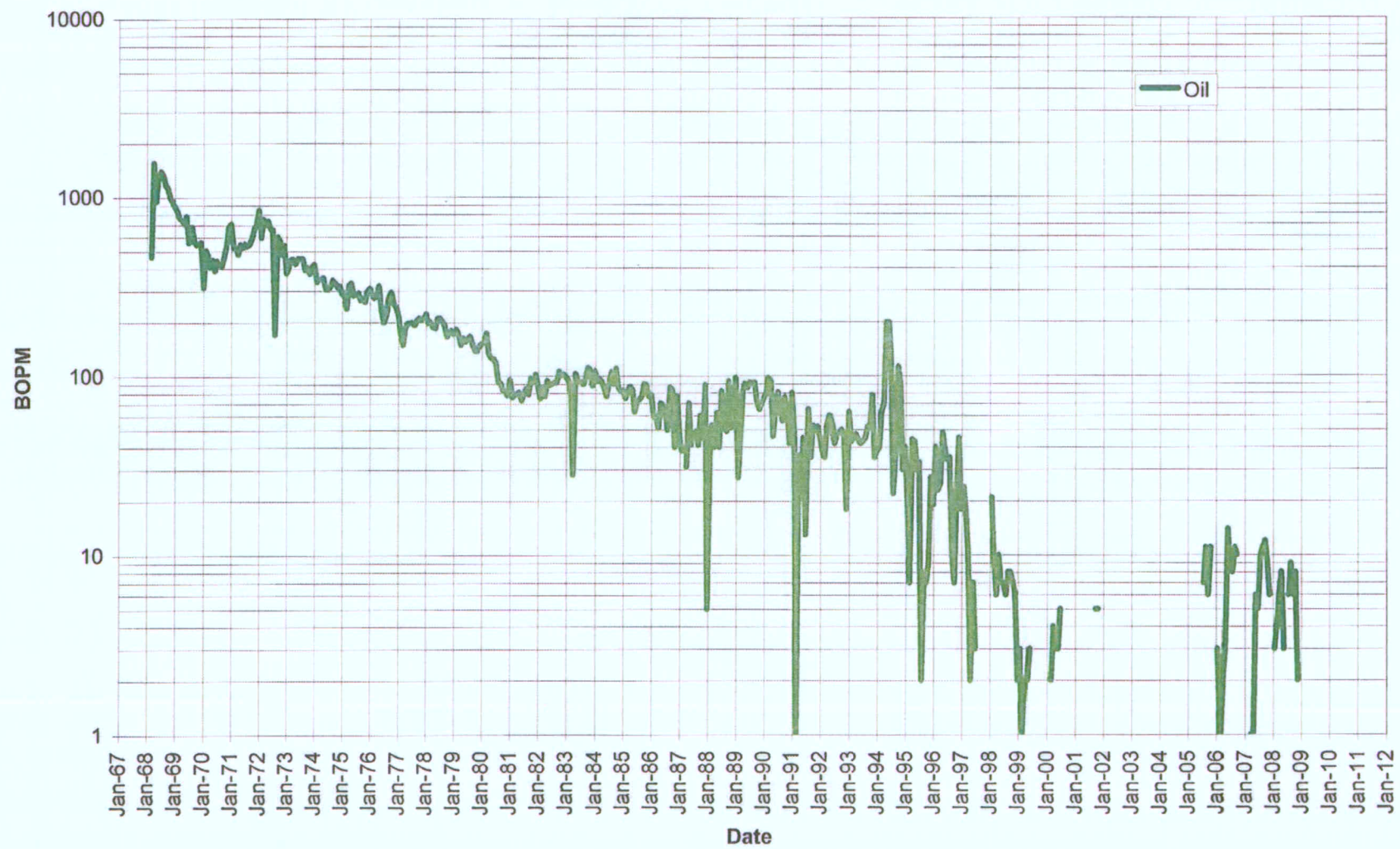

Tract 2, Moyer W.

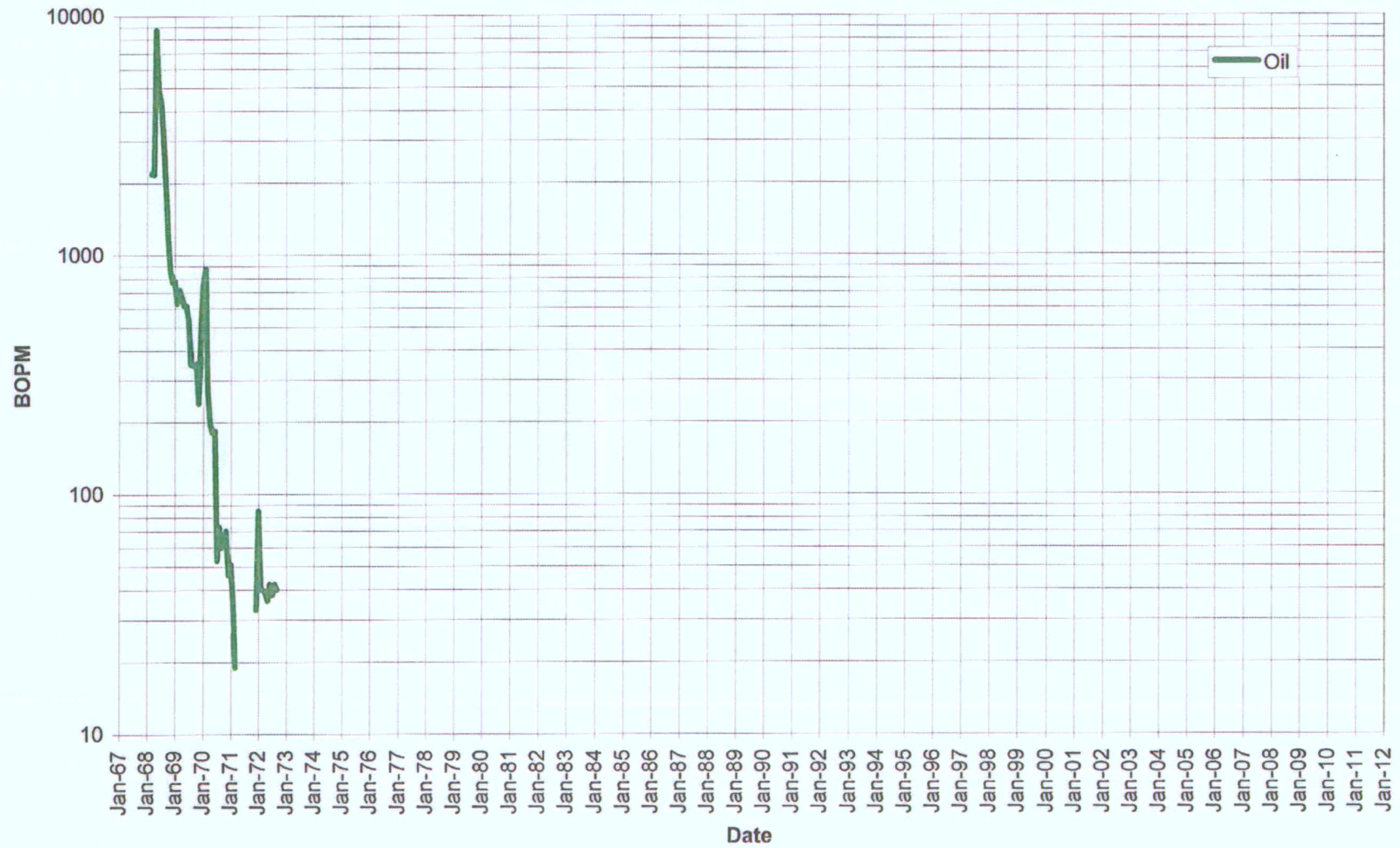

Tract 3, Moyer A

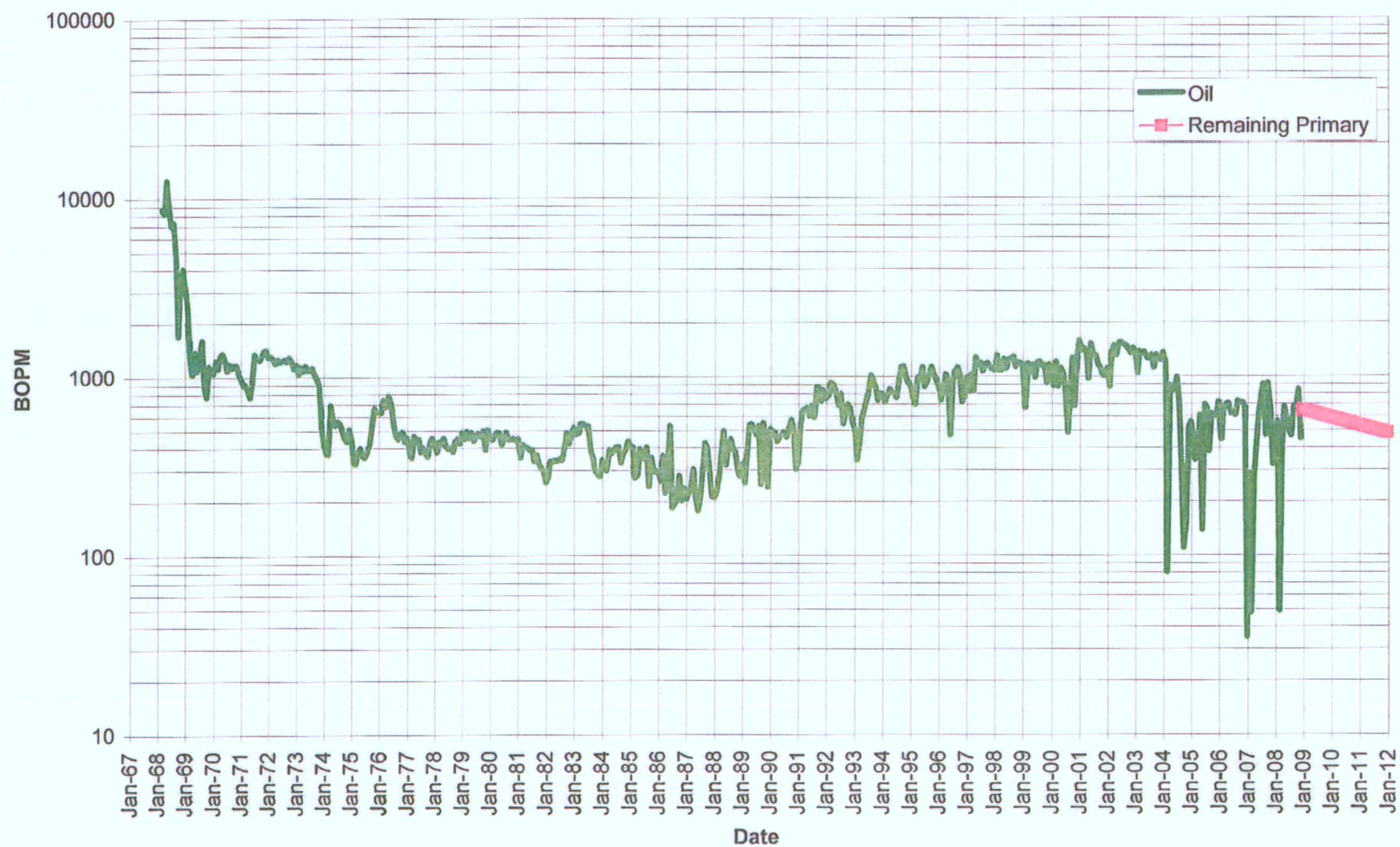

Tract 4, Moyer 4

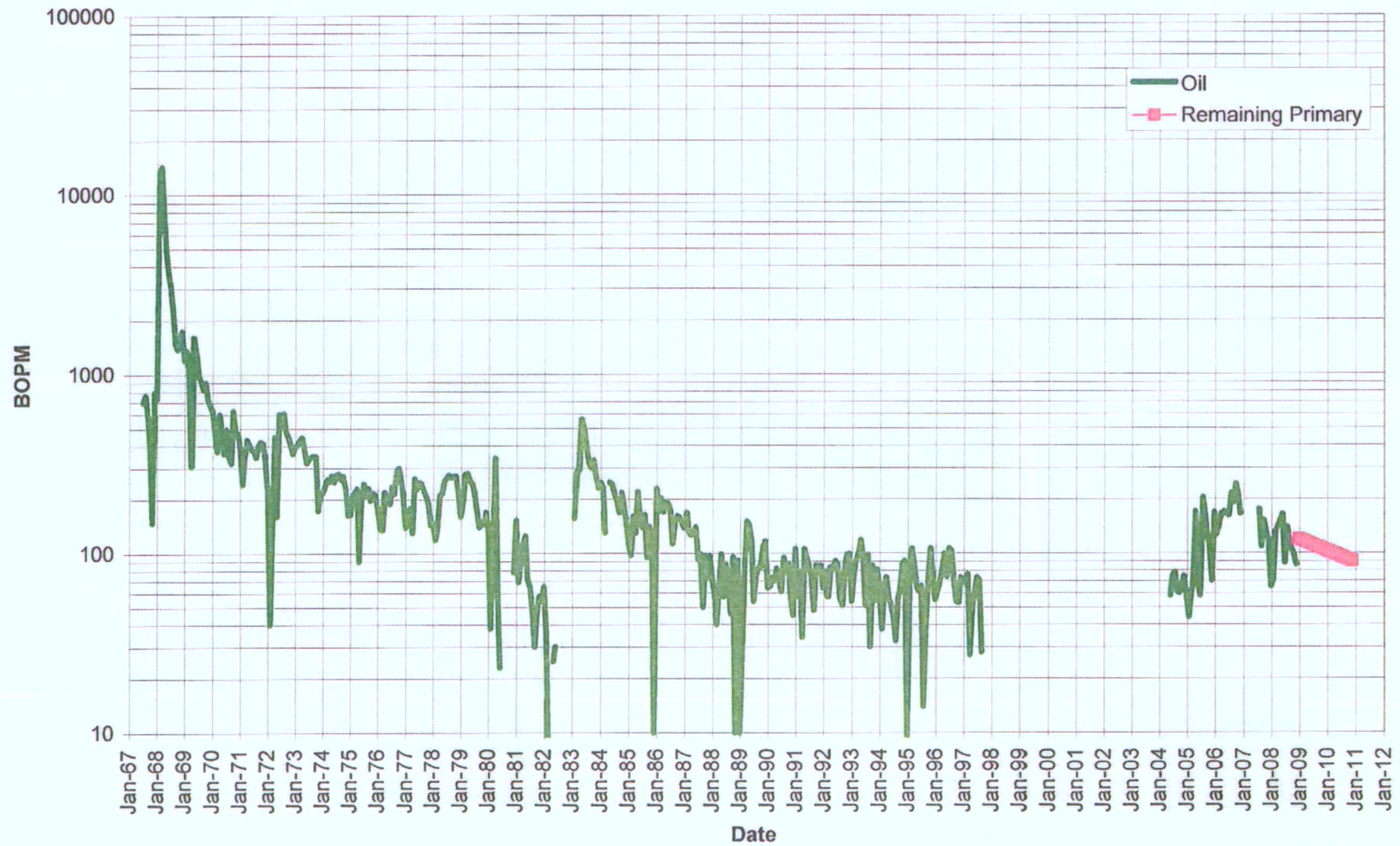

Tract 5, Moyer 2

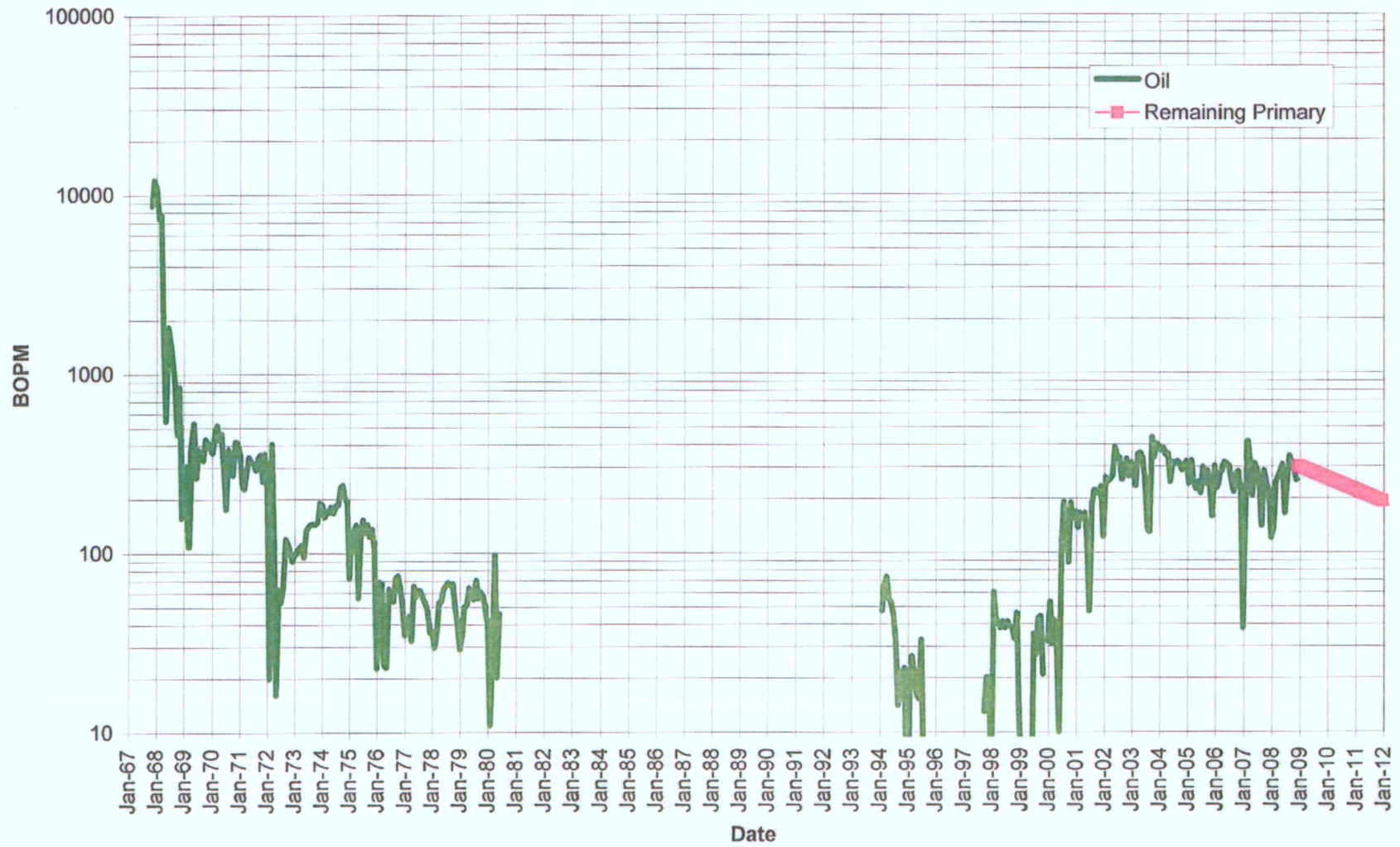

Tract 7, Moyer SE

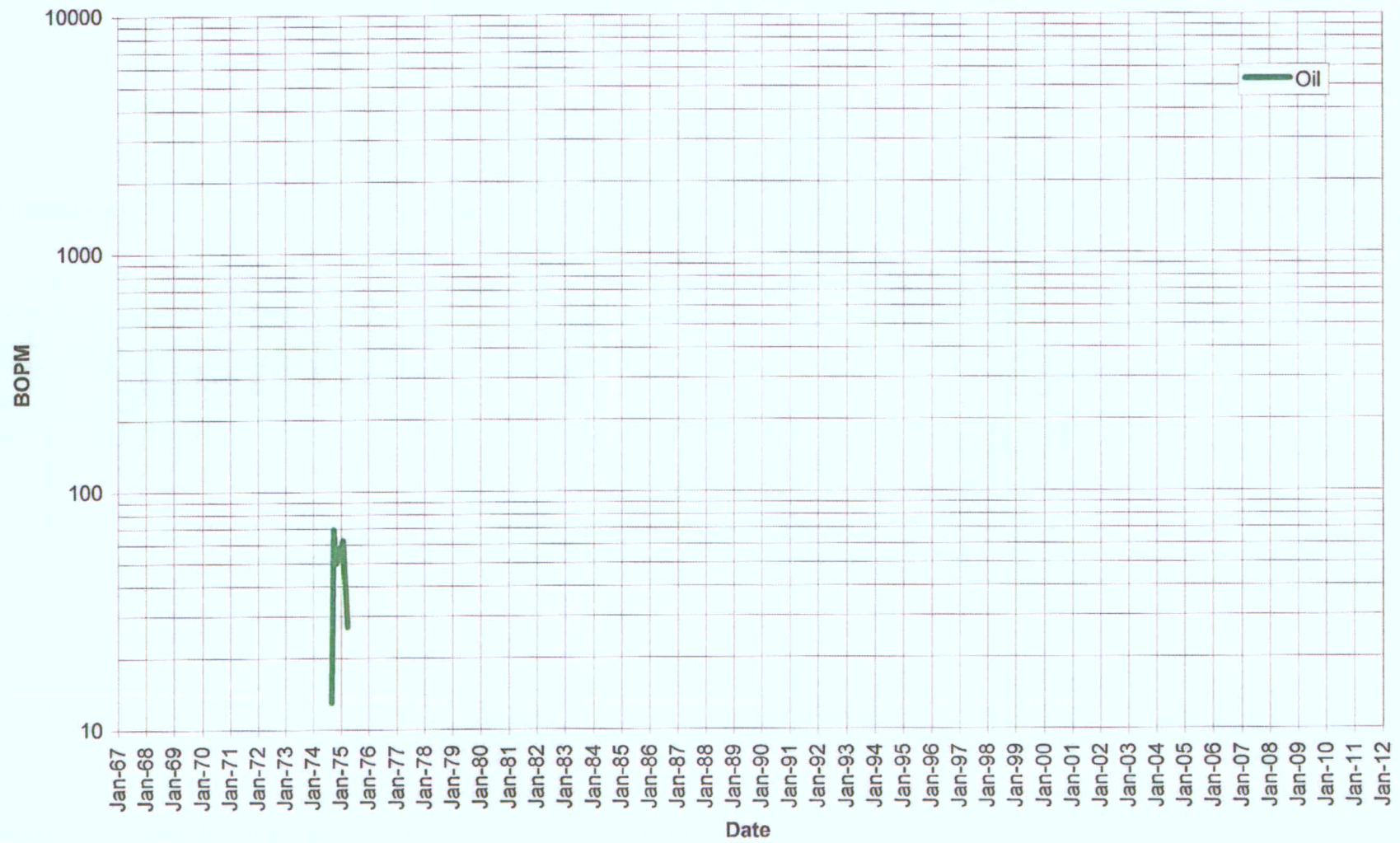

Tract 8, Durland Trust

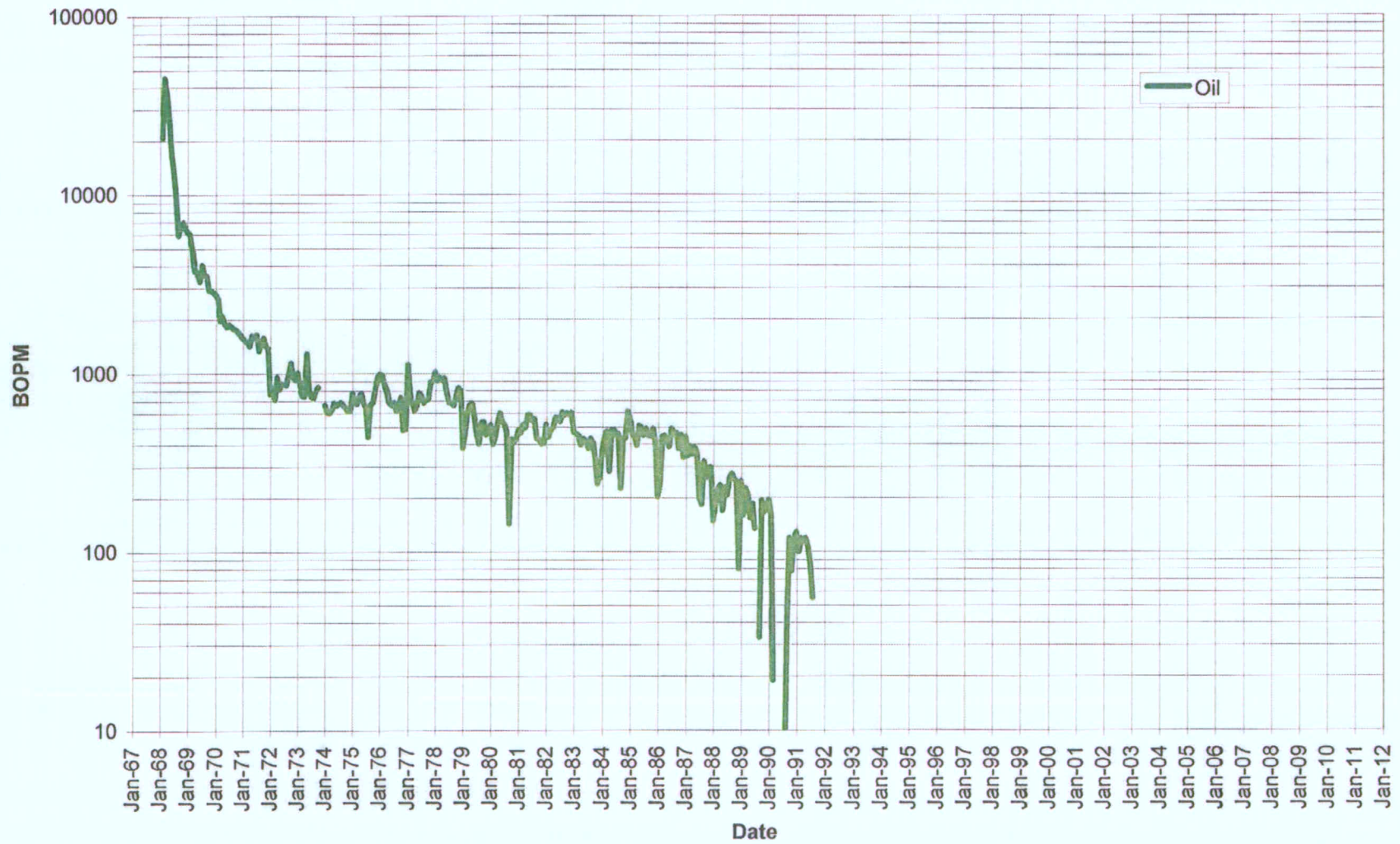

Tract 9, Moyer B-2

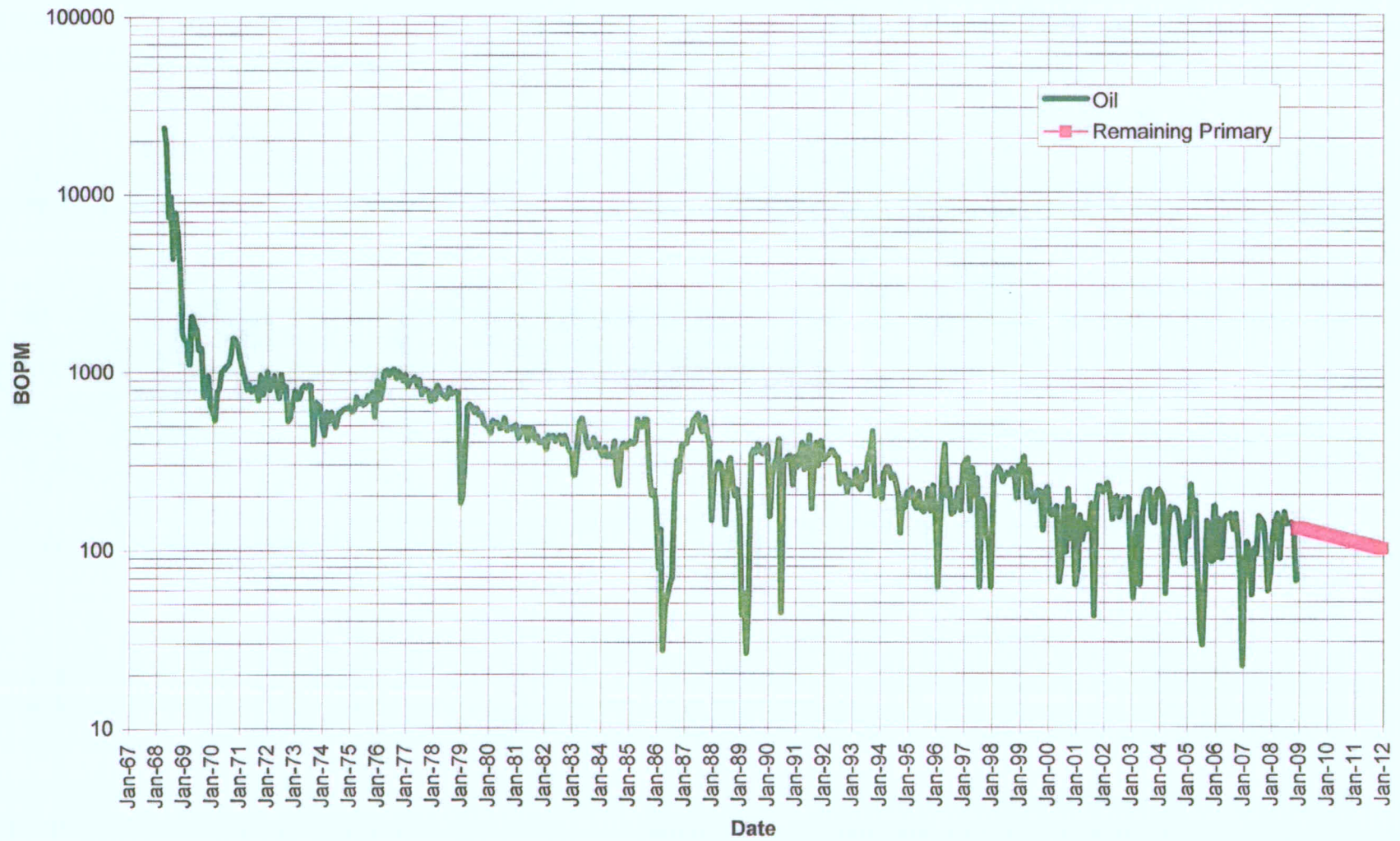

Tract 10, Moyer B

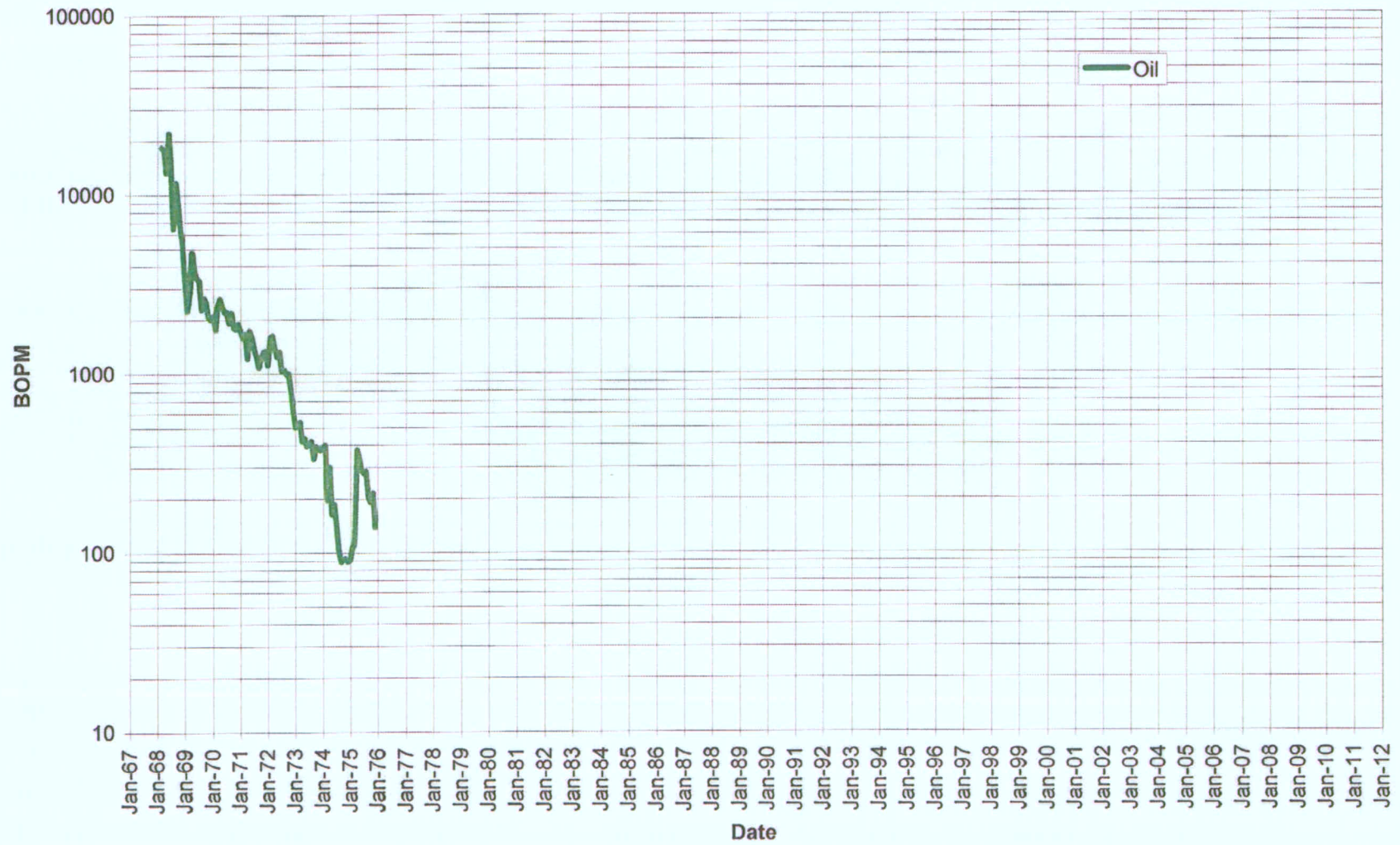

Figure 7 -- Moyer Unit Predicted Performance

