

# CONSTRUCTION LAYOUT DRAWING

EnCana OIL & GAS (USA) INC.

SURFACE DISTURBANCE AREA FOR

WELL PAD K22 596

SECTION 22, T5S, R96W, 6th P.M.

NE 1/4 SW 1/4

SCALE: 1" = 60'  
DATE: 04-22-09  
Drawn By: D.R.B.  
Revised: 06-09-09 D.R.B.  
Revised: 08-25-09 D.R.B.

Sheet 7 of 11

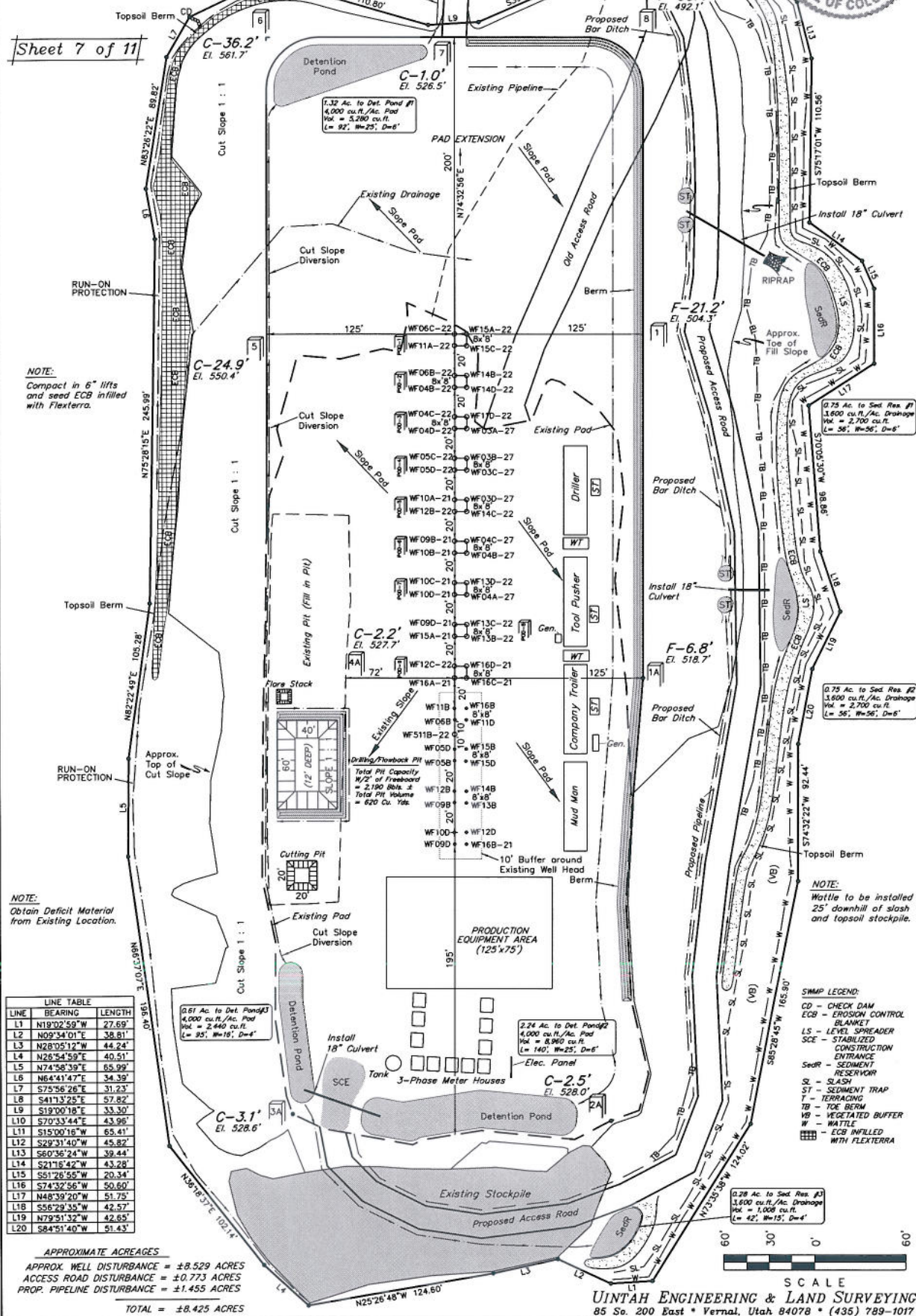
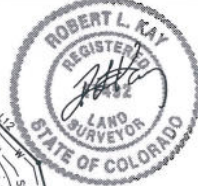

NOTE:  
Compact in 6" lifts  
and seed ECB infilled  
with Flexterra.

NOTE:  
Obtain Deficit Material  
from Existing Location.

NOTE:  
Wattle to be installed  
25' downhill of slash  
and topsoil stockpile.

**SWMP LEGEND:**  
CD - CHECK DAM  
ECB - EROSION CONTROL  
BLANKET  
LS - LEVEL SPREADER  
SCE - STABILIZED  
CONSTRUCTION  
ENTRANCE  
SEDR - SEDIMENT  
RESERVOIR  
SL - SLASH  
ST - SEDIMENT TRAP  
T - TERRACING  
TB - TOE BERM  
VB - VEGETATED BUFFER  
W - WATTLE  
ECB INFILLED  
WITH FLEXTERRA

# CONSTRUCTION LAYOUT DRAWING

EnCana OIL & GAS (USA) INC.

TYPICAL CROSS SECTIONS FOR

WELL PAD K22 596

SECTION 22, T5S, R96W, 6th P.M.

NE 1/4 SW 1/4

NOTE:

Per NRCS U.S. Soil Survey for Rifle Area, Colorado, Parts of Garfield and Mesa Counties. Site has NRCS Chanery, Sandy Loam, and Unweathered Bedrock.

60' 30' 0' 60'

SCALE

Sheet 4 of 11

1" = 40'  
X-Section Scale  
1" = 100'

DATE: 01-14-09

Drawn By: D.R.B.

Revised: 04-22-09 D.R.B.

Revised: 06-09-09 D.R.B.

Revised: 08-25-09 D.R.B.

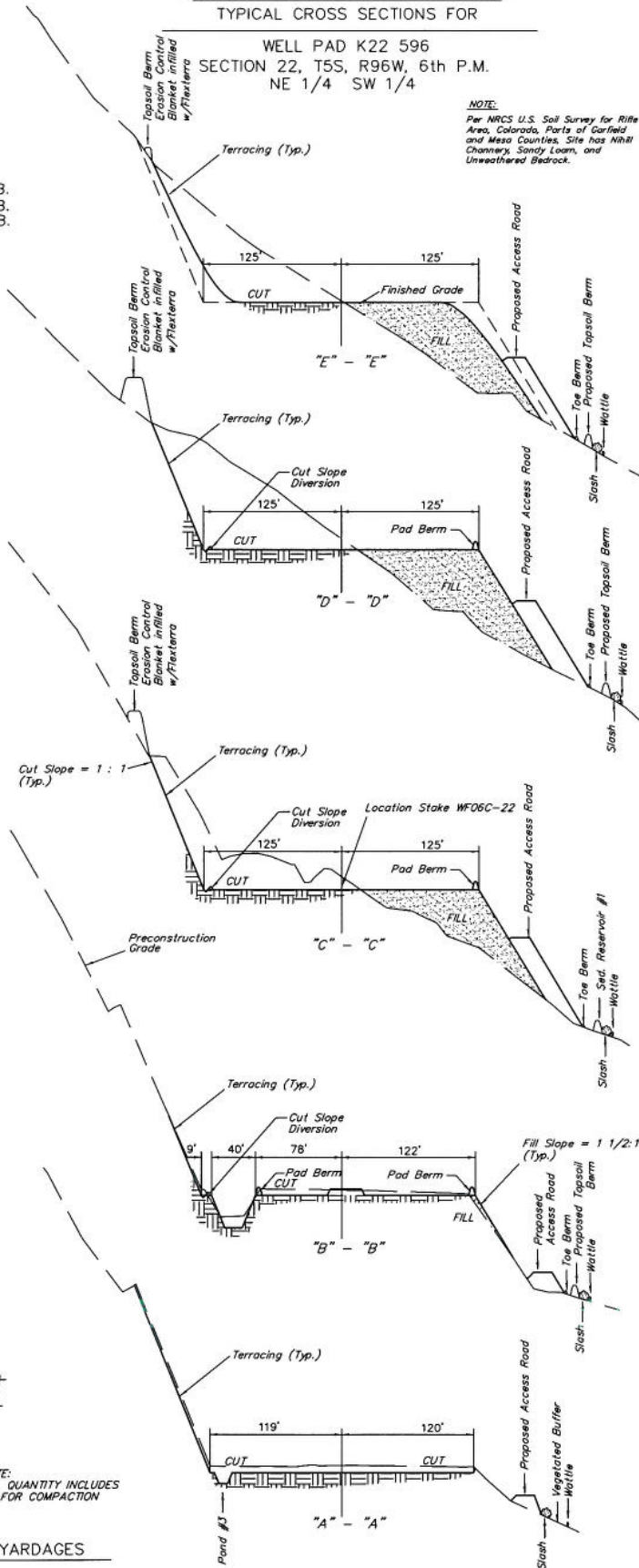

FIGURE #2

\* NOTE:  
FILL QUANTITY INCLUDES  
5% FOR COMPACTION

## APPROXIMATE YARDAGES

CUT  
(6") Topsoil Stripping = 1,230 Cu. Yds.  
(New Construction Only)  
Remaining Location = 37,900 Cu. Yds.  
TOTAL CUT = 39,130 CU.YDS.  
FILL = 30,520 CU.YDS.

EXCESS MATERIAL = 8,610 Cu. Yds.  
Topsoil & Pit Backfill = 1,540 Cu. Yds.  
(1/2 Pit Vol.)  
EXCESS UNBALANCE = 7,070 Cu. Yds.  
(After Interim Rehabilitation)

UINTAH ENGINEERING & LAND SURVEYING  
85 So. 200 East • Vernal, Utah 84078 • (435) 789-1017

